

FINAL SURVEY SURVEYED PLOTTED DATE  
 NOTE BOOK AREAS CHECKED

ORIGINAL SURVEY SURVEYED PLOTTED DATE  
 NOTE BOOK AREAS CHECKED

F.A.P. RTE.	SECTION	COUNTY	TOTAL SHEETS	SHEET NO.
322	18Z & 18Y, R5 28Z	MARION	222	212
STA.		TO STA.		
FED. ROAD DIST. NO.		ILLINOIS	FED. AID PROJECT	

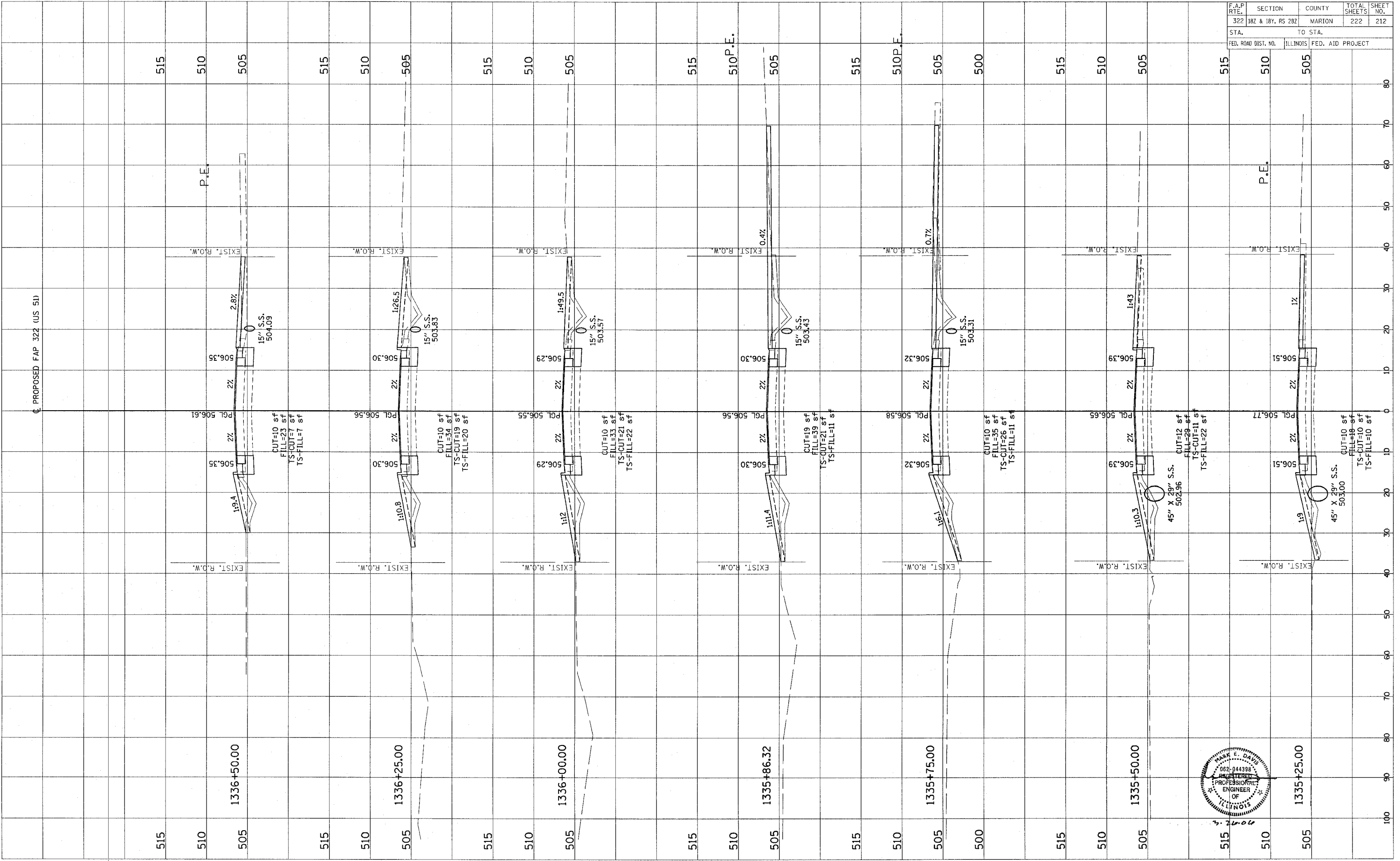

CONTRACT NO. 94700

Revised 3/28/06