

FINAL SURVEY	REVISIONS	BY	DATE
NOTE BOOK	PLOTTED		
NO.	TEMPLATE		
	AREAS CHECKED		

ORIGINAL SURVEY	REVISIONS	BY	DATE
NOTE BOOK	PLOTTED		
NO.	TEMPLATE		
	AREAS CHECKED		

F.A.P. RTE.	SECTION	COUNTY	TOTAL SHEETS	SHEET NO.
322	182 & 184, RS 282	MARION	222	214
STA.	TO STA.			
FED. ROAD DIST. NO.	ILLINOIS FED. AID PROJECT			

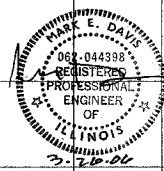
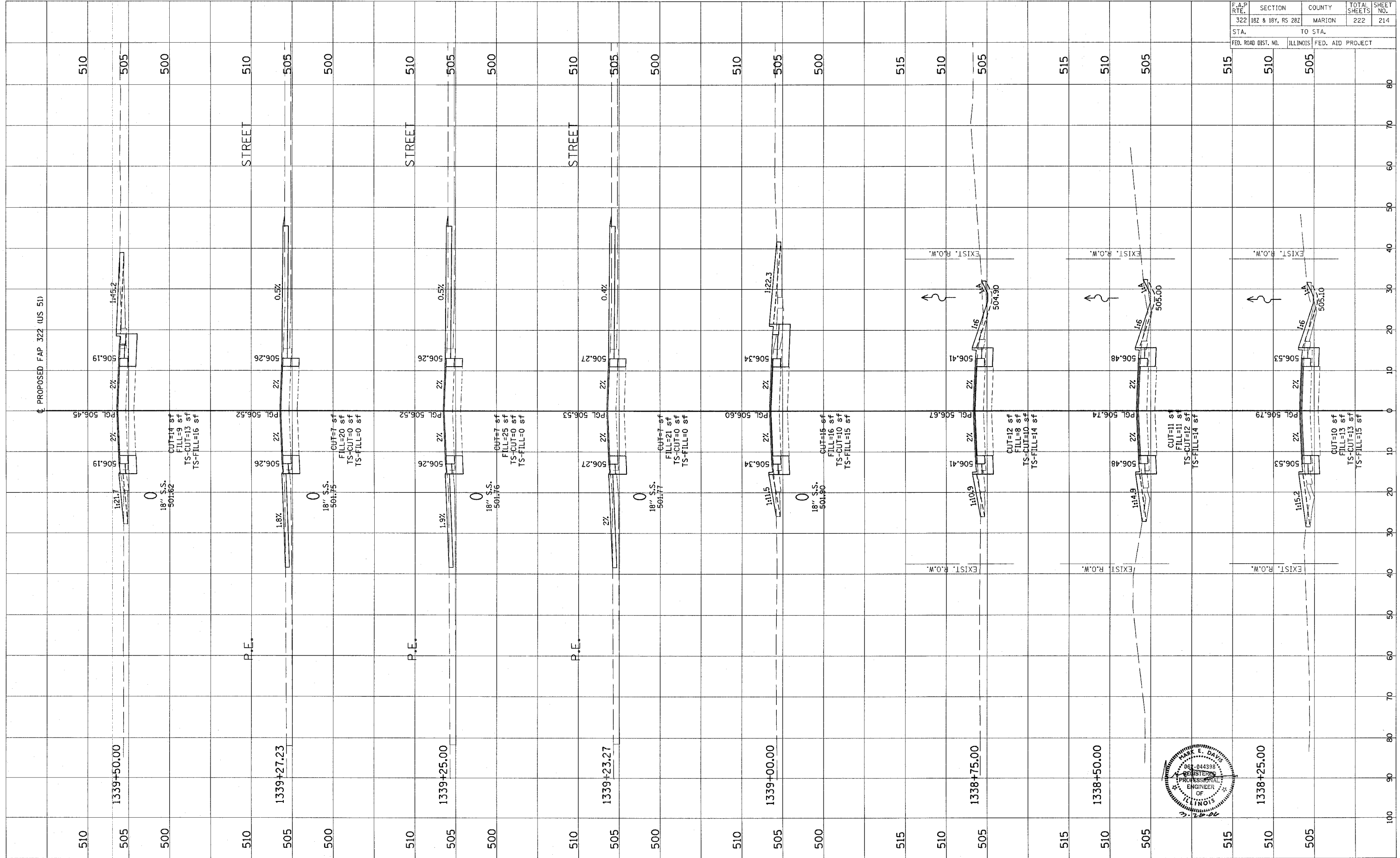

CONTRACT NO. 94700

Revised 3/28/06