

CONTRACT NO. 95423

GENERAL NOTES

Layout of riprap may be varied in the field to suit ground conditions as directed by the Engineer.
 Excavation required to construct the Abutments shall be considered incidental to Concrete Structures. No additional compensation will be allowed for Structure Excavation.
 The Contractor shall drive one steel test pile in a permanent location at the West Abutment, as directed by the Engineer before ordering the remainder of the piles.
 Non-prestressing steel shall conform to the requirements of AASHTO M-31 or M-322 Grade 60.
 See sheet 19 for Borings.

C.N.I.C. RAILROAD
 BUILT 200 BY
 JEFFERSON COUNTY
 SEC. 03-10117-00-BR
 F.A. PROJ. BROS-081(44)
 STR. NO. 041-9929
 LOADING HS 20

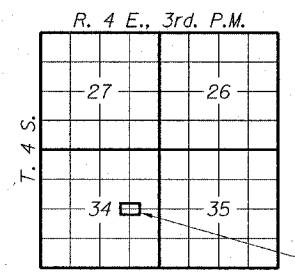

NAME PLATE
 See Std. 515001

DESIGN STRESSES

$f'_c = 5,000$ psi (Prestressed Beams)
 $f'_{ci} = 4,000$ psi (Prestressed Beams)
 $f'_s = 270,000$ psi (Prestressed Strands)
 $f_{si} = 189,000$ psi (Prestressed Strands)
 $f_y = 60,000$ psi (Reinf. Bars)
 $f'_c = 3,500$ psi (Class S1 Concrete) — LF DESIGN
 Loading HS 20-44
 Design Specifications: 2002 AASHTO & all applicable interims.
 25#/Sq. Ft. included in dead load for future wearing surface.

SEISMIC DATA

Seismic Performance Category (SPC) = B
 Bedrock Acceleration Coefficient (A) = 0.10g
 Site Coefficient (S) = 1.0

TOTAL BILL OF MATERIAL

ITEM	UNIT	SUPER	SUB	TOTAL
Precast Prestressed Concrete Deck Beams (21" Depth)	Sq. Ft.	3,996		3,996
Concrete Structures	Cu. Yd.		144.8	144.8
Reinforcement Bars	Pound		31,810	31,810
Steel Railing, Type S1	Foot	306		306
Name Plates	Each		1	1
Steel Piles HP10x42	Foot		210	210
Test Pile Steel HP10x42	Each		1	1
Stud Shear Connectors	Each		16	16
Concrete Encasement	Cu. Yd.		2.0	2.0
Controlled Low Strength Material	Cu. Yd.		35	35
Structure Excavation	Cu. Yd.		200	200
Rock Excavation	Cu. Yd.		8.6	8.6
Stone Dumped Riprap, Class A4	Ton			500

HLR
 Rice, Berry and Associates
 A Division of Hampton, Lenzini and Renwick, Inc.
 Civil & Structural Engineers
 3085 Stevenson Drive
 Suite 201
 Springfield, Illinois 62703
 217-546-3400
 P.O. Box 1036
 DuQuoin, Illinois 62832
 618-790-4637
 Account Number 12-49-0002-1
 Date: 01/04/06
 DESIGNED: S.M.S. CHECKED: S.W.M. DRAWN: D.B.

GENERAL PLAN AND ELEVATION
 SECTION 03-10117-00-BR
 MOORES PRAIRIE ROAD DISTRICT
 JEFFERSON COUNTY
 STR. NO. 041-9929 STATION 20+00

I certify that to the best of my knowledge, information and belief, this bridge design is structurally adequate for the design loading shown on the plans. The design is an economical one for the style of structure and complies with requirements of the current "AASHTO Standard Specifications for Highway Bridges".
 Steven W. Megginson 1-4-06
 ILLINOIS STRUCTURAL NO. 6064
 Expires 11-30-06

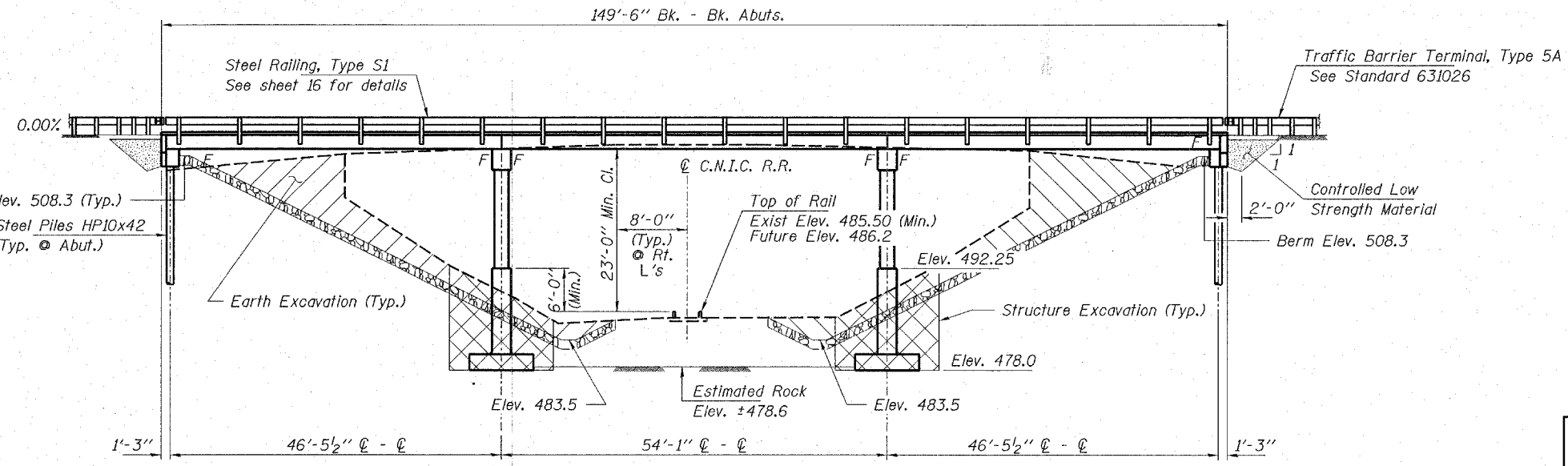

ELEVATION

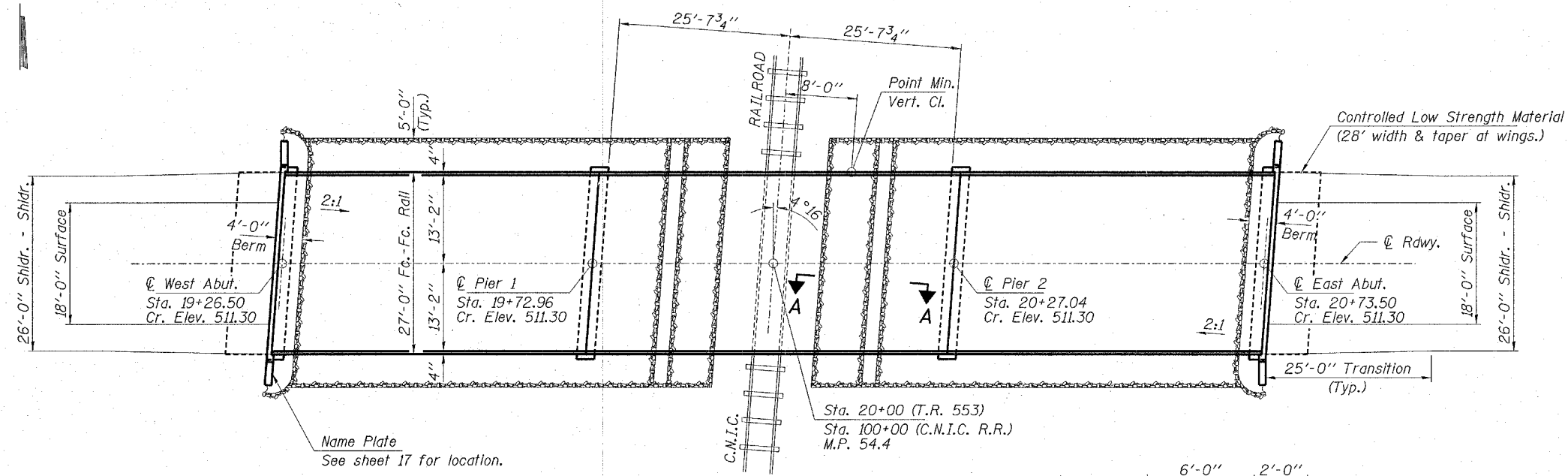

PLAN

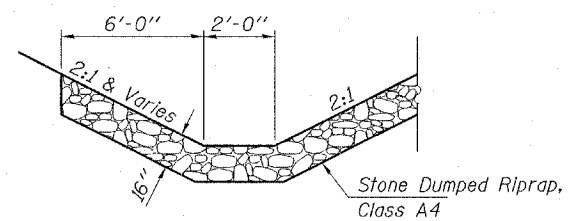

SECTION A-A

Boring Locations

B-1	Sta. 18+57
B-2	Sta. 21+63

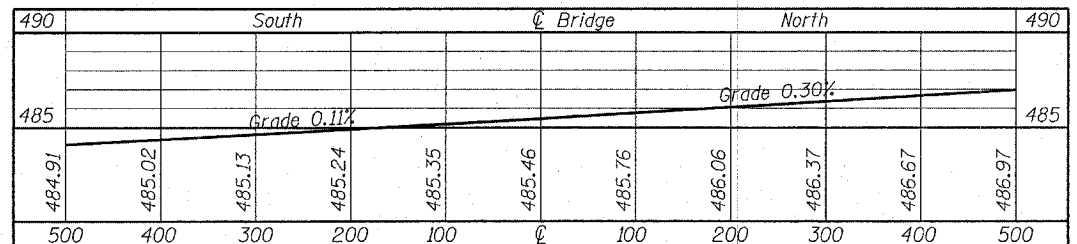

C.N.I.C. RAIL PROFILE