

STATE OF ILLINOIS
DEPARTMENT OF TRANSPORTATION

ROUTE NO.	SECTION	COUNTY	TOTAL SHEETS	SHEET NO.
T.R. 299	05-01122-00-BR	FAYETTE	11	4
FED. ROAD DIST. NO.		ILLINOIS		

CONTRACT NO. 95465

B.M. - B.M. #1, R.R. Spike in Power Pole, 25.7' RT., STA. 48+53.35, EL. 564.49
B.M. #2, R.R. Spike in Power Pole, 71.1' LT., STA. 51+43.53, EL. 564.42

Existing Structure - Two span precast concrete channel beam superstructure on concrete pile caps, supported by timber piling.

Salvage - Material deemed salvageable by the Engineer shall be stored on the ROW for removal by the County.

Existing Known Utilities - Overhead electric, Telephone

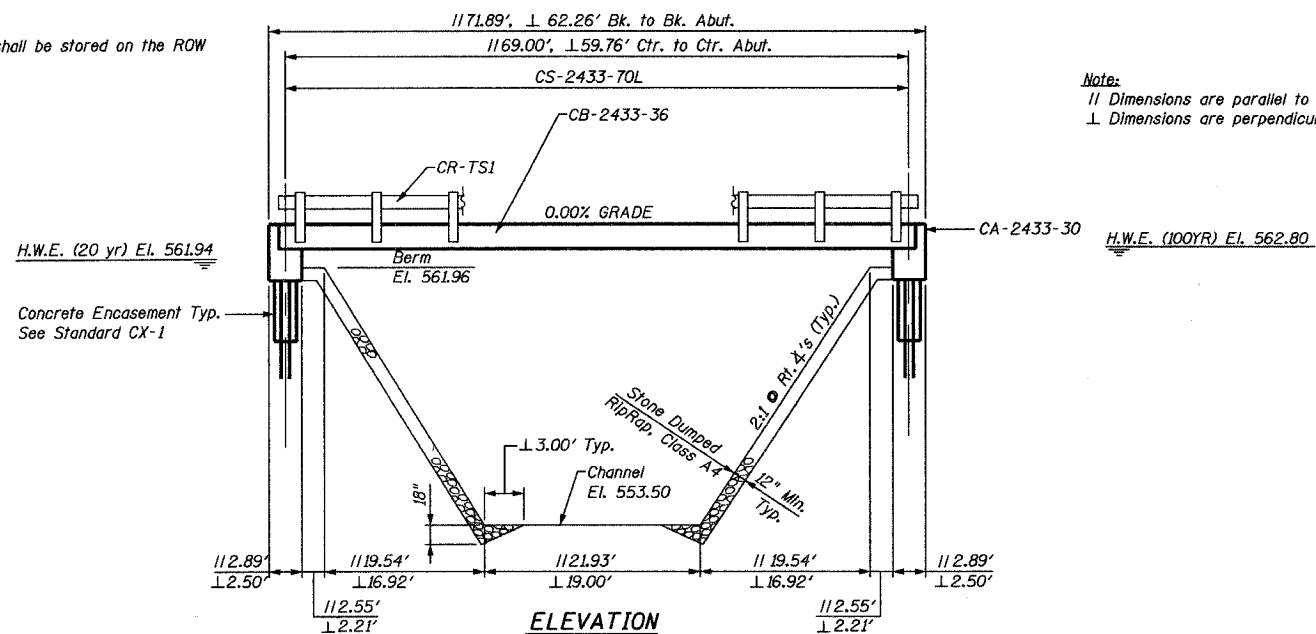

Note:
|| Dimensions are parallel to roadway
⊥ Dimensions are perpendicular to channel

GENERAL NOTES

- The contractor shall drive 1 test pile, as specified, in a permanent location as directed by the Engineer before ordering the remaining piles.
- See Special Provisions for boring logs.
- A Calcium Nitrite Corrosion inhibitor, as covered in the Special Provisions, shall be used in the concrete for precast prestressed concrete deck beams.
- The Waterproofing Membrane System and Bituminous Concrete Surface Course Shown on the Standards Shall Not be Provided.

TOTAL BILL OF MATERIAL

Item	Unit	Super	Sub.		Total
			Piers	Abuts.	
Removal of Existing Structures	Each				1
Concrete Structures	Cu. Yd.			22.6	22.6
Precast Prestressed Concrete Deck Beams (33" Depth)	Sq. Ft.	1680			1680
Steel Railing, Type S-1	Foot	140			140
Reinforcement Bars	Pound			2680	2680
Furnishing Steel Piles HP 12x53	Foot			172	172
Driving Steel Piles	Foot			172	172
Test Pile Steel HP 12x53	Each			1	1
Name Plates	Each			1	1
Concrete Encasement	Cu. Yd.			3.36	3.36

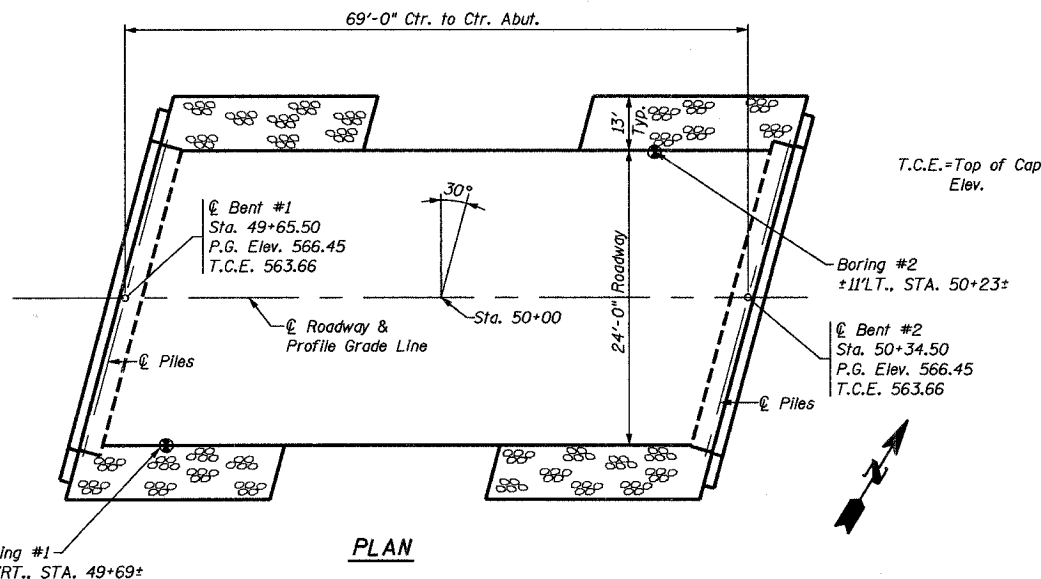

T.C.E. = Top of Cap Elev.

The standard detail sheets for this structure were assembled by me or persons under my direct supervision.

Date of License Expiration: 11/30/07

Date: 1/24/06

Signature: Michael R. Quantt



I certify these Standard Bridge Plans for foundation treatment only.

Date of License Expiration: 11-30-06

Date: 1-24-06

Signature: William D. Lucking



DESIGN SPECIFICATIONS

2002 AASHTO Standard Specifications - 17th ed.

LOADING HS 20-44

Allow 25# / Sq. Ft. for Future Wearing Surface.

PILE DATA (2-ABUTS.)

Type: Steel Piles, HP12x53
Capacity: 60 Tons (Includes 150% of Max. Pile Load for H-Pile In Friction)
Estimated Length: 16 Feet Bent #1, 23 Feet Bent #2
Number Required: 10 (Includes 1 Test Pile located in Bent #2)

LETTERING FOR NAME PLATE

Locate Name Plate at Northwest Corner of Bridge (See Std. CN)

STATION 50+00
BRICKYARD BRANCH
SEC. 05-01122-00-BR BUILT 20-
PROJECT NO. BROS-051(72)
FAYETTE COUNTY
LOADING HS20
STR. NO. 026-3427

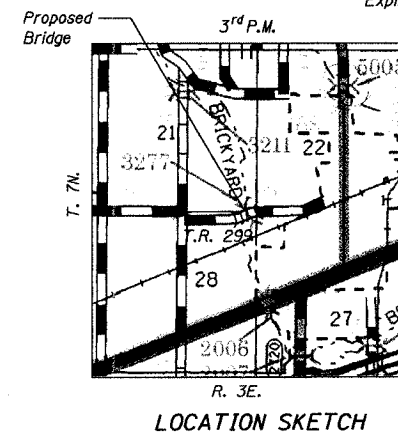

WATERWAY INFORMATION

Drainage Area = 8.58 Sq. Mi.		Low Grade Elev. 565.32 @ Sta. 48+46							
Flood Yr.	Q C.F.S.	Opening Sq. Ft.		H.W.E. Ft.		Head - Ft.		Headwater Elev. - Ft.	
		Exist.	Prop.	Exist.	Prop.	Exist.	Prop.	Exist.	Prop.
Design	20	1680	193	303	561.94	N/A	0.40	N/A	562.34
Base	100	2473	214	352	562.80	N/A	0.84	N/A	563.64
Overtopping Max. Calc.	500								

INDEX OF SHEETS

- General Plan & Elevation
- Standard CS-2433-70L
- Standard CB-2433-36
- Standard CA-2433-30
- Standard CR-TS1
- Standard CN
- Standard CX-1

GENERAL PLAN & ELEVATION

T.R. 299
OVER BRICKYARD BRANCH
SECTION 05-01122-00-BR
FAYETTE COUNTY
STATION 50+00