

BY	DATE
ORIGINAL SURVEY PLOTTED	
NOTE BOOK TEMPLATE	
AREAS CHECKED	
NO.	

BY	DATE
ORIGINAL SURVEY PLOTTED	
NOTE BOOK TEMPLATE	
AREAS CHECKED	
NO.	

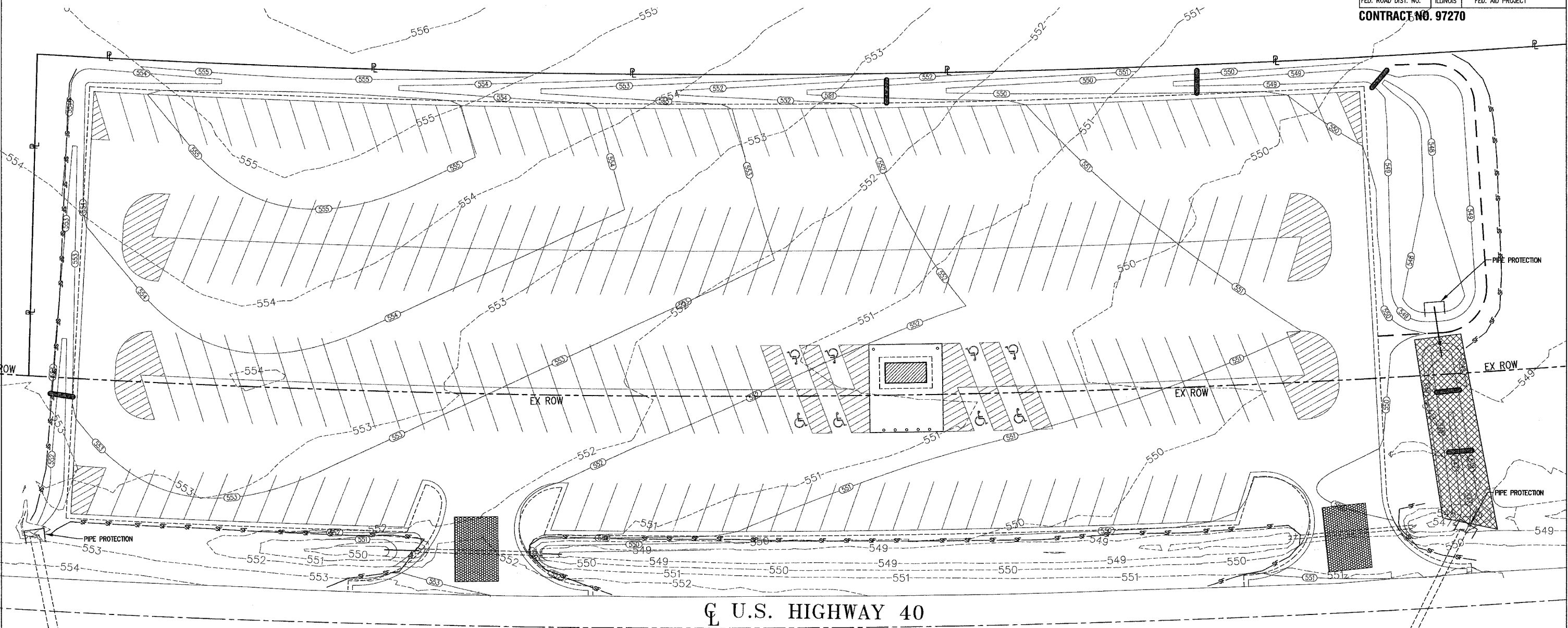

EROSION CONTROL GENERAL NOTES

- 1) THE CONTRACTOR SHALL PROVIDE AND MAINTAIN EROSION AND SILTATION CONTROL AS SHOWN ON THE EROSION CONTROL PLAN AND AS NEEDED TO PREVENT DAMAGE TO OFF-SITE PROPERTIES UNTIL THE PROJECT HAS BEEN CONSTRUCTED AND VEGETATION IN ALL AREAS HAS BEEN ESTABLISHED, AT WHICH TIME, THE CONTRACTOR SHALL BE RESPONSIBLE FOR REMOVAL OF ALL TEMPORARY EROSION CONTROL AND REPAIR OF ALL ERODED AREAS. THE EROSION CONTROL SHALL SPECIFICALLY INCLUDE PLACEMENT OF ANCHORED AND STAKED SILT FENCING AT ALL POINTS WHERE RUNOFF LEAVES THE CONSTRUCTION SITE. THE SILT FENCING SHALL BE OF SUFFICIENT LENGTH TO TRAP ALL ERODED MATERIALS. THE EROSION CONTROL SHOWN HEREIN SHALL BE PROVIDED AS A MINIMUM MEASURE. ADDITIONAL MEASURES SHALL BE PROVIDED AS NECESSARY TO PREVENT EROSION OR AS MAY BE REQUIRED BY THE ENGINEER. ALL EROSION CONTROL PRACTICES SHALL CONFORM TO ILLINOIS ENVIRONMENTAL PROTECTION AGENCY "STANDARDS AND SPECIFICATIONS FOR SOIL EROSION CONTROL", LATEST EDITION.
- 2) THE CONTRACTOR SHALL INSURE THAT OFF-SITE SEDIMENTATION DAMAGE WILL NOT OCCUR BY RESTRICTING THE AMOUNT OF LAND GRADED AT ANY ONE TIME TO A MINIMUM AND STOCKPILING TOPSOIL FOR RE-USE IN PREPARING THE FINAL SEED BED.
- 3) PIPE PROTECTION SHALL BE PLACED AT THE UPSTREAM END OF ALL CULVERTS WHERE INDICATED ON THE DRAWINGS TO PREVENT SILTATION.
- 4) PERIMETER EROSION BARRIER SHALL BE KEPT IN GOOD REPAIR AND MAINTAINED THROUGHOUT CONSTRUCTION. SEDIMENT SHALL BE REMOVED WHEN THE PONDING CAPACITY IS REDUCED BY ONE-HALF.

EROSION CONTROL GENERAL NOTES (CONTINUED)

- 5) THE TEMPORARY EROSION CONTROL SYSTEMS SHALL BE PROPERLY MAINTAINED BY THE CONTRACTOR TO CONTROL SILTATION AT ALL TIMES DURING THE LIFE OF THE CONTRACT.
- 6) ALL SALVAGEABLE TEMPORARY EROSION CONTROL ITEMS WHEN REMOVED SHALL BECOME THE PROPERTY OF THE CONTRACTOR.
- 7) COLLECTED SEDIMENT FROM PERIMETER EROSION BARRIER SHALL BE PLACED IN FILL AREAS, GRADED AND RESEEDED AS DIRECTED BY THE ENGINEER.
- 8) PRIOR TO ANY CONSTRUCTION, A TEMPORARY CONSTRUCTION EXIT PAD SHALL BE CONSTRUCTED AT EACH EXIT FROM THE SITE AS DIRECTED BY THE ENGINEER. THE CONSTRUCTION EXIT SHALL BE MAINTAINED IN A CONDITION, WHICH WILL PREVENT TRACKING OR FLOW OF MUD OFF THE JOB SITE. THIS MAY REQUIRE A PERIODIC TOP DRESSING WITH STONE, AS CONDITIONS DEMAND, AND REPAIR AND/OR CLEAN-OUT OF ANY STRUCTURES USED TO TRAP SEDIMENT. ALL MATERIALS SPILLED, DROPPED, WASHED, OR TRACKED FROM VEHICLES OFF THE JOB SITE OR INTO STORM DRAINS MUST BE REMOVED. PAYMENT FOR THIS WORK, INCLUDING PERIODIC DRESSING OF EXIT PAD AND REMOVAL, SHALL BE AT THE LUMP SUM UNIT PRICE FOR TEMPORARY CONSTRUCTION EXIT PAD.

EROSION CONTROL LEGEND

SYMBOL	MEASURE	DETAIL
	PERIMETER EROSION BARRIER	280001-02
	URETHANE FOAM/GEOTEXTILE DITCH CHECK	280001-02
	INLET PROTECTION	280001-02
	EROSION CONTROL BLANKET	
	TEMPORARY CONSTRUCTION EXIT	SEE SHEET 10

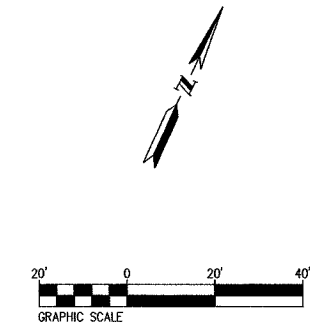

<p>Juneau Associates, Inc. P.C. CONSULTING ENGINEERS AND LAND SURVEYORS 2100 State Street, P.O. Box 1305 Peoria City, Illinois 61604-4735 Phone: (309)777-1400/(309)452-5505 Fax: (309)452-5541</p>		<p>EROSION CONTROL PLAN HIGHLAND PARK-RIDE IMPROVEMENTS MADISON COUNTY TRANSIT HIGHLAND, ILLINOIS SECTION No. 00-00012-00-PK</p>																					
<p>REVISIONS</p> <table border="1"> <thead> <tr> <th>NO.</th> <th>DATE</th> <th>BY</th> <th>REMARKS</th> </tr> </thead> <tbody> <tr> <td> </td> <td> </td> <td> </td> <td> </td> </tr> </tbody> </table>		NO.	DATE	BY	REMARKS					<p>SCALE:</p> <table border="1"> <tr> <td>DSN. BY: RGL/AJW</td> <td>DATE: 12/20/05</td> <td>SHEET</td> </tr> <tr> <td>DWN. BY: RGL/AJW</td> <td>DATE: 12/20/05</td> <td>9</td> </tr> <tr> <td>CHK'D: RAK</td> <td>DATE: 12/20/05</td> <td></td> </tr> <tr> <td>DWG. NO.:</td> <td>JOB NO. E054401</td> <td>DWG NAME:</td> </tr> </table>		DSN. BY: RGL/AJW	DATE: 12/20/05	SHEET	DWN. BY: RGL/AJW	DATE: 12/20/05	9	CHK'D: RAK	DATE: 12/20/05		DWG. NO.:	JOB NO. E054401	DWG NAME:
NO.	DATE	BY	REMARKS																				
DSN. BY: RGL/AJW	DATE: 12/20/05	SHEET																					
DWN. BY: RGL/AJW	DATE: 12/20/05	9																					
CHK'D: RAK	DATE: 12/20/05																						
DWG. NO.:	JOB NO. E054401	DWG NAME:																					