

ROUTE NO.	SECTION	COUNTY	TOTAL SHEETS	SHEET NO.
FAS 788 (C.H. 24/ C.H. 16)	03-00075- 00-BR WASH. 03-00082- 00-BR CLIN.	WASHINGTON CLINTON	22	7

FINAL SURVEY

DATE: _____ BY: _____

REVIEWED: _____

NOTE BOOK NO. _____

AREAS CHECKED: _____

ORIGINAL SURVEY

DATE: _____ BY: _____

REVIEWED: _____

NOTE BOOK NO. _____

AREAS CHECKED: _____

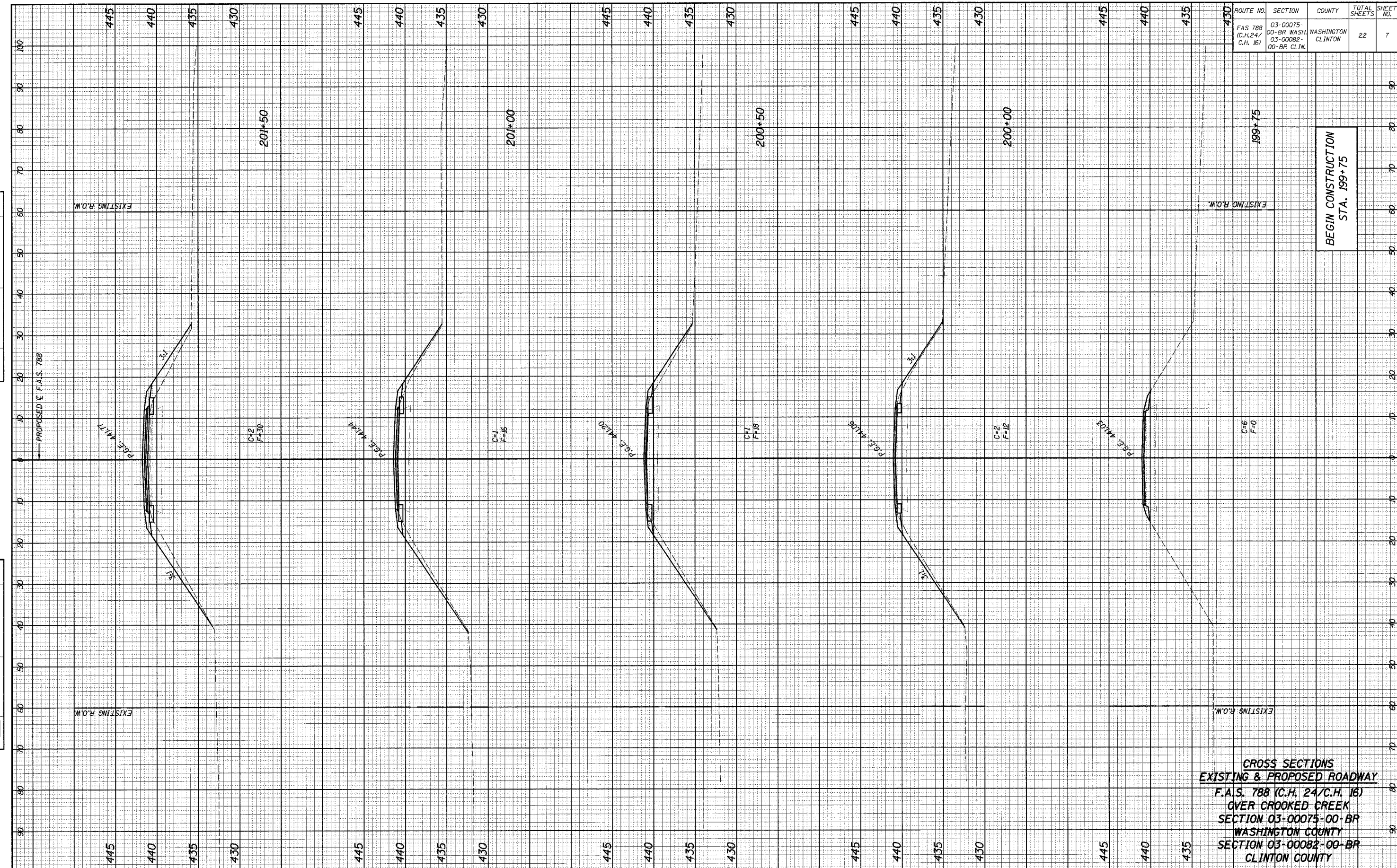

**CROSS SECTIONS
EXISTING & PROPOSED ROADWAY**
 F.A.S. 788 (C.H. 24/C.H. 16)
 OVER CROOKED CREEK
 SECTION 03-00075-00-BR
 WASHINGTON COUNTY
 SECTION 03-00082-00-BR
 CLINTON COUNTY