

F.A.P. RTE.	SECTION	COUNTY	TOTAL SHEETS	SHEET NO.
331	*	JACKSON	158	188

STA. 64+91.00 TO STA. 65+50.00
 FED. ROAD DIST. NO. 7 ILLINOIS FED. AID PROJECT

* (12-1)2N, 1-5, TS-3, B-1

DATE	BY
DATE	BY
DATE	BY

DATE	BY
DATE	BY
DATE	BY

2/15/2006
 5:00:00 PM
 2006

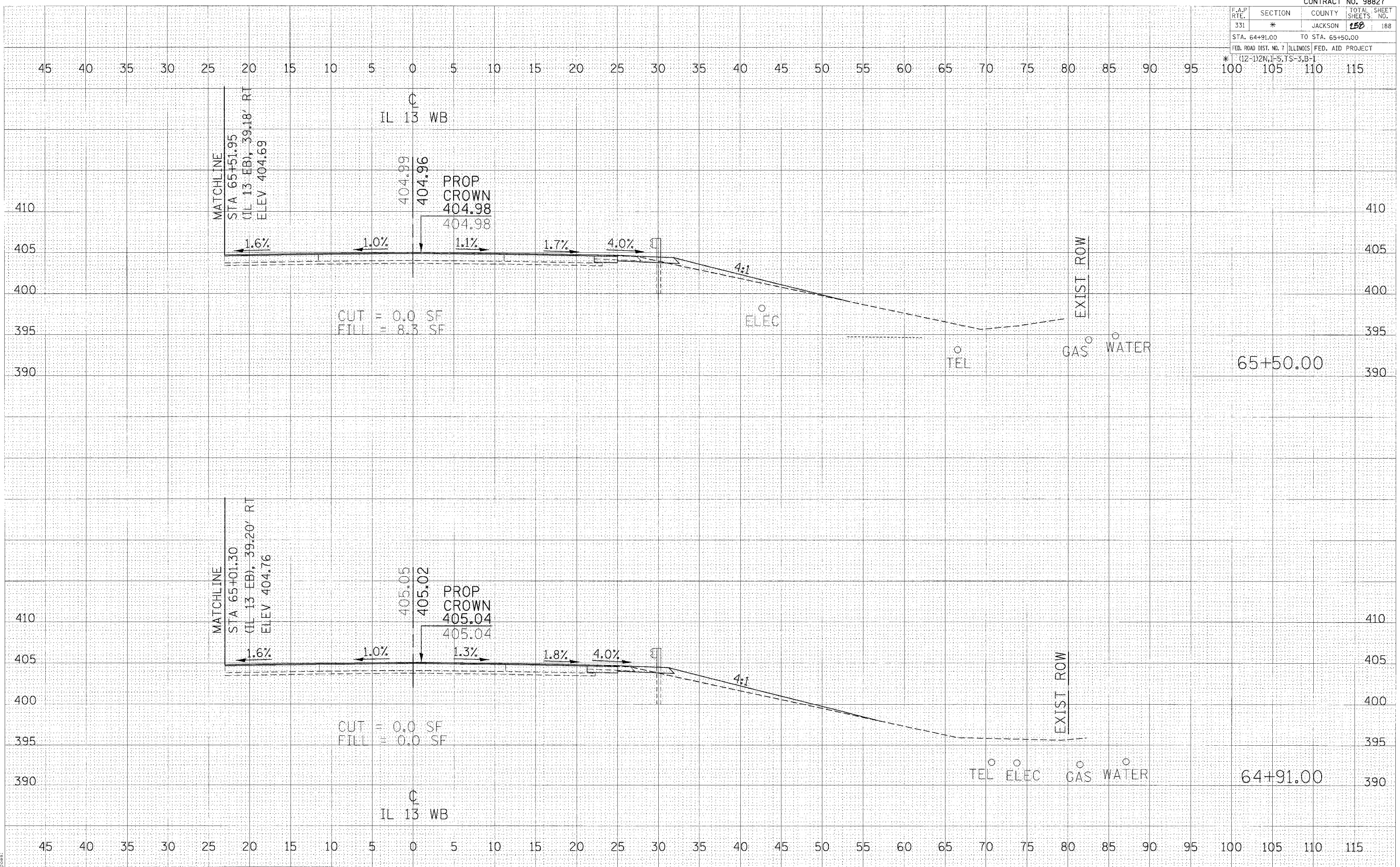

CROSS SECTIONS - IL 13 WB