

F.A.P. RTE	SECTION	COUNTY	TOTAL SHEETS	SHEET NO
726	130 RS-2	WILLIAMSON	58	18
STA.		TO STA.		
FED. ROAD DIST. NO. -		ILLINOIS	FED. AID PROJECT	

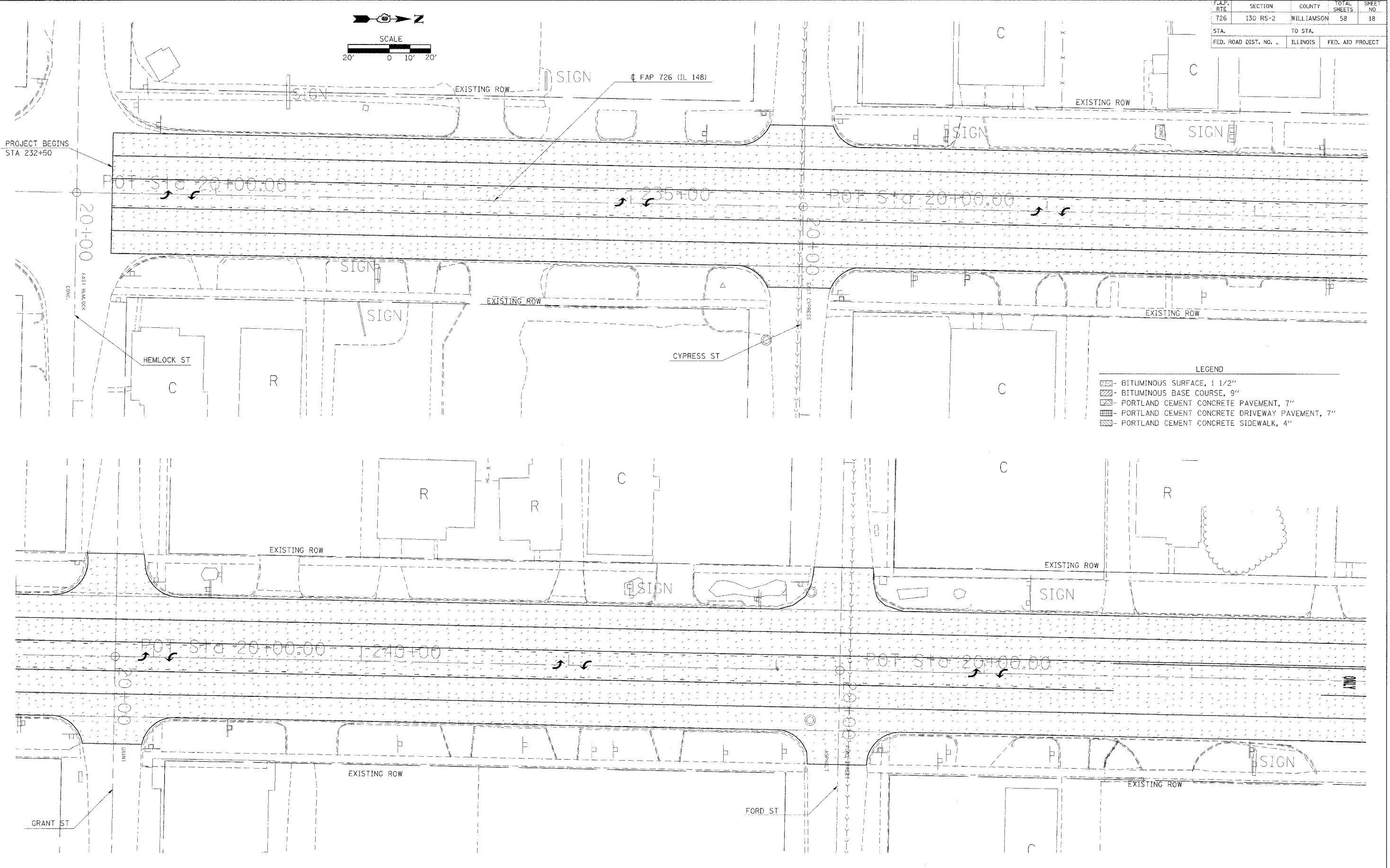
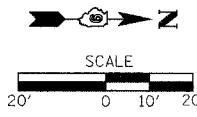

LEGEND

	- BITUMINOUS SURFACE, 1 1/2"
	- BITUMINOUS BASE COURSE, 9"
	- PORTLAND CEMENT CONCRETE PAVEMENT, 7"
	- PORTLAND CEMENT CONCRETE DRIVEWAY PAVEMENT, 7"
	- PORTLAND CEMENT CONCRETE SIDEWALK, 4"

PLOT DATE = 2/16/2005
 FILE NAME = c:\p130rs2\98912\98912.dwg
 PLOT SCALE = 22,00000 / IN.
 USER NAME = cam-laborn

PROPOSED CONSTRUCTION