

F.A.P. RTE	SECTION	COUNTY	TOTAL SHEETS	SHEET NO
726	130 RS-2	WILLIAMSON	58	20
STA.		TO STA.		
FED. ROAD DIST. NO. -		ILLINOIS	FED. AID PROJECT	

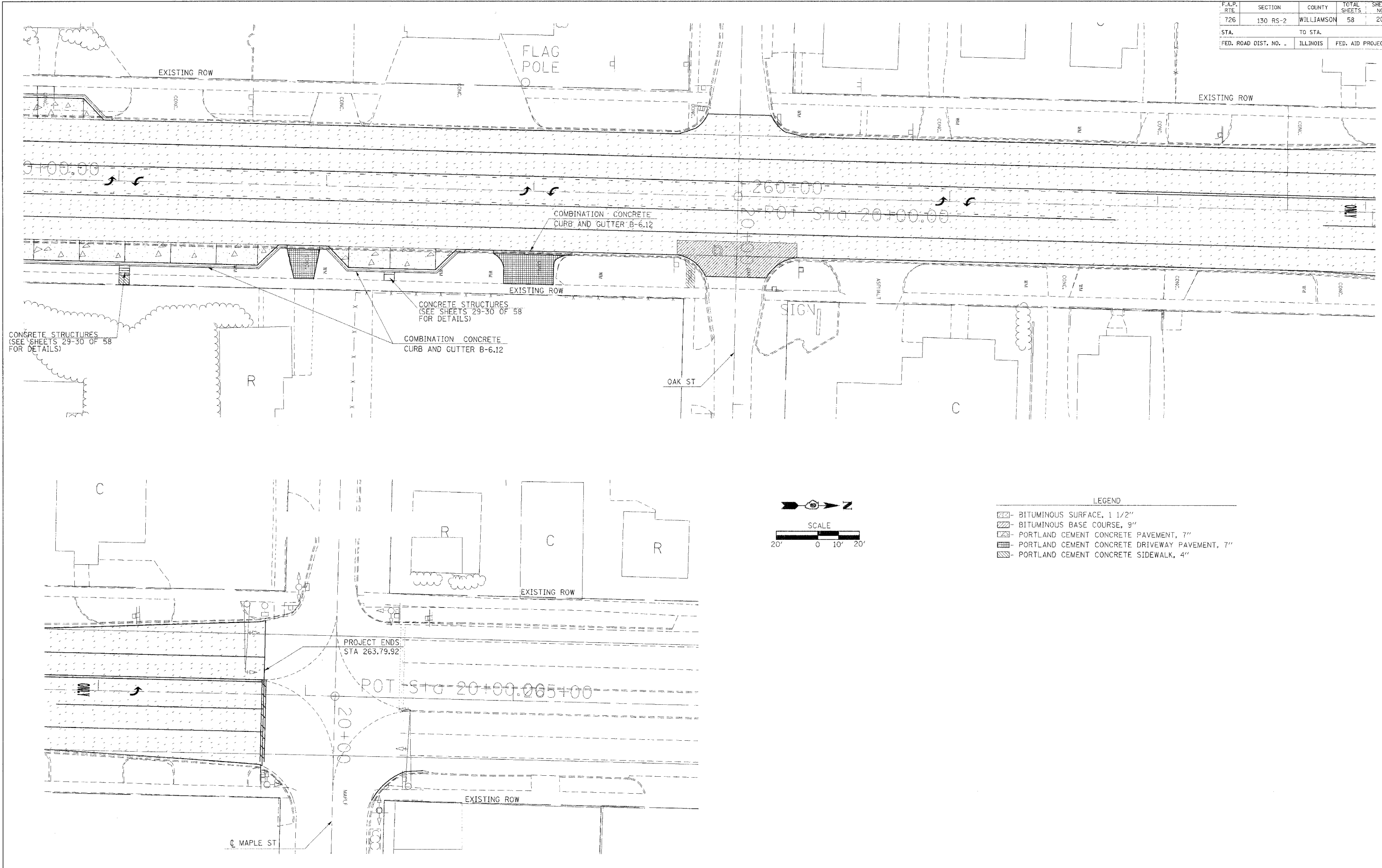

CONCRETE STRUCTURES
(SEE SHEETS 29-30 OF 58
FOR DETAILS)

CONCRETE STRUCTURES
(SEE SHEETS 29-30 OF 58
FOR DETAILS)

COMBINATION CONCRETE
CURB AND GUTTER B-6.12

COMBINATION CONCRETE
CURB AND GUTTER B-6.12

PROJECT ENDS:
STA 263.79.92'

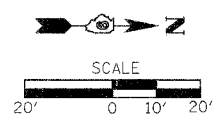

LEGEND

	BITUMINOUS SURFACE, 1 1/2"
	BITUMINOUS BASE COURSE, 9"
	PORTLAND CEMENT CONCRETE PAVEMENT, 7"
	PORTLAND CEMENT CONCRETE DRIVEWAY PAVEMENT, 7"
	PORTLAND CEMENT CONCRETE SIDEWALK, 4"

DATE = 2/16/2005
 FILE NAME = c:\pcc\projects\98912\98912-20.dwg
 PLOT SCALE = 20.00000' / 1" = 1" = 20.00000'
 USER NAME = cm-larney

PROPOSED CONSTRUCTION