

F.A.P. RTE.	SECTION	COUNTY	TOTAL SHEETS	SHEET NO.
885	104 RS-4	UNION	24	1

STATE OF ILLINOIS  
DEPARTMENT OF TRANSPORTATION  
DIVISION OF HIGHWAYS

**PROPOSED  
HIGHWAY PLANS**

FAP ROUTE 885 (ILL. ROUTE 146)  
SECTION 104 RS-4  
PROJECT: HS-0885(033)

ILLINOIS 146 AT ANNA HIGH SCHOOL  
UNION COUNTY  
C-99-035-06

FOR INDEX OF SHEETS, SEE SHEET NO. 2  
FOR SUMMARY OF QUANTITIES, SEE SHEET NO. 3

APPROACH	ADT (2004)	% TRUCKS
ILLINOIS 146	11,800	9

PROJECT LOCATION  
BEGIN STATION 0+53  
STA EQ. 0+00 BK=100+00 AH  
END STATION 104+85

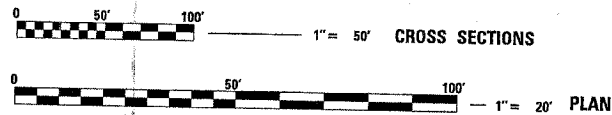
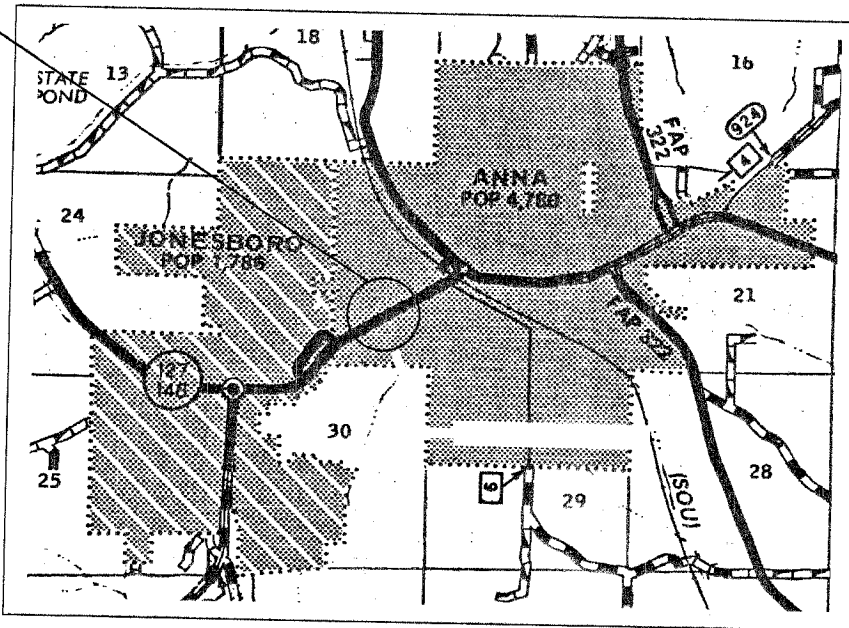

FULL SIZE PLANS HAVE BEEN PREPARED USING STANDARD ENGINEERING SCALES. REDUCED SIZED PLANS WILL NOT CONFORM TO STANDARD SCALES. IN MAKING MEASUREMENTS ON REDUCED PLANS, THE ABOVE SCALES MAY BE USED.

J.U.L.I.E.  
JOINT UTILITY LOCATION INFORMATION FOR EXCAVATION  
1-800-892-0123

ANNA TOWNSHIP  
CONTRACT NO. 98914

GROSS LENGTH OF PROJECT = 0.09 MILES  
NET LENGTH OF PROJECT = 0.09 MILES

STATE OF ILLINOIS  
DEPARTMENT OF TRANSPORTATION  
DIVISION OF HIGHWAYS

SUBMITTED Feb 9 2006  
M. C. Adams  
DEPUTY DIRECTOR OF HIGHWAYS, REGION ENGINEER

March 24 2006  
Mike New  
ENGINEER OF DESIGN AND ENVIRONMENT

March 24 2006  
Milton R. Seis  
DIRECTOR OF HIGHWAYS, CHIEF ENGINEER

**PRINTED BY THE AUTHORITY  
OF THE STATE OF ILLINOIS**

F.A.P. RTE.	SECTION	COUNTY	TOTAL SHEETS	SHEET NO.
885	104 RS-4	UNION	24	2
STA.		TO STA.		
FED. ROAD DIST. NO.	ILLINOIS	FED. AID PROJECT		

## GENERAL NOTES

THE THICKNESS OF BITUMINOUS MIXTURE SHOWN ON THE PLANS IS THE NOMINAL THICKNESS. DEVIATIONS FROM THE NOMINAL THICKNESS WILL BE PERMITTED WHEN SUCH DEVIATIONS OCCUR DUE TO IRREGULARITIES IN THE EXISTING SURFACE OR BASE ON WHICH THE BITUMINOUS MIXTURE IS PLACED.

FACTORS USED FOR ESTIMATING PLAN QUANTITIES ARE AS FOLLOWS AND SHALL NOT BE USED FOR THE BASIS OF FINAL QUANTITIES:

ALL BITUMINOUS CONCRETE	2.016 TONS/CU.YD.
ALL AGGREGATE	2.05 TONS/CU.YD.
BITUMINOUS MATERIALS:	
ON PAVEMENT	0.09 GAL./SQ.YD.
INTERMEDIATE LIFTS (FOG COAT)	0.04 GAL./SQ.YD.
ON AGGREGATE SURFACE	0.32 GAL./SQ.YD.
AGGREGATE (PRIME COAT)	0.0015 TONS/SQ.YD.

PROTECTIVE COAT SHALL BE APPLIED TO ALL PCC PAVEMENT, PCC DRIVEWAY PAVEMENT, SIDEWALKS, GUTTER FLAGS, AND FACE OF CURB AS NEEDED ACCORDING TO THE SEASONAL REQUIREMENTS OF ARTICLE 420.21.

AT ALL LOCATIONS WHERE THE PROPOSED BITUMINOUS OR CONCRETE PAVEMENT JOINS AN EXISTING BITUMINOUS OR CONCRETE PAVEMENT, A FULL DEPTH SAWED JOINT SHALL BE CONSTRUCTED. THE COST OF THIS JOINT WILL BE INCLUDED IN THE COST OF THE TYPE OF PAVEMENT BEING CONSTRUCTED.

AFTER A LIFT OF BITUMINOUS CONCRETE HAS BEEN PLACED ON A LANE, THAT LANE SHALL REMAIN CLOSED TO TRAFFIC UNTIL THE NEW MAT HAS COOLED TO 150°

FORMS FOR COMBINATION CONCRETE CURB AND GUTTER SHALL BE OF METAL ONLY. EXCEPT THAT WOOD FORMS MAY BE USED ON SHORT RADIUS CURVES.

THE EXISTING ROAD SIGNS THAT INTERFERE WITH CONSTRUCTION WILL BE REMOVED OR RELOCATED AS DIRECTED BY THE ENGINEER ACCORDING TO ARTICLE 107.25 OF THE STANDARD SPECIFICATIONS. AFTER THE CONSTRUCTION IS COMPLETED, THE CONTRACTOR WILL RE-ERECT THE SIGNS AS DIRECTED BY THE ENGINEER. THIS WORK WILL NOT BE PAID FOR SEPARATELY BUT SHALL BE CONSIDERED INCIDENTAL TO THE CONTRACT AND NO COMPENSATION WILL BE ALLOWED.

PRIOR TO PLACEMENT OF THE FINAL PAVEMENT MARKINGS THE RESIDENT ENGINEER SHOULD CONTACT THE BUREAU OF OPERATIONS AND ARRANGE FOR INSPECTION AND APPROVAL OF THE PAVEMENT MARKING LAYOUT.

THE QUANTITY OF SHORT TERM PAVEMENT MARKING SHOWN IN THE PLANS IS BASED ON ONE APPLICATION EACH FOR THE PRIME COAT, LEVELING BINDER, AND SURFACE COURSE, AT THE RATE OF 4 FEET IN 40 FEET.

UTILITIES ARE SHOWN IN ACCORDANCE WITH THE BEST AVAILABLE INFORMATION AND THEIR ACTUAL LOCATIONS ARE NOT GUARANTEED TO BE AS SHOWN IN THE PLANS.

THE EXCAVATION FOR THE PROJECT IS CLASSIFIED AS EARTH EXCAVATION IN ACCORDANCE WITH THE STANDARD SPECIFICATIONS AND AS PROVIDED IN THE CONTRACT SPECIFICATIONS. EARTH EXCAVATION SHALL INCLUDE THE REMOVAL OF EARTH AND UNCLASSIFIED MATERIALS. THE CONTRACTOR SHALL NOTIFY ALL UTILITY COMPANIES 48 HOURS PRIOR TO EXCAVATION OPERATIONS.

THERE ARE NO AVAILABLE WASTE SITES ON THE EXISTING RIGHT-OF-WAY WITHIN THE PROJECT LIMITS.

THE QUANTITY OF EROSION CONTROL BLANKET SHOWN IN THE PLANS IS ONLY AN ESTIMATE. THE ACTUAL AMOUNT USED, AND LOCATION, SHALL BE DETERMINED BY THE ENGINEER.

EARTHWORK COMPACTION SHALL BE TO THE SATISFACTION OF THE ENGINEER

QUANTITIES SHOWN IN THE PLANS FOR PATCHING ARE ESTIMATES. THE ACTUAL AMOUNT OF PATCHING REQUIRED SHALL BE DETERMINED BY THE ENGINEER.

THE CONTRACTOR SHALL STAMP STATIONING IN THE PROPOSED BITUMINOUS SURFACE AT 300 FT. INTERVALS ON ALTERNATING SIDES OF THE PAVEMENT AND AS DIRECTED BY THE ENGINEER. THE STATION SYMBOL STAMPS USED SHALL BE FURNISHED BY THE CONTRACTOR. THEY SHALL BE 5 IN. TALL, OF A DESIGN APPROVED BY THE ENGINEER, AND SHALL REMAIN THE PROPERTY OF THE CONTRACTOR.

THE USE OF VIBRATORY ROLLER SHALL BE PROHIBITED THROUGH THE CITY OF ANNA. THE CONTRACTOR MAY HAVE TO MAKE ADJUSTMENTS TO HIS ROLLING PATTERN TO OBTAIN THE REQUIRED FIELD DENSITY

REMOVAL OF BITUMINOUS MATERIAL IN GUTTER SHALL BE INCIDENTAL TO BITUMINOUS SURFACE REMOVAL 1 1/2"

SEEDING AND NUTRIENT QUANTITIES ARE INCLUDED IN THE PRICE OF EROSION CONTROL BLANKET AS DETAILED IN THE SPECIAL PROVISIONS.

AN ADDITIONAL QUANTITY OF STRIP REFLECTIVE CRACK CONTROL WAS ADDED FOR EXISTING LANE LINE CRACKS

COMMITMENTS: NONE.

## INDEX OF SHEETS

SHT NO	DESCRIPTION
1	COVER SHEET
2	GENERAL NOTES, INDEX OF SHEETS, STANDARDS
3	SUMMARY OF QUANTITIES
4-8	TYPICAL SECTIONS
9-10	SCHEDULES OF QUANTITIES
11	TIE POINTS
12	PLAN/PROFILE
13-14	PROPOSED CONSTRUCTION & REMOVAL
15	GEOMETRICS
16	PAVEMENT MARKING
17	DETAIL: SPRING STREET
18	DETAILS: ROUGH GROOVED SURFACE SIGN, UNEVEN PAVEMENT SIGN, SEEDING & MULCHING
19-24	CROSS SECTIONS IL 146

## STANDARDS

000001-04	STANDARD SYMBOLS, ABBREVIATIONS, AND PATTERNS
001006	DECIMAL OF AN INCH AND OF A FOOT
280001-02	TEMPORARY EROSION CONTROL SYSTEMS
424001-04	CURB RAMPS FOR SIDEWALKS
442201-01	CLASS C AND D PATCHES
606001-02	CONCRETE CURB TYPE B AND COMBINATION CONCRETE CURB AND GUTTER
701006-02	OFF-ROAD OPERATIONS 2L, 2W, 15' TO PAVEMENT EDGE FOR SPEED > 45 MPH
701301-02	LANE CLOSURE, 2L, 2W, SHORT TIME OPERATIONS
701306-01	LANE CLOSURE 2L, 2W SLOW MOVING OPERATIONS DAY ONLY, FOR SPEEDS > 45 MPH
701311-02	2L, 2W MOVING OPERATIONS-DAY ONLY
701501-03	URBAN LANE CLOSURE, 2L, 2W, UNDIVIDED
702001-06	TRAFFIC CONTROL DEVICES
780001-01	TYPICAL PAVEMENT MARKINGS
BLR 21-6	TYPICAL APPLICATION OF TRAFFIC CONTROL DEVICES FOR CONSTRUCTION ON RURAL LOCAL HIGHWAYS

Prepared By:	<i>Joe Zdanovics</i> DISTRICT STAFF & PLANS ENGINEER
Examined By:	<i>James W. Conroy</i> DISTRICT LAND ACQUISITION ENGINEER
Examined By:	<i>Carrie Nelson</i> DISTRICT PROGRAM DEVELOPMENT ENGINEER
Examined By:	<i>Jim Smith</i> DISTRICT OPERATIONS ENGINEER
Examined By:	<i>Frank Lee</i> DISTRICT CONSTRUCTION ENGINEER
Examined By:	<i>Bruce Weisbach</i> DISTRICT MATERIALS ENGINEER
Examined By:	<i>Walter C. James</i> DISTRICT PROJECT IMPLEMENTATION ENGINEER
Approved By:	<i>Walter C. James</i> DEPUTY DIRECTOR OF HIGHWAYS, REGION ENGINEER
	Feb 9 2010 DATE

F.A.P. RTE.	SECTION	COUNTY	TOTAL SHEETS	SHEET NO.
885	104 RS-4	UNION	24	3
STA.		TO STA.		
FED. ROAD DIST. NO.		ILLINOIS FED. AID PROJECT		

## SUMMARY OF QUANTITIES

CODE NO	ITEM	CONSTRUCTION TYPE CODE	1000-1A
		UNIT	URBAN ROADWAY HES 90% FED 10% STATE
X4066530	POLYMERIZED BITUMINOUS CONCRETE SURFACE COURSE, SUPERPAVE, MIX "D", N105	TON	190
X4066920	POLYMERIZED LEVELING BINDER (MACHINE METHOD), SUPERPAVE N105	TON	92
X4409410	BITUMINOUS SURFACE REMOVAL 2 1/4"	SQYD	2122
X7015000	CHANGEABLE MESSAGE SIGN	CAL MO	1
20200100	EARTH EXCAVATION	CUYD	91
21101645	TOPSOIL FURNISH AND PLACE, 12"	SQYD	72
25100630	EROSION CONTROL BLANKET	SQYD	102
31100300	SUB-BASE GRANULAR MATERIAL, TYPE A 4"	SQYD	416
35300400	PORTLAND CEMENT CONCRETE BASE COURSE 9"	SQYD	132
40600100	BITUMINOUS MATERIALS (PRIME COAT)	GALLON	203
40600300	AGGREGATE (PRIME COAT)	TON	4
40600990	TEMPORARY RAMP	SQYD	42
42001300	PROTECTIVE COAT	SQYD	158
42300300	PORTLAND CEMENT CONCRETE DRIVEWAY PAVEMENT, 7 INCH	SQYD	72
42400100	PORTLAND CEMENT CONCRETE SIDEWALK, 4 INCH	SOFT	90
44000100	PAVEMENT REMOVAL	SQYD	184
44000200	DRIVEWAY PAVEMENT REMOVAL	SQYD	130
44000500	COMBINATION CURB AND GUTTER REMOVAL	FOOT	72
44000600	SIDEWALK REMOVAL	SOFT	40
44201761	CLASS D PATCHES, TYPE I, 10 INCH	SQYD	85
44201769	CLASS D PATCHES, TYPE III, 10 INCH	SQYD	5
44300200	STRIP REFLECTIVE CRACK CONTROL TREATMENT	FOOT	1255
60300305	FRAMES AND LIDS TO BE ADJUSTED	EACH	3
60605000	COMBINATION CONCRETE CURB AND GUTTER, TYPE B-6. 24	FOOT	298
67000400	ENGINEER'S FIELD OFFICE, TYPE A	CAL MO	3
67100100	MOBILIZATION	L SUM	1
70100460	TRAFFIC CONTROL AND PROTECTION, STANDARD 701306	L SUM	1
70102620	TRAFFIC CONTROL AND PROTECTION, STANDARD 701501	L SUM	1
70102640	TRAFFIC CONTROL AND PROTECTION, STANDARD 701801	L SUM	1
70101830	TRAFFIC CONTROL AND PROTECTION, STANDARD BLR 21	LSUM	1
70103815	TRAFFIC CONTROL SURVEILLANCE	CAL DA	6
70300100	SHORT-TERM PAVEMENT MARKING	FOOT	167
70300210	TEMPORARY PAVEMENT MARKING - LETTERS AND SYMBOLS	SOFT	18
70300220	TEMPORARY PAVEMENT MARKING - LINE 4"	FOOT	1535
70300240	TEMPORARY PAVEMENT MARKING - LINE 6"	FOOT	68
70300260	TEMPORARY PAVEMENT MARKING - LINE 12"	FOOT	184
70301000	WORK ZONE PAVEMENT MARKING REMOVAL	SOFT	803
* 78000100	THERMOPLASTIC PAVEMENT MARKING - LETTERS AND SYMBOLS	SOFT	18
* 78000400	THERMOPLASTIC PAVEMENT MARKING - LINE 6"	FOOT	68
* 78000600	THERMOPLASTIC PAVEMENT MARKING - LINE 12"	FOOT	184
* 78001110	PAINT PAVEMENT MARKING - LINE 4"	FOOT	1535
* 78300200	RAISED REFLECTIVE PAVEMENT MARKER REMOVAL	EACH	15

\* SPECIALTY ITEMS

PLOT DATE = 2/6/2006  
 FILE NAME = c:\prow\msta\9022105\9022105.dgn  
 PLOT SCALE = 50.001 / IN.  
 USER NAME = russellr

F.A.P. RTE.	SECTION	COUNTY	TOTAL SHEETS	SHEET NO.
885	104 RS-4	UNION	24	4
STA.		TO STA.		
FED. ROAD DIST. NO.	ILLINOIS	FED. AID PROJECT		

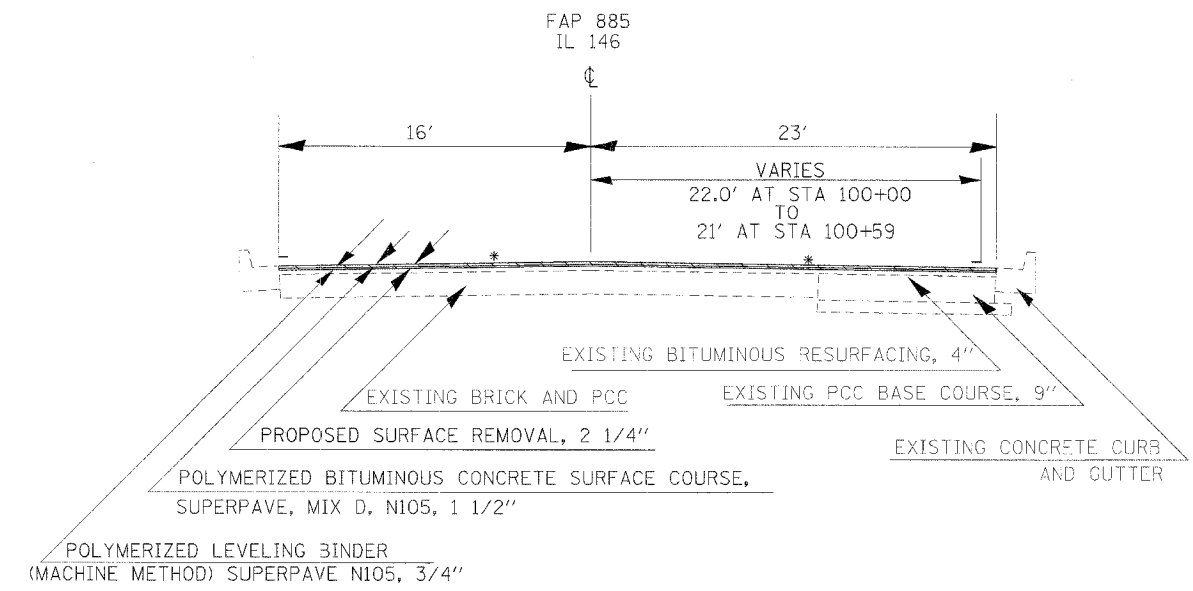

TO BE USED  
STA 100+00 TO STA 100+59

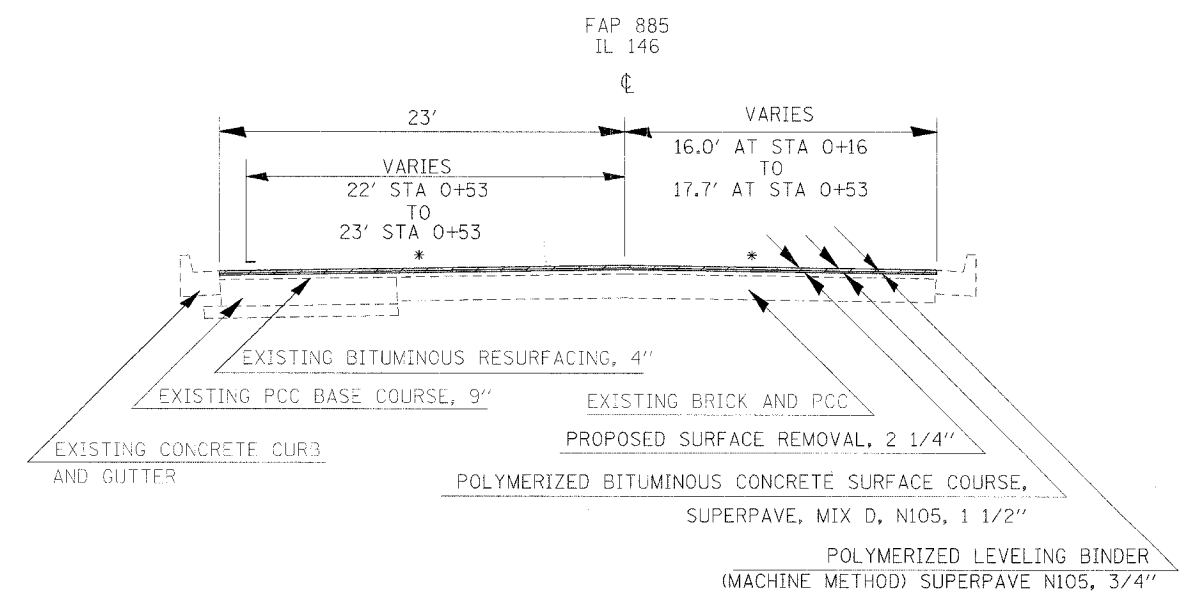

TO BE USED  
STA 0+00 TO STA 0+53

NOTE: STATION REVERSES DIRECTION AT STATION EQUATION STA 0+00 BK = STA 100+00 AH

\* MATCH EXISTING SLOPES

PLT DATE = 1/31/2006  
 FILE NAME = \\s02005\p02105\adgn  
 PLOT SCALE = 5/8" = 1' / IN.  
 USER NAME = russellof

F.A.R. RTE.	SECTION	COUNTY	TOTAL SHEETS	SHEET NO.
885	104 RS-4	UNION	24	5
STA.		TO STA.		
FED. ROAD DIST. NO.		ILLINOIS FED. AID PROJECT		

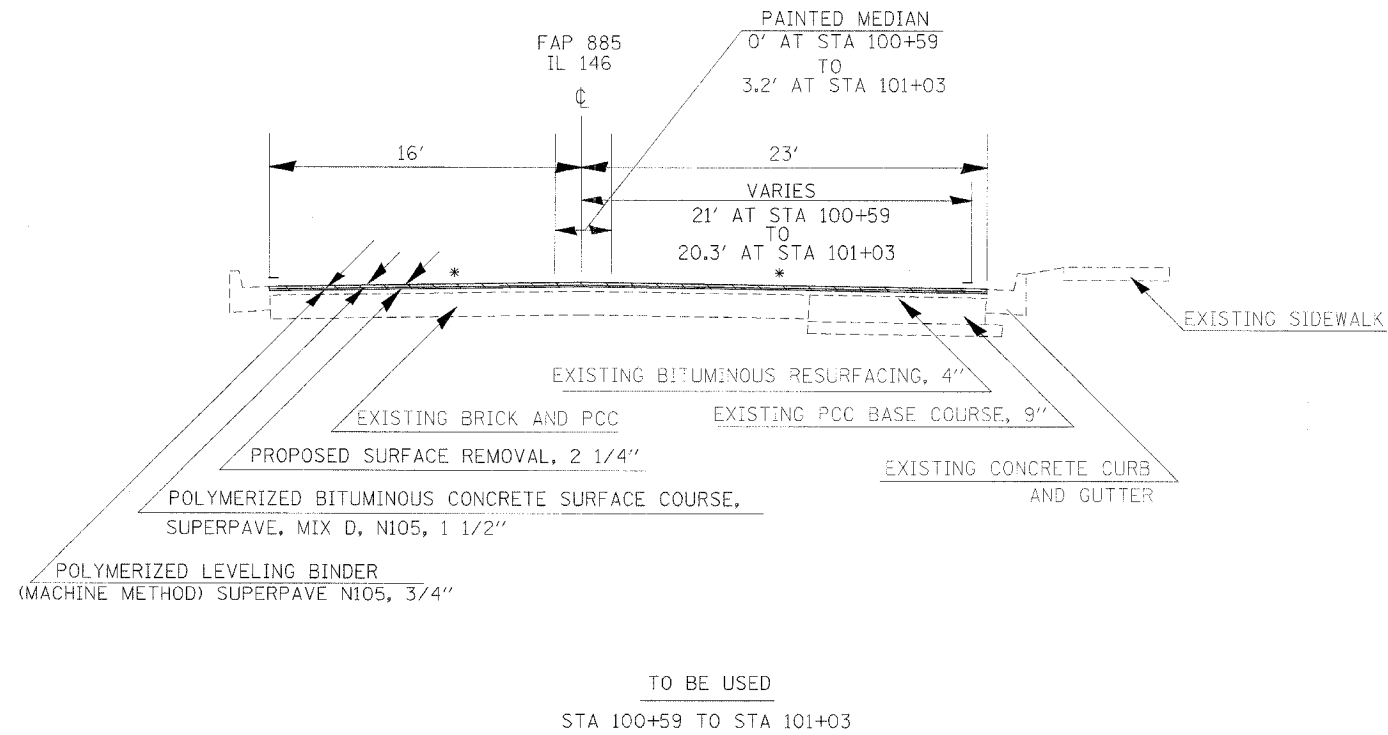
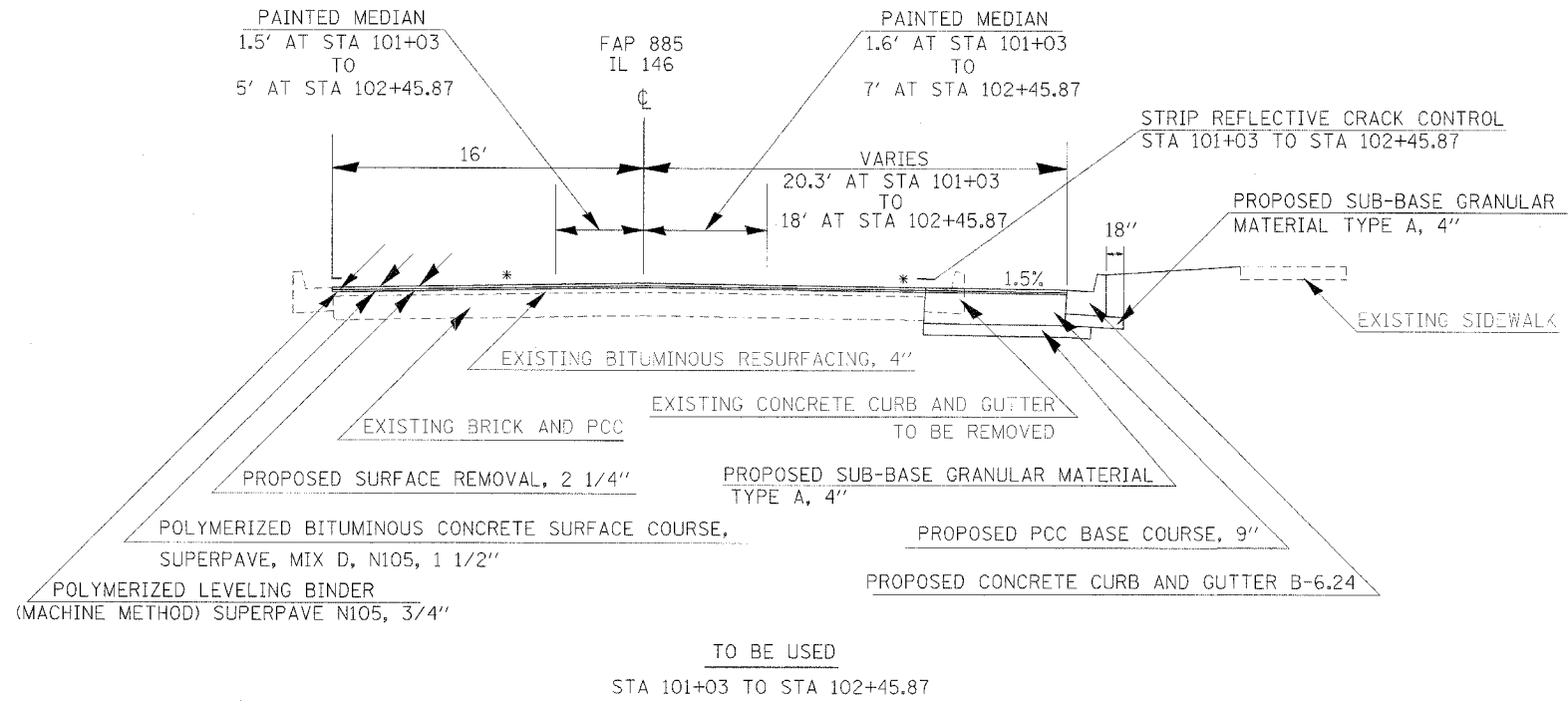

\* MATCH EXISTING SLOPES

PLOT DATE = 1/21/2006  
 FILE NAME = c:\projects\982106\982106.dwg  
 PLOT SCALE = 5.0000 / 1"  
 USER NAME = fuser101

F.A.P. RTE.	SECTION	COUNTY	TOTAL SHEETS	SHEET NO.
885	104 RS-4	UNION	24	6
STA.		TO STA.		
FED. ROAD DIST. NO.		ILLINOIS	FED. AID PROJECT	

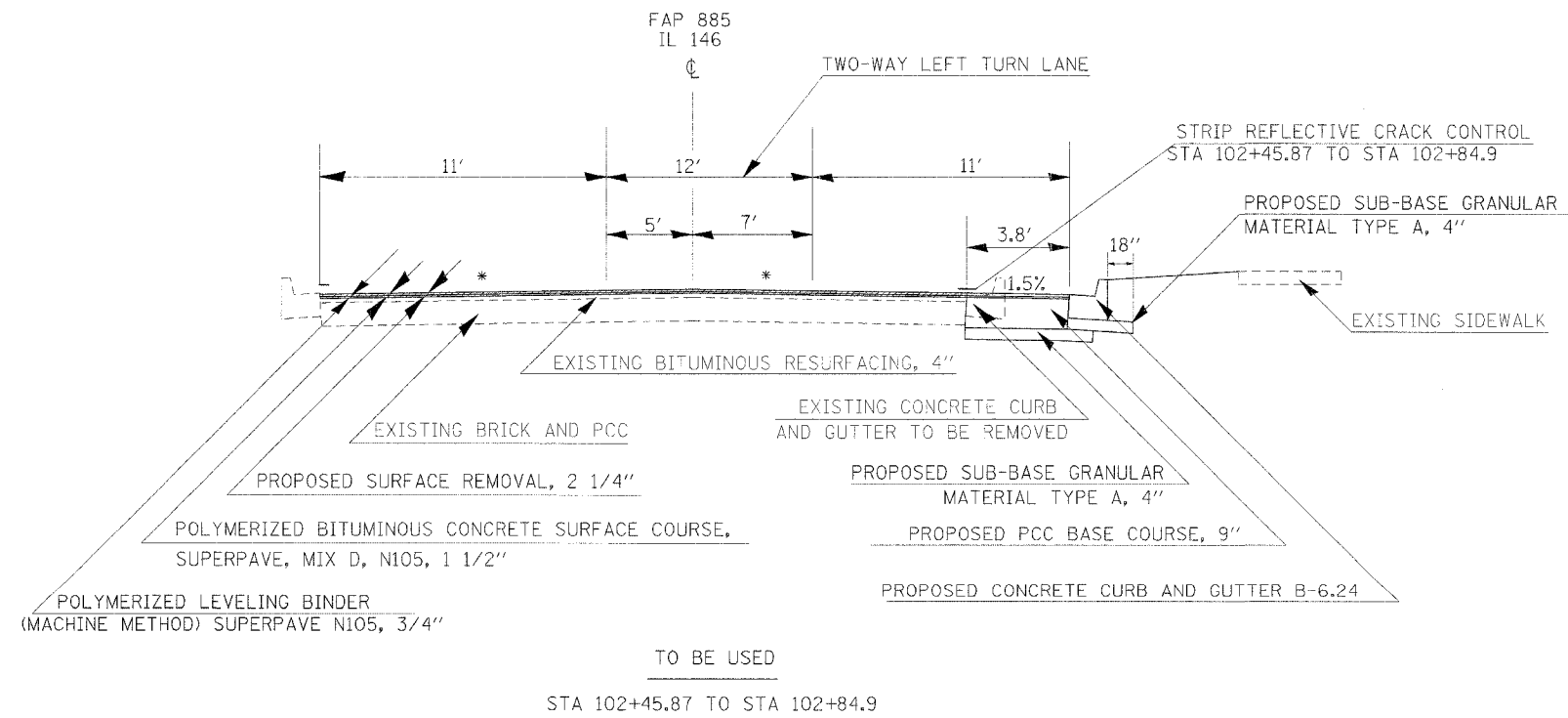
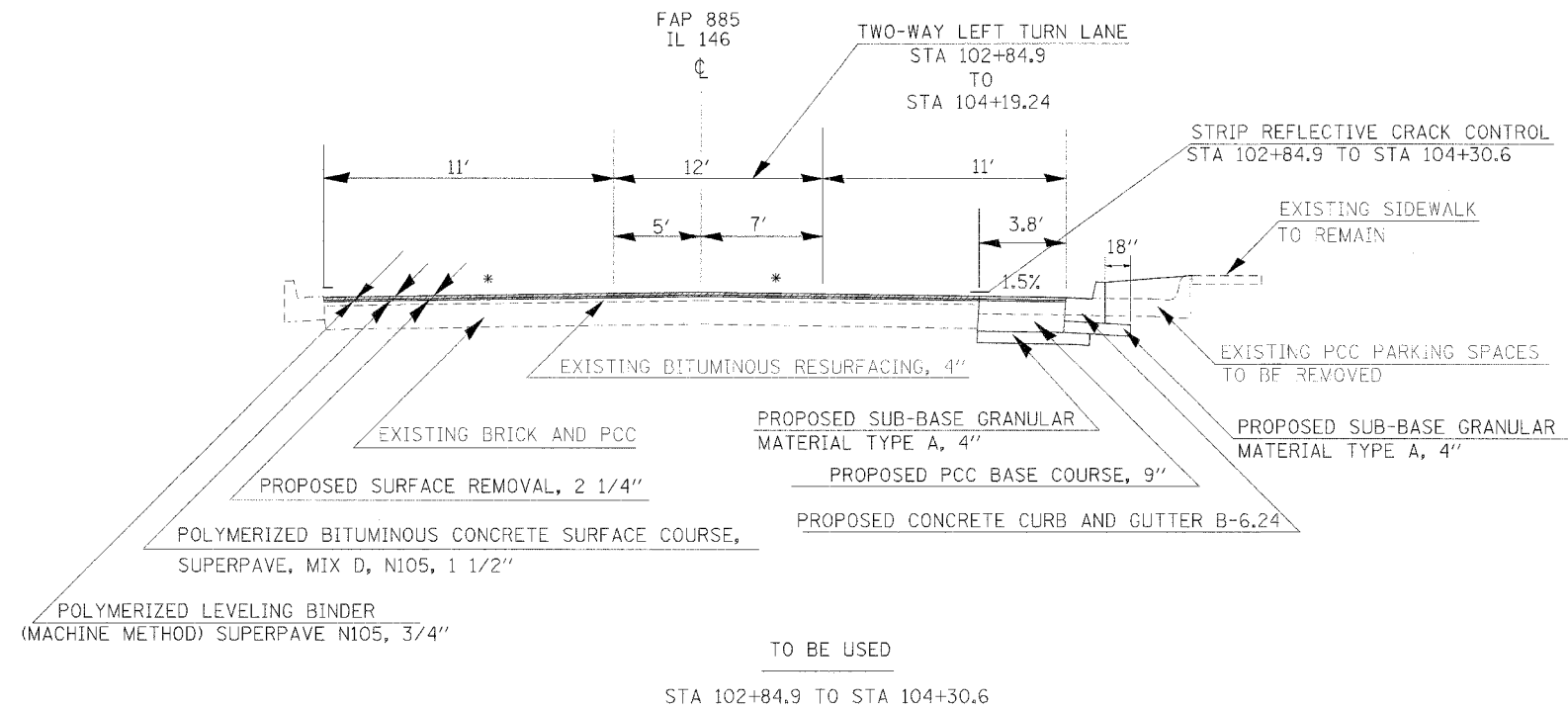

\* MATCH EXISTING SLOPES

PLOT DATE = 1/31/2006  
 FILE NAME = c:\projevs\98914\105\_d982105.dgn  
 USER NAME = rns0110f

F.A.P. RTE.	SECTION	COUNTY	TOTAL SHEET SHEETS	SHEET NO.
885	104 RS-4	UNION	24	7
STA.			TO STA.	
FED. ROAD DIST. NO.	ILLINOIS	FED. AID PROJECT		

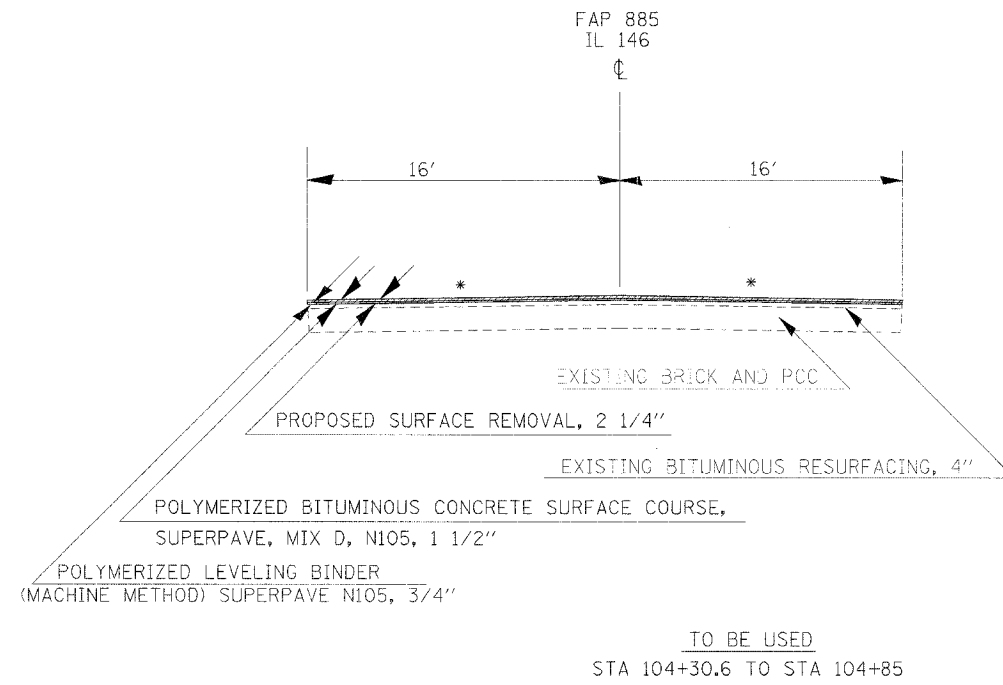

\* MATCH EXISTING SLOPES

PLOT DATE = 1/24/2006  
FILE NAME = C:\pcc\cadd\104RS4\104RS4.dgn  
PLOT SCALE = 5.00000' / IN.  
USER NAME = pmas10f

F.A.P. RTE.	SECTION	COUNTY	TOTAL SHEETS	SHEET NO.
885	104 RS-4	UNION	24	8
STA.		TO STA.		
FED. ROAD DIST. NO.	ILLINOIS	FED. AID PROJECT		

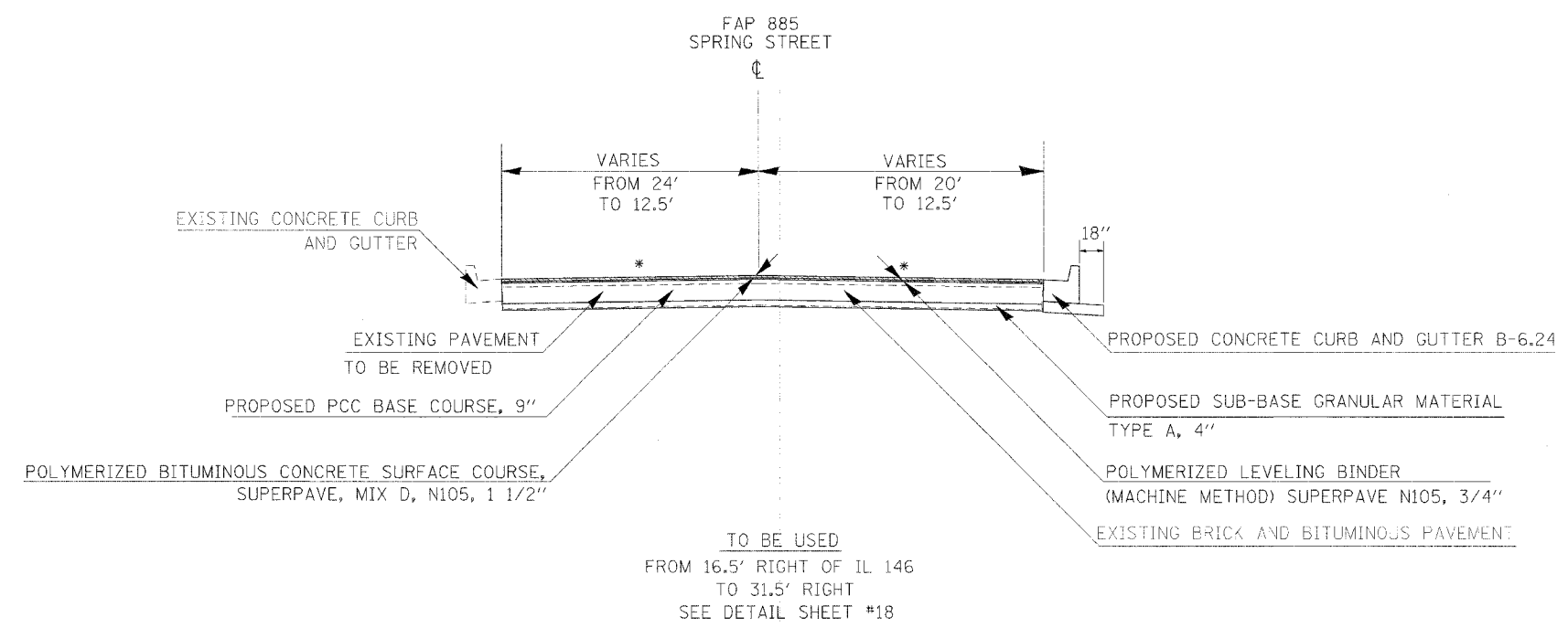

\* MATCH EXISTING SLOPES

**TYPICALS - SPRING STREET**

PLOT DATE = 1/31/2006  
 FILE NAME = c:\p\proj\p05\982105\982105.dwg  
 USER = r30000 / IN.  
 USER NAME = r30000



F.A.P. RTE.	SECTION	COUNTY	TOTAL SHEETS	SHEET NO.
885	104 RS-4	UNION	24	9
STA.		TO STA.		
FED. ROAD DIST. NO.	ILLINOIS	FED. AID PROJECT		

### PAVEMENT SCHEDULE

LOCATION STATION TO STATION	POLYMERIZED BITUMINOUS SURFACE COURSE, SUPERPAVE, MIX D, N105, 1-1/2"	PCC BASE COURSE, 9"	POLYMERIZED LEVELING BINDER (MACHINE METHOD), SUPERPAVE N105	SUB-BASE GRANULAR MATERIAL TYPE A, 4"	AGGREGATE PRIME COAT	BIT. MATERIAL PRIME COAT	TEMP RAMP	PCC DRIVEWAY PAVEMENT 7"	PCC SIDEWALK, 4"	PROTECTIVE COAT
	TON	SQYD	TON	SQYD	TON	TON	SQYD	SQYD	SQFT	SQYD
STA 0+00 TO STA 0+53	20		10		1	21				
STA 0+48 TO STA 0+53							23			
STA 100+00 TO STA 104+85	166		80		2	178				
STA 101+00 TO STA 104+50 (RIGHT)		90		144						
STA 101+23(RIGHT)				24				24		24
STA 102+55(RIGHT)				52				36		36
STA 103+44(RIGHT)				18				12		12
104+22 (LEFT)									52	
104+22 (RIGHT)									38	
STA 104+80 TO STA 104+85							19			
SPRING STREET	4	42	2	42	1	4				
<b>TOTALS</b>	<b>190</b>	<b>132</b>	<b>92</b>	<b>280</b>	<b>4</b>	<b>203</b>	<b>42</b>	<b>72</b>	<b>90</b>	<b>72</b>

### PAVEMENT MARKING SCHEDULE

LOCATION STATION TO STATION	PAINT 4 INCH			THERMOPLASTIC		LETTERS AND SYMBOLS SQ FT
	WHITE	YELLOW	DOUBLE YELLOW	6 INCH WHITE	12 INCH YELLOW	
	FOOT	FOOT	FOOT	FOOT	FOOT	
STA 0+00 TO STA 0+53 (EDGE LINE)	53					
STA 0+00 TO STA 0+53 (DOUBLE YELLOW)			53			
STA 100+00 TO STA 101+03 (EDGE LINE)	103					
STA 100+00 TO STA 100+59 (DOUBLE YELLOW)			59			
STA 100+59 TO STA 102+46(LT TAPER)			146		184	
STA 100+59 TO STA 102+46(RT TAPER)			187			
STA 102+05 TO STA 104+19(LT)		215				
STA 102+05 TO STA 104+19(LT SKIP DASH)		51				
STA 102+46 TO STA 104+19(RT)		174				
STA 102+46 TO STA 104+19(RT SKIP DASH)		49				
STA 103+25(TWO-WAY LEFT TURN ARROWS)						18
STA 104+19(CROSSWALK)				68		
<b>SUBTOTAL</b>	<b>156</b>	<b>489</b>	<b>890</b>	<b>68</b>	<b>184</b>	<b>18</b>
<b>TOTAL</b>		<b>1535</b>		<b>68</b>	<b>184</b>	<b>18</b>

PLOT DATE = 2/6/2006  
 FILE NAME = c:\prowork\98914\98914.dwg  
 PLOT SCALE = 50:1  
 USER NAME = puser101

F.A.P. RTE.	SECTION	COUNTY	TOTAL SHEETS	SHEET NO.
885	104 RS-4	UNION	24	10
STA.		TO STA.		
FED. ROAD DIST. NO.	ILLINOIS	FED. AID PROJECT		

### REMOVAL SCHEDULE

LOCATION STATION TO STATION	BITUMINOUS SURFACE REMOVAL 2-1/4"	PAVEMENT REMOVAL	COMBINATION CURB AND GUTTER REMOVAL	DRIVEWAY PAVEMENT REMOVAL	SIDEWALK REMOVAL
	SQ YD	SQ YD	FOOT	SQYD	SQFT
STA 0+00 TO STA 0+53	233				
STA 100+00 TO STA 104+85	1889				
STA 101+23(RIGHT)				44	
STA 101+49 TO STA 102+21(RIGHT)			72		
STA 102+55(RIGHT)				62	
STA 102+85 TO STA 103+33(RIGHT)		51			
STA 103+44(RIGHT)				24	
STA 103+54 TO STA 104+38(RIGHT)		86			
STA 104+22 (LEFT)					40
SPRING STREET		47			
TOTALS	2122	184	72	130	40

### DRAINAGE SCHEDULE

LOCATION STATION TO STATION	COMBINATION CONCRETE CURB & GUTTER TYPE B-6.24	SUB-BASE GRANULAR MATERIAL TYPE A	FRAMES AND LIDS TO BE ADJUSTED	PROTECTIVE COAT
	FOOT	SQYD	EACH	SQYD
STA 101+47 TO STA 104+39(RIGHT)	298	136		86
STA 100+17 11' RIGHT			1	
STA 101+46 11' RIGHT			1	
STA 104+18 8' LEFT			1	
TOTALS	298	136	3	86

### EARTHWORK AND EROSION CONTROL SCHEDULE

LOCATION STATION TO STATION	EARTH EXCAVATION	EXCAVATION TO BE USED IN EMBANKMENT ADJUSTED FOR SHRINKAGE	EMBANKMENT	EARTHWORK BALANCE WASTE (+) OR SHORTAGE (-)	EROSION CONTROL BLANKET	TOPSOIL FURNISH AND PLACE, 12"	COMMENTS
	CU YD	CU YD	CU YD	CU YD	SQYD	SQYD	
STA 101+00 TO STA 104+50	91	68	5	63			
STA 101+47 TO STA 102+22					30		
STA 102+85 TO STA 103+33						28	
STA 102+85 TO STA 104+39					72		
STA 103+55 TO STA 104+37						44	
TOTALS	91			63	102	72	

SHRINKAGE FACTOR: EARTH EXCAVATION 25%

PLOT DATE = 2/6/2006  
 FILE NAME = c:\pwc\pwc\98914\98914.dwg  
 PLOT SCALE = 1/8" = 1' / IN.  
 USER NAME = pwc\pwc

F.A.P. RTE.	SECTION	COUNTY	TOTAL SHEETS	SHEET NO.
885	104 RS-4	UNION	24	11
STA.		TO STA.		
FED. ROAD DIST. NO.	ILLINOIS	FED. AID PROJECT		

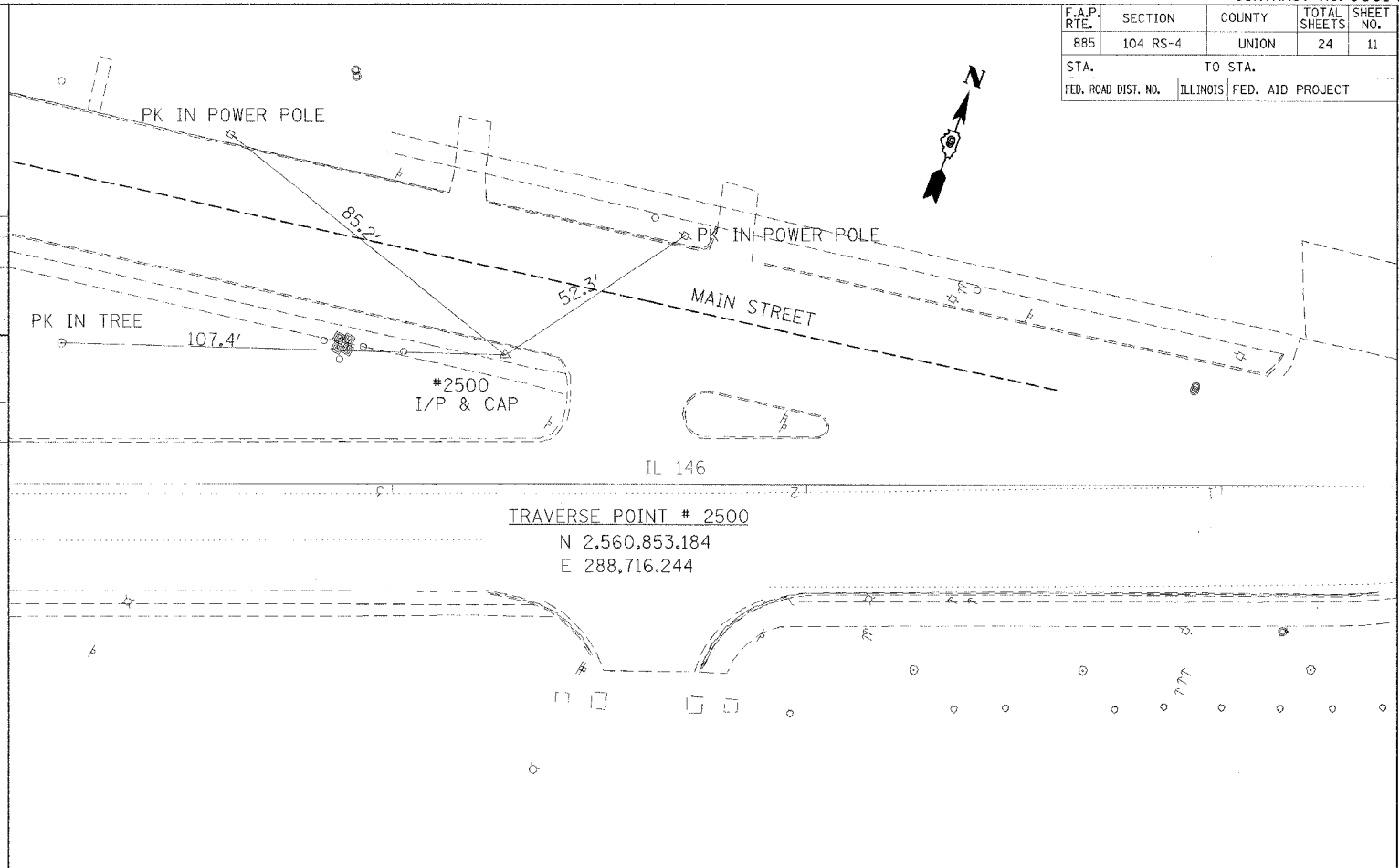
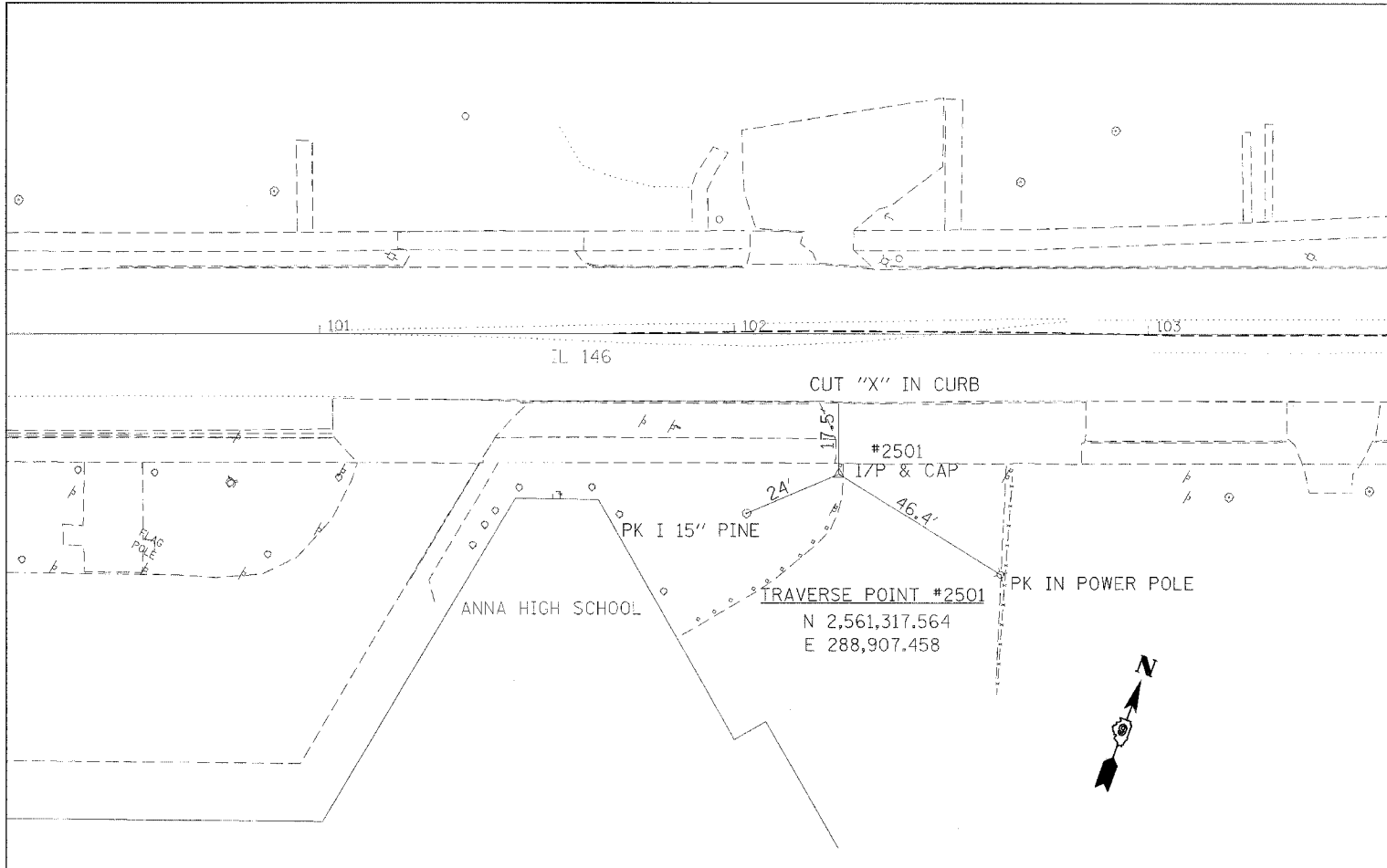

PLOT DATE = 2/6/2008  
 FILE NAME = \\jag02085\proj\2008\104\104.dgn  
 PLOT SCALE = 22.00000 / IN.  
 USER NAME = rmas10c

F.A.P. RTE.	SECTION	COUNTY	TOTAL SHEETS	SHEET NO.
885	104 RS-4	UNION	24	12
STA.		TO STA.		
FED. ROAD DIST. NO.		ILLINOIS		FED. AID PROJECT

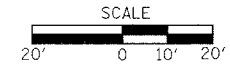

PLAN	DATE
SURVEYED	
ALIGNED	
CHECKED	
NO. _____	
DATE	

PROFILE	DATE
SURVEYED	
GRADES CHECKED	
STRUCTURE NOTATIONS C/D	
NO. _____	
DATE	

PLOT DATE = 2/6/2006  
 FILE NAME = c:\p0\jessy\98914\98914.dwg  
 USER NAME = jessy

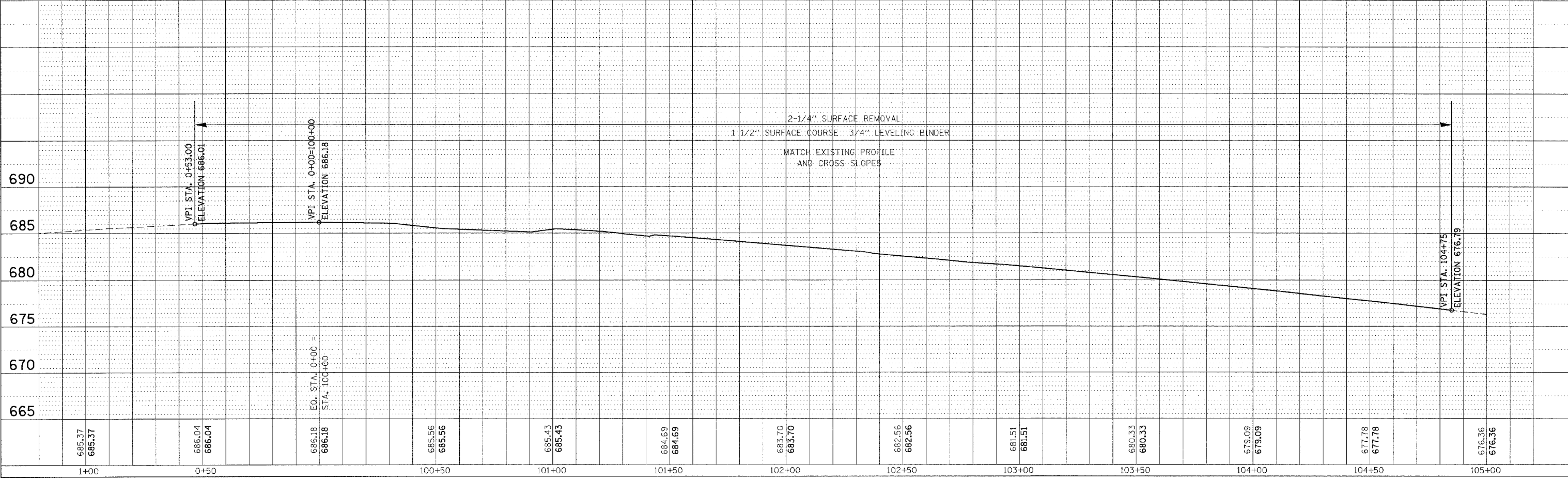
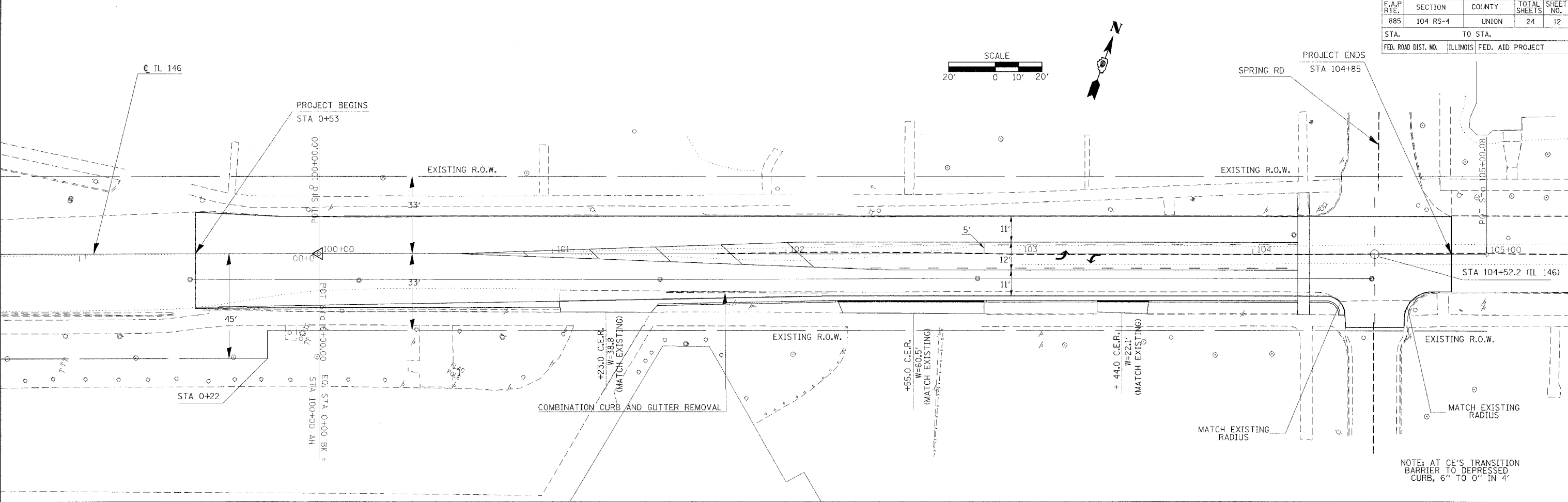



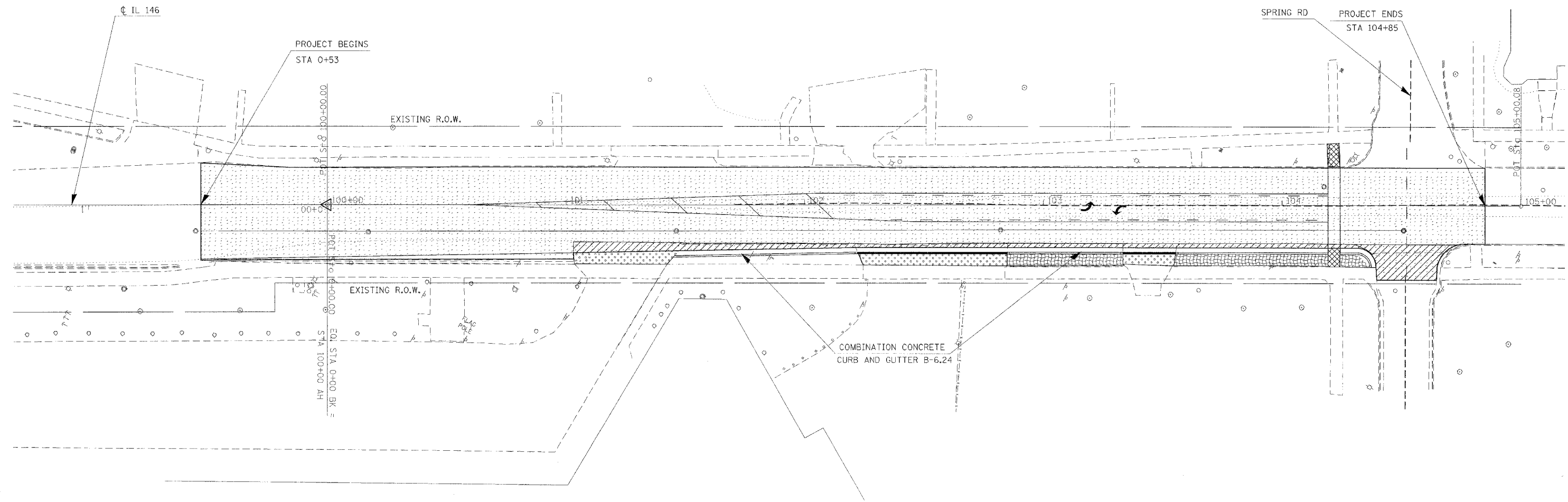
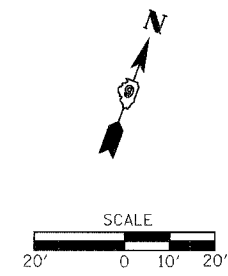

PLAN PROFILE IL 146

F.A.P. RTE.	SECTION	COUNTY	TOTAL SHEETS	SHEET NO.
885	104 RS-4	UNION	24	13
STA.		TO STA.		
FED. ROAD DIST. NO.		ILLINOIS	FED. AID PROJECT	



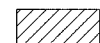

PROPOSED RIGHT EDGE OF PAVEMENT					
STATION	OFFSET	ELEVATION	STATION	OFFSET	ELEVATION
101+25	19.9'	684.49	103+00	18.0'	680.98
101+50	19.4'	684.16	103+25	18.0'	680.34
101+75	18.9'	683.65	103+50	18.0'	679.64
102+00	18.4'	683.16	103+75	18.0'	679.01
102+25	18.0'	682.64	104+00	18.0'	678.43
102+50	18.0'	682.09	104+25	18.0'	677.78
102+75	18.0'	681.54	104+50	18.0'	677.28

-  - PORTLAND CEMENT CONCRETE SIDEWALK, 4"
-  - TOPSOIL FURNISH AND PLACE, 12"
-  - BITUMINOUS SURFACE COURSE, 1 1/2" LEVELING BINDER, 3/4"
-  - PCC BASE COURSE, 9"
-  - PCC DRIVEWAY PAVEMENT

PLOT DATE = 2/6/2006  
 FILE NAME = c:\proweb\98914\98914.dwg  
 PLOT SCALE = 28.0000 / IN.  
 USER NAME = pmasst1cf

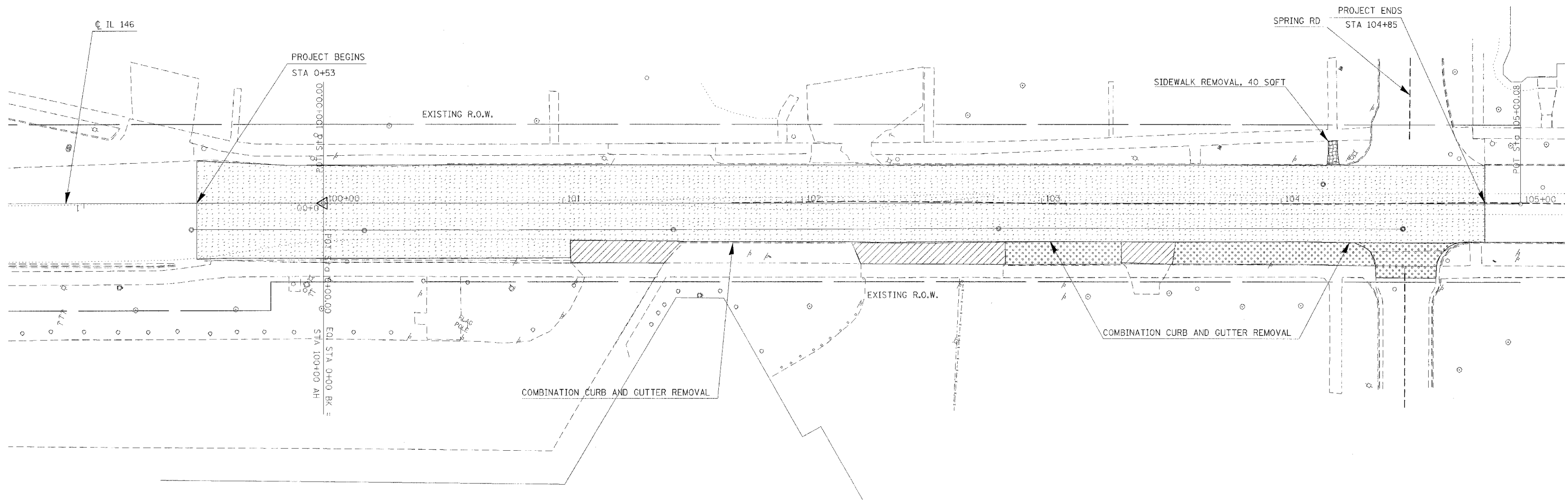
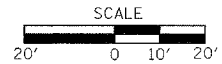
F.A.P. RTE.	SECTION	COUNTY	TOTAL SHEETS	SHEET NO.
885	104 RS-4	UNION	24	14
STA.		TO STA.		
FED. ROAD DIST. NO.	ILLINOIS	FED. AID PROJECT		

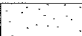
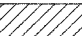

-  - BITUMINOUS SURFACE REMOVAL, 2 1/4"
-  - DRIVEWAY PAVEMENT REMOVAL
-  - PAVEMENT REMOVAL

PLOT DATE = 2/6/2006  
 FILE NAME = c:\p\proj\sta\98914\98914.dgn  
 PLOT SCALE = 20:8000 / IN.  
 USER NAME = rpsand107

F.A.P. RTE.	SECTION	COUNTY	TOTAL SHEETS	SHEET NO.
885	104 RS-4	UNION	24	15
STA.		TO STA.		
FED. ROAD DIST. NO.	ILLINOIS	FED. AID PROJECT		

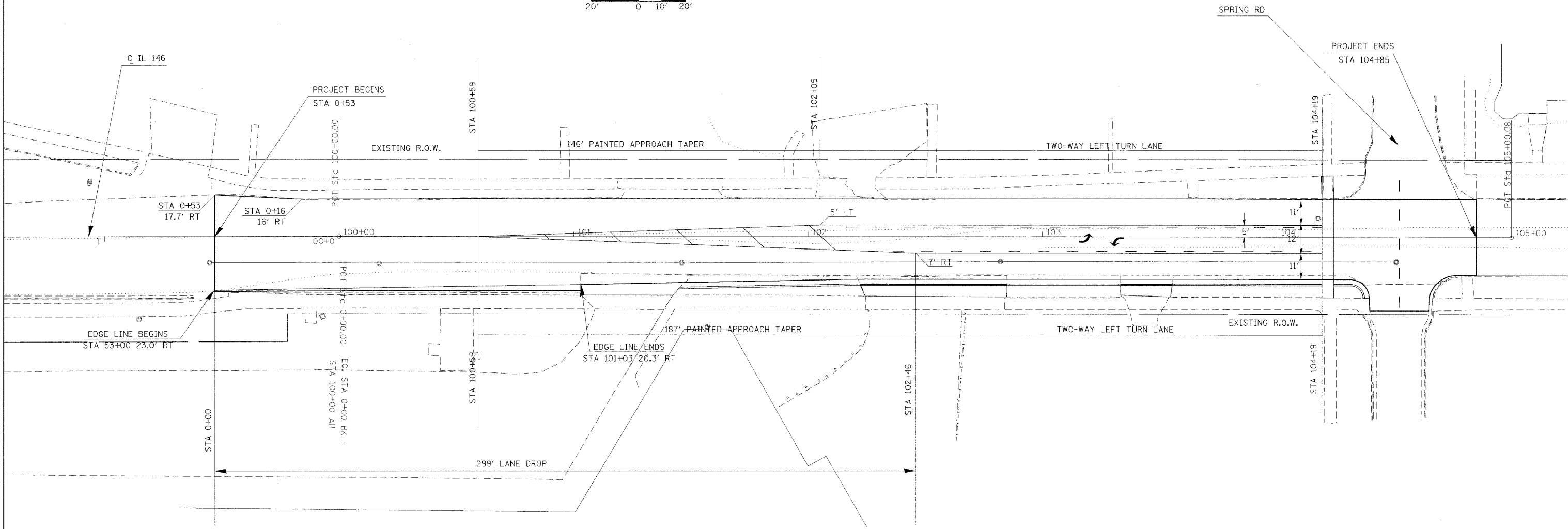
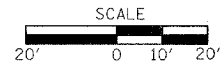

PLOT DATE = 2/6/2006  
 FILE NAME = \\s1922\05\982105\982105.dwg  
 PLOT SCALE = 28.000000 / IN.  
 USER NAME = ruse11of

F.A.P. RTE.	SECTION	COUNTY	TOTAL SHEETS	SHEET NO.
885	104 RS-4	UNION	24	16
STA.		TO STA.		
FED. ROAD DIST. NO.		ILLINOIS	FED. AID PROJECT	

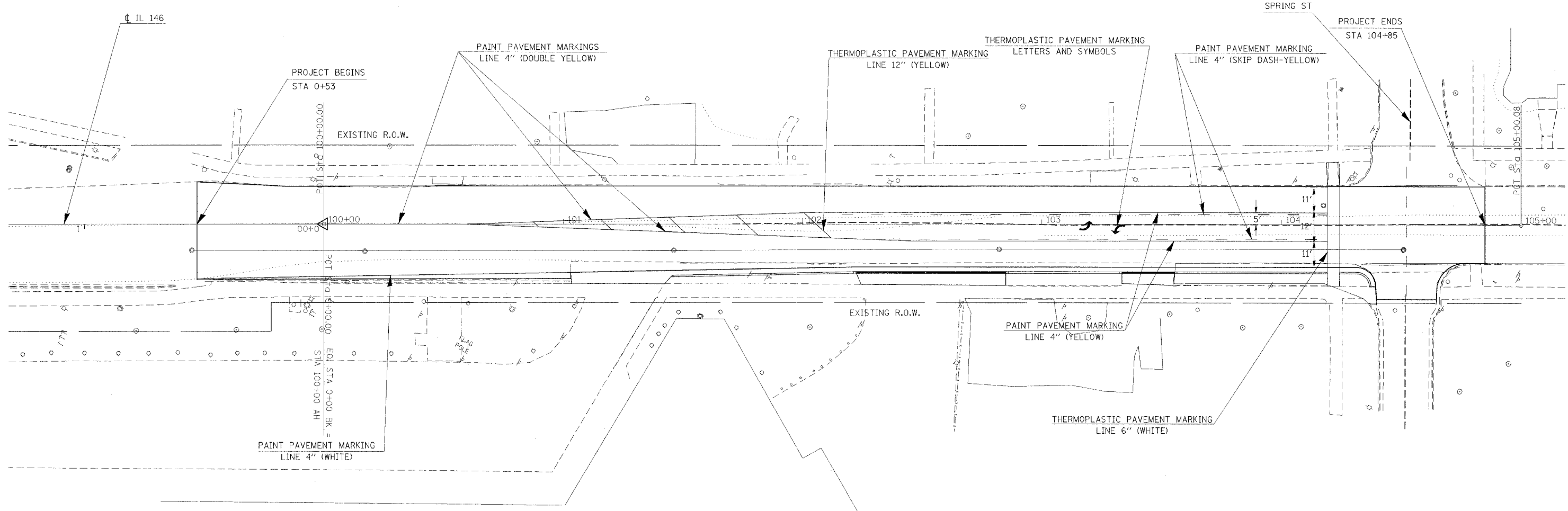
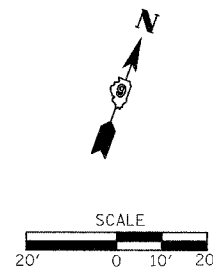

PLOT DATE = 2/6/2006  
 FILE NAME = c:\p\proj\98914\98914.dgn  
 PLOT SCALE = 28.0000 / IN  
 USER NAME = rmasstor



F.A.P. RTE.	SECTION	COUNTY	TOTAL SHEETS	SHEET NO.
885	104 RS-4	UNION	24	17
STA.		TO STA.		
FED. ROAD DIST. NO.	ILLINOIS	FED. AID PROJECT		

NOT TO SCALE

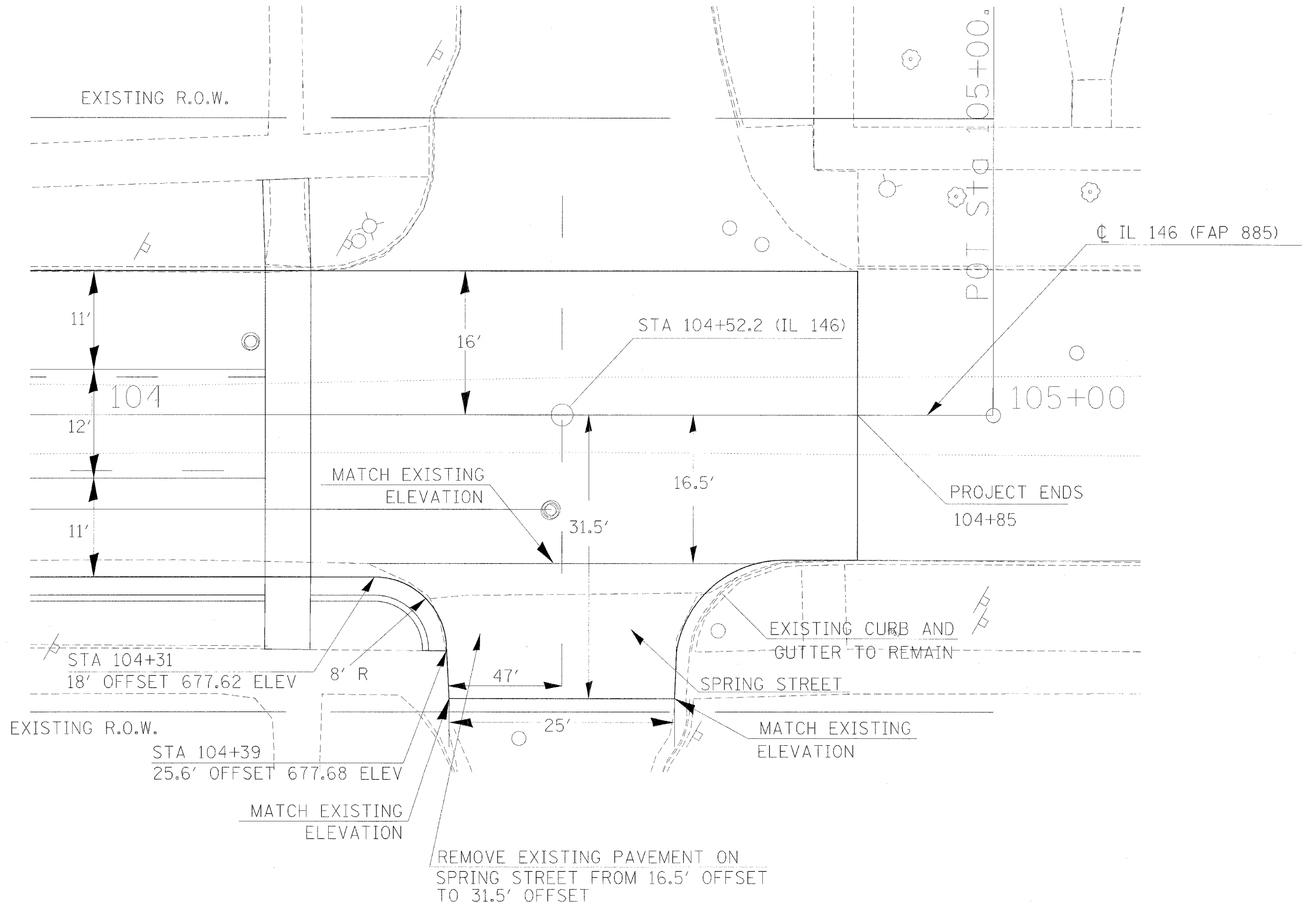

PLOT DATE = 2/6/2006  
 FILE NAME = C:\Users\muse1\Documents\1042105\1042105.dwg  
 PLOT SCALE = 20.0000 / 1" = 1'-0"  
 USER NAME = muse1

F.A.P. RTE.	SECTION	COUNTY	TOTAL SHEETS	SHEET NO.
885	104 RS-4	UNION	24	18
STA.		TO STA.		
FED. ROAD DIST. NO.		ILLINOIS	FED. AID PROJECT	

**ILLINOIS STANDARD  
W8-I106**

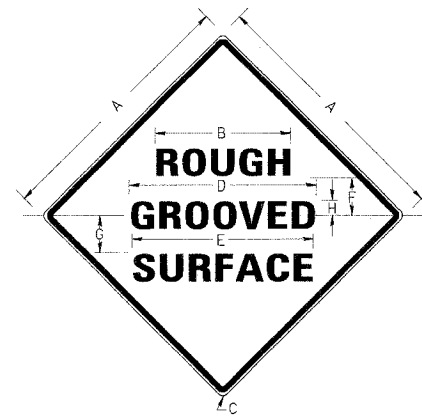

**COLORS:**  
LEGEND AND BORDER BLACK NON-REFLECTORIZED  
BACKGROUND ORANGE REFLECTORIZED

SIGN SIZE	DIMENSIONS							
	A	B	C	D	E	F	G	H
48X48	48.0	24.1	3.0	34.0	33.0	6.0	13.0	3.5

SIGN SIZE	SERIES LINES			MAR-GIN	BOR-DER	BLANK STD.
	1	2	3			
48X48	7C	7C	7C	0.8	1.2	B4-48D

ALL DIMENSIONS IN INCHES

NOTE: PRIOR TO ALLOWING TRAFFIC ON ANY PORTION OF THE ROADWAY THAT HAS BEEN COLDMILLED, THE CONTRACTOR SHALL HAVE ERECTED "ROUGH GROOVED SURFACE" SIGNS THAT CONFORM TO THE ABOVE DETAILS. A MINIMUM OF ONE SIGN AT EACH END OF THE IMPROVEMENT WILL BE REQUIRED. THE CONTRACTOR SHALL MAINTAIN THE "ROUGH GROOVED SURFACE" SIGNS UNTIL THE COLDMILLED SURFACE IS COVERED WITH LEVELING BINDER OR SURFACE COURSE.

IF AT ANY TIME THE SIGNS ARE IN PLACE BUT NOT APPLICABLE, THEY SHALL BE TURNED FROM THE VIEW OF MOTORISTS OR COVERED AS DIRECTED BY THE ENGINEER.

THE COST OF FURNISHING, ERECTING, MAINTAINING, AND REMOVING THE REQUIRED SIGNS SHALL BE INCLUDED IN THE CONTRACT.

REVISIONS

REDRAWN	2-15-89
REVISED	4-6-93

STD 9-39

**SEEDING & MULCHING**

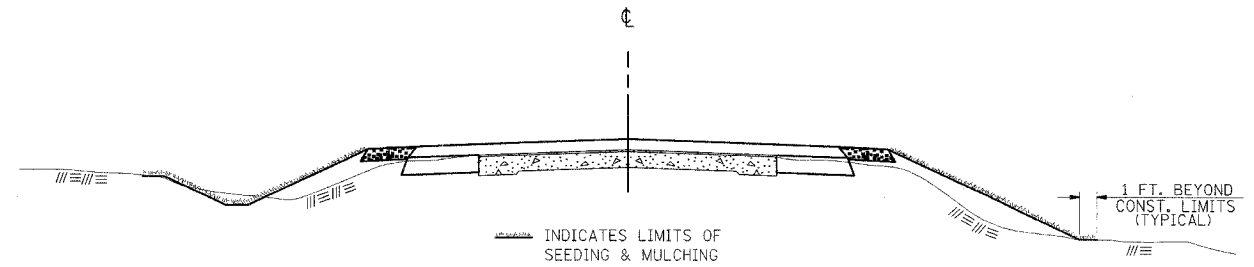

**GENERAL NOTES**

IN GENERAL, ALL EARTH SURFACES DISTURBED DURING CONSTRUCTION OPERATIONS SHALL BE SEEDED AND MULCHED UPON COMPLETION OF ALL GRADING OPERATIONS.

FERTILIZER NUTRIENTS AND LIMESTONE SHALL BE APPLIED TO ALL SEEDED AREAS.

THE RATES OF APPLICATION OF FERTILIZER, MULCH AND LIMESTONE SHALL BE AS SPECIFIED IN THE SPECIAL PROVISIONS.

SECTIONS 250 AND 251 OF THE STANDARD SPECIFICATIONS SHALL GOVERN THIS WORK EXCEPT AS SPECIFIED HEREIN OR AS NOTED IN THE SPECIAL PROVISIONS.

REVISIONS

REDRAWN	2-15-89
REVISED	8-15-94
CHECKED	6-3-99

STD. 9-12

**UNEVEN PAVEMENT SIGN  
W8-9a-(0)-48**

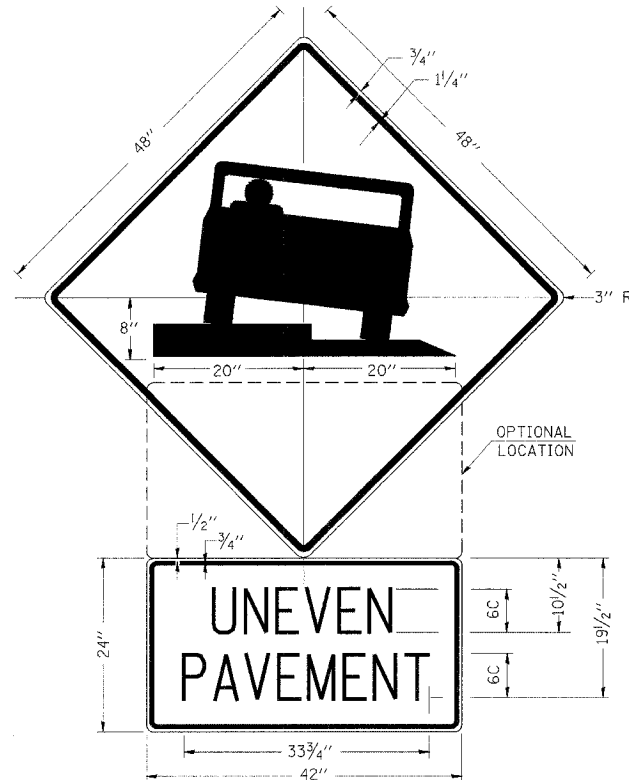

**COLORS:**  
LEGEND AND BORDER - BLACK NON-REFLECTORIZED  
BACKGROUND - ORANGE REFLECTORIZED

NOTE: PRIOR TO ALLOWING TRAFFIC ON ANY PORTION OF THE ROADWAY THAT HAS BEEN COLDMILLED OR BEFORE RESURFACING OPERATIONS BEGIN, THE CONTRACTOR SHALL HAVE ERECTED "UNEVEN PAVEMENT" SIGNS THAT CONFORM TO THE ABOVE DETAILS. A MINIMUM OF ONE SIGN AT EACH END OF THE IMPROVEMENT WILL BE REQUIRED. THE CONTRACTOR SHALL MAINTAIN THE "UNEVEN PAVEMENT" SIGNS UNTIL THE RESURFACING OPERATIONS ARE COMPLETED.

IF AT ANY TIME THE SIGNS ARE IN PLACE BUT NOT APPLICABLE, THEY SHALL BE TURNED FROM THE VIEW OF MOTORISTS OR COVERED AS DIRECTED BY THE ENGINEER.

THE COST OF FURNISHING, ERECTING, MAINTAINING, AND REMOVING THE REQUIRED SIGNS SHALL BE INCLUDED IN THE CONTRACT.

REVISIONS

DRAWN	2-15-89
REVISED	4-6-93

STD 9-41

F.A.P. RTE.	SECTION	COUNTY	TOTAL SHEETS	SHEET NO.
885	104 RS-4	UNION	24	19
STA. +00.00 TO STA. +75.00				
FED. ROAD DIST. NO.	ILLINOIS	FED. AID PROJECT		

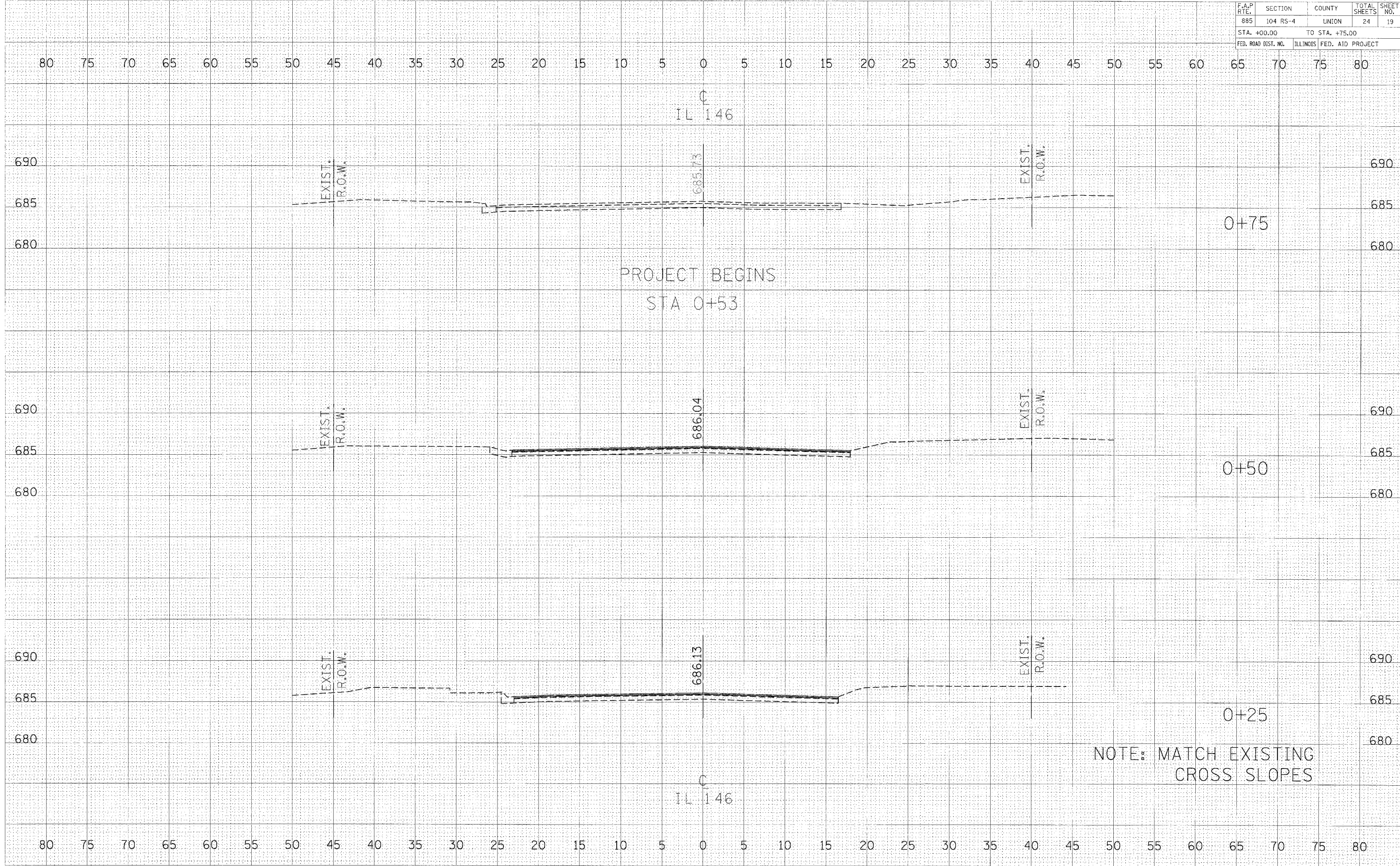

**CROSS SECTIONS - ILLINOIS 146**

FINI	DATE
BY	
CHECKED	
DATE	
BY	
DATE	

ORIGINAL	DATE
BY	
CHECKED	
DATE	
BY	
DATE	

PLOT DATE = 1/31/2006  
 FILE NAME = c:\p1\proj\104\rs\146\cross\csec.dgn  
 USER NAME = p1043121

F.A.P. RTE.	SECTION	COUNTY	TOTAL SHEET SHEETS, NO.
885	104 RS-4	UNION	24 20
STA. 100+00.00		TO STA. 100+75.00	
FED. ROAD DIST. NO.	ILLINOIS	FED. AID PROJECT	

FINAL SURVEY	APPROVED	BY	DATE
NOTE BOOK NO.	DATE		
NO.	AREAS CHECKED		

ORIGINAL SURVEY	APPROVED	BY	DATE
NOTE BOOK NO.	DATE		
NO.	AREAS CHECKED		

PLOT DATE = 1/31/2006  
 FILE NAME = c:\p01\p01\146\146.dgn  
 USER NAME = jk  
 USER NAME = jk

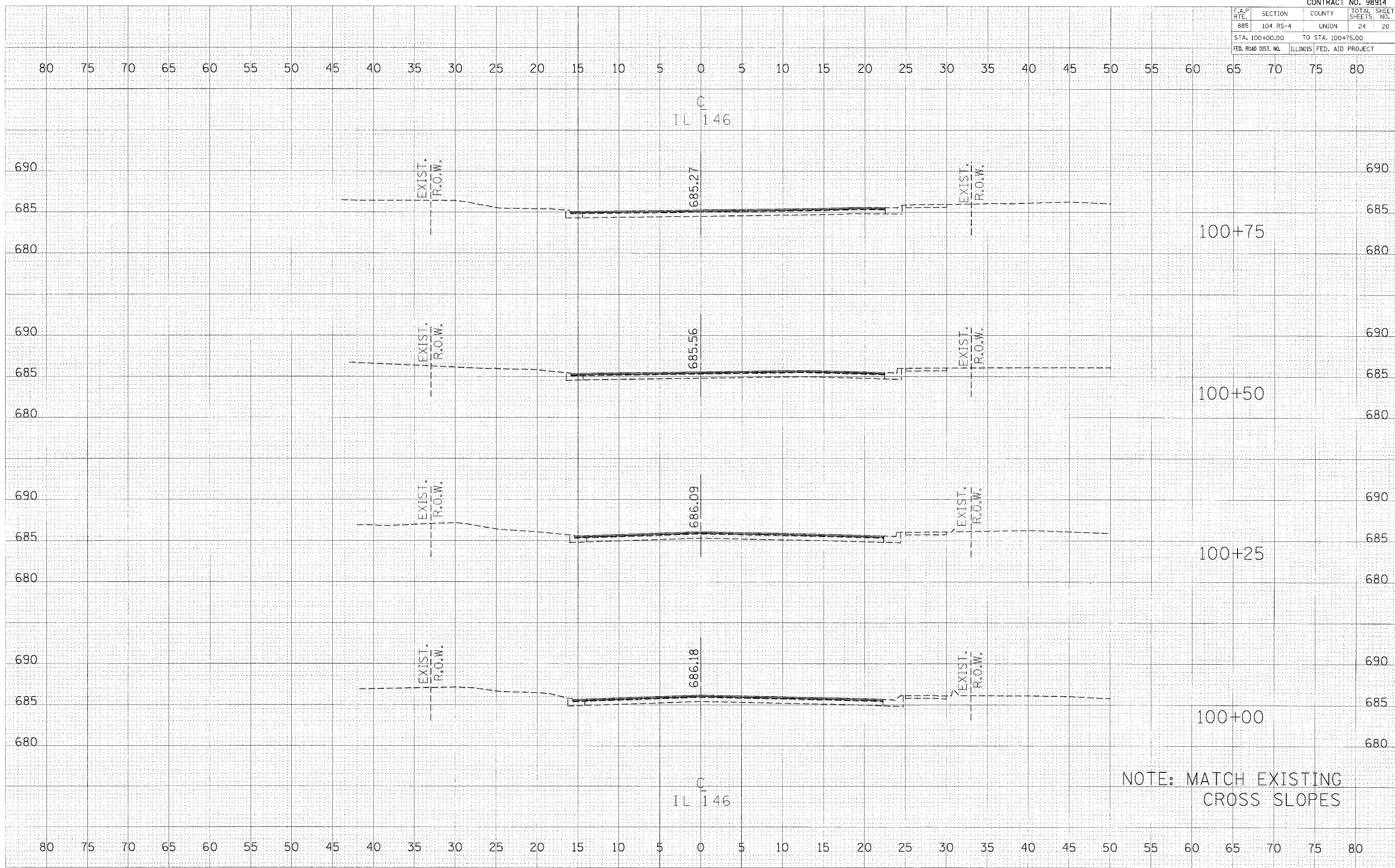

F.A.P. RTE.	SECTION	COUNTY	TOTAL SHEETS	SHEET NO.
885	104 RS-4	UNION	24	21
STA. 101+00.00		TO STA. 101+75.00		
FED. ROAD DIST. NO.		ILLINOIS FED. AID PROJECT		

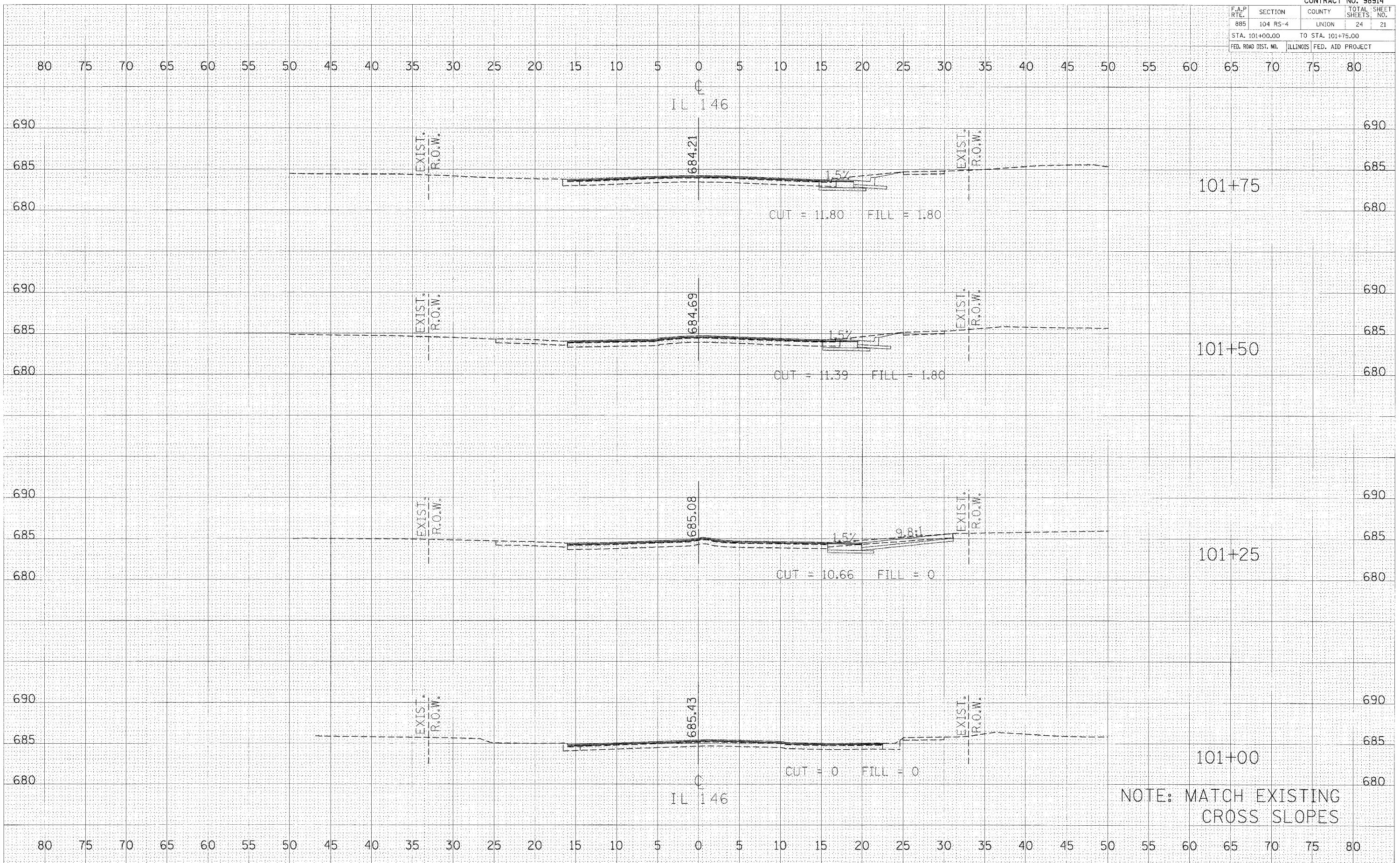

NOTE: MATCH EXISTING CROSS SLOPES

DATE: \_\_\_\_\_ BY: \_\_\_\_\_  
 SURVEYED: \_\_\_\_\_  
 NO. 1011 BOOK: \_\_\_\_\_  
 AREAS CHECKED: \_\_\_\_\_

DATE: \_\_\_\_\_ BY: \_\_\_\_\_  
 SURVEYED: \_\_\_\_\_  
 NO. 1011 BOOK: \_\_\_\_\_  
 AREAS CHECKED: \_\_\_\_\_

PLOT DATE = 1/31/2006  
 FILE NAME = c:\projects\98914\98914.dgn  
 PLOT SCALE = 5/8" = 1' IN.  
 USER NAME = russellcf

F.A.P. RTE.	SECTION	COUNTY	TOTAL SHEETS	SHEET NO.
885	104 RS-4	UNION	24	22

STA. 102+00.00 TO STA. 103+00.00  
FED. ROAD DIST. NO. ILLINOIS FED. AID PROJECT

DATE: \_\_\_\_\_ BY: \_\_\_\_\_  
 SURVEYED: \_\_\_\_\_  
 PLOTTED: \_\_\_\_\_  
 TEMPLATE: \_\_\_\_\_  
 NOTE BOOK: \_\_\_\_\_  
 NO. \_\_\_\_\_  
 AREAS CHECKED: \_\_\_\_\_

DATE: \_\_\_\_\_ BY: \_\_\_\_\_  
 SURVEYED: \_\_\_\_\_  
 PLOTTED: \_\_\_\_\_  
 TEMPLATE: \_\_\_\_\_  
 NOTE BOOK: \_\_\_\_\_  
 NO. \_\_\_\_\_  
 AREAS CHECKED: \_\_\_\_\_

PLOT DATE = 1/31/2005  
 FILE NAME = c:\p05\p05\102205\146\cns1.dgn  
 USER NAME = p0501107

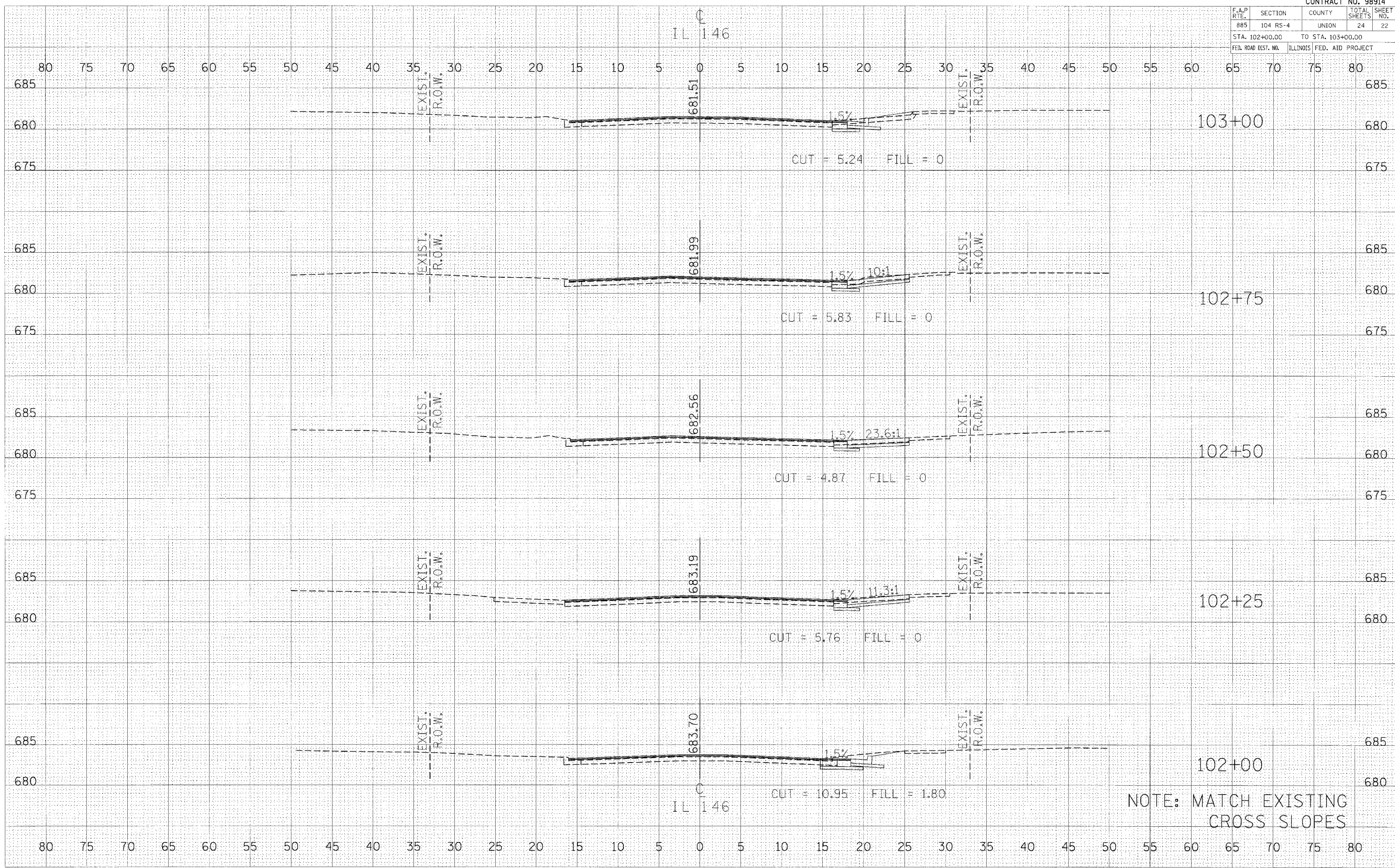

NOTE: MATCH EXISTING CROSS SLOPES

F.A.P. RTE.	SECTION	COUNTY	TOTAL SHEETS	SHEET NO.
885	104 RS-4	UNION	24	23
STA. 103+25.00		TO STA. 104+00.00		
FED. ROAD DIST. NO.		ILLINOIS FED. AID PROJECT		

DATE	
BY	
NO.	
FINAL SURVEY	
NOTE BOOK	
PLOTTED	
TEMPLATE	
ADDRESS CHECKED	

DATE	
BY	
NO.	
ORIGINAL SURVEY	
NOTE BOOK	
PLOTTED	
TEMPLATE	
ADDRESS CHECKED	

PLOT DATE = 1/31/2006  
FILE NAME = c:\projects\98914\885\146\cross1.dgn  
USER NAME = mrs10107

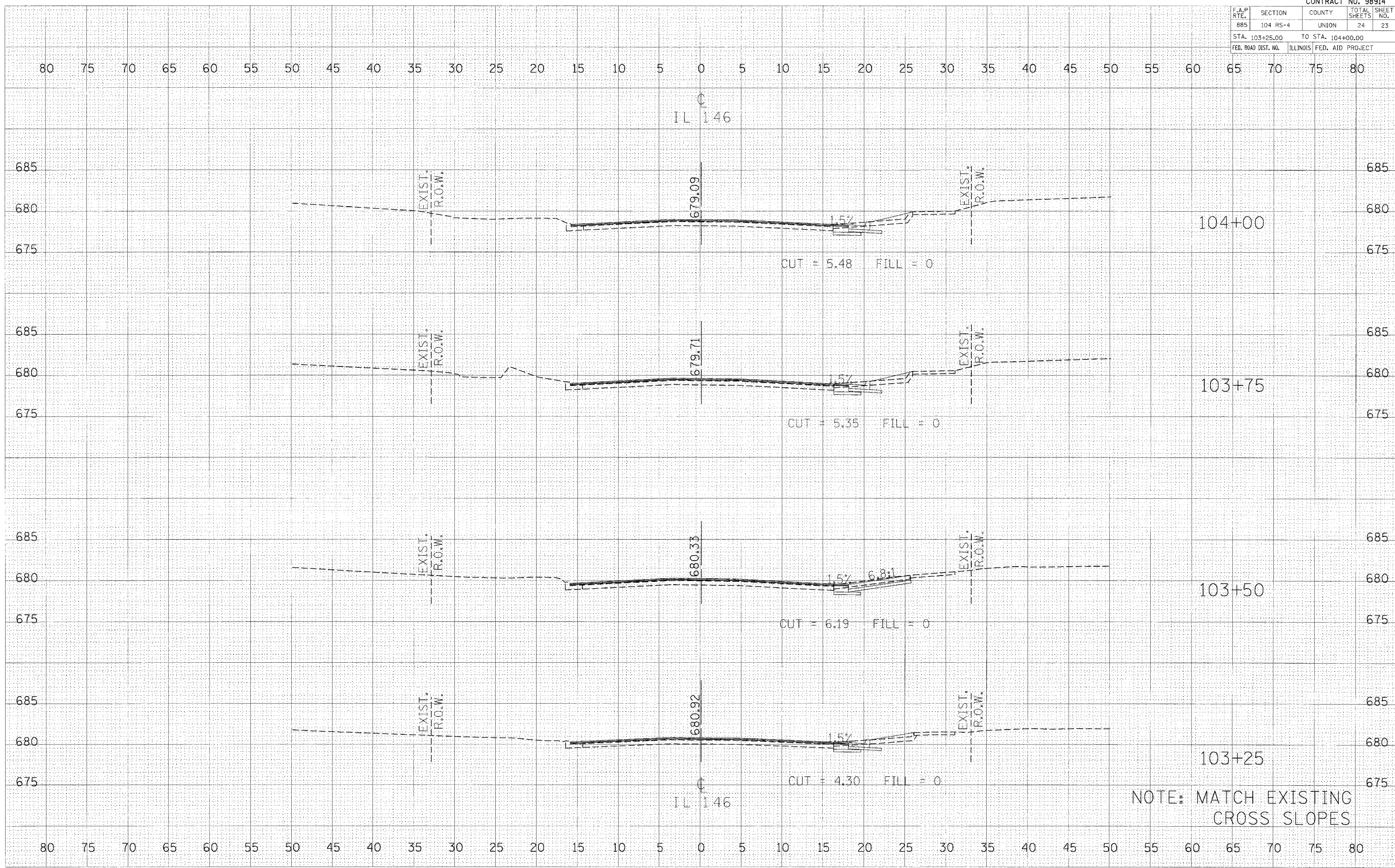

NOTE: MATCH EXISTING CROSS SLOPES

F.A.P. RTE.	SECTION	COUNTY	TOTAL SHEETS	SHEET NO.
885	104 RS-4	UNION	24	24
STA. 104+25.00		TO STA. 105+00.00		
FED. ROAD DIST. NO.		ILLINOIS FED. AID PROJECT		

DATE	
BY	
FINAL SURVEY	
NOTE BOOK	
AREAS CHECKED	

DATE	
BY	
ORIGINAL SURVEY	
NOTE BOOK	
AREAS CHECKED	

DATE = 1/31/2006  
FILE NAME = c:\pvc\pvcas\982105\106\stn.dgn  
PLOT SCALE = 5.0000' / 1" IN.  
USER NAME = russellc

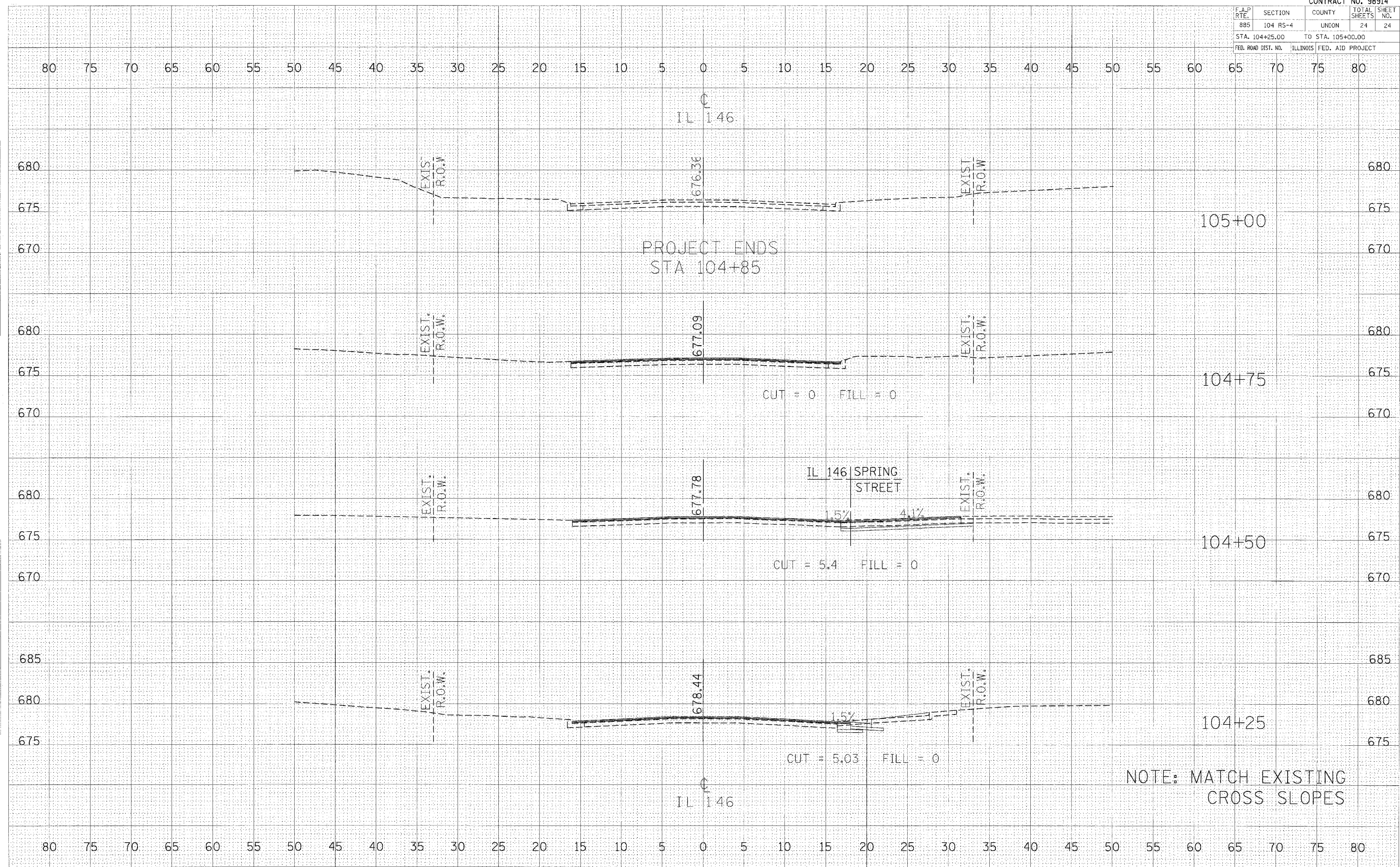

NOTE: MATCH EXISTING CROSS SLOPES