

F.A.P. RTE.	SECTION	COUNTY	TOTAL SHEETS	SHEET NO
(1)	(2)	(3)	5	3
FED. ROAD DIST. NO.		ILLINOIS	FED. AID PROJECT	
(1) FAP 778, FAP 885, TR-2 FAP 782, FAS 893				
(2) FY-06 FLASHING BEACONS				
(3) HARDIN & GALLATIN				

**NOTES**

- BEFORE BEGINNING WORK CONTACT DIANE ROBERTSON OF SOUTHEASTERN IL. ELECTRIC CO-OP AT 1-800-833-2611 FOR SERVICE DETAILS
- EXISTING SURFACE DISTURBED DURING EXCAVATION FOR TRENCHING AND/OR AUGERING SHALL BE RESTORED TO ITS ORIGINAL CONDITION. NO ADDITIONAL COMPENSATION WILL BE MADE FOR THIS WORK.
- ALL CABLE SHALL BE A.W.G. #14 2C
- PINNACLE FLASHERS INSTALLED IN SIGNAL HEAD TO BE INCLUDED IN COST OF LED.
- THE COST OF SUB BASE GRANULAR MATERIAL SHALL BE INCLUDED IN THE PRICE OF CONCRETE MEDIAN SURFACE, 4"
- THE GULFBOX JUNCTION IN THE MEDIAN SHALL BE PLACED 2 FEET FROM THE EXISTING R-1 STOP SIGN. THE CONDUIT RUNNING FROM THE GULFBOX JUNCTION TO THE EXISTING STOP SIGN SHALL BE BACKFILLED BUT SHALL NOT HAVE CONCRETE MEDIAN SURFACE ABOVE IT.
- COST OF 1-1/2" CONDUIT FROM BASE OF SIGN POST TO GULFBOX SHALL BE INCLUDED IN THE COST THE OF GULFBOX JUNCTION.
- MATCH EXISTING GROUND ELEVATIONS FOR PROPOSED GULFBOX JUNCTIONS. UNLESS OTHERWISE NOTED.

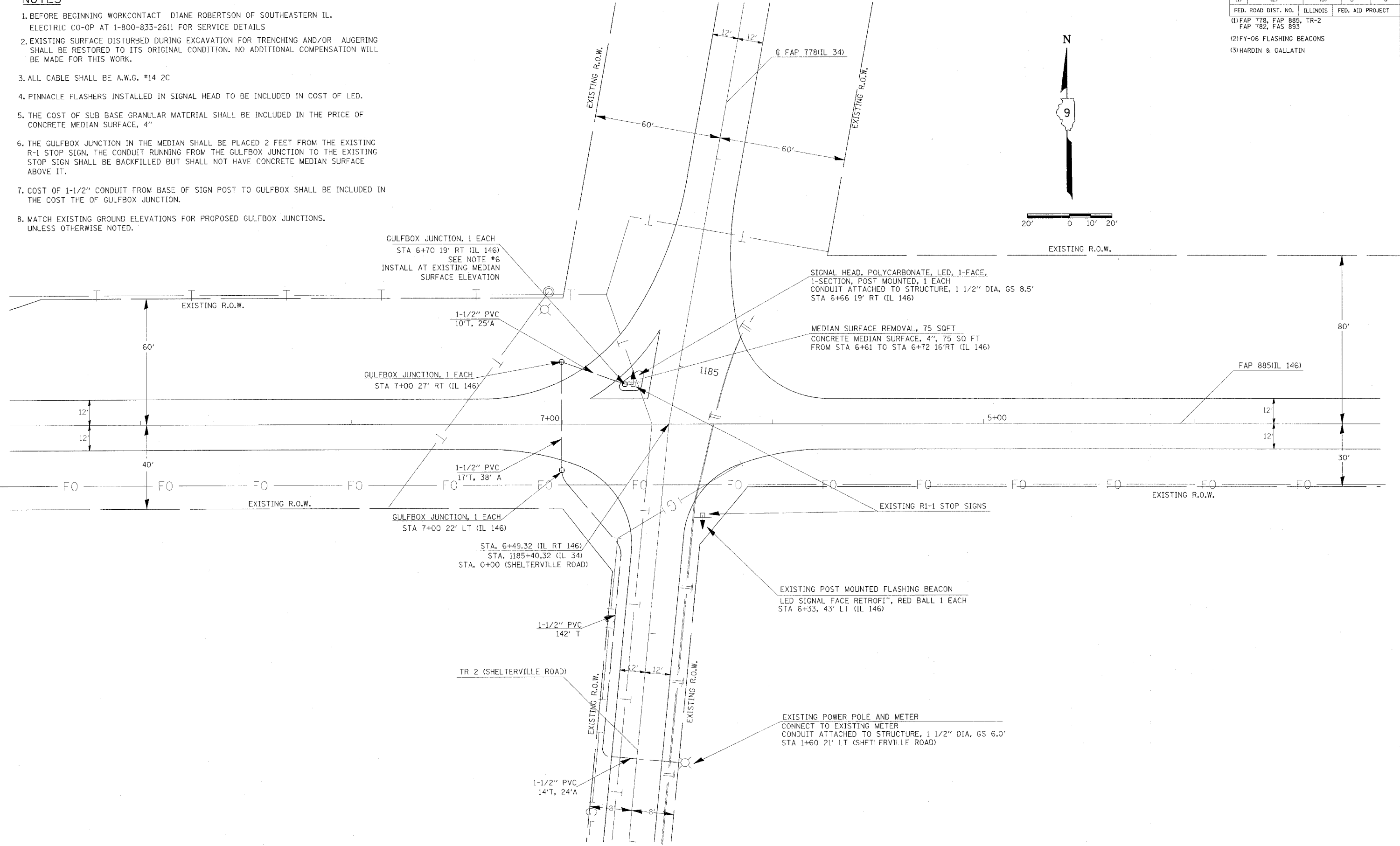
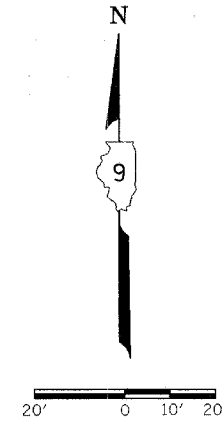

**LOCATION 1 - IL 146 /IL 34-SHETLerville ROAD FLASHING BEACON PLAN**

DATE: TIME: DGN: SREB