

| | | | | |
|---------------------|---------------------------|------------------|--------------|-----------|
| F.A. No. | SECTION | COUNTY | TOTAL SHEETS | SHEET NO. |
| 1926 | 04-00093-00-BR | UNION | 22 | 8 |
| STA. 10+00.00 | | TO STA. 18+90.00 | | |
| FED. ROAD DIST. NO. | ILLINOIS FED. AID PROJECT | | | |
| CONTRACT NO. 99236 | | | | |

HANSON
Hanson Professional Services Inc.
Copyright Hanson Professional Services Inc. 2006

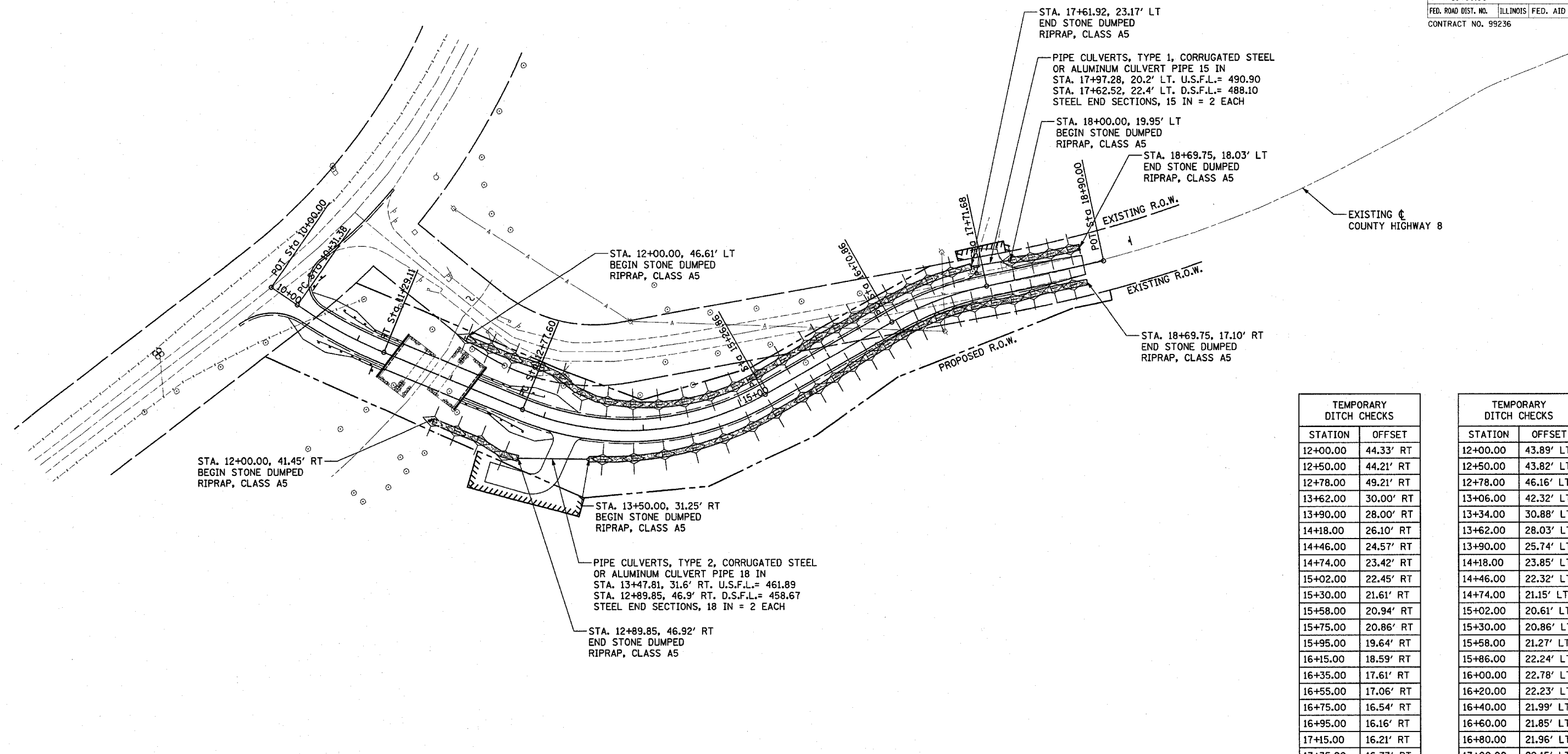

STA. 12+00.00, 41.45' RT
BEGIN STONE DUMPED RIPRAP, CLASS A5

STA. 12+00.00, 46.61' LT
BEGIN STONE DUMPED RIPRAP, CLASS A5

STA. 13+50.00, 31.25' RT
BEGIN STONE DUMPED RIPRAP, CLASS A5

PIPE CULVERTS, TYPE 2, CORRUGATED STEEL OR ALUMINUM CULVERT PIPE 18 IN
STA. 13+47.81, 31.6' RT. U.S.F.L.= 461.89
STA. 12+89.85, 46.9' RT. D.S.F.L.= 458.67
STEEL END SECTIONS, 18 IN = 2 EACH

STA. 12+89.85, 46.92' RT
END STONE DUMPED RIPRAP, CLASS A5

STA. 17+61.92, 23.17' LT
END STONE DUMPED RIPRAP, CLASS A5

PIPE CULVERTS, TYPE 1, CORRUGATED STEEL OR ALUMINUM CULVERT PIPE 15 IN
STA. 17+97.28, 20.2' LT. U.S.F.L.= 490.90
STA. 17+62.52, 22.4' LT. D.S.F.L.= 488.10
STEEL END SECTIONS, 15 IN = 2 EACH

STA. 18+00.00, 19.95' LT
BEGIN STONE DUMPED RIPRAP, CLASS A5

STA. 18+69.75, 18.03' LT
END STONE DUMPED RIPRAP, CLASS A5

STA. 18+69.75, 17.10' RT
END STONE DUMPED RIPRAP, CLASS A5

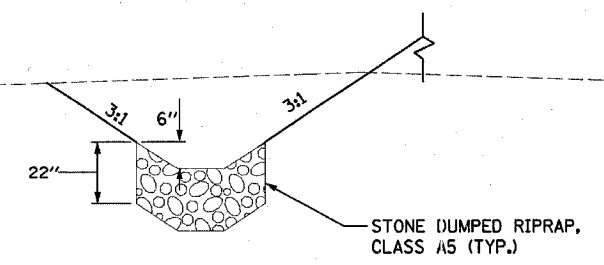

EROSION CONTROL LEGEND

- STONE RIPRAP
- TEMPORARY DITCH CHECK

| TEMPORARY DITCH CHECKS | |
|------------------------|-----------|
| STATION | OFFSET |
| 12+00.00 | 44.33' RT |
| 12+50.00 | 44.21' RT |
| 12+78.00 | 49.21' RT |
| 13+62.00 | 30.00' RT |
| 13+90.00 | 28.00' RT |
| 14+18.00 | 26.10' RT |
| 14+46.00 | 24.57' RT |
| 14+74.00 | 23.42' RT |
| 15+02.00 | 22.45' RT |
| 15+30.00 | 21.61' RT |
| 15+58.00 | 20.94' RT |
| 15+75.00 | 20.86' RT |
| 15+95.00 | 19.64' RT |
| 16+15.00 | 18.59' RT |
| 16+35.00 | 17.61' RT |
| 16+55.00 | 17.06' RT |
| 16+75.00 | 16.54' RT |
| 16+95.00 | 16.16' RT |
| 17+15.00 | 16.21' RT |
| 17+35.00 | 16.73' RT |
| 17+55.00 | 17.23' RT |
| 17+75.00 | 18.03' RT |
| 17+95.00 | 18.77' RT |
| 18+15.00 | 17.80' RT |
| 18+35.00 | 16.11' RT |
| 18+55.00 | 17.07' RT |

| TEMPORARY DITCH CHECKS | |
|------------------------|-----------|
| STATION | OFFSET |
| 12+00.00 | 43.89' LT |
| 12+50.00 | 43.82' LT |
| 12+78.00 | 46.16' LT |
| 13+06.00 | 42.32' LT |
| 13+34.00 | 30.88' LT |
| 13+62.00 | 28.03' LT |
| 13+90.00 | 25.74' LT |
| 14+18.00 | 23.85' LT |
| 14+46.00 | 22.32' LT |
| 14+74.00 | 21.15' LT |
| 15+02.00 | 20.61' LT |
| 15+30.00 | 20.86' LT |
| 15+58.00 | 21.27' LT |
| 15+86.00 | 22.24' LT |
| 16+00.00 | 22.78' LT |
| 16+20.00 | 22.23' LT |
| 16+40.00 | 21.99' LT |
| 16+60.00 | 21.85' LT |
| 16+80.00 | 21.96' LT |
| 17+00.00 | 22.15' LT |
| 17+20.00 | 22.37' LT |
| 17+40.00 | 22.36' LT |
| 18+00.00 | 19.91' LT |
| 18+20.00 | 18.38' LT |
| 18+40.00 | 18.02' LT |
| 18+60.00 | 18.02' LT |

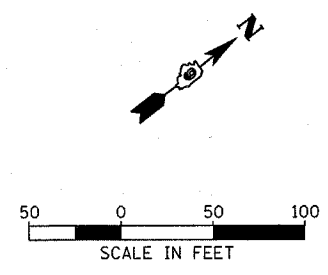

| REVISIONS | |
|-----------|------|
| NAME | DATE |
| | |
| | |
| | |
| | |
| | |
| | |
| | |
| | |
| | |
| | |

ILLINOIS DEPARTMENT OF TRANSPORTATION
F.A.S. 1926
SECTION 04-00093-00-BR
UNION COUNTY
COUNTY HIGHWAY 8 OVER BRADSHAW CREEK

EROSION CONTROL PLAN

SCALE: VERT. 1"=50'
HORIZ. 1"=50'
DATE 02/03/06

DRAWN BY RLA
CHECKED BY JDS

LAYOUT RLA 08/17/04 Hc
DRAWN RLA 01/24/05 JDS
REVIEWED JDS 01/24/05 JDS
02/03/06 JDS