

CONTRACT NUMBER	COUNTY	TOTAL SHEETS	SHEET NO.
GROO2	BOND	29	5

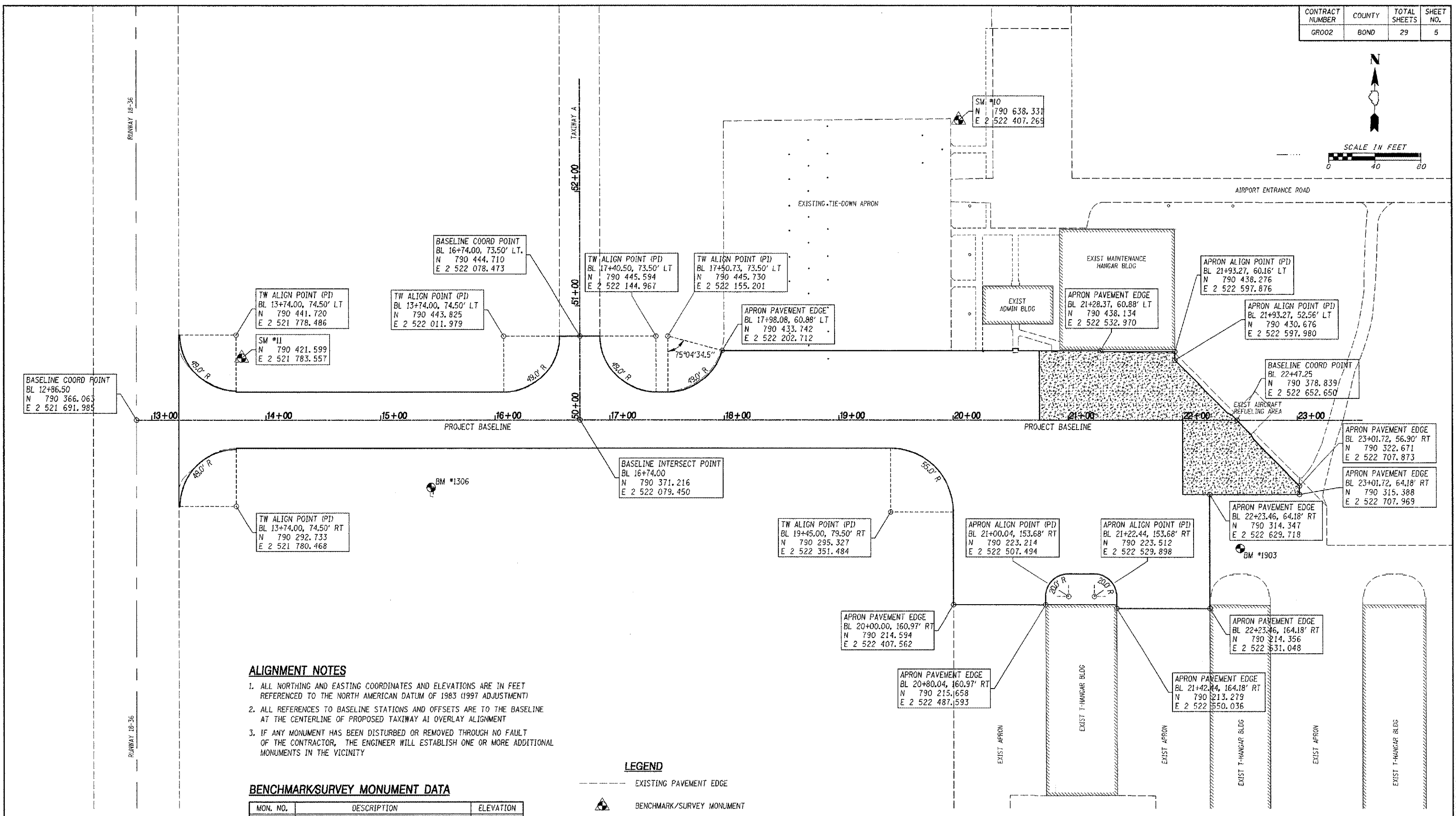
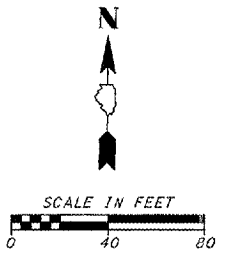

ALIGNMENT NOTES

1. ALL NORTHING AND EASTING COORDINATES AND ELEVATIONS ARE IN FEET REFERENCED TO THE NORTH AMERICAN DATUM OF 1983 (1997 ADJUSTMENT)
2. ALL REFERENCES TO BASELINE STATIONS AND OFFSETS ARE TO THE BASELINE AT THE CENTERLINE OF PROPOSED TAXIWAY AI OVERLAY ALIGNMENT
3. IF ANY MONUMENT HAS BEEN DISTURBED OR REMOVED THROUGH NO FAULT OF THE CONTRACTOR, THE ENGINEER WILL ESTABLISH ONE OR MORE ADDITIONAL MONUMENTS IN THE VICINITY

BENCHMARK/SURVEY MONUMENT DATA

MON. NO.	DESCRIPTION	ELEVATION
SM 10	3/8" IRON ROD WITH CAP N 790 638.331 E 2 522 407.269	537.715
SM 11	NGS CONTROL POINT (GPS) 1/2" STEEL ROD IN ALUMINUM CASING N 790 421.599 E 2 521 783.557	533.503
BM 1903	PAINTED "+" S.E. COR. INLET TOP	535.800
BM 1306	CHISELED "x" N.W. COR. CONCRETE HOLD SIGN PAD ON SOUTH SIDE TW AI	533.981

LEGEND

- EXISTING PAVEMENT EDGE
- ▲ BENCHMARK/SURVEY MONUMENT
- PROPOSED BASELINE/CENTERLINE
- ▨ EXISTING BUILDINGS
- ▩ PROPOSED PCC PAVEMENT AREA
- PROPOSED AC PAVEMENT AREA

DATE	DESCRIPTION OF THE REVISIONS	BY

GREENVILLE AIRPORT AUTHORITY GREENVILLE, ILLINOIS

HENRY, MEISENHEIMER & GENDEL, INC.
ENGINEERS
CARLYLE, ILLINOIS 62831
www.hmgengineers.com
(618) 504-3711 Fax (618) 504-8217

HORIZONTAL ALIGNMENT AND MONUMENT LOCATIONS

IL PROJ. NO.	GRE-3215
A.J.P. PROJ. NO.	3-17-0049-B4
FILE NAME	GA-HALIGN
DATE	03-24-2006

H.M.G. NO. 5636