

INLET NOTE

THE PROPOSED TYPE D INLETS, AS SHOWN ON THIS SHEET, SHALL BE CONSTRUCTED BY EXPOSING THE EXISTING 12" H.D.P.E. PIPE AND THEN SAWING THE PIPE TO INSTALL THE INLET. ONCE THE INLET IS INSTALLED, THE 12" H.D.P.E. SHALL BE EXTENDED, AS REQUIRED TO MAINTAIN DRAINAGE THROUGH THE PIPE AND THE STRUCTURE. ALL EQUIPMENT, MATERIALS AND LABOR REQUIRED TO INSTALL THE INLETS AND RETURN THE 12" H.D.P.E. TO A DRAINABLE CONDITION SHALL BE INCLUDED IN THE PRICE OF THE TYPE D INLET, AND NO ADDITIONAL COMPENSATION WILL BE ALLOWED. THIS WILL BE PAID FOR UNDER ITEM:
AR751414 INLET TYPE D _____ 2 EACH

P.C.C. PAVEMENT NOTE

THE EXISTING CONCRETE (APPROXIMATELY 10") SHALL BE REMOVED TO A SUITABLE SUBGRADE. CRUSHED AGGREGATE BASE COURSE SHALL BE USED TO RAISE THE SUBGRADE ELEVATION TO A MINIMUM OF 6" BELOW THE PROPOSED GRADE AS SHOWN ON THE TYPICAL SECTION "A-A" ON SHEET NO. 5.

REMOVE INLET NOTE

THE EXISTING INLET SHALL BE REMOVED TO ALLOW FOR THE INSTALLATION OF THE PROPOSED TYPE D INLET. THE EXISTING INLET SHALL BE REMOVED AND HAULED OFF-SITE BY THE CONTRACTOR. ANY DAMAGE TO THE EXISTING PIPE OR PAVEMENT WILL BE REPAIRED BY THE CONTRACTOR AT NO ADDITIONAL COST TO THE CONTRACT. THIS WILL BE PAID FOR UNDER ITEM:
AR751900 REMOVE INLET _____ 1 EACH

LW021

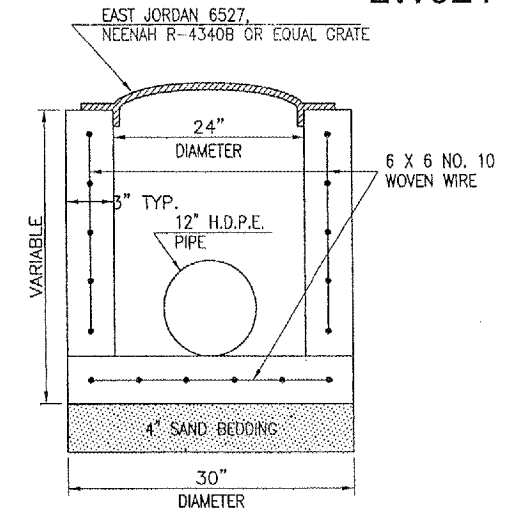

PROPOSED TYPE D INLET

IDOT STANDARD 1538-6

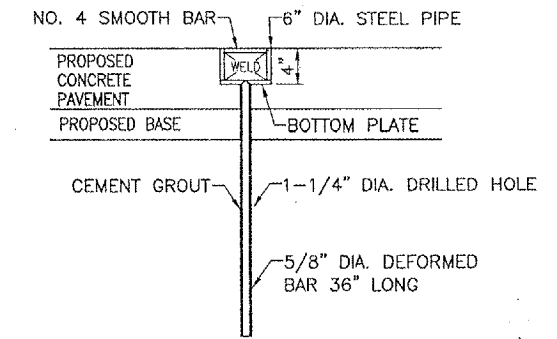

TIE DOWN DETAIL "C"
"NOT TO SCALE"

TIE DOWN NOTES

NEW TIE DOWNS WILL BE INSTALLED IN ACCORDANCE WITH DETAIL "C" AND AT THE LOCATIONS SHOWN ON THIS SHEET.

THE PERIMETER OF EACH PROPOSED TIE DOWN SHALL BE SAWED.

CONCRETE SHALL MEET THE REQUIREMENTS OF 610 - STRUCTURAL CONCRETE.

THE PROPOSED TIE DOWN MARKING WILL BE IN ACCORDANCE WITH THE DETAIL ON THIS SHEET AND THE SPECIFICATIONS.

THE TIE DOWNS WILL BE PAID FOR UNDER ITEM:
AR510510 "TIE DOWN" _____ 3 EA.

LEGEND

- EXISTING PAVEMENT
- EXISTING BUILDING
- EXISTING FENCE
- EXISTING DRAINAGE PIPE
- EXISTING MARKING
- PROPOSED IMPROVEMENTS
- EXISTING INLET (TO BE REMOVED AND REPLACED)
- PROPOSED INLET
- PROPOSED TIE DOWN

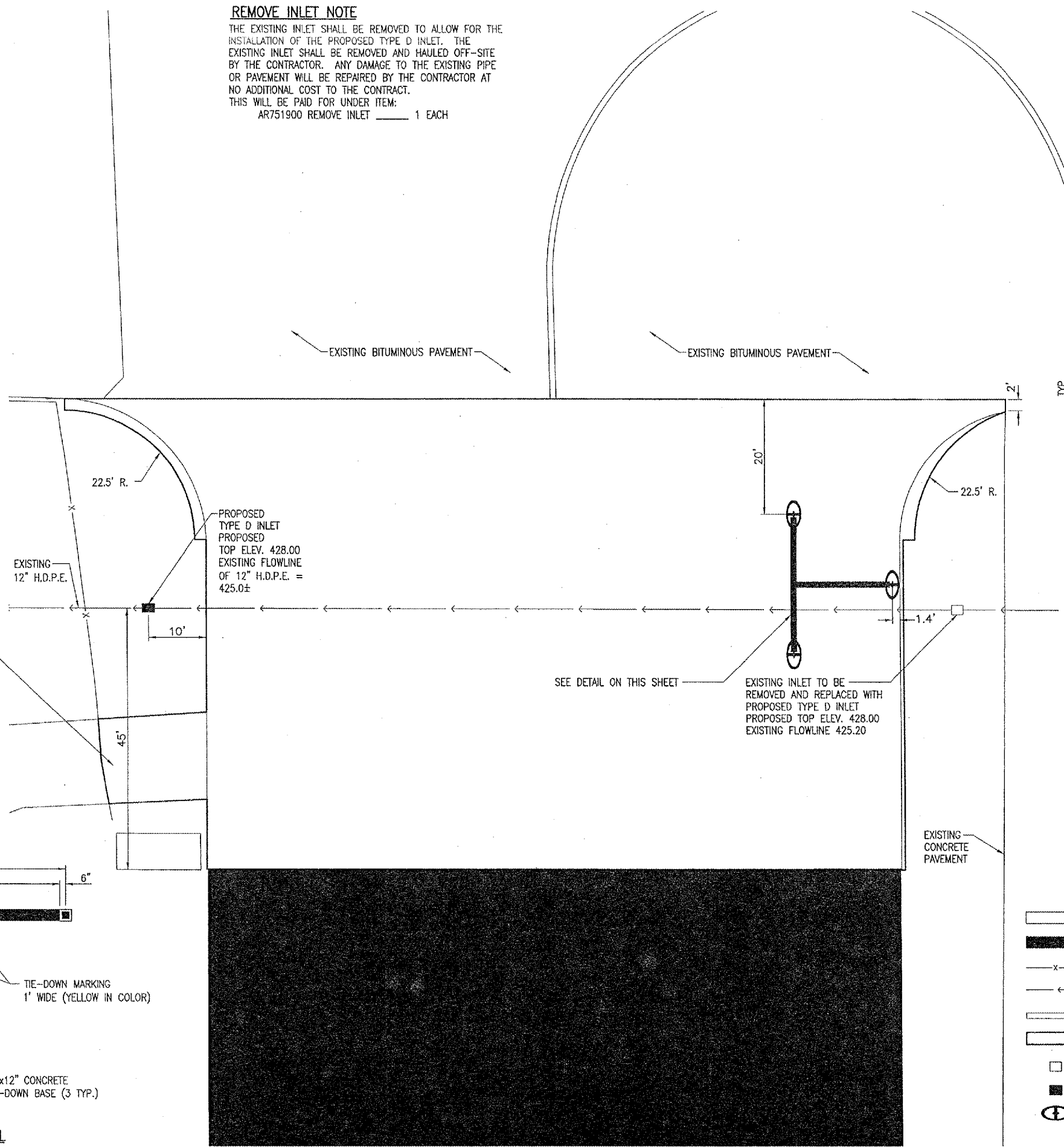
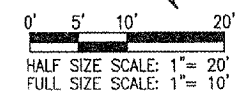

THE EXISTING BITUMINOUS ACCESS ROAD IS IN POOR CONDITION, AND SHALL BE OVERLAID WITH APPROXIMATELY 2" OF BITUMINOUS SURFACE COURSE. THIS CAN BE CONSTRUCTED IN ASSOCIATION WITH THE GLIDER CLUB AREA BITUMINOUS PAVING. THE CONTRACTOR AND RESIDENT ENGINEER WILL AGREE UPON THE MANNER IN WHICH THE OVERLAY IS CONSTRUCTED PRIOR TO THE OVERLAY. THE EXISTING ROAD SHALL BE REGRADED TO INSURE POSITIVE DRAINAGE AFTER THE 2" BITUMINOUS OVERLAY (SEE SHEET 8). THIS WILL BE PAID FOR UNDER ITEMS:
AR401610 BITUMINOUS SURFACE COURSE _____ 4 TONS
AR603510 BITUMINOUS TACK COAT _____ 6 GAL.

*THESE QUANTITIES ARE REPEATED IN THE GLIDER CLUB AREA QUANTITIES.

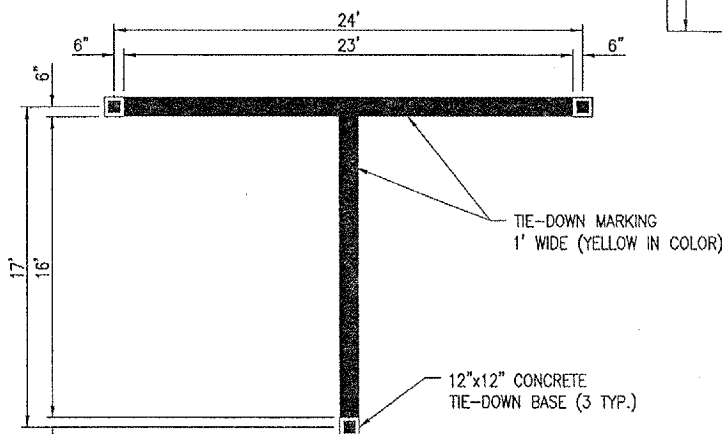

TIE DOWN MARKING DETAIL
"NOT TO SCALE"

MAR 29, 2006 10:33 AM CAH
E:\AIRPORTS\LAWRENCE\812-06APN\AIRPORT_SHEETS\R-122CON.DWG - VINCENNES U. AREA

DATE	REVISION	BY

MID-AMERICAN AIR CENTER
LAWRENCEVILLE-VINCENNES AIRPORT
LAWRENCEVILLE, ILLINOIS

NO.	DATE	BY	CHKD.
LAYOUT	12/12/05	B.A.K.	
DRAWN	12/12/05	B.A.K.	
REVIEWED	1/12/06	C.A.H.	

HANSON
Hanson Professional Services Inc.
1525 South Sixth Street
Springfield, Illinois 62703-2886
Offices Nationwide

RECONSTRUCTION OF
TWO APRON AREAS
PROPOSED
CONSTRUCTION PLAN FOR
VINCENNES UNIVERSITY AREA