

STATE OF ILLINOIS  
DEPARTMENT OF TRANSPORTATION

F.A.P. RTE.	SECTION	COUNTY	TOTAL SHEETS	SHEET NO.
132	12RS-4	POPE	26	1
ILLINOIS			CONTRACT NO. 78558	

FOR INDEX OF SHEETS, SEE SHEET NO. 3  
FOR SUMMARY OF QUANTITIES, SEE SHEET NO. 5-7  
FOR STRUCTURAL PAVEMENT DESIGN INFORMATION, SEE SHEET NO. 8-23

PROPOSED  
HIGHWAY PLANS

FAP 132 ROUTE IL 145  
SECTION 12RS-4

PROJECT STP-0132(134)  
PAVEMENT PATCHING & RESURFACING  
POPE COUNTY

TRAFFIC DATA

IL 37 (FAP 132) GLENDALE/DIXON SPRINGS	LOC A: (13.01-13.35)	LOC B: (13.35-18.67)
M.P.		
(2017)		
PV =	1,170	805
SU =	60	110
MU =	50	255
ADT =	1,280	1,170
(2037)		
PV =	1,425	985
SU =	75	135
MU =	60	310
ADT =	1,560	1,430

FOR OMMISIONS AND STATION EQUATIONS SEE SHEET NO. 3

TOWNSHIPS  
ALEXANDER AND WEBSTER

DESIGN DESIGNATION : N/A

COORDINATE SYSTEM : ILLINOIS EAST

POSTED SPEED : 55 MPH

J.U.L.I.E.  
JOINT UTILITY LOCATION INFORMATION FOR EXCAVATION  
1-800-892-0123  
OR 811

PROJECT ENGINEER CHARLES STEIN  
PROJECT DESIGNER AESHA JACKSON

CONTRACT NO. 78558

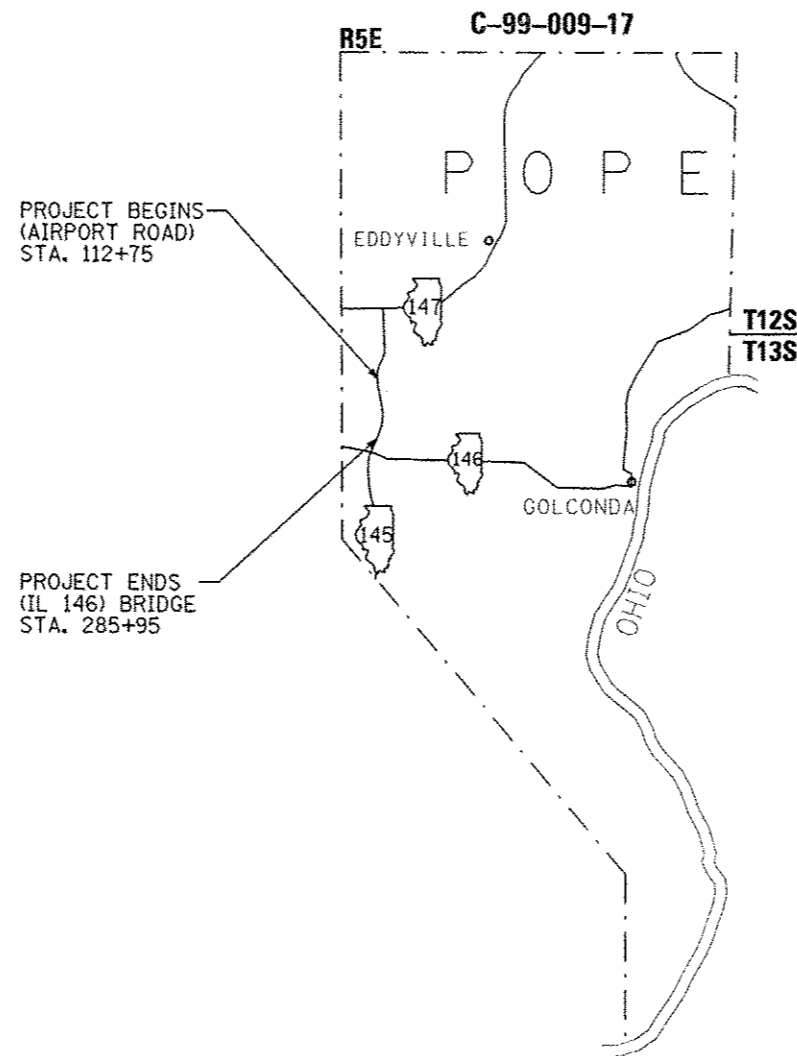

GROSS LENGTH = 17,320 FT. = 3.28 MILES  
NET LENGTH = 17,213 FT. = 3.26 MILES

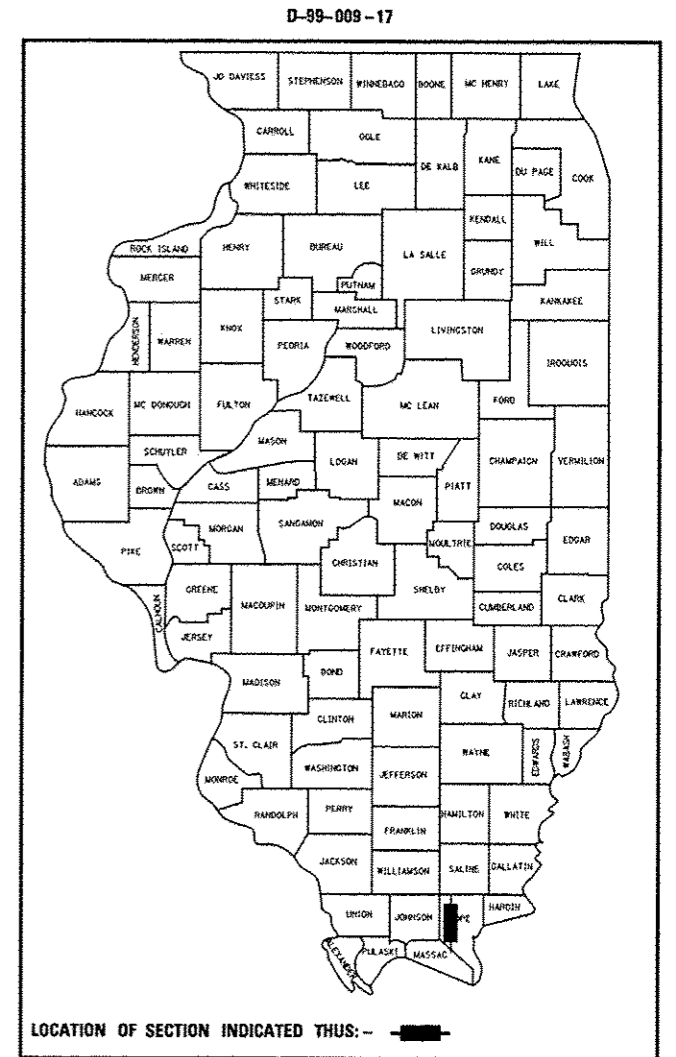

STATE OF ILLINOIS  
DEPARTMENT OF TRANSPORTATION

SUBMITTED Feb 6 20 17  
Duffrey L Keern  
REGION FIVE ENGINEER  
Mar 24 20 17  
Maureen M. Addis P.E.  
ENGINEER OF DESIGN AND ENVIRONMENT  
Mar 24 20 17  
Charles Stein  
DIRECTOR OF PROGRAM DEVELOPMENT

PRINTED BY THE AUTHORITY  
OF THE STATE OF ILLINOIS

Prepared By: [Signature]  
DISTRICT STUDIES & PLANS ENGINEER

Examined By: [Signature]  
DISTRICT LAND ACQUISITION ENGINEER

Examined By: [Signature]  
DISTRICT PROGRAM DEVELOPMENT ENGINEER

Examined By: [Signature]  
DISTRICT OPERATIONS ENGINEER

Examined By: [Signature]  
DISTRICT PROJECT IMPLEMENTATION ENGINEER

Examined By: [Signature]  
DISTRICT CONSTRUCTION ENGINEER

Examined By: [Signature]  
DISTRICT MATERIALS ENGINEER

FILE NAME =	USER NAME = jacksonec	DESIGNED -	REVISED -
pw\IL084EBIDINTEG\illinois.gov\PIDOT\Documents\IDOT Offices\District 9\Projects\78558\Drawings\CA08sheets\78558 Sheet		DRAWN	REVISED -
Default	PLOT SCALE = 100.0000' / 1"	CHECKED -	REVISED -
	PLOT DATE = 2/2/2017	DATE -	REVISED -

**STATE OF ILLINOIS  
DEPARTMENT OF TRANSPORTATION**

SIGNATURE SHEET				
SCALE:	SHEET	OF	SHEETS	STA. TO STA.

F.A.P. RTE.	SECTION	COUNTY	TOTAL SHEETS	SHEET NO.
132	12RS-4	POPE	26	2
<b>CONTRACT NO. 78558</b>				
ILLINOIS FED. AID PROJECT				



# GENERAL NOTES

QUANTITIES SHOWN IN THE PLANS FOR PATCHING ARE ESTIMATES. THE ACTUAL AMOUNT OF PATCHING REQUIRED WILL BE DETERMINED BY THE ENGINEER.

FACTORS USED FOR ESTIMATING PLAN QUANTITIES ARE AS FOLLOWS AND SHALL NOT BE USED FOR THE BASIS OF FINAL QUANTITIES:

ALL HOT MIX ASPHALT	2.016 TONS/ CU.YD.
ALL AGGREGATE	2.05 TONS/ CU. YD.

IN ADDITION TO THE REQUIREMENTS OF ARTICLE 107.16, THE CONTRACTOR SHALL PROTECT THE SURFACE OF ALL BRIDGE DECKS AND BRIDGE APPROACH PAVEMENTS IN A MANNER SATISFACTORY OF THE ENGINEER BEFORE ANY EQUIPMENT IS ALLOWED TO CROSS THE STRUCTURE. PROTECT SHALL BE PROVIDED FOR ALL EQUIPMENT AS DEFINED IN ARTICLE 101.17.

THE THICKNESS OF HOT MIX ASPHALT MIXTURE SHOWN ON THE PLANS IS THE NOMINAL THICKNESS. DEVIATIONS FROM THE NOMINAL THICKNESS WILL BE PERMITTED WHEN SUCH DEVIATIONS OCCUR DUE TO IRREGULARITIES IN THE EXISTING SURFACE OR BASE ON WHICH THE HOT MIX ASPHALT MIXTURE IS PLACED.

THE QUANTITY OF SHORT TERM PAVEMENT MARKING SHOWN IN THE PLANS IS BASED ON ONE APPLICATION EACH FOR THE HMA SURFACE REMOVAL, SURFACE COURSE, AND BINDER COURSE.

REMAINING CONCRETE GUTTER SHALL BE MILLED OFF SO THAT NOTHING SHOWS ABOVE THE FINISHED SURFACE

UNLESS OTHERWISE DIRECTED BY THE ENGINEER ,RESURFACING SHALL BE PLACED IN A SEQUENCE THAT WILL MINIMIZE THE TIME THE CENTERLINE EDGE IS EXPOSED TO TRAFFIC. WHEN AT THE END OF A DAY'S OPERATION THE EXPOSED CENTERLINE EDGE IS GREATER THAN 2,000 FT. THE CONTRACTOR SHALL BE REQUIRED TO PAVE IN THE ADJACENT LANE ON THE FOLLOWING WORK DAY . PRIOR TO WINTER SHUT DOWN RESURFACING ON ADJACENT LANES IS TO BE BROUGHT UP TO THE SAME ELEVATION.

ATTAINMENT OF PROPER CROWN OR SUPERELEVATION SHALL BE FULLY ACCOMPLISHED WITH THE HOT-MIX ASPHALT SURFACE REMOVAL OR HOT-MIX ASPHALT BINDER COURSE WHEN SPECIFIED.

RECLAIMED ASPHALT PAVEMENT (RAP )WILL NOT BE ALLOWED FOR USE AS AGGREGATE IN AGGREGATE SHOULDERS ,TYPE B.

PRIOR TO PLACEMENT OF THE FINAL PAVEMENT MARKINGS THE RESIDENT ENGINEER SHOULD CONTACT THE BUREAU OF OPERATIONS AND ARRANGE FOR INSPECTION AND APPROVAL OF THE PAVEMENT MARKING LAYOUT.

AFTER A LIFT OF HOT-MIX ASPHALT HAS BEEN PLACED ON A LANE, THAT LANE SHALL REMAIN CLOSED TO TRAFFIC UNTIL THE NEW MAT HAS COOLED TO 150 °F.

THE CONTRACTOR SHALL COMPLETE ALL PATCHING PRIOR TO THE BITUMINOUS SURFACE REMOVAL.

ALL EXISTING GUARDRAIL OR BRIDGE DAMAGED OR DESTROYED BY THE CONTRACTOR'S OPERATIONS SHALL BE REPAIRED OR REPLACED AT THE CONTRACTORS EXPENSE IN A MANNER SATISFACTORY TO THE ENGINEER.

THE CONTRACTOR SHALL STAMP STATIONING IN THE HOT-MIX ASPHALT SURFACE AT 300 FT INTERVALS ALTERNATING SIDES ON THE OUTSIDE EDGE OF PAVEMENT AND AS DIRECTED BY THE ENGINEER.THE STATION SYMBOL STAMPS USED SHALL BE FURNISHED BY THE CONTRACTOR. THEY SHALL BE 140 mm (5½ IN.) TALL, OF A DESIGN APPROVED BY THE ENGINEER, AND SHALL REMAIN THE PROPERTY OF THE CONTRACTOR.

STRUCTURE NO.	OPERATING RATING	INVENTORY RATING	POSTING	MTD
076 - 0014	56	34	NONE	TBD
076 - 0015	89	53	NONE	TBD
076 - 0028	65	49	NONE	TBD
076 - 2003	41	27	NONE	TBD
076 - 7035	0	0	NONE	TBD

## COMMITMENTS

NONE

FILE NAME =	USER NAME = jacksonc	DESIGNED -	REVISED -	<b>STATE OF ILLINOIS DEPARTMENT OF TRANSPORTATION</b>	<b>INDEX OF SHEETS, STANDARDS, GENERAL NOTES, MIXTURE DESIGN, OMISSIONS AND STATION EQUATIONS-CONT'D</b>	F.A.P. RTE.	SECTION	COUNTY	TOTAL SHEETS	SHEET NO.		
p:\11\084EBID\INTEG.illinois.gov\PI\DOT\Documents\DOT Offices\District 9\Projects\78558\Drawings\CAD\Sheets\78558 Sheet								132	12RS-4	POPE	26	4
PLOT SCALE = 100.0000' / in.						CHECKED -		CONTRACT NO. 78558				
PLOT DATE = 2/7/2017						DATE -	SCALE:	SHEET OF SHEETS		STA. TO STA.		
Default						ILLINOIS FED. AID PROJECT						

# SUMMARY OF QUANTITIES

COUNTY:	Pope
ROUTE:	FAP 132 IL 145
FUNDING:	80%FED 20%STATE ✓
LOCATION:	RURAL ✓
TOTAL QUANTITY	ROADWAY 0005 ✓

CODE NUMBER	ITEM DESCRIPTION	UNIT	TOTAL QUANTITY	ROADWAY
25000200	SEEDING, CLASS 2	ACRE	1.6	1.6
25000350	SEEDING, CLASS 7	ACRE	1.6	1.6
25000400	NITROGEN FERTILIZER NUTRIENT	POUND	100	100
25000500	PHOSPHORUS FERTILIZER NUTRIENT	POUND	100	100
25000600	POTASSIUM FERTILIZER NUTRIENT	POUND	100	100
25000700	AGRICULTURAL GROUND LIMESTONE	TON	2	2
25100105	MULCH, METHOD 1	ACRE	1.6	1.6
28000250	TEMPORARY EROSION CONTROL SEEDING	POUND	160	160
40600290	BITUMINOUS MATERIALS (TACK COAT)	POUND	32684	32684
40600637	LEVELING BINDER (MACHINE METHOD), IL-9.5FG, N70	TON	1915	1915
40600982	HOT-MIX ASPHALT SURFACE REMOVAL - BUTT JOINT	SQ YD	258	258
40600990	TEMPORARY RAMP	SQ YD	64	64
40603315	HOT-MIX ASPHALT SURFACE COURSE, MIX "C", N70	TON	4037	4037
40800050	INCIDENTAL HOT-MIX ASPHALT SURFACING	TON	55	55

11

# SUMMARY OF QUANTITIES - CONT

COUNTY:	Pope
ROUTE:	FAP 132 IL 145
FUNDING:	80%FED 20%STATE
LOCATION:	RURAL

CODE NUMBER	ITEM DESCRIPTION	UNIT	TOTAL QUANTITY	ROADWAY 0005
44000151	HOT-MIX ASPHALT SURFACE REMOVAL, 1/2"	SQ YD	45679	45679
44201361	CLASS C PATCHES, TYPE I, 11 INCH	SQ YD	254	254
44201365	CLASS C PATCHES, TYPE II, 11 INCH	SQ YD	133	133
44201369	CLASS C PATCHES, TYPE III, 11 INCH	SQ YD	18	18
48102100	AGGREGATE WEDGE SHOULDER, TYPE B	TON	1019	1019
48203100	HOT-MIX ASPHALT SHOULDERS	TON	79	79
67000400	ENGINEER'S FIELD OFFICE, TYPE A	CAL MO	3	3
67100100	MOBILIZATION	LSUM	1	1
70100460	TRAFFIC CONTROL AND PROTECTION, STANDARD 701306	LSUM	1	1
70100600	TRAFFIC CONTROL AND PROTECTION, STANDARD 701336	LSUM	1	1
70300100	SHORT TERM PAVEMENT MARKING	FOOT	5217	5217
70300150	SHORT TERM PAVEMENT MARKING REMOVAL	SQ FT	1739	1739
70300220	TEMPORARY PAVEMENT MARKING - LINE 4"	FOOT	51828	51828
19 * 78001110	PAINT PAVEMENT MARKING - LINE 4"	FOOT	51828	51828

\* SPECIALTY ITEM

# SUMMARY OF QUANTITIES - CONT

7/05 10 037

COUNTY:	Pope
ROUTE:	FAP 132 IL 145
FUNDING:	80%FED 20%STATE
LOCATION:	RURAL
TOTAL QUANTITY	ROADWAY 0005

CODE NUMBER	ITEM DESCRIPTION	UNIT	TOTAL QUANTITY	ROADWAY
* 78100100	RAISED REFLECTIVE PAVEMENT MARKER	EACH	217	217
78300200	RAISED REFLECTIVE PAVEMENT MARKER REMOVAL	EACH	217	217
X2020110	GRADING AND SHAPING SHOULDERS	UNIT	143	143
X7015005	CHANGEABLE MESSAGE SIGN	CAL DA	28	28
X7030005	TEMPORARY PAVEMENT MARKING REMOVAL	SQ FT	17276	17276
Z0034105	MATERIAL TRANSFER DEVICE	TON	4037	4037

6

\* SPECIALTY ITEM

# TYPICAL SECTION

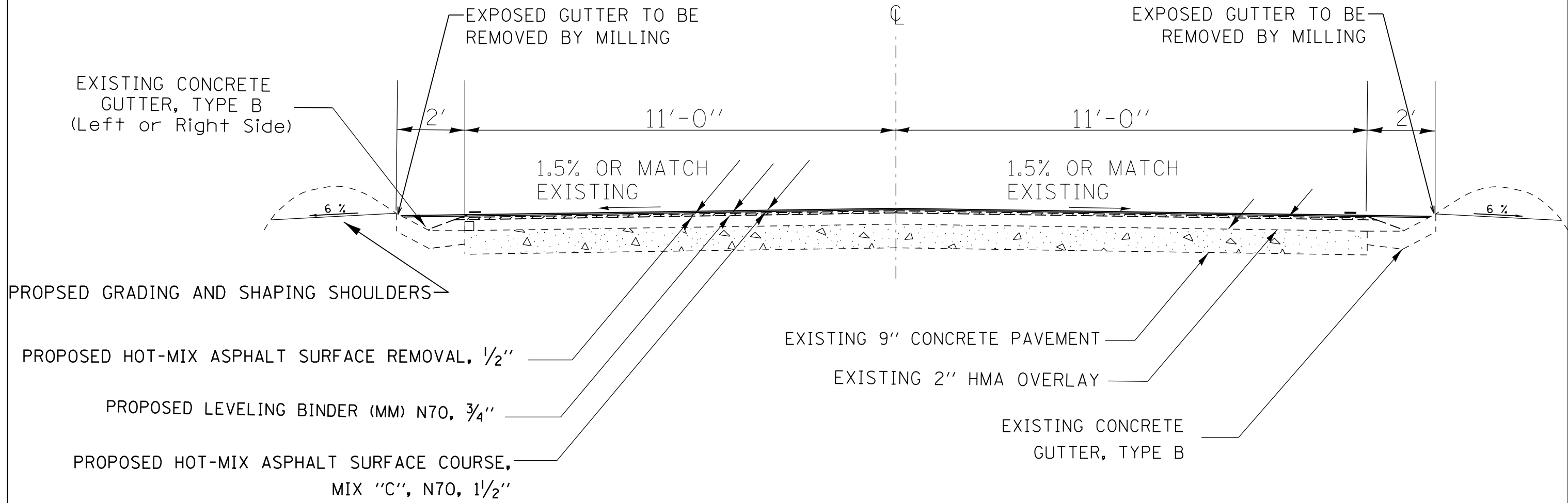

TO BE USED:

FROM	TO
STA. 112+94	STA. 119+47
STA. 179+76	STA. 183+80
STA. 204+60	STA. 208+00
STA. 241+76	STA. 251+14
STA. 281+40	STA. 285+95



# TYPICAL SECTION

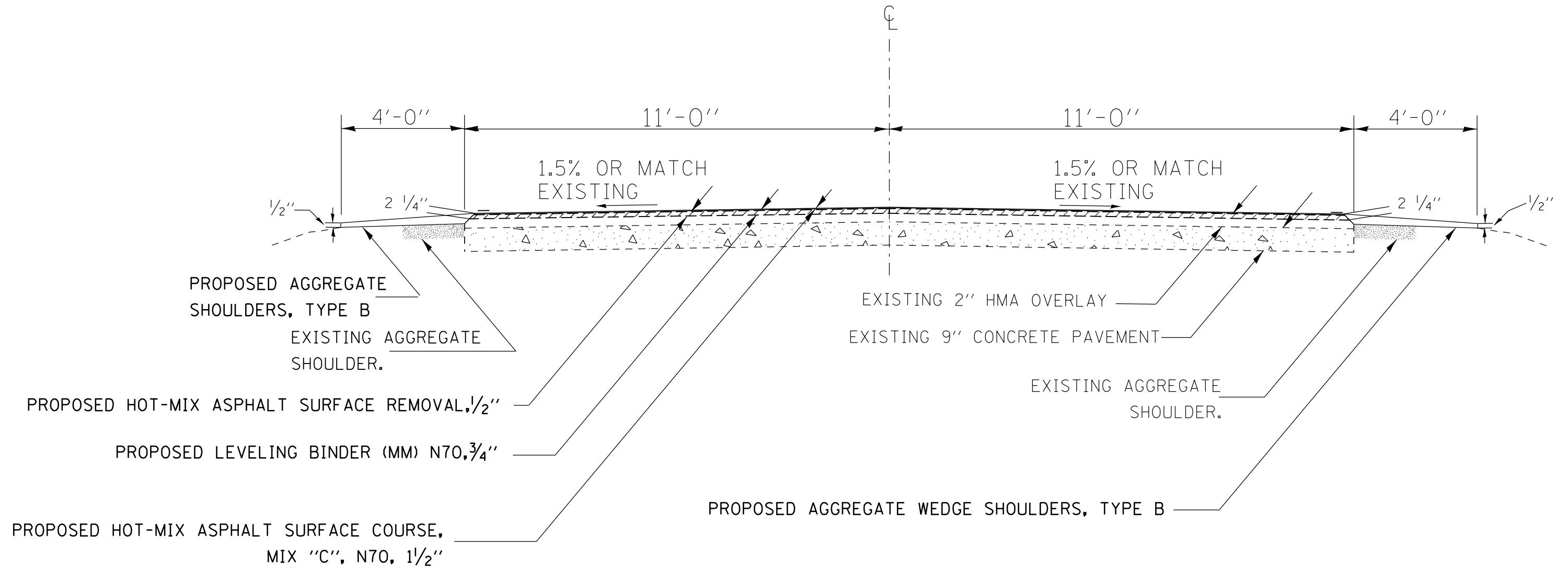

TO BE USED:

FROM	TO
STA. 149+70	STA. 149+85
STA. 154+76	STA. 167+85
STA. 169+30	STA. 172+65
STA. 201+00	STA. 203+50
STA. 208+00	STA. 228+80
STA. 251+25	STA. 252+02
STA. 274+40	STA. 281+40

FILE NAME =	USER NAME = jacksonec	DESIGNED -	REVISED -	STATE OF ILLINOIS DEPARTMENT OF TRANSPORTATION	TYPICAL SECTIONS	F.A.P. RTE.	SECTION	COUNTY	TOTAL SHEETS	SHEET NO.
p:\11\084EBIDINTEG.illinois.gov\PIWIDOT\Documents\IDOT Offices\District 9\Projects\78558\Drawings\CAD\Sheets\78558 Sheet	DRAWN	CHECKED -	REVISED -			132	12RS-4	POPE	26	9
Default	PLOT DATE = 2/7/2017	DATE -	REVISED -		SCALE:	SHEET OF SHEETS		STA. TO STA.		CONTRACT NO. 78558
ILLINOIS FED. AID PROJECT										

# TYPICAL SECTION

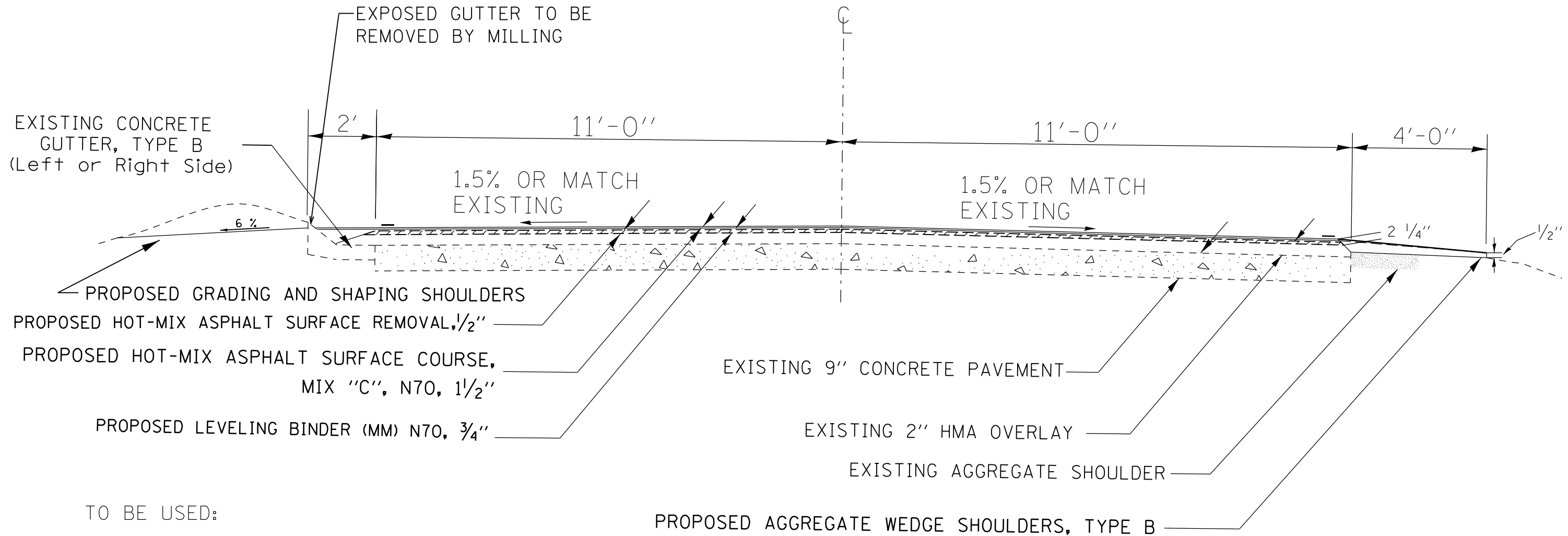

TO BE USED:

FROM	TO	GUTTER
STA. 112+75	STA. 112+94	(LT)
STA. 119+47	STA. 149+70	(LT)
STA. 149+85	STA. 154+76	(LT)
STA. 167+85	STA. 169+30	(LT)
STA. 172+65	STA. 179+76	(RT)
STA. 183+80	STA. 201+00	(RT)
STA. 203+50	STA. 204+60	(RT)
STA. 228+80	STA. 241+76	(RT)
STA. 251+14	STA. 251+25	(LT)
STA. 252+02	STA. 274+40	(RT)

# IL 145 MAINLINE RESURFACING SCHEDULE

LOCATION STATION TO STATION			LENGTH	ROADWAY WIDTH	HOT-MIX ASP. SURF. REMOV. - BUTT JT.	TEMP RAMP	HMA SUR. REMOVAL 1/2" **	HOT-MIX ASP. SUR. CSE., MIX C, N 70 (1 1/2") **	LEVELING BINDER (MM) N70 (3/4") **	BIT. MAT. (TACK COAT) *	HOT-MIX ASPHALT SHOULDLERS	NOTES	
			FOR INFORMATIONAL PURPOSE ONLY										
	(FT)	(FT)	(SQ YD)	(SQ YD)	(SQ YD)	(TON)	(TON)	(LBS)	(TON)				
<b>MAINLINE: STA.112+75 TO STA. 285+95</b>													
	112+75.00	TO	119+47.00			49	12						
LT	112+75.00	TO	119+47.00	672	11			821	70	35	554		
RT	112+75.00	TO	119+47.00	672	11			821	70	35	554		
	119+47.00	TO	140+00.00										
LT	119+47.00	TO	140+00.00	2053	11			2509	213	106	1,694		
RT	119+47.00	TO	140+00.00	2053	11			2509	213	106	1,694		
LT	140+00.00	TO	150+06.00	1006	11			1230	105	52	830		
RT	140+00.00	TO	150+06.00	1006	11			1230	105	52	830		
<b>STA. EQ. STA. 150+06 BK=STA.149+36 AH</b>													
LT	149+36.00	TO	154+82.00	546	11			667	57	29	450		
RT	149+36.00	TO	154+82.00	546	11			667	57	29	450		
	154+82.00		155+17.00										
LT	154+82.00	TO	155+17.00	35	12			47	3	0	32	14	HMA SHOULDERS STA.154+21 TO STA. 157+26
RT	154+82.00	TO	155+17.00	35	12			47	3	0	32	14	HMA SHOULDERS STA.152+78 TO STA. 155+70
	155+17.00	TO	170+11.00										
LT	155+17.00	TO	170+11.00	1494	11			1,869	155	77	1,233	25	HMA SHOULDERS STA.169+30 TO STA. 173+70
RT	155+17.00	TO	170+11.00	1494	11	80	20	1882	155	77	1,233	26	HMA SHOULDERS STA.168+00 TO STA. 172+65
<b>OMISSION: STRUCTURAL NUMBER 076-0015</b>													
	171+88.00	TO	211+00.00			80	20						STA. 170+11 TO STA. 171+88
	171+88.00	TO	211+00.00										BOX CULVERT (SN 076-2003) STA. 211+00
LT	171+88.00	TO	211+00.00	3912	11			4802	406	201	3,227		
RT	171+88.00	TO	211+00.00	3912	11			4790	406	201	3,227		
	211+00.00	TO	250+00.00										
LT	211+00.00	TO	250+00.00	3900	11			4767	405	201	3,218		
RT	211+00.00	TO	250+00.00	3900	11			4767	405	201	3,218		
LT	250+00.00	TO	285+95.00	3595	11			4394	373	185	2,966		
RT	250+00.00	TO	285+95.00	3595	11	49	12	4394	373	185	2,966		
<b>MAINLINE TOTALS</b>						<b>258</b>	<b>64</b>	<b>42,212</b>	<b>3,574</b>	<b>1,772</b>	<b>28,407</b>	<b>79</b>	

**\*NOTE: SEE GUTTER SCHEDULE, SIDE ROAD, AND ENTRANCE SCHEDULES FOR ADDITIONAL QUANTITIES**

**\*\*NOTE: SEE GUTTER SCHEDULE FOR ADDITIONAL QUANTITIES**

FILE NAME -	USER NAME - jacksonc	DESIGNED -	REVISED -	<b>STATE OF ILLINOIS</b>	<b>IL 145 MAINLINE RESURFACING SCHEDULE</b>	F.A.P. RTE.	SECTION	COUNTY	TOTAL SHEETS	SHEET NO.
pw:\IL\084EBIDINTEG\illinois.gov\PWIDOT\Documents\DOT Offices\District 9\Projects\78558\DRAWING\CAD\Sheets\78558 Sheet				<b>DEPARTMENT OF TRANSPORTATION</b>		132	12RS-4	POPE	26	11
Default	PLOT SCALE = 100.0000' / in.	CHECKED -	REVISED -			CONTRACT NO. 78558				
	PLOT DATE = 2/7/2017	DATE -	REVISED -		SCALE:	SHEET OF SHEETS		STA.	TO STA.	
						ILLINOIS FED. AID PROJECT				

# IL 145 PATCHING SCHEDULE

LOCATION	WIDTH	LENGTH	AREA	CLASS C PATCHES, TYPE I, 11 INCH	CLASS C PATCHES, TYPE II, 11 INCH
	FOOT	FOOT	SQ YD	SQ YD	SQ YD
<b>SOUTHBOUND LANE</b>					
	11	4	5	5	0
	11	4	5	5	0
	11	4	5	5	0
	11	4	5	5	0
	11	4	5	5	0
	11	4	5	5	0
	11	6	7	0	7
	11	5	6	0	6
	11	5	6	0	6
	11	4	5	5	0
	11	5	6	0	6
	11	4	5	5	0
	11	4	5	5	0
	11	4	5	5	0
	11	4	5	5	0
	11	4	5	5	0
	11	4	5	5	0
	11	4	5	5	0
	11	4	5	5	0
	11	4	5	5	0
	11	4	5	5	0
	11	5	6	0	6
	11	4	5	5	0
	6	6	4	4	0
	11	4	5	5	0
	11	4	5	5	0
	11	4	5	5	0
	11	4	5	5	0
	4	15	7	0	7
	11	4	5	5	0
	11	4	5	5	0
	11	4	5	5	0
	11	4	5	5	0
	4	15	7	0	7
	4	4	2	2	0
	11	6	7	0	7
	11	5	6	0	6
	6	5	3	3	0
	10	4	4	4	0
<b>SOUTHBOUND TOTAL</b>				<b>136</b>	<b>59</b>

# IL 145 PATCHING SCHEDULE

LOCATION	LENGT	WIDTH	AREA	CLASS C PATCHES, TYPE I, 11 INCH	CLASS C PATCHES, TYPE II, 11 INCH	CLASS C PATCHES, TYPE III, 11 INCH
	FOOT	FOOT	SQ YD	SQ YD	SQ YD	SQ YD
<b>NORTHBOUND LANE</b>						
	11	4	5	5	0	0
	11	4	5	5	0	0
	11	5	6	0	6	0
	11	4	5	5	0	0
	11	4	5	5	0	0
	11	15	18	0	0	18
	11	4	5	5	0	0
	11	4	5	5	0	0
	11	8	10	0	10	0
	11	6	7	0	7	0
	11	5	6	0	6	0
	11	4	5	5	0	0
	11	4	5	5	0	0
	11	4	5	5	0	0
	11	6	7	0	7	0
	11	4	5	5	0	0
	11	4	5	5	0	0
	11	4	5	5	0	0
	11	4	5	5	0	0
	11	4	5	5	0	0
	11	4	5	5	0	0
	11	4	5	5	0	0
	11	4	5	5	0	0
	11	4	5	5	0	0
	11	8	10	0	10	0
	11	6	7	0	7	0
	11	4	5	5	0	0
	6	6	4	4	0	0
	6	6	4	4	0	0
	6	4	3	3	0	0
	6	6	4	4	0	0
	11	4	5	5	0	0
	11	4	5	5	0	0
	11	5	6	0	6	0
	11	5	6	0	6	0
	5	15	8	0	8	0
	5	4	2	2	0	0
	11	4	5	5	0	0
	4	8	4	4	0	0
<b>NORTHBOUND TOTAL</b>				<b>118</b>	<b>74</b>	<b>18</b>
<b>PROJECT TOTAL</b>				<b>254</b>	<b>133</b>	<b>18</b>

# GUTTER SCHEDULE

LOCATION STATION TO STATION				GUTTER LENGTH	ROADWAY WIDTH	HMA SURFACE REMOVAL 1/2" **	LEVELING BINDER (MM) N70 (3/4") **	BIT MAT. (TACK COAT) *	GRADING AND SHAPING	HOT-MIX ASP. SUR. CSE., MIX C, N 70 (1 1/2") **	
				FOR INFORMATIONAL PURPOSE ONLY							
				(FT)	(FT)	(SQ YD)	(TON)	(LBS)	(UNIT)	(TON)	
<b>MAINLINE: STA.112+75 TO STA. 285+95</b>											
						280					
LT	122+75.00	TO	149+70.00	2695	2	599	26	405	2695		
RT	112+94.00	TO	119+47.00	653	2	145	7	98	653	26	
		TO									
LT	149+85.00	TO	154+76.00	491	2	109	5	74	491	20	
RT	+0.00	TO	+0.00	0	2	0	0	0	0	0	
		TO									
LT	167+85.00	TO	169+30.00	145	2	32	2	22	145	6	
RT	+0.00	TO	+0.00	0	2	0	0	0	0	0	
		TO									
LT	179+76.00	TO	183+80.00	404	2	90	4	61	404	16	
RT	172+65.00	TO	201+00.00	2835	2	630	27	426	2835	113	
		TO									
LT	204+60.00	TO	208+00.00	340	2	76	4	51	340	14	
RT	203+50.00	TO	208+00.00	450	2	100	5	68	450	18	
		TO									
LT	+0.00	TO	+0.00	0	2	0	0	0	0	0	
RT	228+80.00	TO	230+00.00	120	2	27	2	18	120	5	
		TO									
LT	241+76.00	TO	251+25.00	949	2	211	9	143	949	38	
RT	230+00.00	TO	251+14.00	2114	2	470	20	318	2114	84	
		TO									
LT	+0.00	TO	+0.00	0	2	0	0	0	0	0	
RT	252+02.00	TO	260+00.00	798	2	177	8	120	798	32	
		TO									
LT	+0.00	TO	+0.00	0	2	0	0	0	0	0	
RT	260+00.00	TO	274+40.00	1440	2	320	14	216	1440	57	
		TO									
LT	281+40.00	TO	285+95.00	455	2	101	5	69	455	18	
RT	281+40.00	TO	285+95.00	455	2	101	5	69	455	18	
		TO									
<b>SUBTOTAL</b>						<b>3,468</b>	<b>143</b>	<b>2,158</b>	<b>143</b>	<b>463</b>	

\* NOTE: MAINLINE RESURFACING, SIDE ROAD, AND ENTRANCE SCHEDULES FOR ADDITIONAL QUANTITIES.

\*\* NOTE: SEE MAINLINE RESURFACING SCHEDULE FOR ADDITIONAL QUANTITIES.

# AGGREGATE WEDGE SHOULDERS SCHEDULE

LOCATION STATION TO STATION				SHOULDER LENGTH	AGGREGATE SHOULDER WIDTH	AGGREGATE WEDGE SHOULDERS, TYPE B
				FOR INFORMATIONAL PURPOSE ONLY		
				(FT)	(FT)	(TON)
<b>MAINLINE: STA.112+75 TO STA. 285+95</b>						
LT	+0.00	TO	+0.00	0	4	0
RT	112+75.00	TO	112+94.00	19	4	1
LT	149+70.00	TO	149+85.00	15	4	1
RT	119+47.00	TO	152+78.00	3331	4	190
LT	157+26.00	TO	167+85.00	1059	4	60
RT	155+70.00	TO	168+00.00	1230	4	70
LT	173+70.00	TO	179+76.00	606	4	35
RT	+0.00	TO	+0.00	0	4	0
LT	183+80.00	TO	204+60.00	2080	4	118
RT	201+00.00	TO	203+50.00	250	4	15
LT	208+00.00	TO	241+76.00	3376	4	192
RT	208+00.00	TO	228+80.00	2080	4	118
LT	251+14.00	TO	281+40.00	3026	4	172
RT	251+14.00	TO	252+02.00	88	4	5
LT	+0.00	TO	+0.00	0	4	0
RT	274+00.00	TO	281+40.00	740	4	42
<b>TOTAL</b>						<b>1,019</b>

## SIDE ROAD SCHEDULE

LOCATION		EXIST. SURFACE FOR	INCIDENTAL HMA SURFACING	BIT. MAT. (TACK COAT) *
			(TON)	(LBS)
<b>FAP 132 (L 145)</b>				
Rt.	Airport Road	Oil & Chip	14	214
Rt.	East Sheep Barn Road	Oil & Chip	10	188
Lt.	Lake Glendale Road	Oil & Chip	9	135
Lt.	Franks Road	Oil & Chip	7	96
<b>TOTALS</b>			<b>40</b>	<b>633</b>

## ENTRANCE SCHEDULE

ENTRANCE TYPE	NUMBER OF ENTRANCES	EXIST. SURFACE FOR	EP WIDTH	INCIDENTAL HMA SURFACING	BIT. MAT. (TACK COAT) *
		(TYPE)	(FT)	(TON)	(LBS)
PE	12	Agg.	24.0	6	48
PE	2	O&C	24.0	1	8
PE	2	Bit	24.0	1	8
PE	10	Agg.	24.0	5	42
PE	2	PCC	35.0	2	13
<b>TOTALS</b>				<b>15</b>	<b>119</b>

\* NOTE: SEE MAINLINE AND GUTTER SCHEDULES FOR ADDITIONAL QUANTITIES.

# PAVEMENT MARKING SCHEDULE

IL 145 (Pope County) LOCATION STATION TO STATION			LENGTH	DESCRIPTION	PAINT PAVEMENT MARKING			SHORT TERM PVMT MRK	TEMP PVMT MRK	SHORT TERM PAVT MK REM	RAISED REF PVMT MKR	RAISED REF PVMT MKR REMOVAL	
					SOLID WHITE 4"	LINE - YELLOW 4"							
						LEFT SOLID	CENTER DASHED						RIGHT SOLID
STA	TO	STA	FEET		FT	FT	FT	FT	FT	SQ FT	EACH	EACH	
STA 112+75.00	TO STA 119+47.00		672	HMA	1344		168	462	202	1974	67	8	8
STA 119+47.00	TO STA 140+00.00		2053	HMA	4106	1385	167	2053	616	7711	205	26	26
STA 140+00.00	TO STA 150+06.00		1006	HMA	2012	1006	249	9	302	3276	101	13	13
STA 149+36.00	TO STA 155+17.00		581	HMA	1162	309	145		174	1616	58	7	7
STA 155+17.00	TO STA 171+88.00		1671	HMA	3342		418		501	3760	167	21	21
STA 171+88.00	TO STA 211+00.00		3912	HMA	7824	1421	900	1442	1174	11587	391	49	49
STA 211+00.00	TO STA 250+00.00		3900	HMA	7800		975	831	1170	9606	390	49	49
STA 250+00.00	TO STA 285+95.00		3595	HMA	7190	2140	608	2359	1079	12297	360	45	45
<b>TOTALS</b>					<b>34780</b>	<b>6261</b>	<b>3631</b>	<b>7156</b>	<b>5217</b>	<b>51828</b>	<b>1739</b>	<b>217</b>	<b>217</b>
					<b>51828</b>								

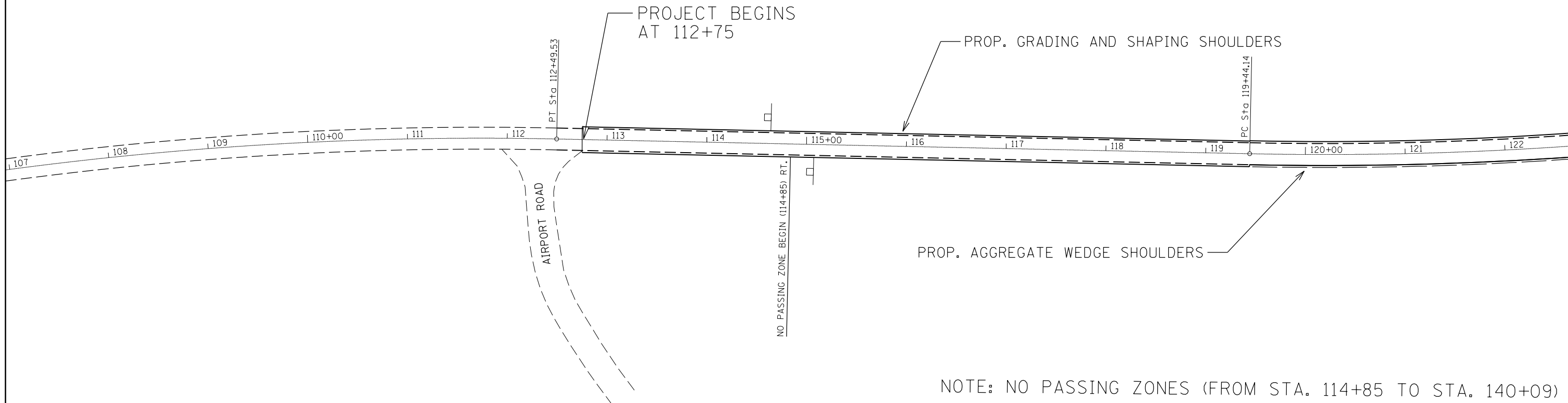

NOTE: NO PASSING ZONES (FROM STA. 114+85 TO STA. 140+09)

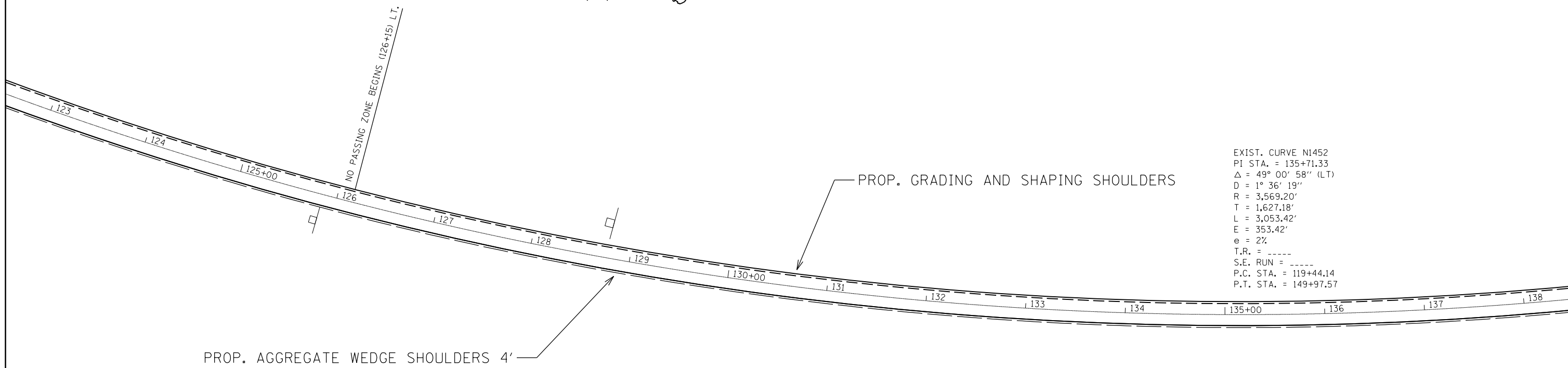

EXIST. CURVE N1452  
 PI STA. = 135+71.33  
 $\Delta$  = 49° 00' 58" (LT)  
 D = 1° 36' 19"  
 R = 3,569.20'  
 T = 1,627.18'  
 L = 3,053.42'  
 E = 353.42'  
 e = 2%  
 T.R. = -----  
 S.E. RUN = -----  
 P.C. STA. = 119+44.14  
 P.T. STA. = 149+97.57

NOTE: NO PASSING ZONES (FROM STA. 126+15 TO STA. 152+45)

FILE NAME =	USER NAME = jacksonec	DESIGNED -	REVISED -	<b>STATE OF ILLINOIS DEPARTMENT OF TRANSPORTATION</b>	<b>DESIGN DETAILS</b>			F.A.P. RTE.	SECTION	COUNTY	TOTAL SHEETS	SHEET NO.
pw:\IL\084EBIDINTEG.illinois.gov\PWIDOT\Documents\IDOT Offices\District 9\Projects\78558\Drawings\CAD\Sheets\78558 Sheet	PLOT SCALE = 100.0000' / in.	CHECKED -	REVISED -					132	12RS-4	POPE	26	16
Default	PLOT DATE = 2/7/2017	DATE -	REVISED -		SCALE: SHEET OF SHEETS STA. 107+00 TO STA. 138+00			CONTRACT NO. 78558				
							ILLINOIS FED. AID PROJECT					



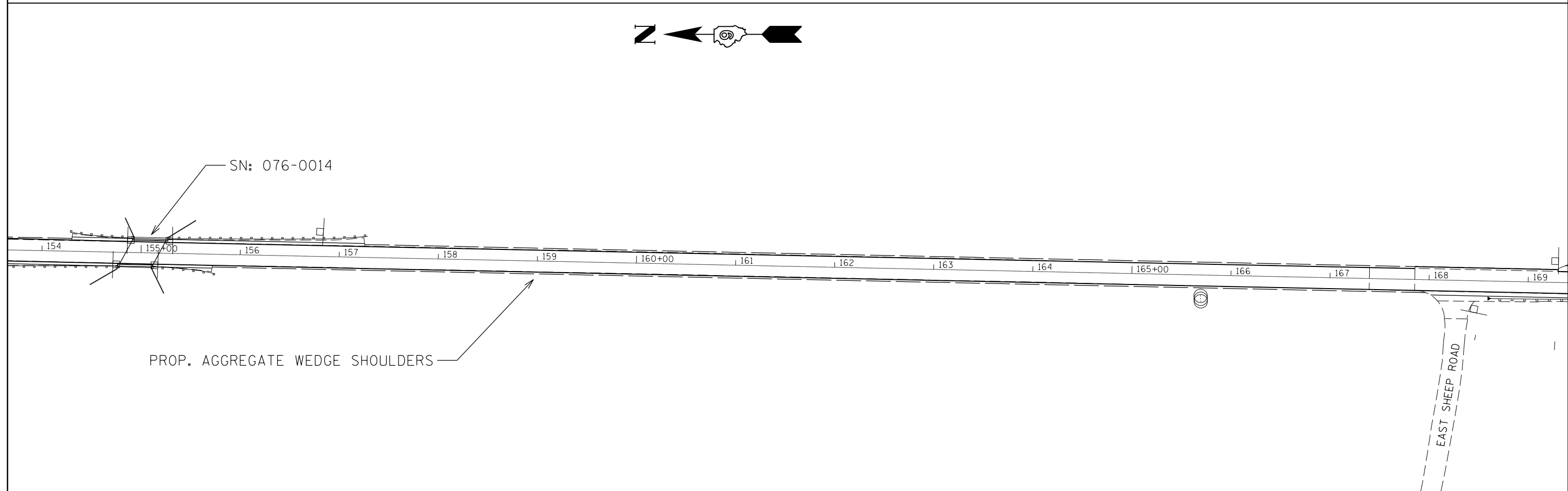
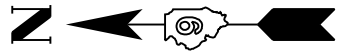
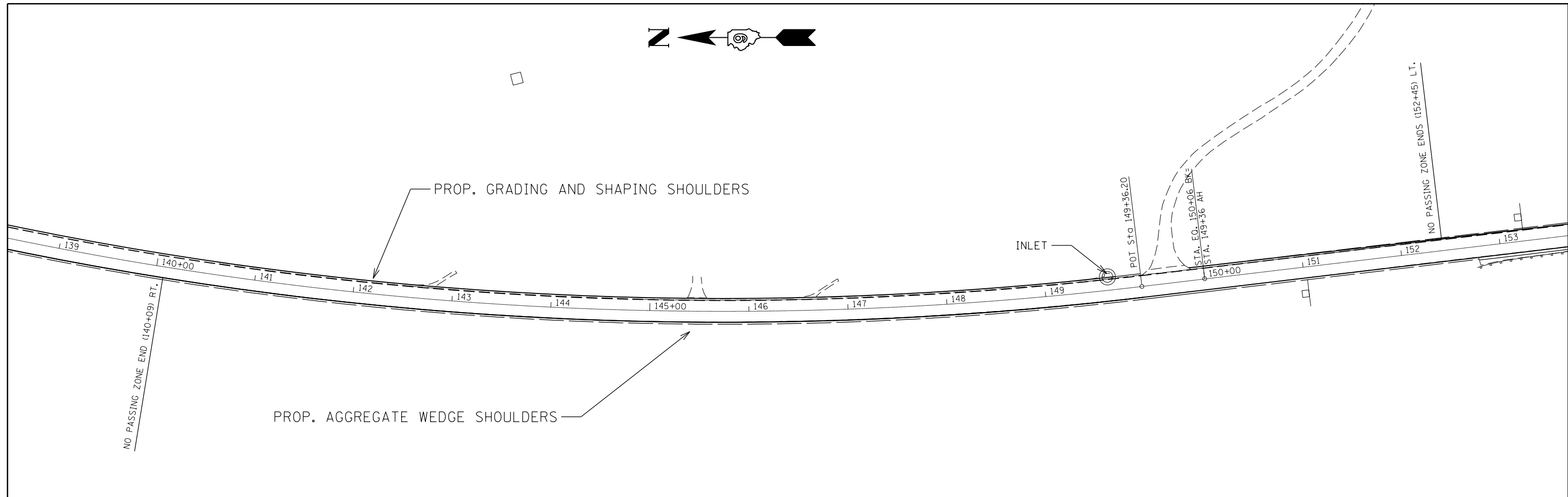

FILE NAME =	USER NAME = jacksonc	DESIGNED -	REVISED -
p:\11084EBIDINTEG.illinois.gov\PIWIDOTDocuments\IDOT Offices\District 9\Projects\78558\DRAWING\CAD\Sheets\78558 Sheet		DRAWN -	REVISED -
Default	PLOT SCALE = 100.0000' / in.	CHECKED -	REVISED -
	PLOT DATE = 2/7/2017	DATE -	REVISED -

**STATE OF ILLINOIS  
DEPARTMENT OF TRANSPORTATION**

**DESIGN DETAILS**

SCALE: SHEET OF SHEETS STA. 138+00 TO STA. 169+00

F.A.P. RTE.	SECTION	COUNTY	TOTAL SHEETS	SHEET NO.
132	12RS-4	POPE	26	17
CONTRACT NO. 78558				
ILLINOIS FED. AID PROJECT				

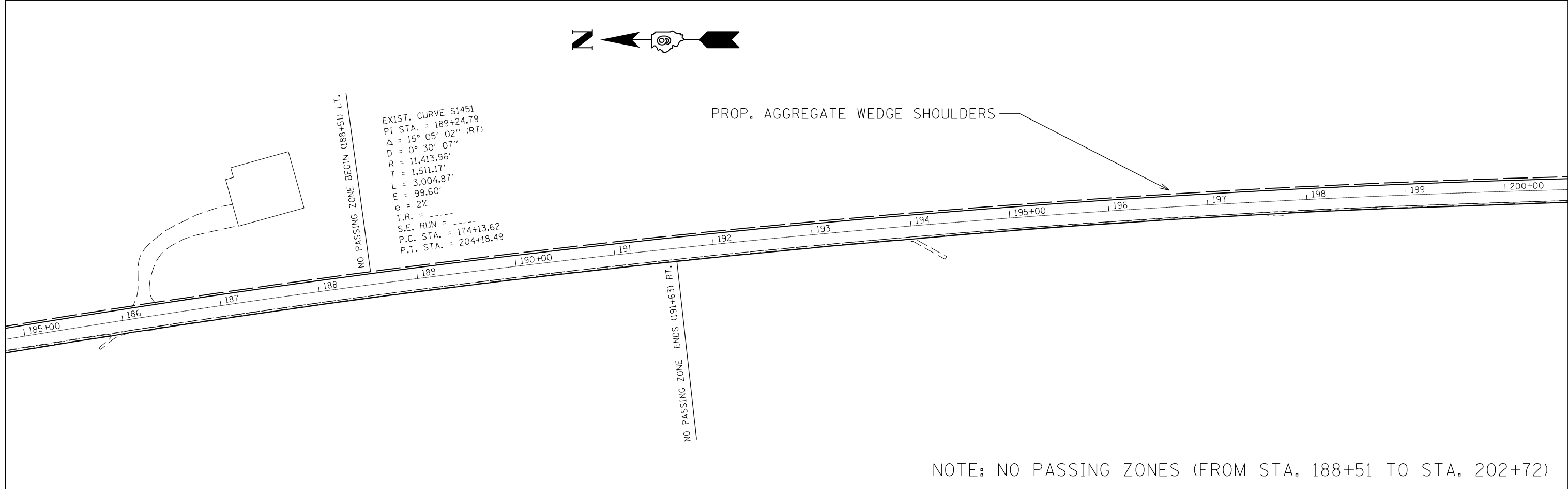
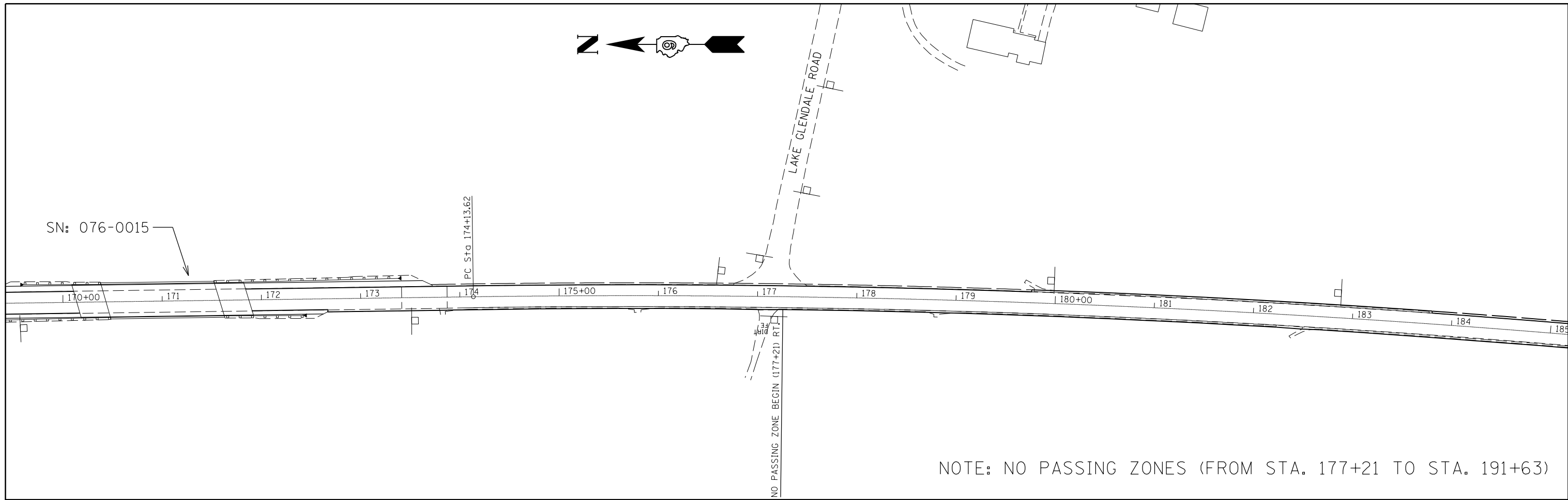

FILE NAME =	USER NAME = jacksonec	DESIGNED -	REVISED -
pw:\IL\084EBIDINTEG.illinois.gov\PIWIDOT\Documents\IDOT Offices\District 9\Projects\78558\Drawings\CAD\Sheets\78558 Sheet		DRAWN -	REVISED -
Default	PLOT SCALE = 100.0000' / in.	CHECKED -	REVISED -
	PLOT DATE = 2/7/2017	DATE -	REVISED -

**STATE OF ILLINOIS  
DEPARTMENT OF TRANSPORTATION**

DESIGN DETAILS			
SCALE:	SHEET	OF	SHEETS
			STA. 169+00 TO STA. 200+00

F.A.P. RTE.	SECTION	COUNTY	TOTAL SHEETS	SHEET NO.
132	12RS-4	POPE	26	18
CONTRACT NO. 78558				
ILLINOIS FED. AID PROJECT				

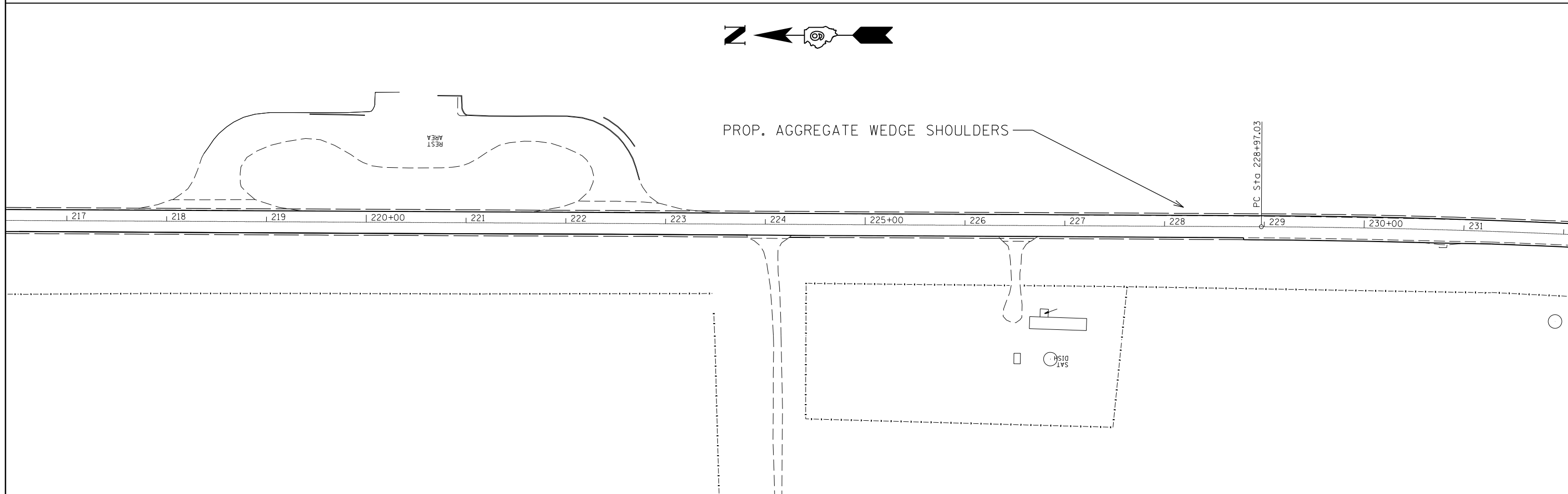
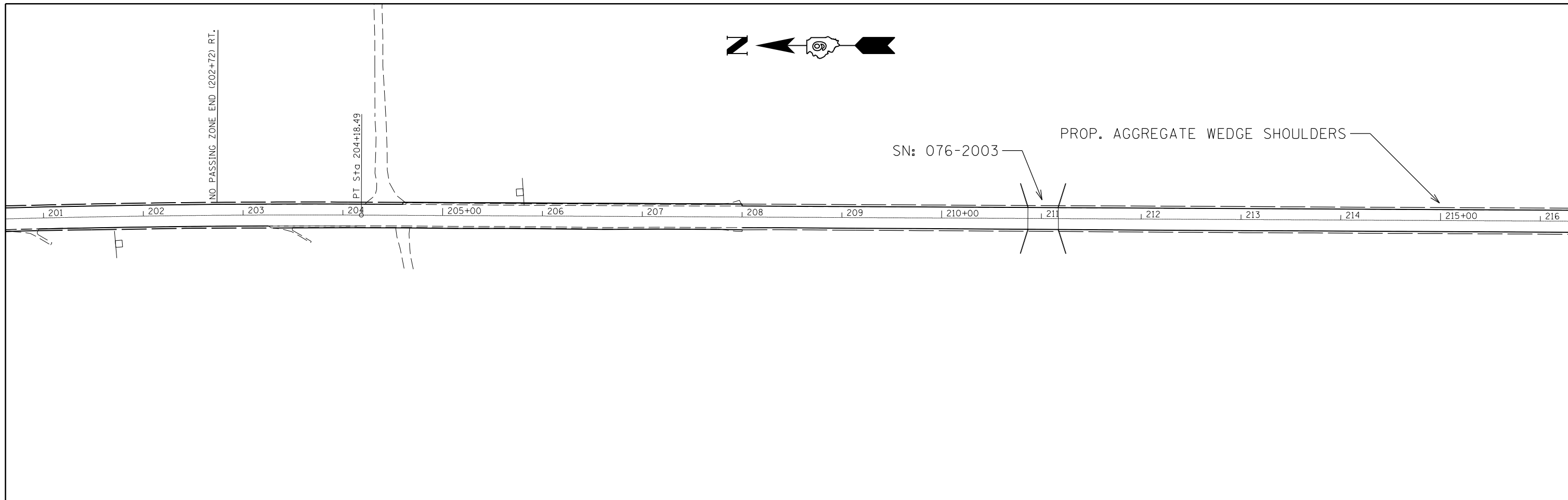

FILE NAME =	USER NAME = jacksonec	DESIGNED -	REVISED -	<b>STATE OF ILLINOIS DEPARTMENT OF TRANSPORTATION</b>	<b>DESIGN DETAILS</b>			F.A.P. RTE.	SECTION	COUNTY	TOTAL SHEETS	SHEET NO.
pw:\IL\084EBIDINTEG.illinois.gov\PWIDOT\Documents\IDOT Offices\District 9\Projects\78558\Drawings\CAD\Sheets\78558 Sheet	PLOT SCALE = 100.0000' / in.	CHECKED -	REVISED -					132	12RS-4	POPE	26	19
Default	PLOT DATE = 2/7/2017	DATE -	REVISED -		SCALE: SHEET OF SHEETS STA. 200+00 TO STA. 231+00			CONTRACT NO. 78558				
							ILLINOIS FED. AID PROJECT					

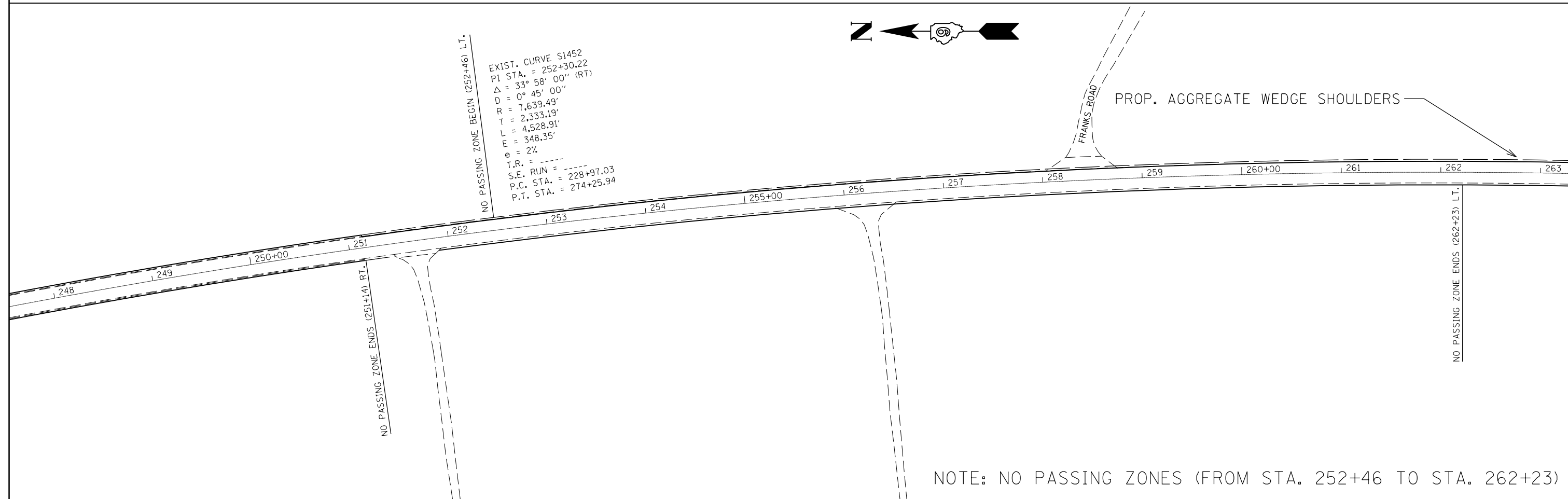
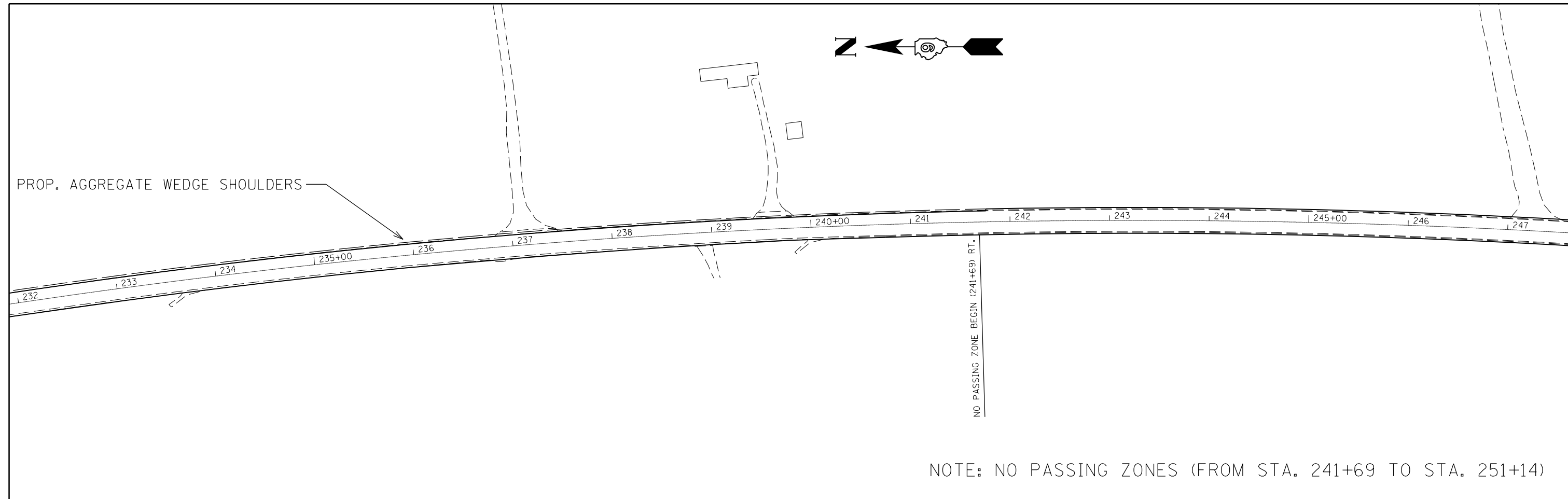

FILE NAME =	USER NAME = jacksonec	DESIGNED -	REVISED -	<b>STATE OF ILLINOIS DEPARTMENT OF TRANSPORTATION</b>	<b>DESIGN DETAILS</b>			F.A.P. RTE.	SECTION	COUNTY	TOTAL SHEETS	SHEET NO.
pw:\IL\084EBIDINTEG.illinois.gov\PWIDOT\Documents\IDOT Offices\District 9\Projects\78558\Drawings\CAD\Sheets\78558 Sheet	PLOT SCALE = 100.0000' / in.	CHECKED -	REVISED -					132	12RS-4	POPE	26	20
Default	PLOT DATE = 2/7/2017	DATE -	REVISED -		SCALE: SHEET OF SHEETS STA. 232+00 TO STA. 263+00			CONTRACT NO. 78558				
ILLINOIS FED. AID PROJECT												

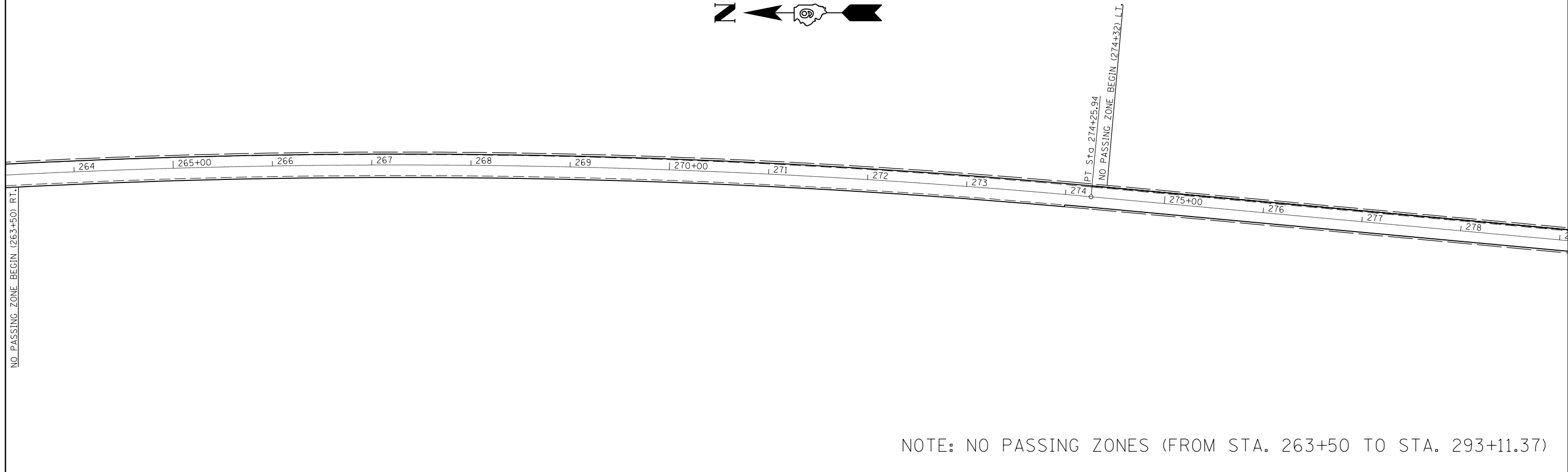

NOTE: NO PASSING ZONES (FROM STA. 263+50 TO STA. 293+11.37)

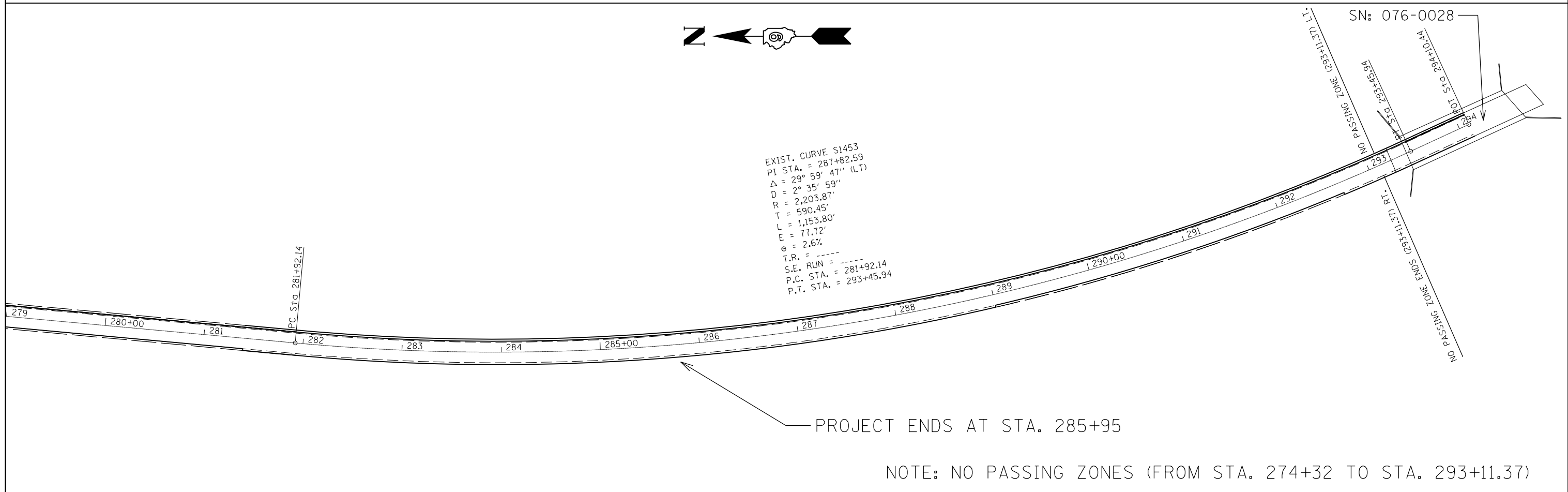

PROJECT ENDS AT STA. 285+95

NOTE: NO PASSING ZONES (FROM STA. 274+32 TO STA. 293+11.37)

FILE NAME =	USER NAME = jacksonc	DESIGNED -	REVISED -	<b>STATE OF ILLINOIS DEPARTMENT OF TRANSPORTATION</b>	<b>DESIGN DETAILS</b>			F.A.P. RTE.	SECTION	COUNTY	TOTAL SHEETS	SHEET NO.
pw:\IL\084EBIDINTEG.illinois.gov\PIWIDOT\Documents\IDOT Offices\District 9\Projects\78558\Drawings\CAD\Sheets\78558 Sheet		CHECKED -	REVISED -		132	12RS-4	POPE	26	21			
Default	PLOT SCALE = 100.0000' / in.	DATE -	REVISED -		SCALE: SHEET OF SHEETS STA. 263+00 TO STA. 294+00			CONTRACT NO. 78558				
	PLOT DATE = 2/7/2017				ILLINOIS FED. AID PROJECT							

DETAIL FOR BUTT JOINTS  
AT BEGINNING OF PROJECT

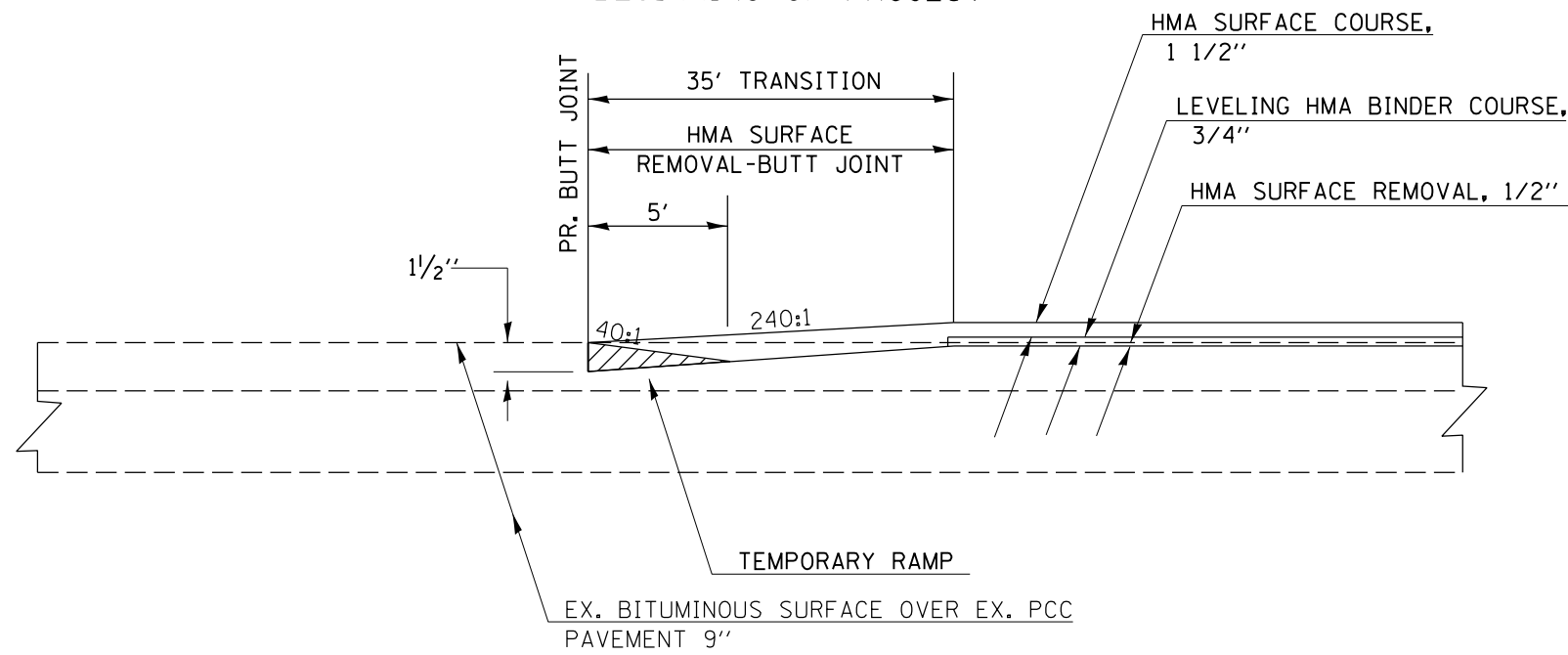

TO BE USED:  
STA. 125+75  
STA. 285+95

DETAIL FOR BUTT JOINTS AT BRIDGES

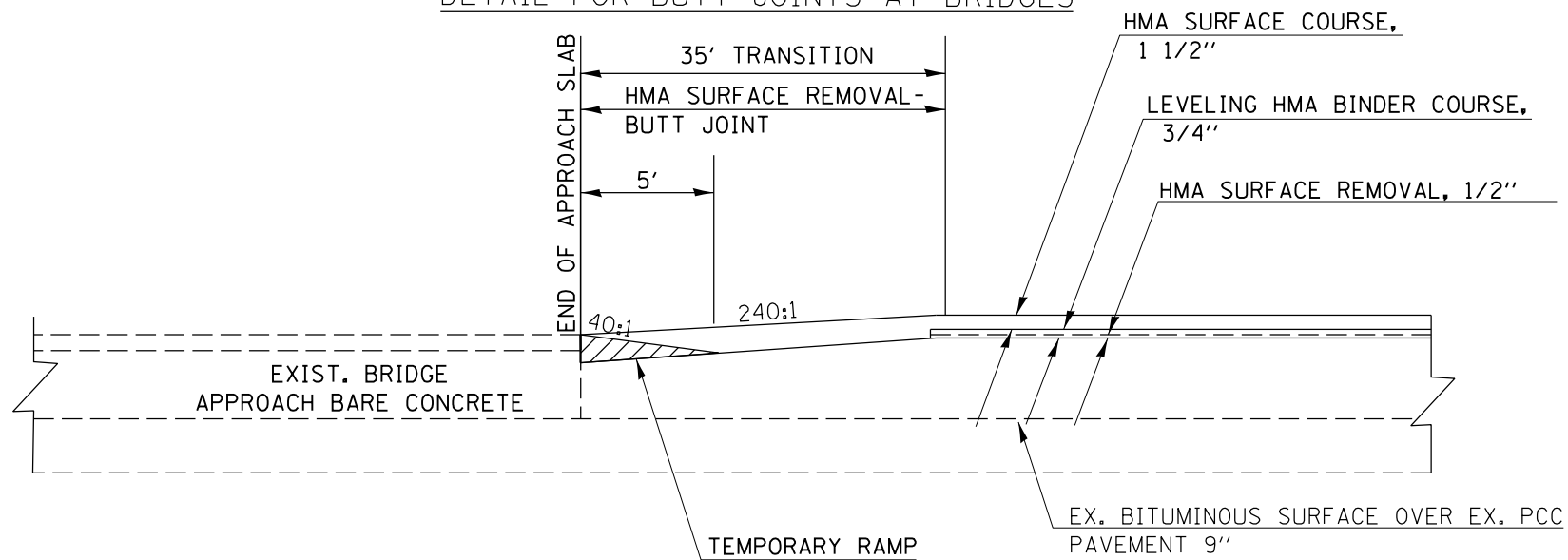

TO BE USED:  
STA. 170+11  
STA. 171+88

FILE NAME =	USER NAME = jacksonc	DESIGNED -	REVISED -	<b>STATE OF ILLINOIS DEPARTMENT OF TRANSPORTATION</b>	<b>DETAILS FOR INLAY AND BUTT JOINTS</b>			F.A.P. RTE.	SECTION	COUNTY	TOTAL SHEETS	SHEET NO.
p:\11084EBID\INTEG.illinois.gov\PI\DOT\Documents\DOT Offices\District 9\Projects\78558\Drawings\CAD\Sheets\78558 Sheet	PLotted SCALE = 100.0000' / 1in.	CHECKED -	REVISED -					132	12RS-4	POPE	26	22
Default	PLOT DATE = 2/7/2017	DATE -	REVISED -		SCALE: SHEET OF SHEETS STA. TO STA.			CONTRACT NO. 78558				
ILLINOIS FED. AID PROJECT												

DETAIL FOR HMA TRANSITION AT SN 076-0014

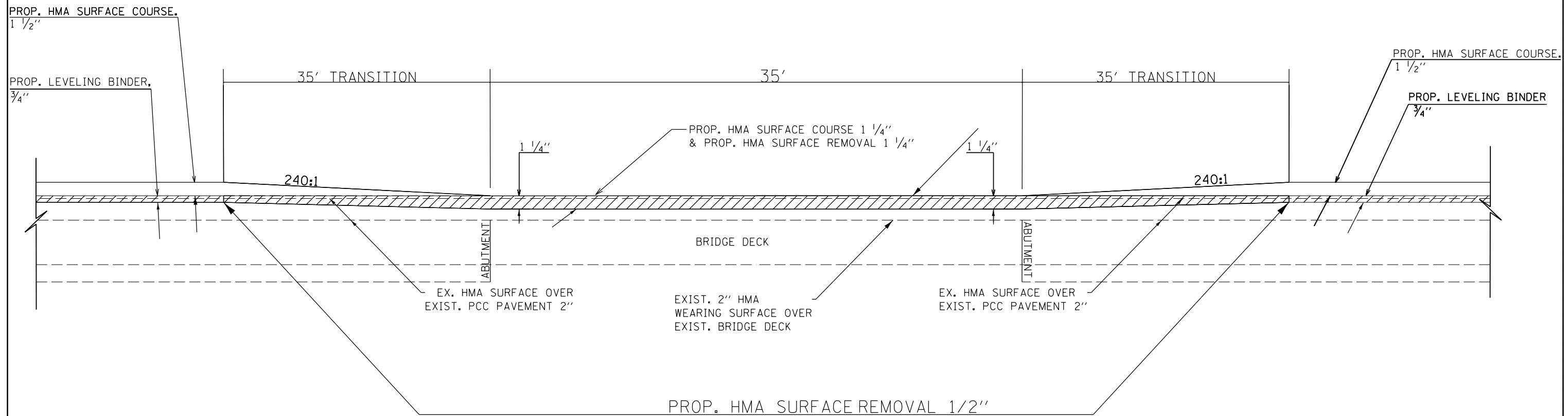

TO BE USED:  
STA. 152+82 TO STA. 155+17 (SN: 076-0014)

\* NOTE: MILLING HMA SHOULDERS INCLUDED IN TRANSITION DETAILS

FILE NAME =	USER NAME = jacksonec	DESIGNED -	REVISED -	<b>STATE OF ILLINOIS DEPARTMENT OF TRANSPORTATION</b>	<b>DETAILS FOR HMA TRANSITION UNDER STRUCTURES</b>			F.A.P. RTE.	SECTION	COUNTY	TOTAL SHEETS	SHEET NO.
p:\11\084EBIDINTEG.illinois.gov\PIWIDOT\Documents\IDOT Offices\District 9\Projects\78558\Drawings\CAD\Sheets\78558 Sheet	PLOT SCALE = 100.0000' / 1"	CHECKED -	REVISED -					132	12RS-4	POPE	26	23
Default	PLOT DATE = 2/7/2017	DATE -	REVISED -		SCALE: SHEET OF SHEETS STA. TO STA.			CONTRACT NO. 78558				
							ILLINOIS FED. AID PROJECT					

# TEMPORARY HOT-MIX ASPHALT TRANSITIONS

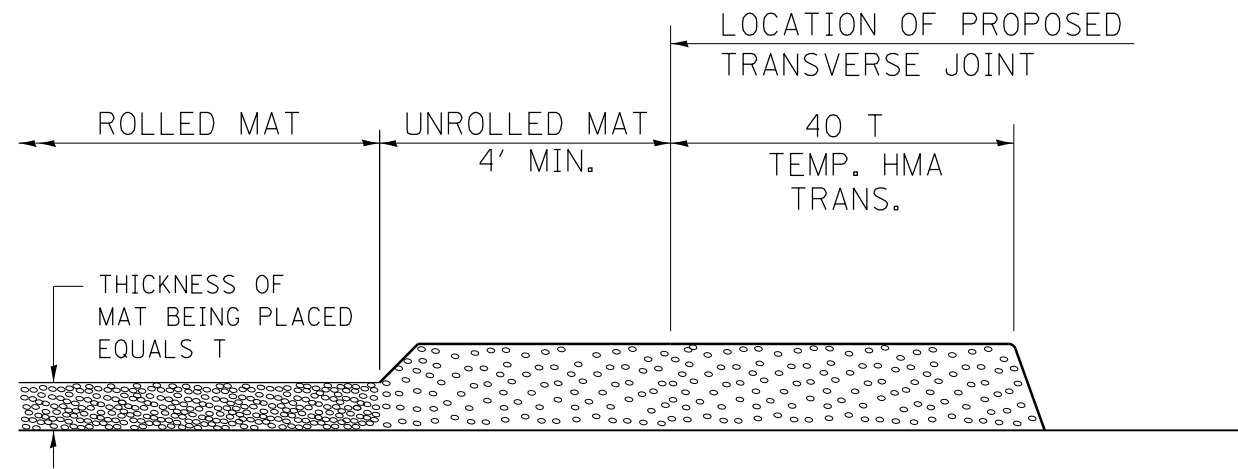

## STEP I

1. PLACE HOT-MIX ASPHALT MAT, LENGTH 40 TIMES THE THICKNESS OF THE MAT BEING PLACED PAST THE PROPOSED TRANSVERSE JOINT LOCATION USING NORMAL OPERATING PROCEDURES.
2. EXTREME CARE SHOULD BE TAKEN TO MAINTAIN ENOUGH MATERIAL IN FRONT OF THE SCREED TO MAINTAIN REQUIRED PAVING DEPTH.

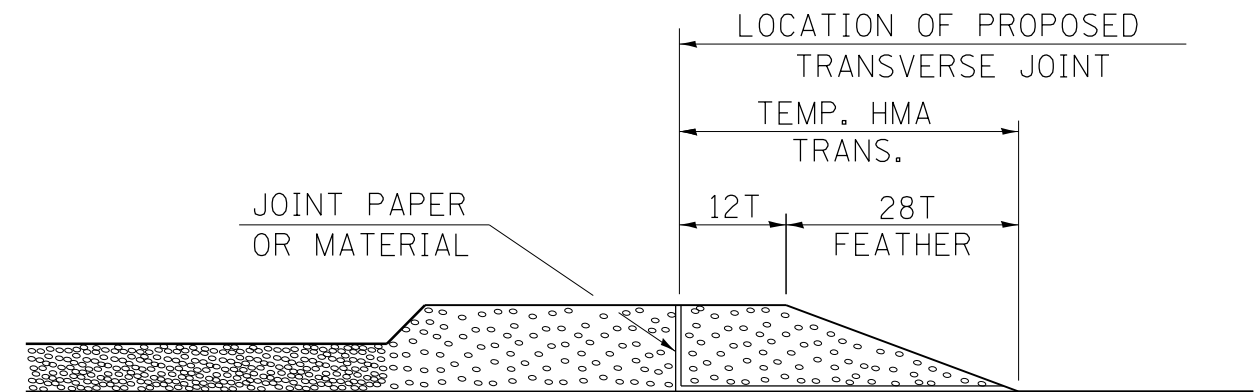

## STEP III

1. JOINT PAPER OR OTHER PRESELECTED JOINT MATERIAL IS THEN PLACED IN THE CLEARED AREA AND THE EXCESS ASPHALT USED TO HAND FORM A TRANSITION TO THE DIMENSIONS SHOWN ABOVE.
2. NOTE THAT IN CONSTRUCTING THE TRANSITION, THE MAT DEPTH IS CONTINUED AS PART OF THE TRANSITION BEFORE FORMING THE FEATHER.

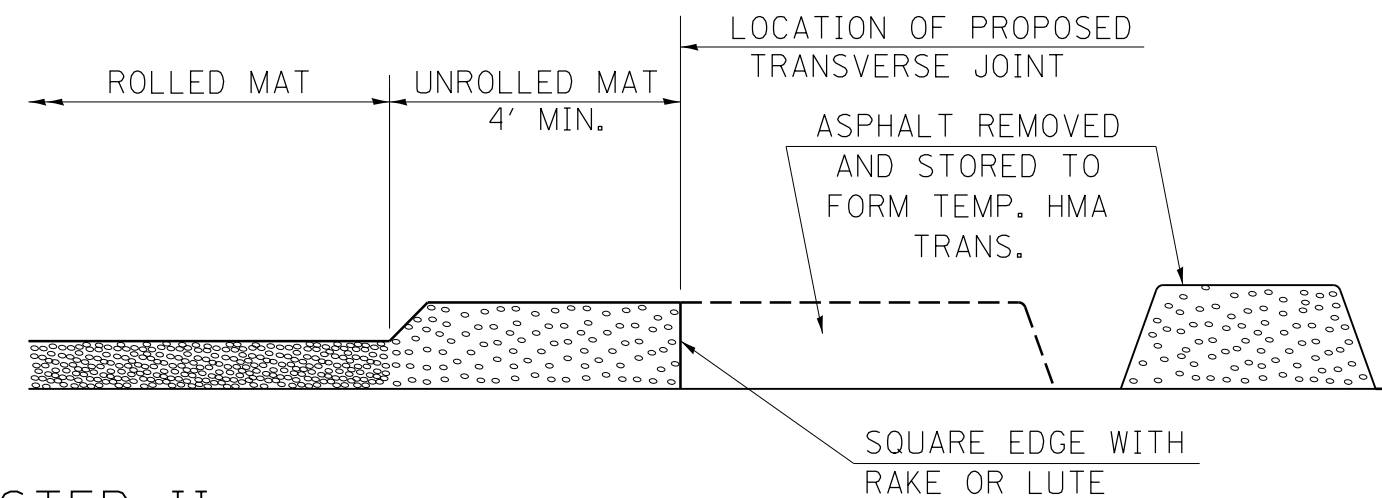

## STEP II

1. MOVE THE PAVER OUT OF THE WAY AND REMOVE THE ASPHALT FROM THE AREA OF THE PROPOSED TEMPORARY HOT-MIX ASPHALT TRANSITION.
2. SQUARE UP THE END OF THE MAT WITH A RAKE OR LUTE.
3. NOTE THAT THE MAT WITHIN 4' OF THE END OF JOINT IS NOT TO BE ROLLED AT THIS TIME.

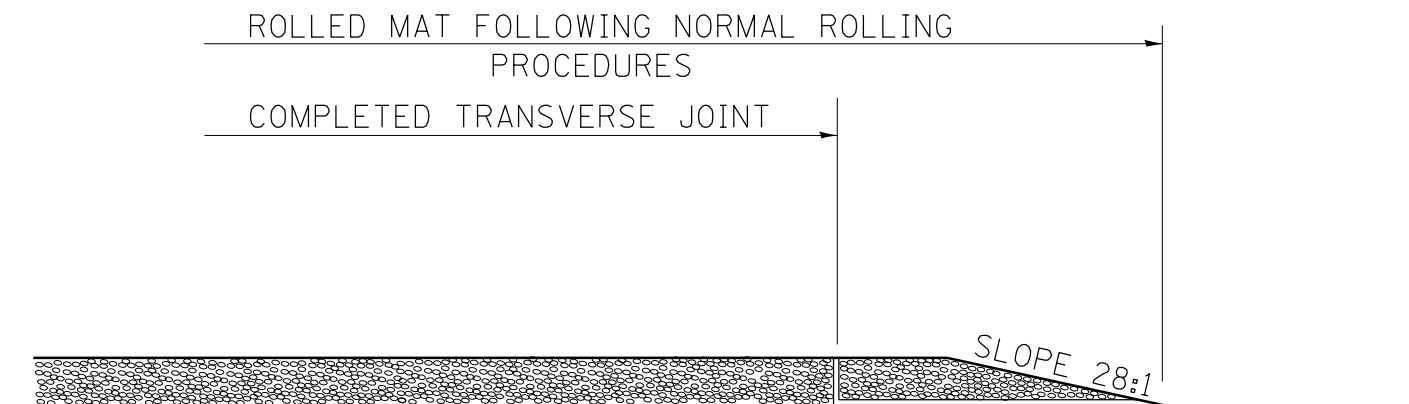

## STEP IV

1. COMPLETE TEMPORARY TRANSITION BY ROLLING.
2. TO RESUME PAVING, AT THE JOINT, REMOVE TEMPORARY TRANSITION AND DISPOSE OF THE MATERIAL ACCORDING TO ART. 202.03 OF THE STD. SPECS. (COST INCLUDED IN THE CONTRACT).
3. CONSTRUCTING THE TEMPORARY TRANSITIONS WILL NOT BE PAID FOR SEPARATELY IN ACCORDANCE WITH ARTICLE 406.14 OF THE STANDARD SPECIFICATIONS.

### REVISIONS

REDRAWN	2-15-89
REVISED	8-16-94
REVISED	01-09-07
RESIZED	05-8-08
REVISED	05-16-13

STD. 9-26

FILE NAME =	USER NAME = jacksonc	DESIGNED -	REVISED -
p:\11084EBIDINTEG.illinois.gov\PIWIDOT\Documents\DOT Offices\District 9\Projects\78558\Drawings\CADsheets\78558 Sheet		REVISION	REVISED -
Default	PLOT SCALE = 100.0000' / in.	CHECKED -	REVISED -
	PLOT DATE = 2/7/2017	DATE -	REVISED -

STATE OF ILLINOIS  
DEPARTMENT OF TRANSPORTATION

BUTT JOINT DETAIL AT RAMPS AND STRUCTURES

SCALE: SHEET OF SHEETS STA. TO STA.

F.A.P. RTE.	SECTION	COUNTY	TOTAL SHEETS	SHEET NO.
132	12RS-4	POPE	26	24
CONTRACT NO. 78558				
ILLINOIS FED. AID PROJECT				



# SIDEROAD AND ENTRANCE

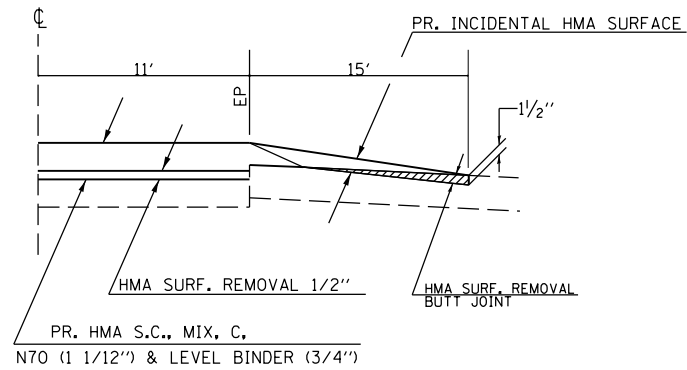

SIDEROAD SECTION B-B  
EX. BIT. OR CONC. SURFACE

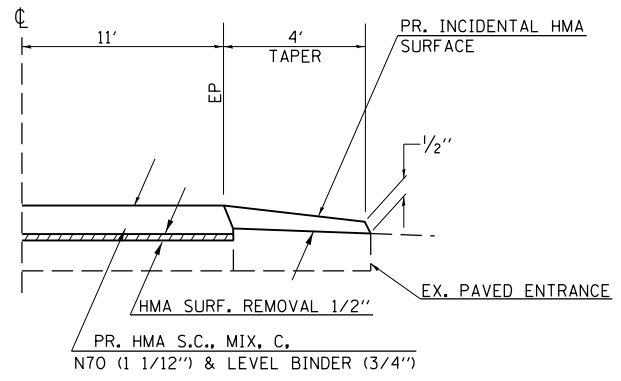

BIT. OR CONC. PE OR CE  
SIDEROAD SECTION A-A

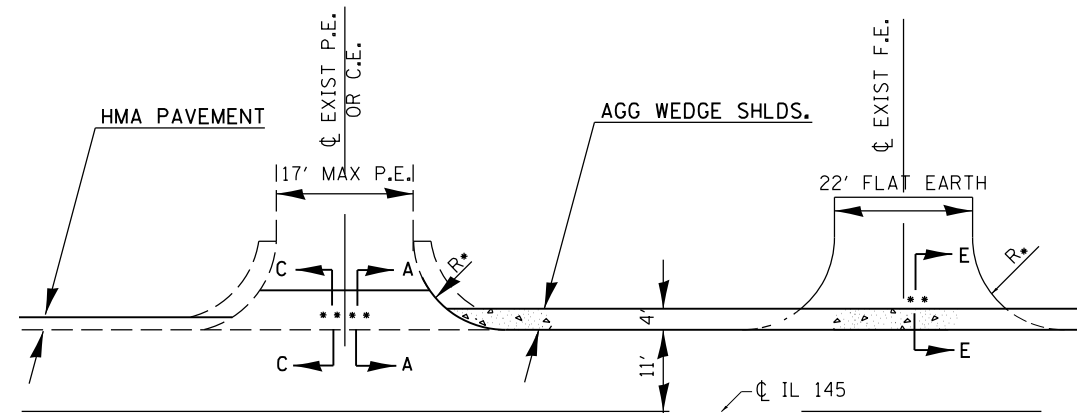

- MATCH EXISTING RADIUS
- RESURFACE AS INDICATED AT LEFT.

ENTRANCE SCHEDULE

TYPE	NUMBER OF ENTRANCES
P.E.	28
C.E.	0

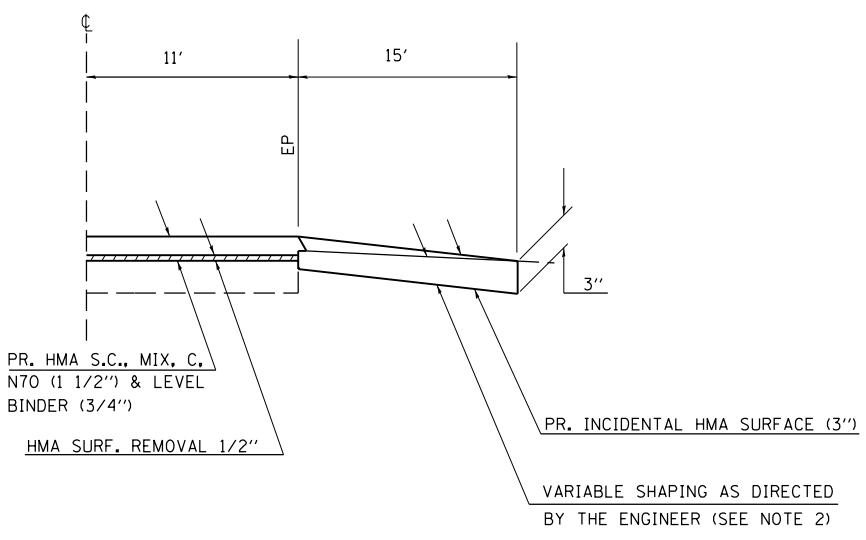

SIDEROAD SECTION B-B  
EX. AGGREGATE SURFACE  
(SEE NOTE 1)

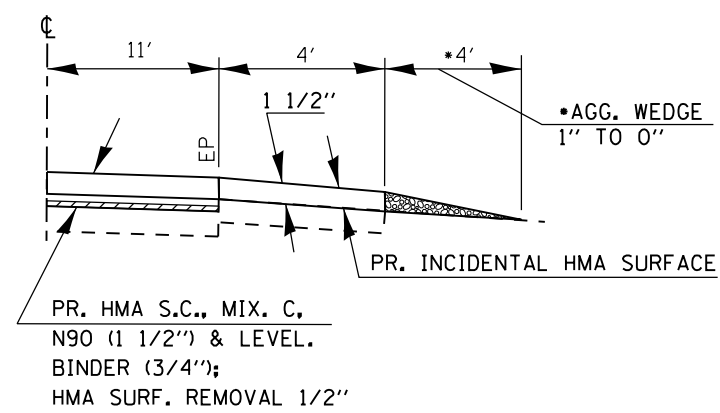

- PE, CE OR FE SEC. A-A
- EX. AGGREGATE SURFACE WITH BIT. APRON OR OIL & CHIP SURFACE
- SEE ENTRANCE SCHEDULE FOR QUANTITY.

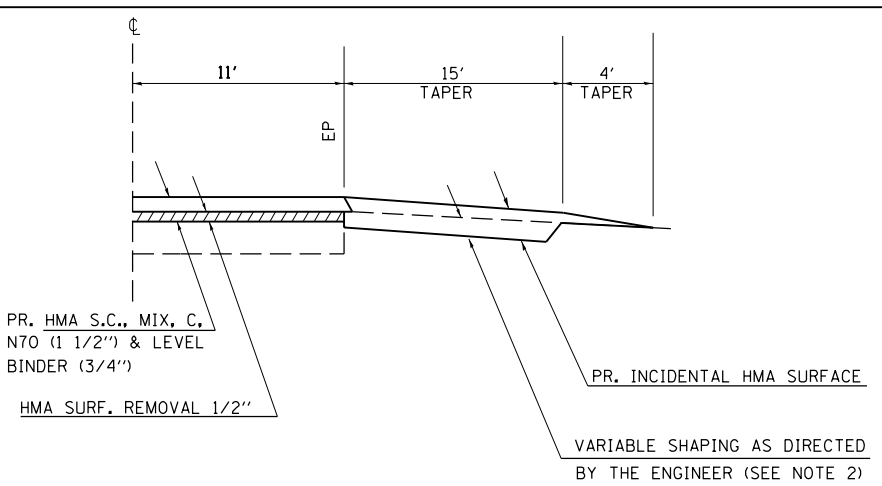

SIDEROAD SECTION B-B  
EX. OIL & CHIP SURFACE  
(SEE NOTE 1)

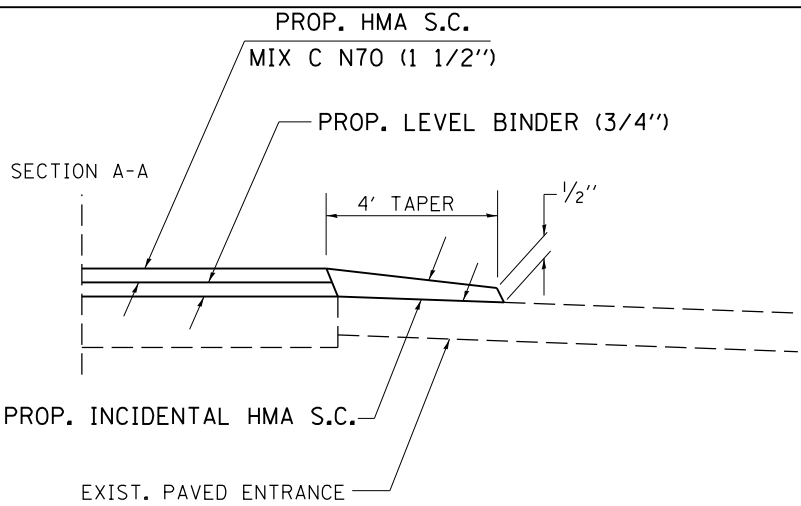

SIDEROAD SECTION A-A  
PRIVATE OR COMMERCIAL ENTRANCE  
HMA, PCC, OR OIL & CHIP

## NOTES

1. IF EXISTING SUBBASE IS INADEQUATE, AS DETERMINED BY THE ENGINEER, THE SIDE ROADS SHALL BE CORED OUT AND AGGREGATE SUBBASE, TYPE B SHALL BE PLACED FOR BASE. THE COST OF CORING OUT THE SIDE ROAD AND ANY AGGREGATE BASE COURSE SHALL BE PAID FOR AS SPECIFIED IN ART. 109.04 OF THE STANDARD SPECIFICATIONS FOR ROAD AND BRIDGE CONSTRUCTION. IF EXISTING SUBBASE IS DETERMINED TO BE ADEQUATE, THE PREPARATION OF THE BASE SHALL BE CONSTRUCTED ACCORDING TO ARTICLE 406.09.
2. VARIABLE SHAPING IS INCLUDED IN THE COST OF INCIDENTAL HOT-MIX ASPHALT SURFACE.

**ILLINOIS STANDARD**

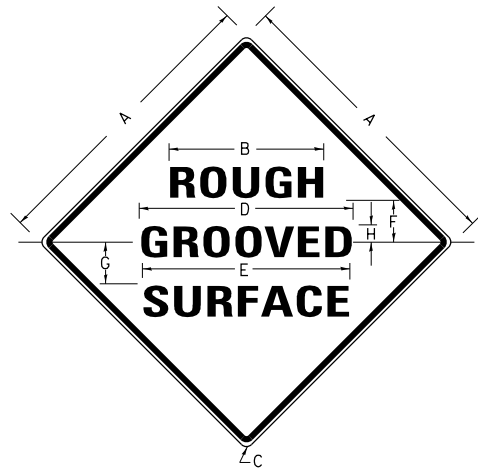

**COLORS:**

LEGEND AND BORDER- BLACK NON-REFLECTORIZED  
BACKGROUND- ORANGE REFLECTORIZED

SIGN SIZE	DIMENSIONS							
	A	B	C	D	E	F	G	H
48X48	48.0	24.1	3.0	34.0	33.0	6.0	13.0	3.5

SIGN SIZE	SERIES LINES			MAR-GIN	BOR-DER	BLANK STD.
	1	2	3			
48X48	7C	7C	7C	0.8	1.2	B4-48D

ALL DIMENSIONS IN INCHES

**NOTES:**

PRIOR TO ALLOWING TRAFFIC ON ANY PORTION OF THE ROADWAY THAT HAS BEEN COLDMILLED, THE CONTRACTOR SHALL HAVE ERECTED "ROUGH GROOVED SURFACE" SIGNS THAT CONFORM TO THE ABOVE DETAILS. A MINIMUM OF ONE SIGN AT EACH END OF THE IMPROVEMENT WILL BE REQUIRED. THE CONTRACTOR SHALL MAINTAIN THE "ROUGH GROOVED SURFACE" SIGNS UNTIL THE COLDMILLED SURFACE IS COVERED WITH LEVELING BINDER OR SURFACE COURSE.

IF AT ANY TIME THE SIGNS ARE IN PLACE BUT NOT APPLICABLE, THEY SHALL BE TURNED FROM THE VIEW OF MOTORISTS OR COVERED AS DIRECTED BY THE ENGINEER.

THE COST OF FURNISHING, ERECTING, MAINTAINING, AND REMOVING THE REQUIRED SIGNS SHALL BE INCLUDED IN THE CONTRACT.

REVISIONS	
REDRAWN	2-15-89
REVISED	4-6-93
REVISED	3-27-08
REVIEWED	5-17-13

STD. 9-39

**UNEVEN LANES SIGN**

W8-11 (48" x 48")

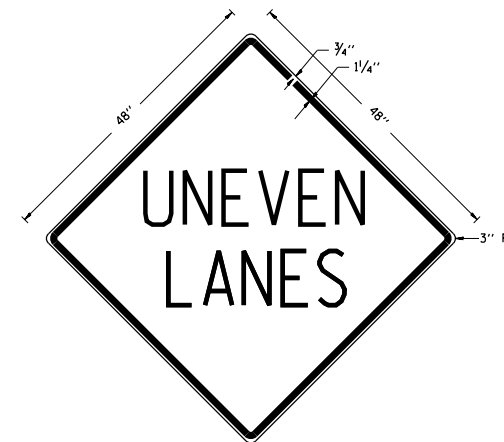

**COLORS:**

LEGEND AND BORDER - BLACK NON-REFLECTORIZED  
BACKGROUND - ORANGE REFLECTORIZED

**NOTE:** PRIOR TO ALLOWING TRAFFIC ON ANY PORTION OF THE ROADWAY THAT HAS BEEN COLDMILLED OR BEFORE RESURFACING OPERATIONS BEGIN, THE CONTRACTOR SHALL HAVE ERECTED "UNEVEN PAVEMENT" SIGNS THAT CONFORM TO THE ABOVE DETAILS. A MINIMUM OF ONE SIGN AT EACH END OF THE IMPROVEMENT WILL BE REQUIRED. THE CONTRACTOR SHALL MAINTAIN THE "UNEVEN PAVEMENT" SIGNS UNTIL THE RESURFACING OPERATIONS ARE COMPLETED.

IF AT ANY TIME THE SIGNS ARE IN PLACE BUT NOT APPLICABLE, THEY SHALL BE TURNED FROM THE VIEW OF MOTORISTS OR COVERED AS DIRECTED BY THE ENGINEER.

THE COST OF FURNISHING, ERECTING, MAINTAINING, AND REMOVING THE REQUIRED SIGNS SHALL BE INCLUDED IN THE CONTRACT.

REVISIONS	
DRAWN	2-15-89
REVISED	4-06-93
REDESIGNED	7-23-04
RESIZED	5-08-08
REVIEWED	5-17-13

STD. 9-41

FILE NAME =	USER NAME = jacksonc	DESIGNED -	REVISED -
p:\11\084EBIDINTEG.illinois.gov\PIWIDOT\Documents\IDOT Offices\District 9\Projects\78558\Drawings\CAD\Sheets\78558 Sheet		DRAWN -	REVISED -
Default	PLOT SCALE = 100.0000' / in.	CHECKED -	REVISED -
	PLOT DATE = 2/7/2017	DATE -	REVISED -

**STATE OF ILLINOIS  
DEPARTMENT OF TRANSPORTATION**

**UNEVEN LANE SIGN DETAIL AND  
ROUGH GROOVED SURFACE SIGNS**

SCALE: SHEET OF SHEETS STA. TO STA.

F.A.P. RTE.	SECTION	COUNTY	TOTAL SHEETS	SHEET NO.
132	12RS-4	POPE	26	26
CONTRACT NO. 78558				
ILLINOIS FED. AID PROJECT				