

**ELEVATION**  
 A - Pier 1 Repair.

**GENERAL NOTES**

Plan dimensions and details relative to existing plans are subject to nominal construction variations. The Contractor shall field verify existing dimensions and details affecting new construction and make necessary approved adjustments prior to construction or ordering of materials. Such variations shall not be cause for additional compensation for a change in scope of the work, however, the Contractor will be paid for the quantity actually furnished at the unit price bid for the work.

The existing concrete surface shall be cleaned and prepared in accordance with the Special Provisions.

Reinforcement bars designated (E) shall be epoxy coated.

Contractor shall verify the condition of Pier 1 below the water level after dewatering. Additional quantity will be determined by the Engineer and will be paid for at the unit price bid for the work.

Existing reinforcement bars exposed during concrete removal shall be cleaned and incorporated into the new construction. Any reinforcement bars that are damaged during concrete removal shall be replaced with an approved bar splicer or anchorage system. Cost included with Concrete Removal.

The quantity for Concrete Removal is estimated. The Engineer shall mark all loose and unbound concrete prior to the removal. The Contractor will be paid for the actual quantity at the unit price bid for the work.

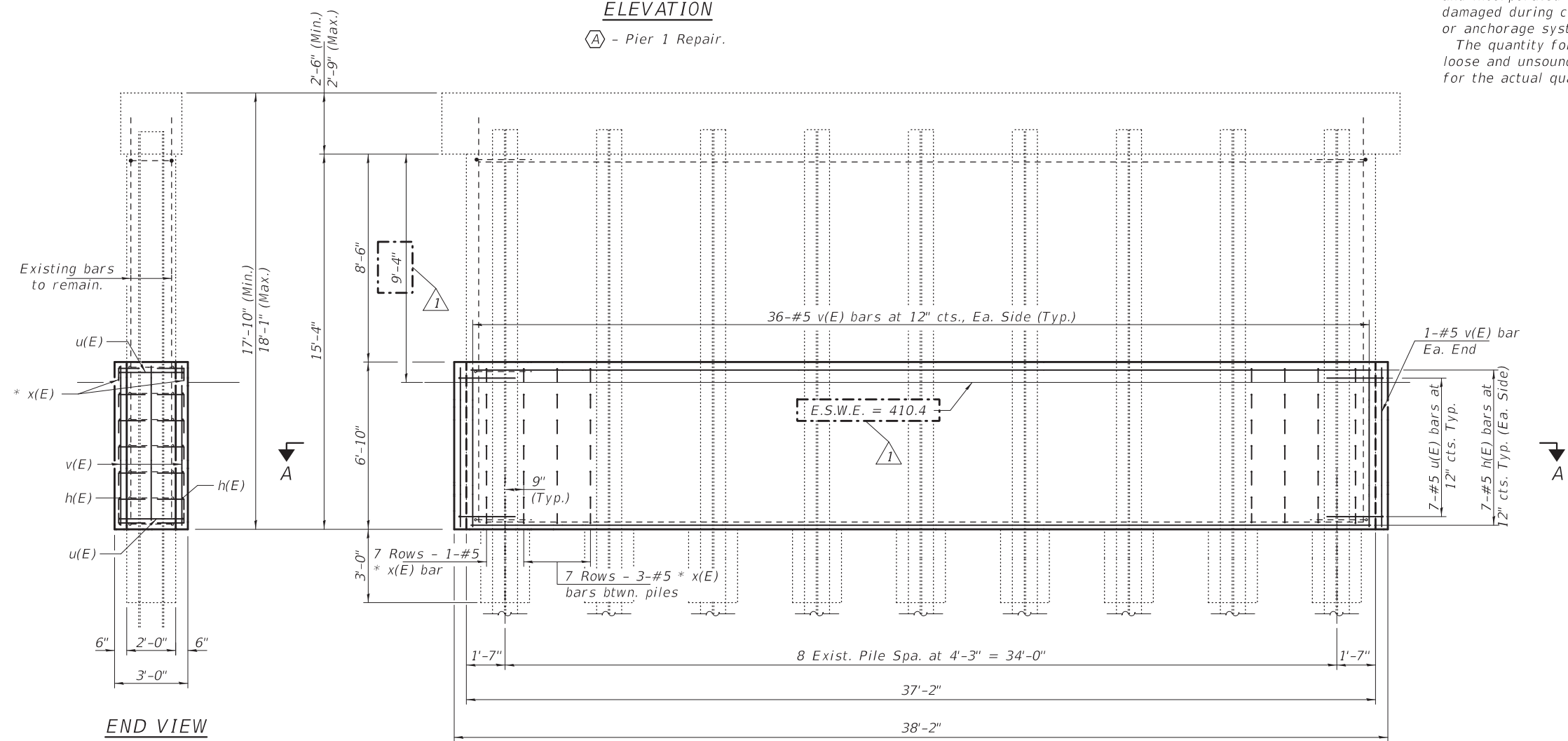

**REPLACEMENT**  
 (Pier 1 Looking South)

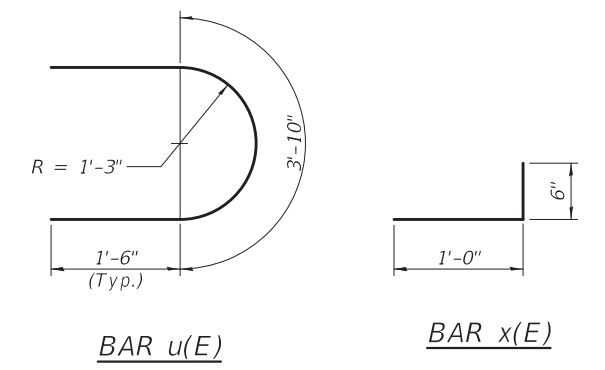

**TOTAL BILL OF MATERIAL**

Bar	No.	Size	Length	Shape
h(E)	14	#5	36'-8"	—
u(E)	14	#5	6'-10"	U
v(E)	74	#5	6'-6"	—
x(E)	182	#5	1'-6"	—
Concrete Removal		Cu. Yd.	0.6	
Concrete Structures		Cu. Yd.	10.5	
Cofferdam (Type 1) (Location -1)		Each	1	
Reinforcement Bars, Epoxy Coated		Pound	1430	
Cofferdam Excavation		Cu. Yd.	145	

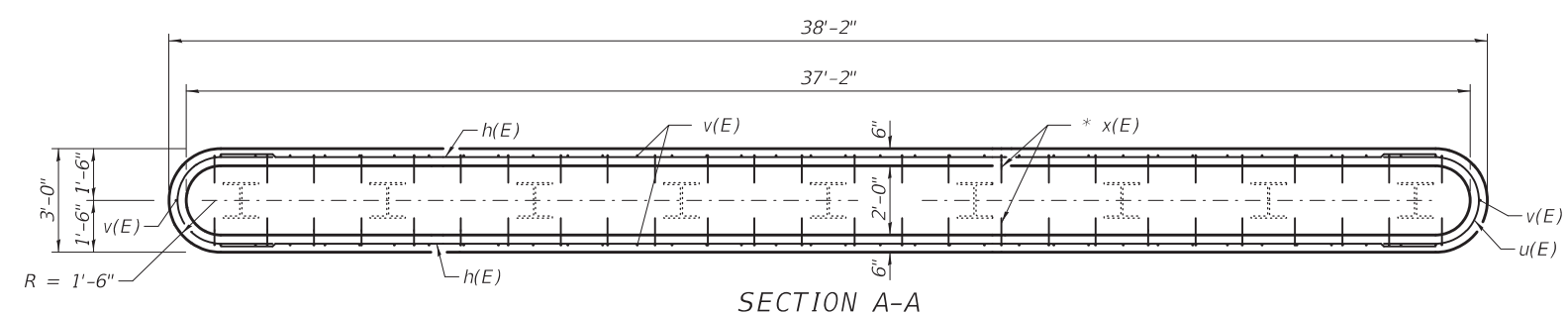

**SECTION A-A**

REVISED 4-13-2023



*Jayne F. Schiff*  
 EXPIRES 11-30-2024