

F.A.S. RTE.	SECTION	COUNTY	TOTAL SHEETS	SHEET NO.
471	20-00038-06-RS	MCLEAN	24	1
		ILLINOIS	CONTRACT NO. 91621	

INDEX OF SHEETS

- 1 COVER
- 2 SUMMARY OF QUANTITIES & GENERAL NOTES
- 3 SCHEDULES
- 4-8 TYPICAL CROSS SECTIONS
- 9 MISCELLANEOUS DETAILS
- 10 STATE ST CURB AND GUTTER ELEVATIONS
- 11 STATE ST SIDEWALK DETAILS
- 12 YUTON ELEVATOR ENTRANCE DETAIL
- 13 YUTON ELEVATOR CURB REPLACEMENT
- 14-24 PLAN VIEW

STATE OF ILLINOIS
DEPARTMENT OF TRANSPORTATION
**PROPOSED
HIGHWAY PLANS**

**FAS ROUTE 471 (C.H. 18)
20-00038-06-RS
RESURFACE
MCLEAN COUNTY
JOB # C-95-001-24
PROJECT ME06(896)
FUNDING: STR, TARP, HSIP, MATCHING**

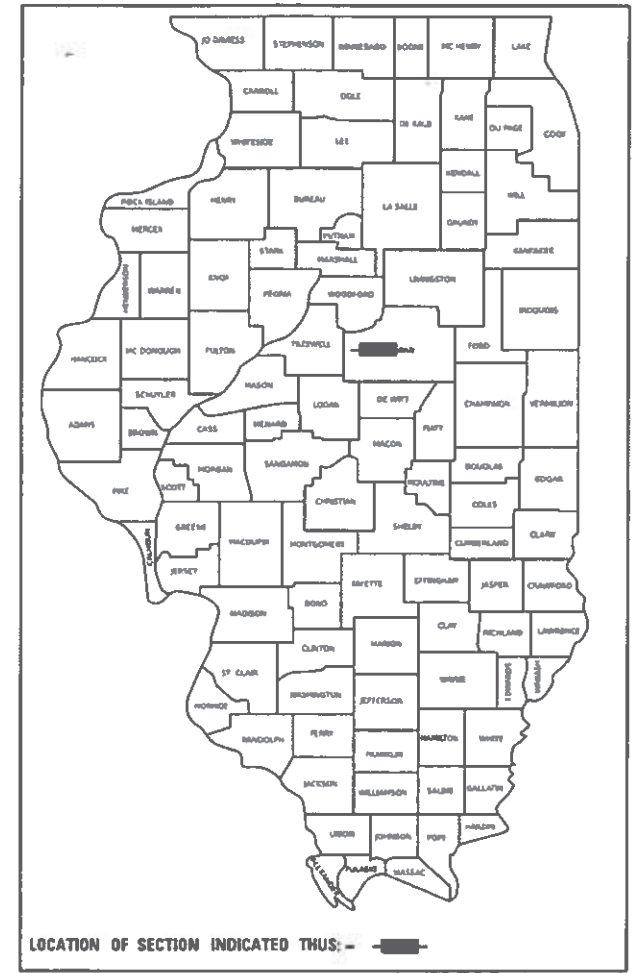

FUNCTIONAL CLASSIFICATION
MAJOR COLLECTOR
2020 ADT = 2300
P.V. = 92% S.U. = 4% M.U. = 4%

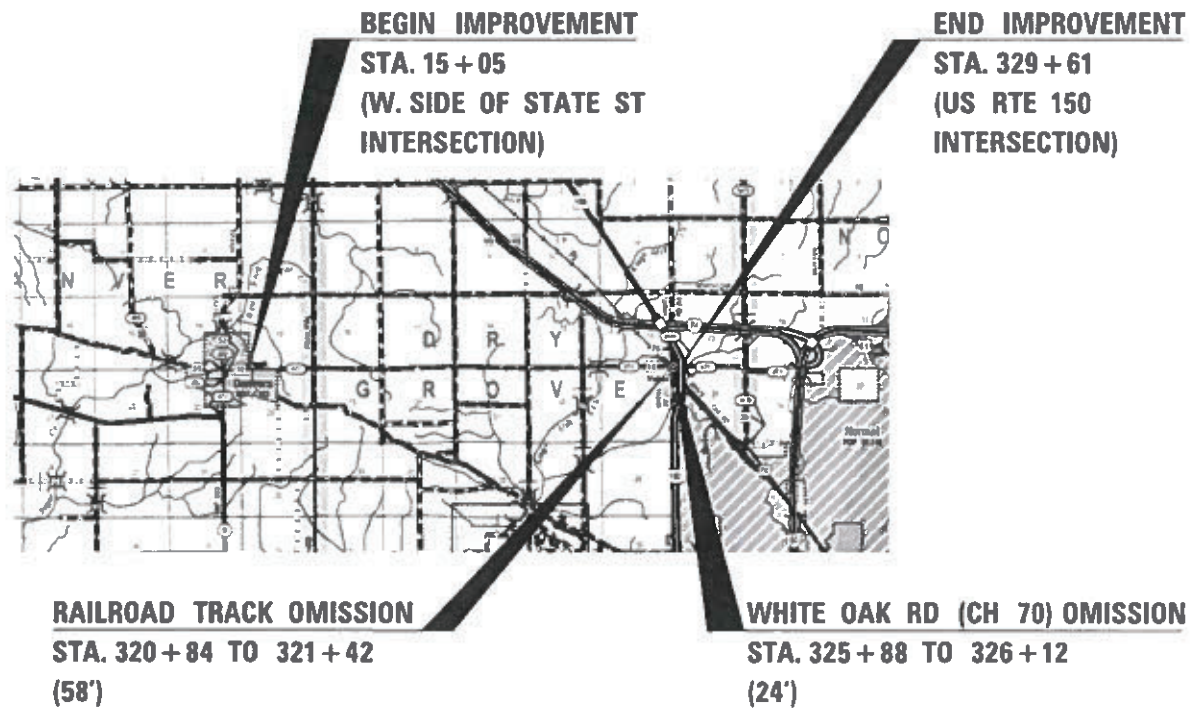

PLANS NOT TO SCALE
J.U.L.I.E.
JOINT UTILITY LOCATION INFORMATION FOR EXCAVATION
1-800-892-0123
OR 811

CONTRACT NO. 91621

GROSS LENGTH = 31,456 FT. = 5.958 MILES
NET LENGTH = 31,374 FT. = 5.942 MILES



01/20/2023
DATE
Luke D. Hohulin
LUKE HOHULIN, P.E.
NO. 062-065157
EXPIRATION DATE 11/30/23

**STATE OF ILLINOIS
DEPARTMENT OF TRANSPORTATION
DIVISION OF HIGHWAY**

APPROVED JANUARY 20 20 23
[Signature]
MCLEAN CO. HIGHWAY DEPT, COUNTY ENGINEER

STATE OF ILLINOIS
DEPARTMENT OF TRANSPORTATION
PASSED JANUARY 30 20 23
[Signature]
DISTRICT 5 ENGINEER OF LOCAL ROADS & STREETS

RELEASING FOR
AND BASED ON
LIMITED REVIEW
January 30 20 23
[Signature]
REGION 3 ENGINEER

**PRINTED BY THE AUTHORITY
OF THE STATE OF ILLINOIS**

SUMMARY OF QUANTITIES

ITEM NO.	ITEM	UNIT	TOTAL QUANTITY	STR/LOCAL 0005	HSIP 0021
20200500	EARTH EXCAVATION (WIDENING)	CU YD	4,809		4,809
35101400	AGGREGATE BASE COURSE, TYPE B	TON	245	245	
35600650	HOT-MIX ASPHALT BASE COURSE WIDENING, 4"	SQ YD	26,715		26,715
40600290	BITUMINOUS MATERIALS (TACK COAT)	POUND	74,750	56,717	18,033
40600370	LONGITUDINAL JOINT SEALANT	FOOT	30,350	30,350	
40600990	TEMPORARY RAMP	SQ YD	352	352	
40602965	HOT-MIX ASPHALT BINDER COURSE, IL-9.5FG, N50	TON	7,700	5,830	1,870
40604062	HOT-MIX ASPHALT SURFACE COURSE, IL-9.5, MIX "D", N70	TON	9,420	7,176	2,244
40800029	BITUMINOUS MATERIALS (TACK COAT)	POUND	1,800	1,800	
40800050	INCIDENTAL HOT-MIX ASPHALT SURFACING	TON	500	500	
42400100	PORTLAND CEMENT CONCRETE SIDEWALK 4 INCH	SQ FT	409	409	
42400800	DETECTABLE WARNINGS	SQ FT	40	40	
44000155	HOT-MIX ASPHALT SURFACE REMOVAL, 1 1/2"	SQ YD	2,135	2,135	
44000159	HOT-MIX ASPHALT SURFACE REMOVAL, 2 1/2"	SQ YD	80,348	80,348	
44000500	COMBINATION CURB AND GUTTER REMOVAL	FOOT	1,616	1,616	
48102100	AGGREGATE WEDGE SHOULDER, TYPE B	TON	1,300	1,300	
56109210	WATER VALVES TO BE ADJUSTED	EACH	2	2	
60255500	MANHOLES TO ADJUSTED	EACH	1	1	
60602500	CONCRETE GUTTER, TYPE A	FOOT	139	139	
60604400	COMBINATION CONCRETE CURB AND GUTTER, TYPE B-6.18	FOOT	676	676	
60609800	COMBINATION CONCRETE CURB AND GUTTER, TYPE M-6.18	FOOT	401	401	
# 63000001	STEEL PLATE BEAM GUARDRAIL, TYPE A, 6 FOOT POSTS	FOOT	2,250	2,250	
# 63000003	STEEL PLATE BEAM GUARDRAIL, TYPE A, 9 FOOT POSTS	FOOT	1,675	1,675	
# 63000030	STRONG POST GUARDRAIL ATTACHED TO CULVERT	FOOT	100	100	
# 63000370	LONG-SPAN GUARDRAIL OVER CULVERT, 25 FT SPAN	FOOT	100	100	
# 63100045	TRAFFIC BARRIER TERMINAL, TYPE 2	EACH	2	2	
# 63100167	TRAFFIC BARRIER TERMINAL, TYPE 1 (SPECIAL) TANGENT	EACH	30	30	
63200310	GUARDRAIL REMOVAL	FOOT	2,974	2,974	
64200108	SHOULDER RUMBLE STRIPS, 8 INCH	FOOT	56,000		56,000
67100100	MOBILIZATION	L SUM	1	1	
# 78001120	PAINT PAVEMENT MARKING - LINE 5"	FOOT	71,420	71,420	
# 78100100	RAISED REFLECTIVE PAVEMENT MARKER	EACH	399	399	
X4401198	HOT-MIX ASPHALT SURFACE REMOVAL, VARIABLE DEPTH	SQ YD	6,343	6,343	
X6024503	INLETS TO BE ADJUSTED WITH NEW FRAME AND GRATE (SPECIAL)	EACH	3	3	
# X6330725	STEEL PLATE BEAM GUARDRAIL (SHORT RADIUS)	FOOT	75	75	
X7010216	TRAFFIC CONTROL AND PROTECTION, (SPECIAL)	L SUM	1	1	
Z0013798	CONSTRUCTION LAYOUT	L SUM	1	1	
Z0048665	RAILROAD PROTECTIVE LIABILITY INSURANCE	L SUM	1	1	

#SPECIALTY ITEMS

HMA MIXTURE REQUIREMENTS	F.A.S. 471	F.A.S. 471	F.A.S. 471	F.A.S. 471
Location(s):				
Mixture Use(s):	Base Course	Binder	Surface	Incidental
PG:	PG 64-22	PG 64-22	PG 64-22	PG 64-22
Design Air Voids:	4.0% @ N50	4.0% @ N50	4.0% @ N70	4.0% @ N50
Mixture Composition:	IL-19	IL-9.5FG	IL-9.5	IL-9.5
Friction Aggregate:	N/A	N/A	Mixture D	Mixture C
Mixture Weight:	112	112	112	112
Quality Management Program:	CC/QA	QC/QA	QC/QA	QC/QA
Sublot Size	N/A	N/A	N/A	N/A
Material Transfer Device (Required?):	No	No	Yes	No

STATE STANDARD DETAILS

- 000001-08 STANDARD SYMBOLS, ABBREVIATIONS, AND PATTERNS
- 001006 DECIMAL OF AN INCH AND OF A FOOT
- 424001-11 PERPENDICULAR CURB RAMPS FOR SIDEWALKS
- 606001-08 CONCRETE CURB TYPE B AND COMBINATION CONCRETE CURB AND GUTTER
- 606101-05 TYPE A GUTTER (INLET, OUTLET, & ENTRANCE)
- 630001-12 STEEL PLATE BEAM GUARDRAIL
- 630301-09 SHOULDER WIDENING FOR TYPE 1 (SPECIAL) GUARDRAIL TERMINALS
- 642006-01 SHOULDER RUMBLE STRIPS, 8"
- 701001-02 OFF-RD OPERATIONS, 2L, 2W, MORE THAN 15' (4.5 m) AWAY
- 701006-05 OFF-RD OPERATIONS, 2L, 2W, 15' TO 24" FROM PAVEMENT EDGE
- 701011-04 OFF-RD MOVING OPERATIONS, 2L, 2W, DAY ONLY
- 701201-05 LANE CLOSURE, 2L, 2W, DAY ONLY, FOR SPEEDS ≥ 45 MPH
- 701301-04 LANE CLOSURE, 2L, 2W, SHORT TIME OPERATIONS
- 701306-04 LANE CLOSURE, 2L, 2W, SLOW MOVING OPERATIONS DAY ONLY, FOR SPEEDS ≥ 45 MPH
- 701326-04 LANE CLOSURE, 2L, 2W, PAVEMENT WIDENING FOR SPEEDS ≥ 45 MPH
- 701801-06 SIDEWALK, CORNER OR CROSSWALK CLOSURE
- 701901-08 TRAFFIC CONTROL DEVICES
- 781001-04 TYPICAL APPLICATIONS RAISED REFLECTIVE PAVEMENT MARKERS
- BLR 18-6 TRAFFIC CONTROL DEVICES - DAY LABOR MAINTENANCE
- BLR 22-7 TYPICAL APPLICATIONS OF TRAFFIC CONTROL DEVICES FOR CONSTRUCTION ON RURAL LOCAL HIGHWAYS

GENERAL NOTES

- MICROSTATION AND GEOPAK FILES OF THIS PROJECT WILL BE MADE AVAILABLE TO THE CONTRACTOR AFTER CONTRACT AWARD. IF THERE IS A CONFLICT BETWEEN THE ELECTRONIC FILES AND THE PRINTED CONTRACT PLAN AND DOCUMENTS, THE PRINTED CONTRACT PLANS AND DOCUMENTS SHALL TAKE PRECEDENCE OVER THE ELECTRONIC FILES. THE CONTRACTOR SHALL ACCEPT ALL RISK ASSOCIATED WITH USING THE ELECTRONIC FILES AND SHALL HOLD THE DEPARTMENT HARMLESS FOR ANY ERRORS OR OMISSIONS IN THE ELECTRONIC FILES AND THE DATA CONTAINED THEREIN. ERRORS OR DELAYS RESULTING FROM THE USE OF THE ELECTRONIC FILES BY THE CONTRACTOR SHALL NOT RESULT IN AN EXTENSION OF TIME FOR ANY INTERIM OR FINAL COMPLETION DATE OR SHALL NOT BE CONSIDERED CAUSE FOR ADDITIONAL COMPENSATION. THE CONTRACTOR SHALL NOT USE, SHARE, OR DISTRIBUTE THESE ELECTRONIC FILES EXCEPT FOR THE PURPOSE OF CONSTRUCTING THIS CONTRACT. ANY CLAIMS BY THIRD PARTIES DUE TO USE OR ERRORS SHALL BE THE SOLE RESPONSIBILITY OF THE CONTRACTOR. THE CONTRACTOR SHALL INCLUDE THIS DISCLAIMER WITH THE TRANSFER OF THESE ELECTRONIC FILES TO ANY OTHER PARTIES AND SHALL INCLUDE APPROPRIATE LANGUAGE BINDING THEM TO SIMILAR RESPONSIBILITIES.
- THE EXISTING TOPOGRAPHIC INFORMATION FOR THIS PROJECT IS BASED ON A TOPOGRAPHIC SURVEY PREPARED BY THE COUNTY. THE CONTRACTOR IS RESPONSIBLE FOR VERIFYING THE TOPOGRAPHIC INFORMATION INDICATED ON THE DRAWINGS AND SHALL DETERMINE THE EXACT LOCATION AND ELEVATION OF ALL EXISTING DATA, ABOVE OR BELOW GROUND, SHOWN OR NOT SHOWN, PRIOR TO CONSTRUCTION. DISCREPANCIES IN EXISTING TOPOGRAPHIC DATA SHALL BE REPORTED TO THE ENGINEER IMMEDIATELY FOR REVIEW. COSTS TO VERIFY EXISTING TOPOGRAPHIC INFORMATION SHALL BE CONSIDERED INCIDENTAL TO THE CONTRACT.
- A FULL DEPTH SAW CUT SHALL BE PROVIDED AT ALL REMOVAL LIMITS. THIS WORK SHALL BE INCLUDED IN THE COST OF REMOVAL ITEMS.
- ALL ELEVATIONS SHOWN IN THE PLANS ARE BASED ON NORTH AMERICAN DATUM OF 1983 (NAD83) AND STATE PLANE COORDINATES, ILLINOIS EAST ZONE.
- THE CONTRACTOR SHALL BE RESPONSIBLE FOR REPAIRS TO ANY UTILITY LINES AND EXISTING IMPROVEMENTS TO REMAIN THAT ARE DAMAGED AS A RESULT OF THE WORK.
- THE COUNTY RESERVES THE RIGHT TO REDUCE ANY QUANTITY OR DELETE ANY PAY ITEMS FROM THIS CONTRACT. NO ADDITIONAL COMPENSATION WILL BE ALLOWED.
- ALL TEMPORARY PAVEMENT MARKINGS & STRIPING WILL BE DONE BY OTHERS (MCLEAN COUNTY).

MODEL: 800 FILE NAME: X:\CountyRoads\CH 18\20-00038-06-RS - Danvers-Yuton Road - 2023\Drawings\CD\ADD Data\Sheets\SC08\Detail_20-00038-06-RS - Danvers-Yuton Road.dgn

USER NAME = collin.frantz	DESIGNED -	REVISED -
	DRAWN -	REVISED -
PLOT SCALE = 0.08333317' / in.	CHECKED -	REVISED -
PLOT DATE = 2/7/2023	DATE -	REVISED -

STATE OF ILLINOIS
DEPARTMENT OF TRANSPORTATION

DANVERS-YUTON ROAD
GENERAL NOTES

SCALE: SHEET 2 OF 24 SHEETS STA. TO STA. _____

F.A.S. RTE.	SECTION	COUNTY	TOTAL SHEETS	SHEET NO.
471	20-00038-06-RS	MCLEAN	24	2
CONTRACT NO. 91621			ILLINOIS FED. AID PROJECT	

EXISTING TYPICAL CROSS SECTION #1

20-00038-06-RS
 DANVERS-YUTON RD (C.H. 18)
 STA. 15+05 TO STA. 19+47
 (NOT TO SCALE)

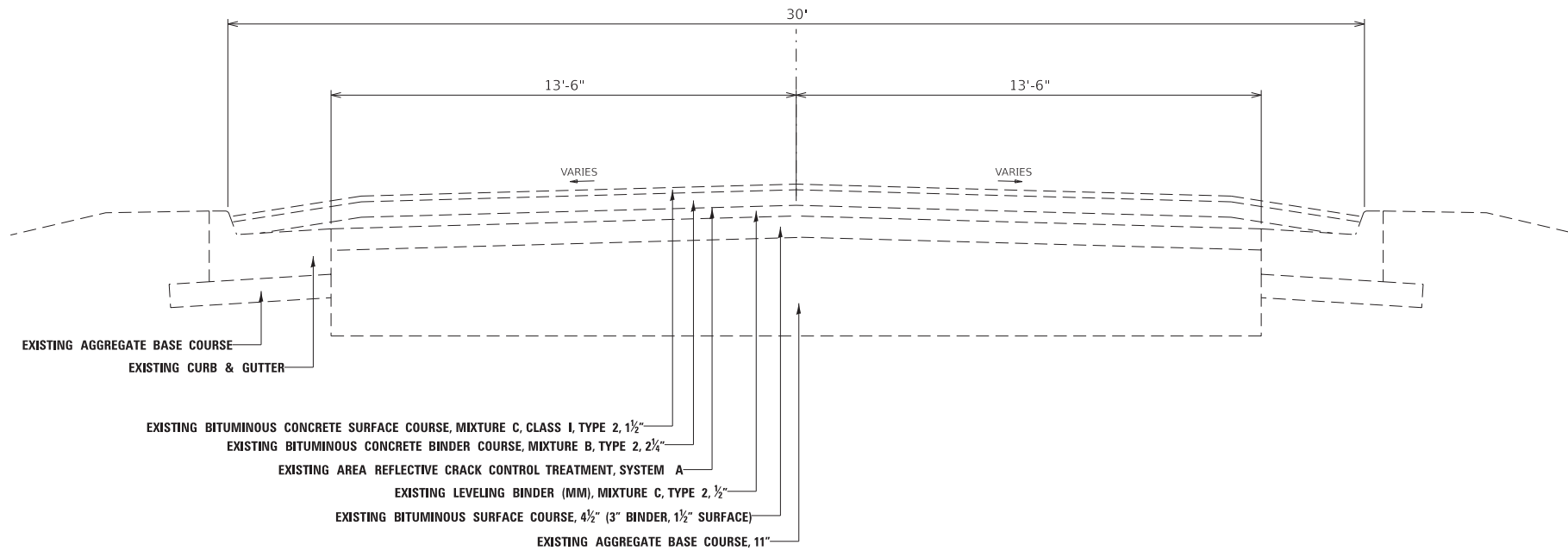

PROPOSED TYPICAL CROSS SECTION #1

20-00038-06-RS
 DANVERS-YUTON RD (C.H. 18)
 STA. 15+05 TO STA. 19+47
 (NOT TO SCALE)

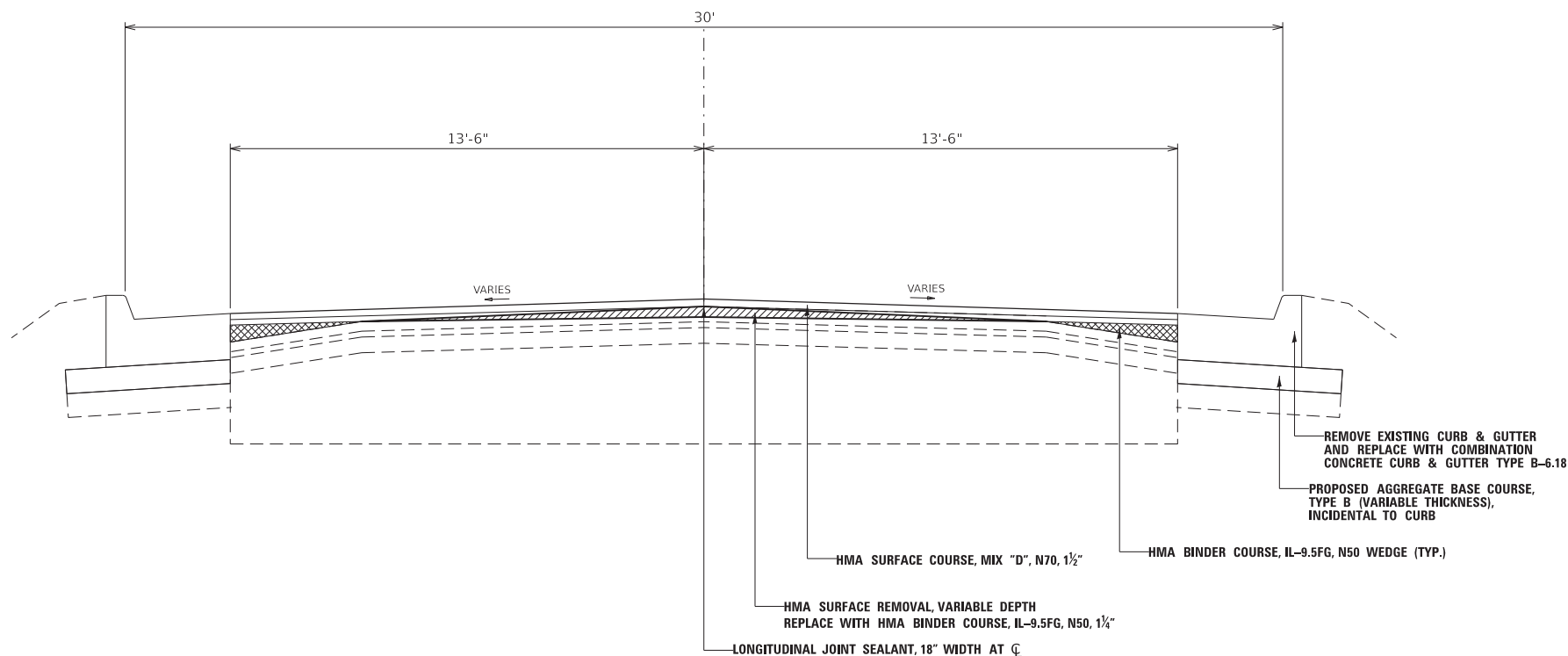

MODEL: Typical Sections 1
 FILE NAME: X:\County\Roads\CH 18\20-00038-06-RS - Danvers-Yuton Road - 2023\Design\DCN\CADD Data\Sheets\Typical\20-00038-06-RS - Danvers-Yuton Road.dgn

USER NAME = collin.frantz	DESIGNED -	REVISED -
	DRAWN -	REVISED -
PLOT SCALE = 0.08333317' / in.	CHECKED -	REVISED -
PLOT DATE = 12/20/2022	DATE -	REVISED -

**STATE OF ILLINOIS
 DEPARTMENT OF TRANSPORTATION**

**DANVERS-YUTON ROAD
 TYPICAL CROSS SECTIONS**

SCALE: SHEET 4 OF 24 SHEETS STA. TO STA. _____

F.A.S RTE.	SECTION	COUNTY	TOTAL SHEETS	SHEET NO.
471	20-00038-06-RS	MCLEAN	24	4
CONTRACT NO. 91621				
ILLINOIS		FED. AID PROJECT		

EXISTING TYPICAL CROSS SECTION #2

20-00038-06-RS
 DANVERS-YUTON RD (C.H. 18)
 STA. 19+47 TO STA. 320+84
 STA. 320+84 TO STA. 321+42 (RAILROAD OMISSION)
 (NOT TO SCALE)

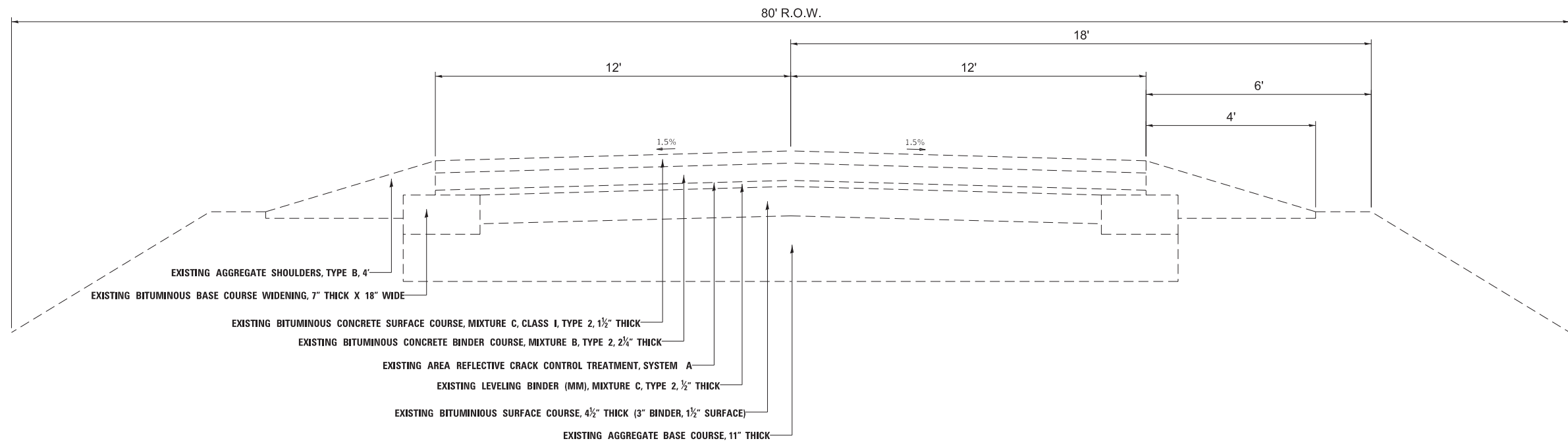

PROPOSED TYPICAL CROSS SECTION #2

20-00038-06-RS
 DANVERS-YUTON RD (C.H. 18)
 STA. 19+47 TO STA. 320+84
 STA. 320+84 TO STA. 321+42 (RAILROAD OMISSION)
 (NOT TO SCALE)

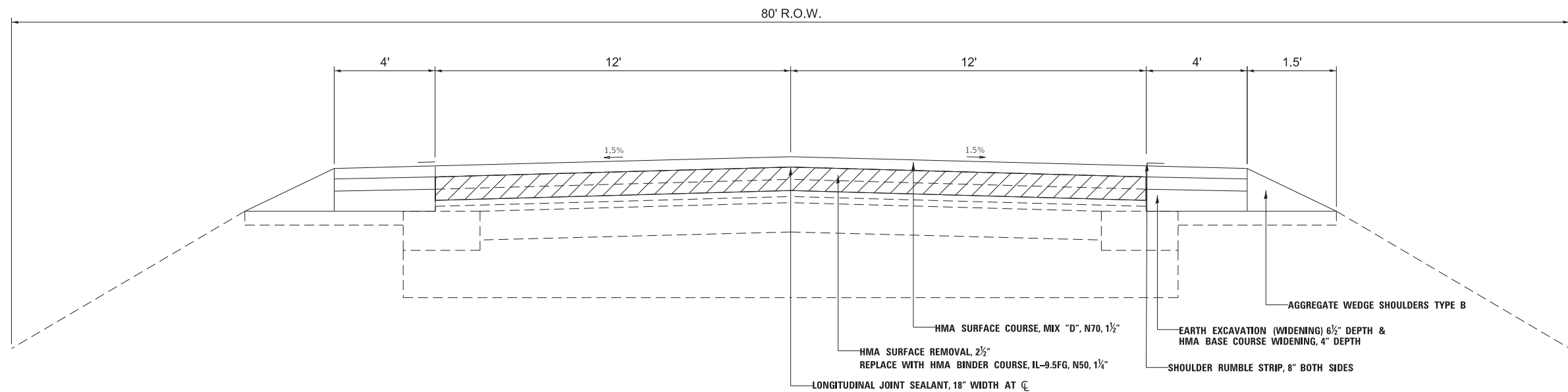

MODEL: Typical Sections 2
 FILE NAME: X:\County\Roads\CH 18\20-00038-06-RS - Danvers-Yuton Road - 2023\Design\DCN\CADD Data\Sheets\Typical\20-00038-06-RS - Danvers-Yuton Road.dgn

USER NAME = collin.frantz	DESIGNED -	REVISED -
	DRAWN -	REVISED -
PLOT SCALE = 0.083333317' / in.	CHECKED -	REVISED -
PLOT DATE = 12/20/2022	DATE -	REVISED -

**STATE OF ILLINOIS
 DEPARTMENT OF TRANSPORTATION**

DANVERS-YUTON ROAD TYPICAL CROSS SECTIONS		F.A.S RTE.	SECTION	COUNTY	TOTAL SHEETS	SHEET NO.
		471	20-00038-06-RS	MCLEAN	24	5
SCALE:		SHEET 5 OF 24 SHEETS		STA.	TO STA. ____	

CONTRACT NO. 91621		ILLINOIS	FED. AID PROJECT
--------------------	--	----------	------------------

EXISTING TYPICAL CROSS SECTION #3

20-00038-06-RS
 DANVERS-YUTON RD (C.H. 18)
 STA. 321+42 TO STA. 324+61
 (NOT TO SCALE)

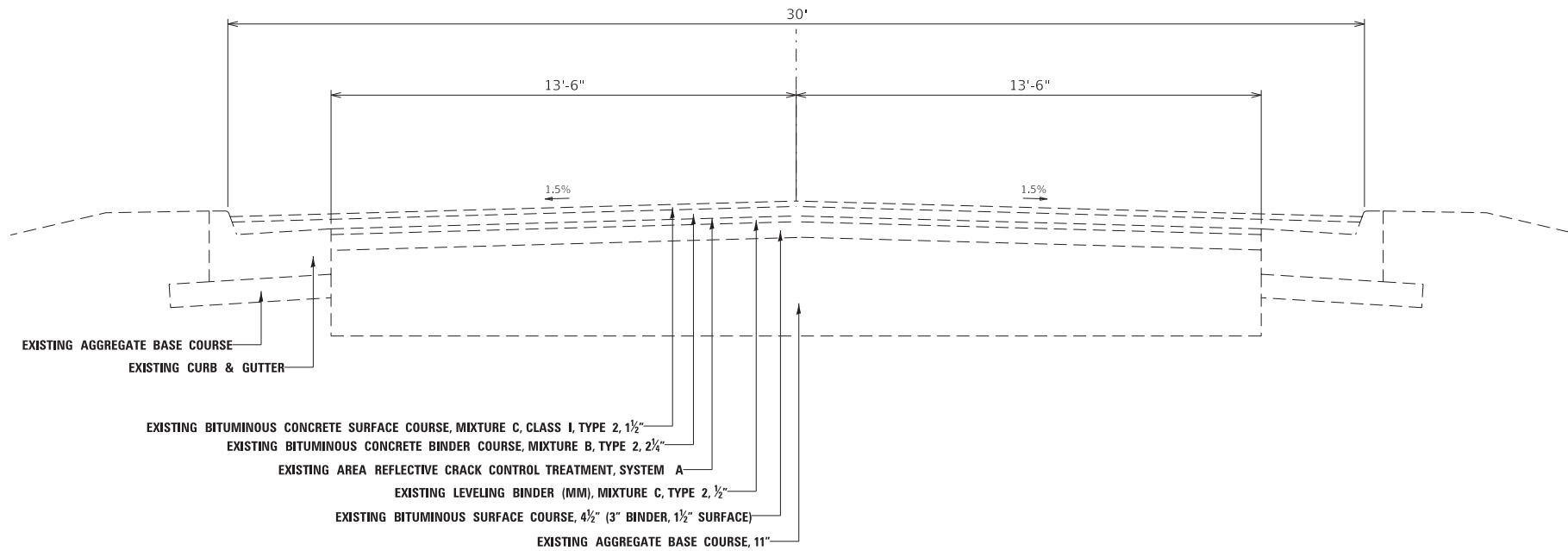

PROPOSED TYPICAL CROSS SECTION #3

20-00038-06-RS
 DANVERS-YUTON RD (C.H. 18)
 STA. 321+42 TO STA. 324+61
 (NOT TO SCALE)

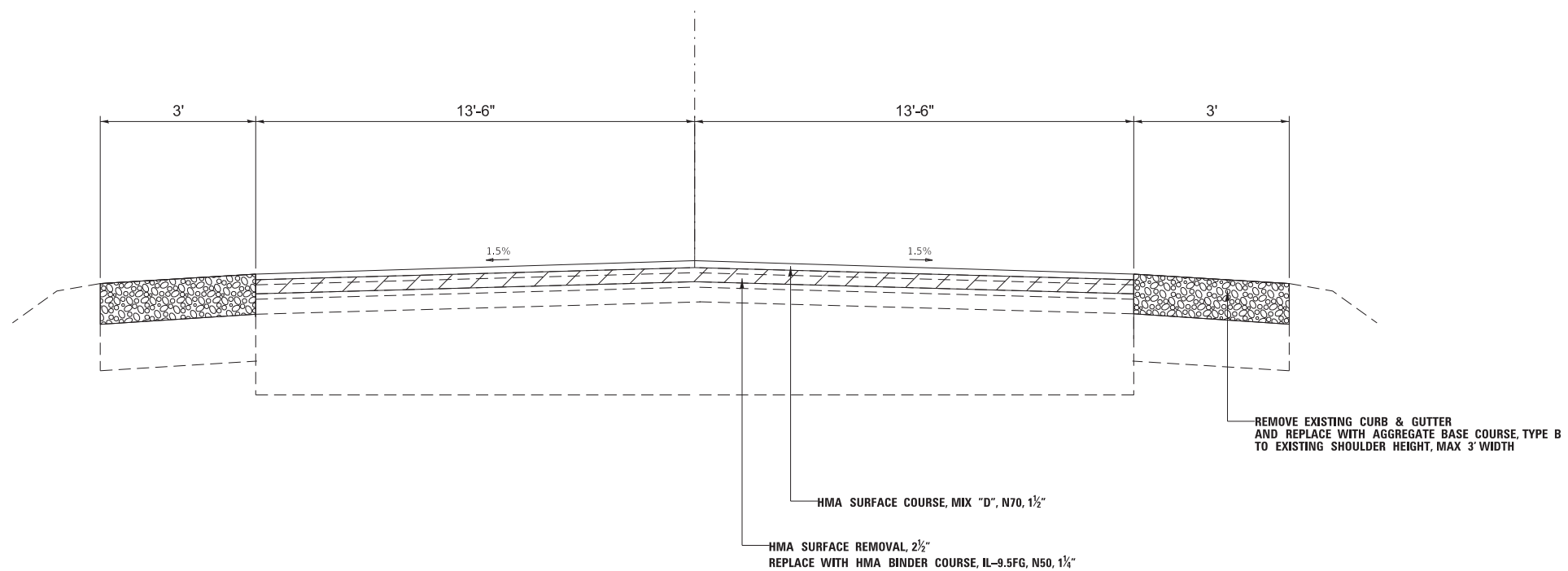

MODEL: Typical Sections 3
 FILE NAME: X:\County\Roads\CH 18\20-00038-06-RS - Danvers-Yuton Road - 2023\Design\DCN\CADD Data\Sheets\Typical\KS_20-00038-06-RS - Danvers-Yuton Road.dgn

USER NAME = collin.frantz	DESIGNED -	REVISED -
PLOT SCALE = 0.08333317' / in.	DRAWN -	REVISED -
PLOT DATE = 12/20/2022	CHECKED -	REVISED -
	DATE -	REVISED -

**STATE OF ILLINOIS
 DEPARTMENT OF TRANSPORTATION**

**DANVERS-YUTON ROAD
 TYPICAL CROSS SECTIONS**

SCALE: SHEET 6 OF 24 SHEETS STA. TO STA. _____

F.A.S RTE.	SECTION	COUNTY	TOTAL SHEETS	SHEET NO.
471	20-00038-06-RS	MCLEAN	24	6
ILLINOIS FED. AID PROJECT			CONTRACT NO. 91621	

EXISTING TYPICAL CROSS SECTION #4

20-00038-06-RS
 DANVERS-YUTON RD (C.H. 18)
 STA. 324+61 TO STA. 325+88
 STA. 326+12 TO STA. 326+48
 (NOT TO SCALE)

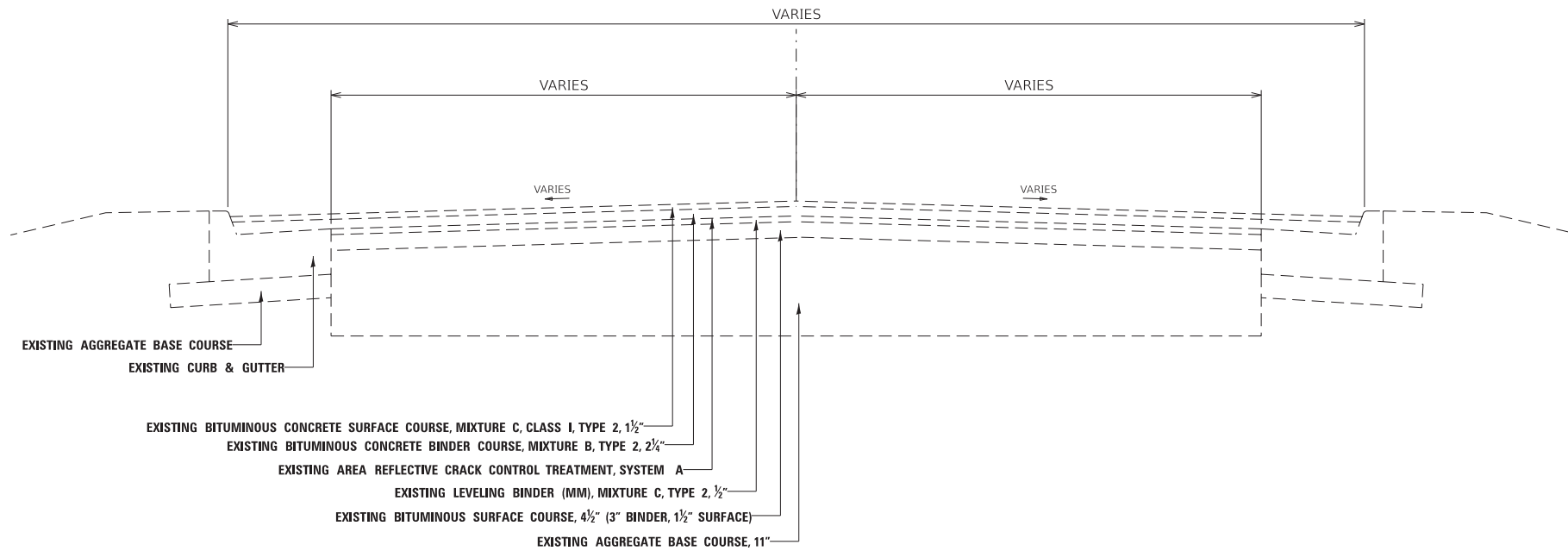

PROPOSED TYPICAL CROSS SECTION #4

20-00038-06-RS
 DANVERS-YUTON RD (C.H. 18)
 STA. 324+61 TO STA. 325+88
 STA. 326+12 TO STA. 326+48
 (NOT TO SCALE)

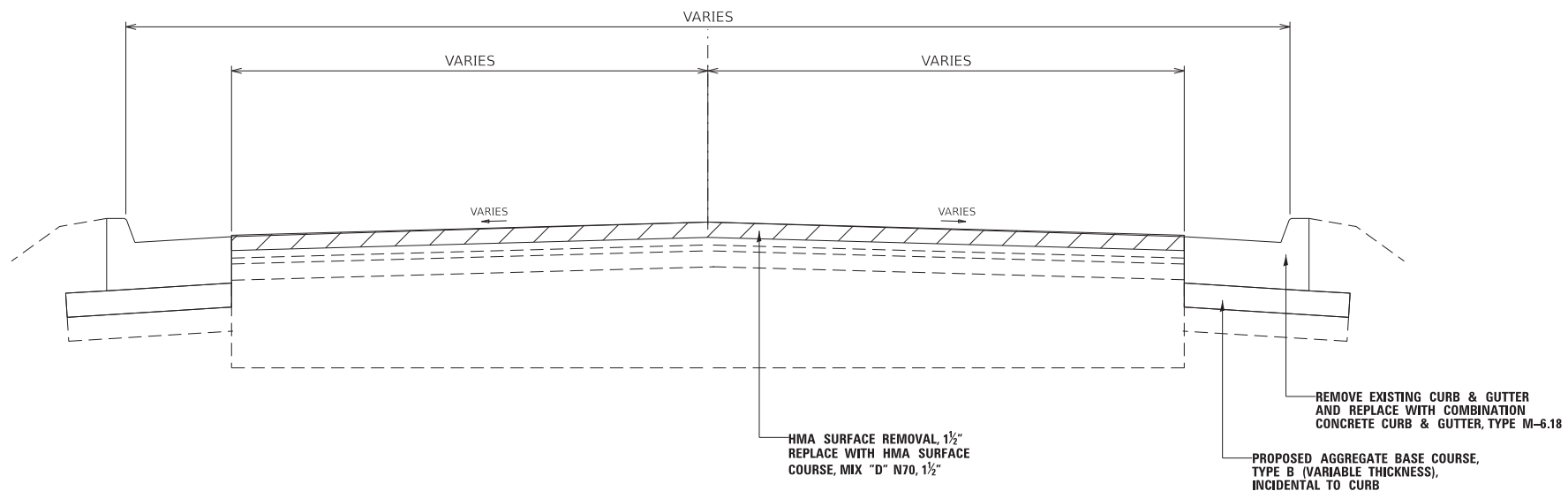

MODEL: Typical Sections 4
 FILE NAME: X:\CountyRoads\CH 18\20-00038-06-RS - Danvers-Yuton Road - 2023\Design\DCN\CADD Data\Sheets\TypicalXS_20-00038-06-RS_Danvers-Yuton Road.dgn

USER NAME = collin.frantz	DESIGNED -	REVISED -
	DRAWN -	REVISED -
PLOT SCALE = 0.08333317' / in.	CHECKED -	REVISED -
PLOT DATE = 12/20/2022	DATE -	REVISED -

**STATE OF ILLINOIS
 DEPARTMENT OF TRANSPORTATION**

**DANVERS-YUTON ROAD
 TYPICAL CROSS SECTIONS**

SCALE: SHEET 7 OF 24 SHEETS STA. TO STA. _____

F.A.S RTE.	SECTION	COUNTY	TOTAL SHEETS	SHEET NO.
471	20-00038-06-RS	MCLEAN	24	7
CONTRACT NO. 91621			ILLINOIS FED. AID PROJECT	

EXISTING TYPICAL CROSS SECTION #5

SEC 20-00038-06-RS
 DANVERS-YUTON RD (C.H. 18)
 STA. 326+48 TO STA. 329+61
 (NOT TO SCALE)

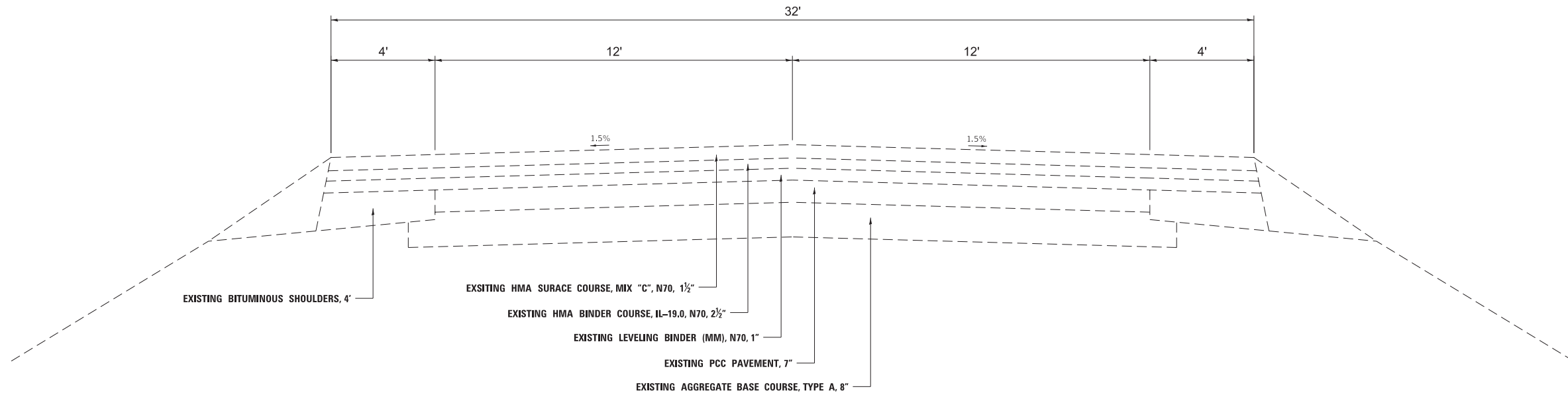

PROPOSED TYPICAL CROSS SECTION #5

SEC 20-00038-06-RS
 DANVERS-YUTON RD (C.H. 18)
 STA. 326+48 TO STA. 329+61
 (NOT TO SCALE)

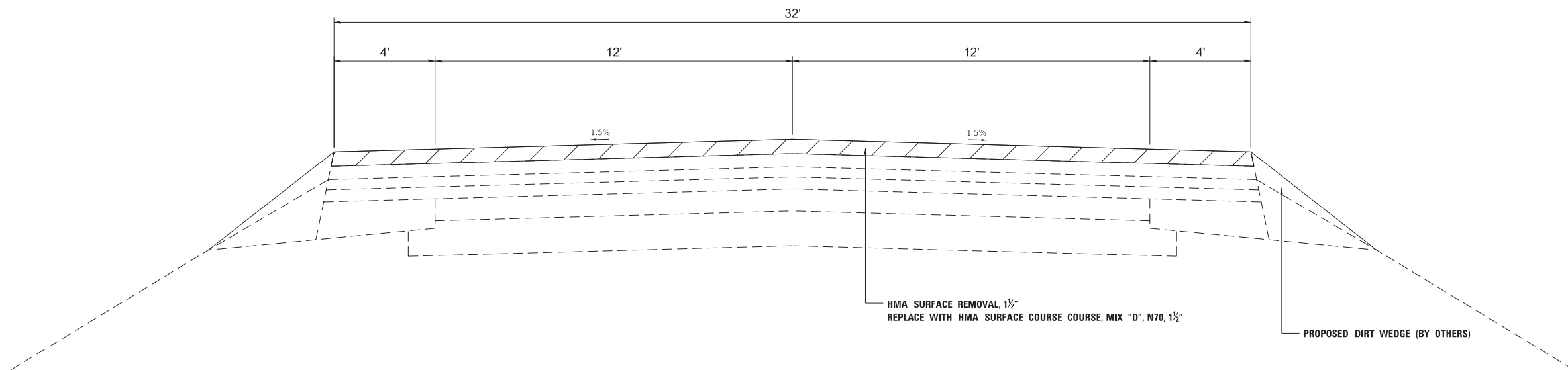

MODEL: Typical Sections 5
 FILE NAME: X:\CountyRoads\CH 18\20-00038-06-RS - Danvers-Yuton Road - 2023\Design\DCN\CADD Data\Sheets\Typical\XS_20-00038-06-RS_Danvers-Yuton Road.dgn

USER NAME = collin.frantz	DESIGNED -	REVISED -
	DRAWN -	REVISED -
PLOT SCALE = 0.083333317' / in.	CHECKED -	REVISED -
PLOT DATE = 12/20/2022	DATE -	REVISED -

**STATE OF ILLINOIS
 DEPARTMENT OF TRANSPORTATION**

**DANVERS-YUTON ROAD
 TYPICAL CROSS SECTIONS**

SCALE: SHEET 8 OF 24 SHEETS STA. TO STA. _____

F.A.S RTE.	SECTION	COUNTY	TOTAL SHEETS	SHEET NO.
471	20-00038-06-RS	MCLEAN	24	8
ILLINOIS FED. AID PROJECT			CONTRACT NO. 91621	

TYPICAL RURAL PRIVATE ENTRANCE

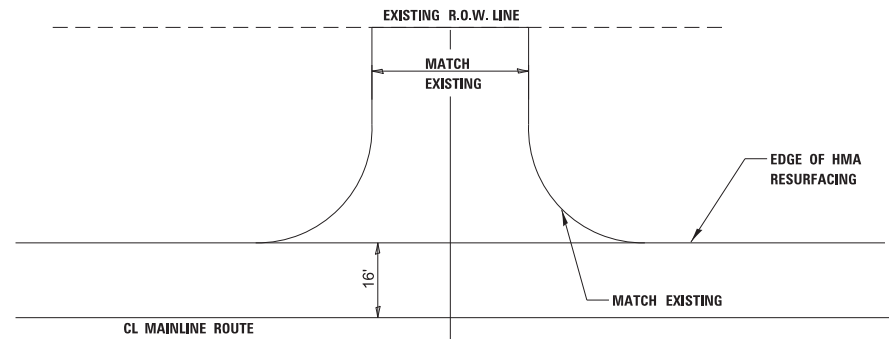

PLAN A

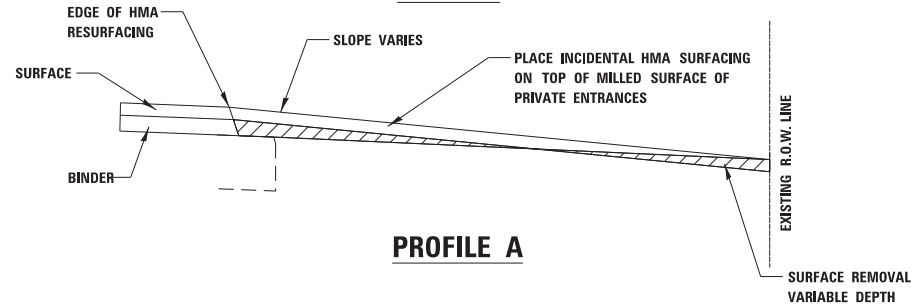

PROFILE A

TYPICAL RURAL MAILBOX TURNOUT

14.4 SQ YD EACH (TYP.)

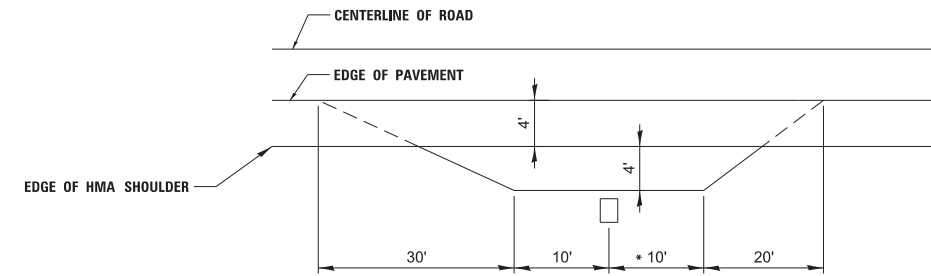

*NOTE: MULTIPLE MAILBOX CLUSTERS TO BE EXTENDED 2' FOR EACH ADDITIONAL MAILBOX

PLAN B

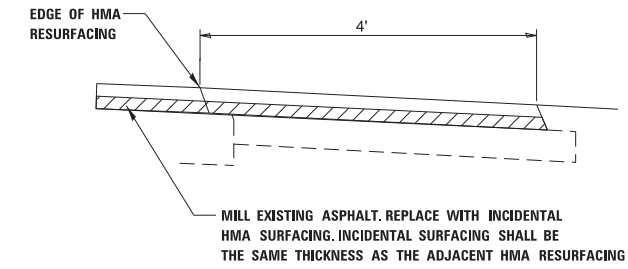

PROFILE B

CURB & GUTTER OUTLET DETAIL

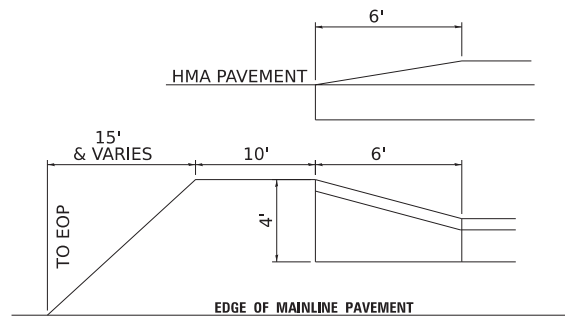

NOTE: CURB & GUTTER OUTLETS WILL BE PAID FOR AS COMBINATION CONCRETE CURB & GUTTER, TYPE B-6.18 OR TYPE M-6.18 AND MEASURED ALONG FACE OF CURB FOR PAYMENT BY THE FOOT AND IS INCLUDED IN PLAN QUANTITY. NO ADDITIONAL COMPENSATION WILL BE ALLOWED.

TYPICAL SIDE ROAD DETAIL

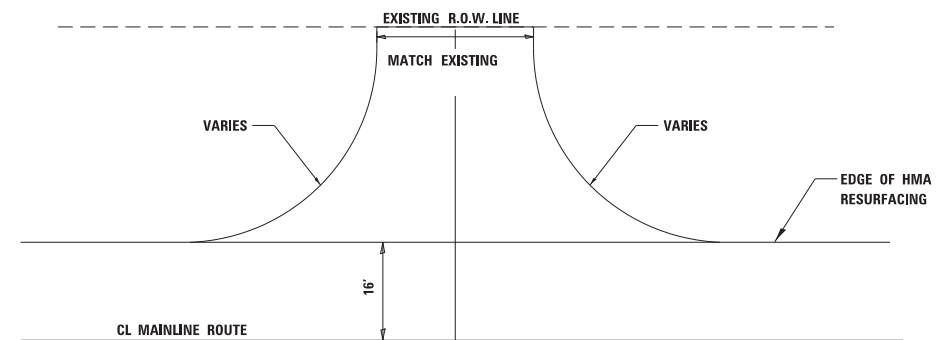

PLAN C

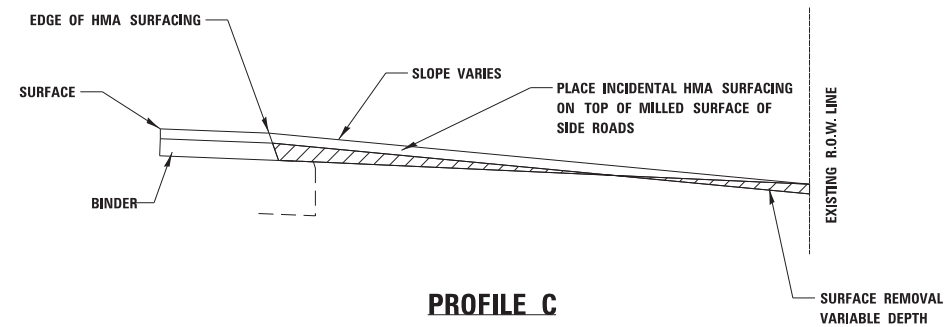

PROFILE C

NOTES:

- ALL SIDE ROAD RETURNS, PRIVATE ENTRANCES, COMMERCIAL ENTRANCES AND RURAL MAILBOX TURNOUTS ARE TO BE CONSTRUCTED AND PAID FROM INCIDENTAL HOT-MIX ASPHALT SURFACING.
- AGGREGATE SHOULDERS SHALL BE PLACED ALONG ALL SIDEROAD RETURN RADII AND SHALL BE PLACED ALONG AND BEHIND ALL FIELD ENTRANCES, GUADRIL AND GUADRIL RUNOUTS, MAILBOX TURNOUTS AND ALL PRIVATE AND COMMERCIAL ENTRANCES UNLESS SPECIFIED BY THE RESIDENT ENGINEER.

MODEL: Miscellaneos Details
FILE NAME: X:\CountyRoads\CH 1820\00038-06-RS - Danvers-Yuton Road - 2023\Design\DCN\CADD Data\Sheets\SC08\Detail_20-00038-06-RS - Danvers-Yuton Road.dgn

USER NAME = collin.frantz	DESIGNED -	REVISED -
	DRAWN -	REVISED -
PLOT SCALE = 0.08333317' / in.	CHECKED -	REVISED -
PLOT DATE = 12/20/2022	DATE -	REVISED -

**STATE OF ILLINOIS
DEPARTMENT OF TRANSPORTATION**

**DANVERS-YUTON ROAD
MISCELLANEOUS DETAILS**

SCALE: SHEET 9 OF 24 SHEETS STA. TO STA. _____

F.A.S RTE.	SECTION	COUNTY	TOTAL SHEETS	SHEET NO.
471	20-00038-06-RS	MCLEAN	24	9
CONTRACT NO. 91621				
ILLINOIS FED. AID PROJECT				

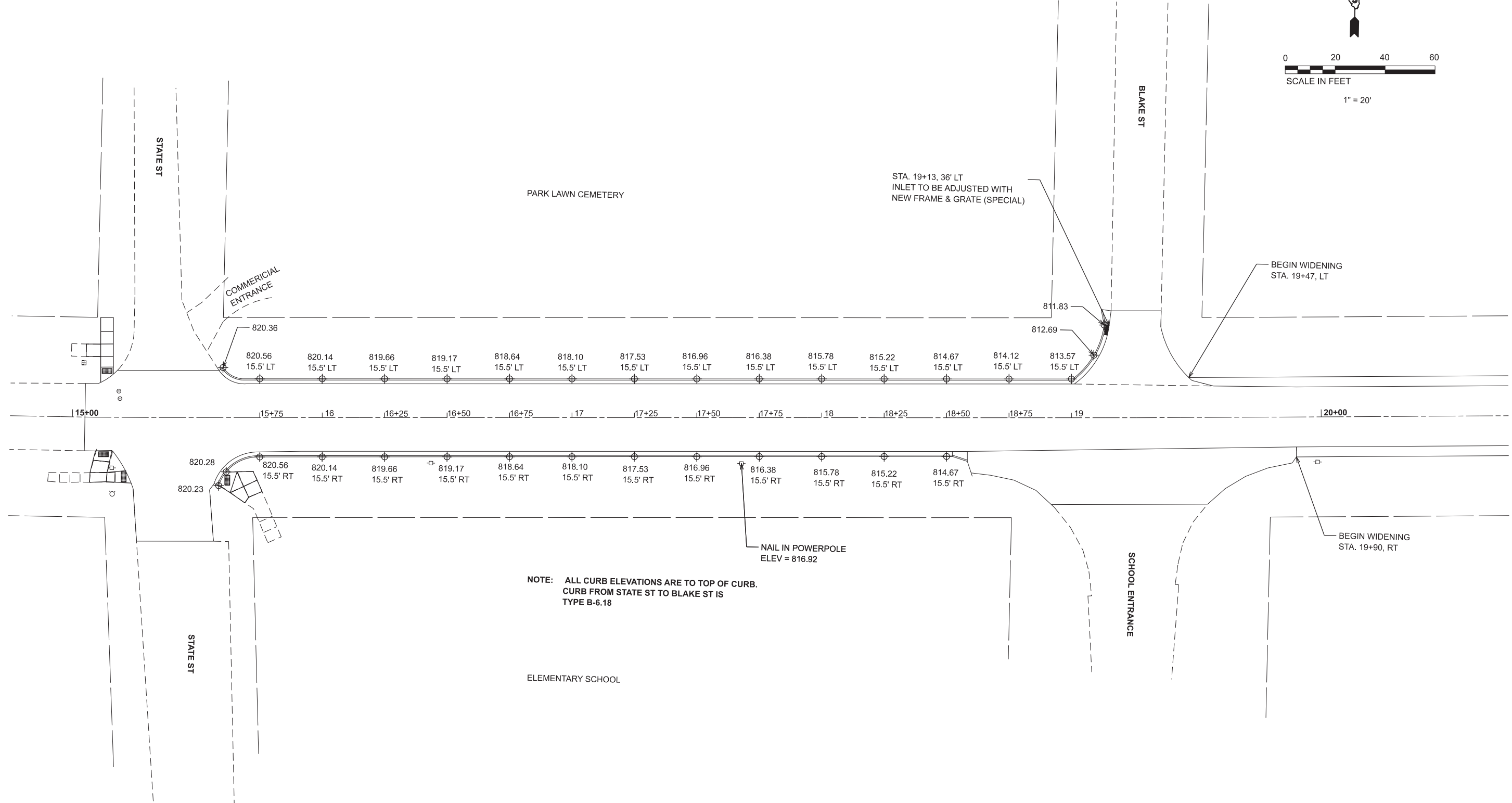
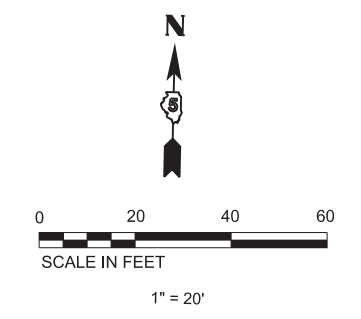

NOTE: ALL CURB ELEVATIONS ARE TO TOP OF CURB.
CURB FROM STATE ST TO BLAKE ST IS
TYPE B-6.18

MODEL: School_CurbSideElev.dwg (Sheet)
 FILE NAME: X:\CountyRoads\CH 1920\0038-06-RS - Danvers-Yuton Road - 2023\Design\DCN\CADD Data\Sheets\SchoolCurb_20-00038-06-RS_Danvers-Yuton Road.dgn

USER NAME = collin.frantz	DESIGNED -	REVISED -
	DRAWN -	REVISED -
PLOT SCALE = 0.08333317' / in.	CHECKED -	REVISED -
PLOT DATE = 12/20/2022	DATE -	REVISED -

**STATE OF ILLINOIS
DEPARTMENT OF TRANSPORTATION**

**DANVERS-YUTON ROAD
STATE ST CURB ELEVATIONS**

SCALE: 1"=20' SHEET 10 OF 24 SHEETS STA. TO STA.

F.A.S RTE.	SECTION	COUNTY	TOTAL SHEETS	SHEET NO.
471	20-00038-06-RS	MCLEAN	24	10
CONTRACT NO. 91621				
ILLINOIS FED. AID PROJECT				

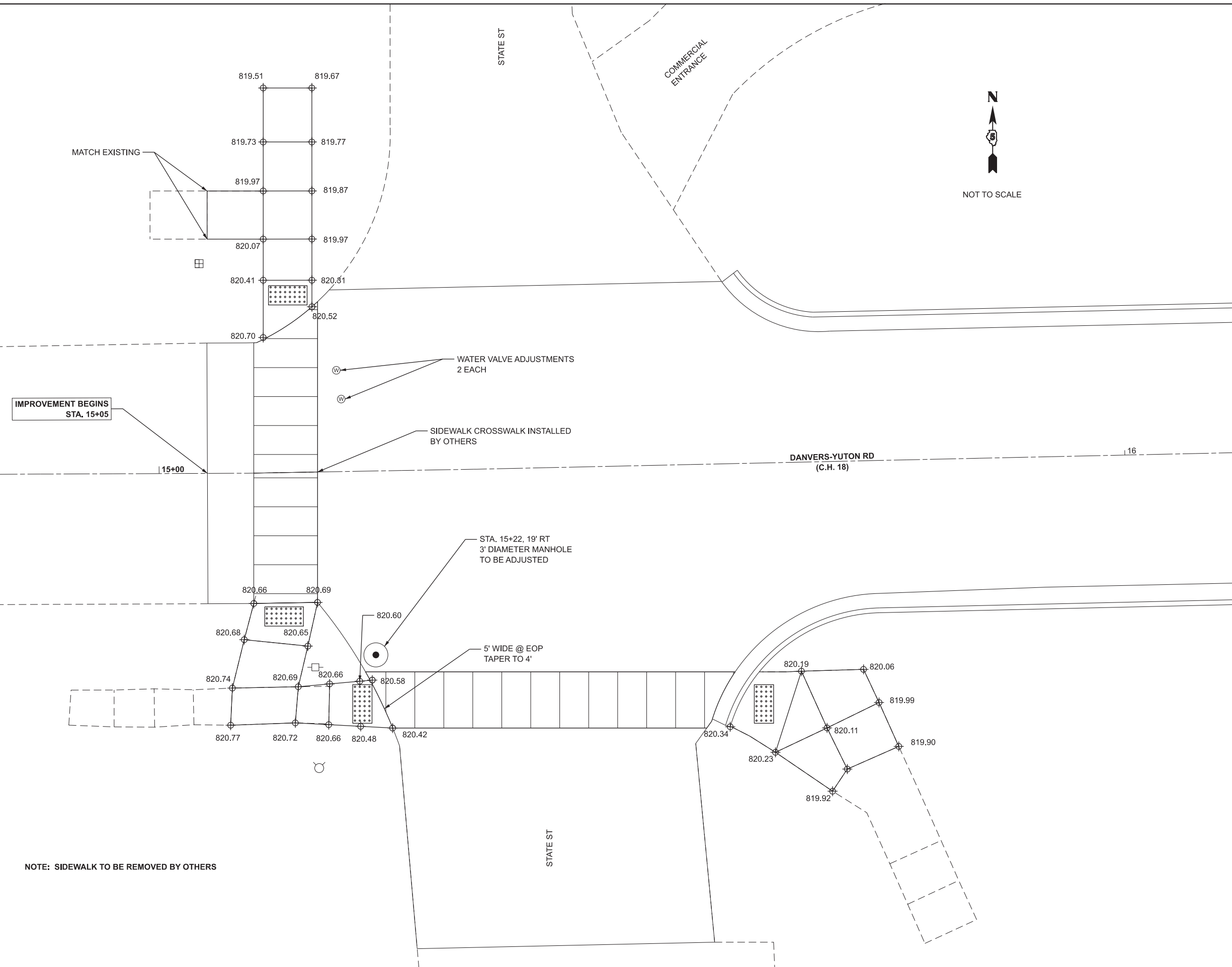
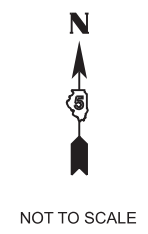

MODEL: School_Sidewalk.dwg
 FILE NAME: X:\CountyRoads\CH_1820\00038-06-RS-Danvers-Yuton Road - 2023\Design\DCN\CADD Data\Sidewalk\SchoolCurb_20-00038-06-RS-Danvers-Yuton Road.dwg

IMPROVEMENT BEGINS
STA. 15+05

WATER VALVE ADJUSTMENTS
2 EACH

SIDEWALK CROSSWALK INSTALLED
BY OTHERS

STA. 15+22, 19' RT
3' DIAMETER MANHOLE
TO BE ADJUSTED

5' WIDE @ EOP
TAPER TO 4'

NOTE: SIDEWALK TO BE REMOVED BY OTHERS

USER NAME = collin.frantz	DESIGNED -	REVISED -
	DRAWN -	REVISED -
PLOT SCALE = 0.08333317' / in.	CHECKED -	REVISED -
PLOT DATE = 12/20/2022	DATE -	REVISED -

**STATE OF ILLINOIS
DEPARTMENT OF TRANSPORTATION**

**DANVERS-YUTON ROAD
STATE ST SIDEWALK DETAILS**

SCALE: SHEET 11 OF 24 SHEETS STA. ___ TO STA. ___

F.A.S RTE.	SECTION	COUNTY	TOTAL SHEETS	SHEET NO.
471	20-00038-06-RS	MCLEAN	24	11
CONTRACT NO. 91621			ILLINOIS FED. AID PROJECT	

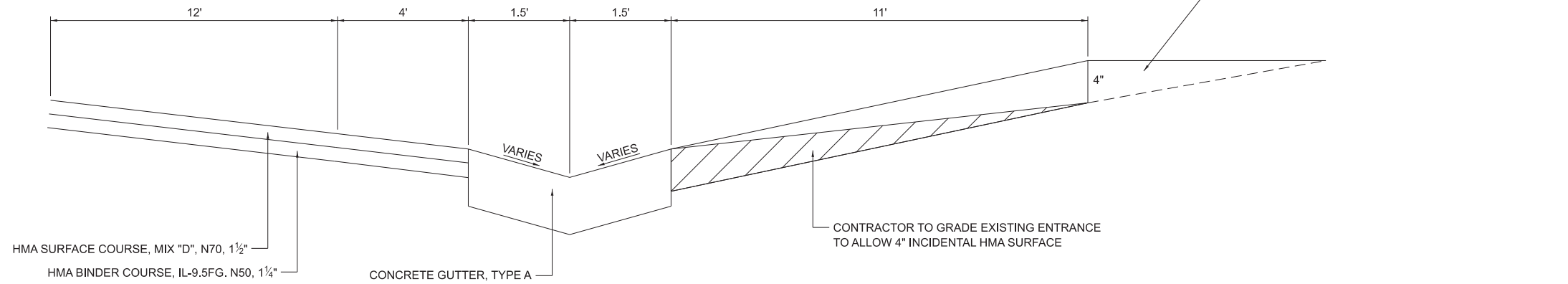

PROFILE D

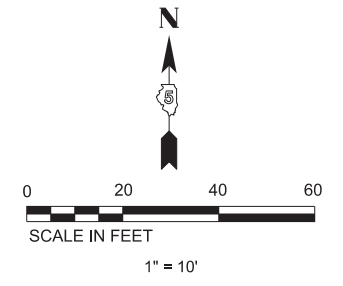

END WIDENING STA. 320+23, LT & RT

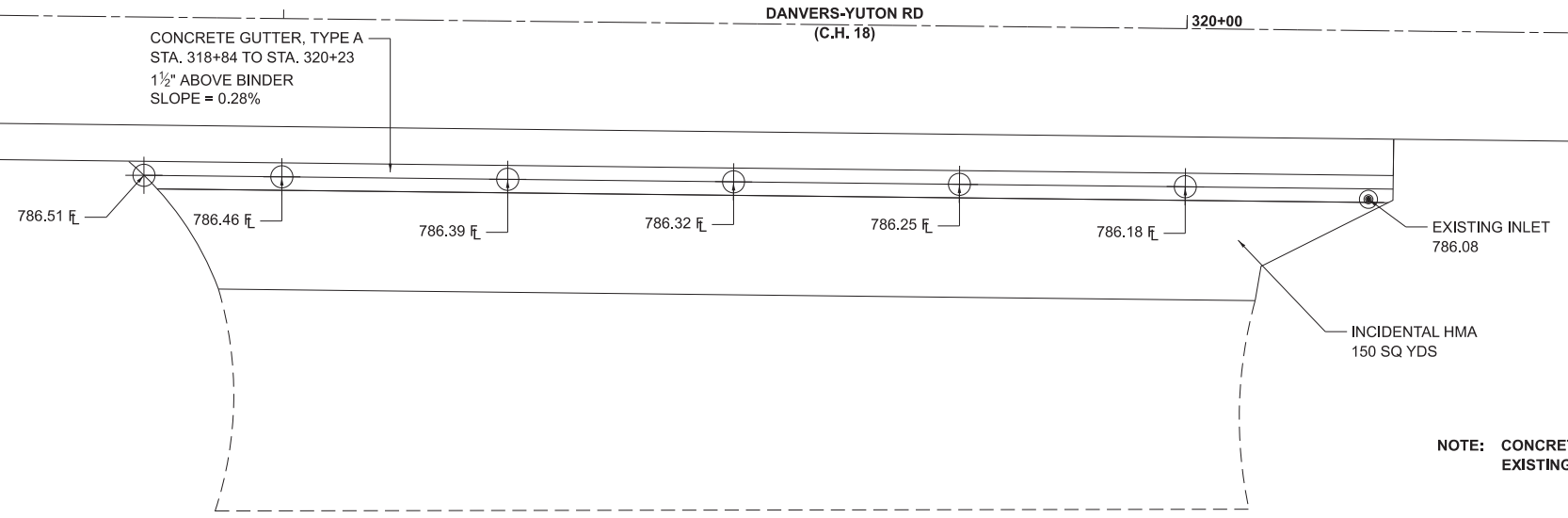

PLAN D

CHISELED X IN CONCRETE PAD
ELEV = 789.00

MODEL: Elevator Entrance (Sheet)
FILE NAME: X:\CountyProjects\CH1820-00038-06-RS - Danvers-Yuton Road - 2023\Design\DCN\CADD Data\Sheets\PlanView_20-00038-06-RS_Danvers-Yuton Road.dgn

USER NAME = collin.frantz	DESIGNED -	REVISED -
	DRAWN -	REVISED -
PLOT SCALE = 0.08333317' / in.	CHECKED -	REVISED -
PLOT DATE = 12/20/2022	DATE -	REVISED -

**STATE OF ILLINOIS
DEPARTMENT OF TRANSPORTATION**

**DANVERS-YUTON RD
ELEVATOR ENTRANCE**

SCALE: 1"=10' SHEET 12 OF 24 SHEETS STA. ___+___ TO STA. ___+___

F.A.S RTE.	SECTION	COUNTY	TOTAL SHEETS	SHEET NO.
471	20-00038-06-RS	MCLEAN	24	12
CONTRACT NO. 91621				
ILLINOIS FED. AID PROJECT				



NOT TO SCALE

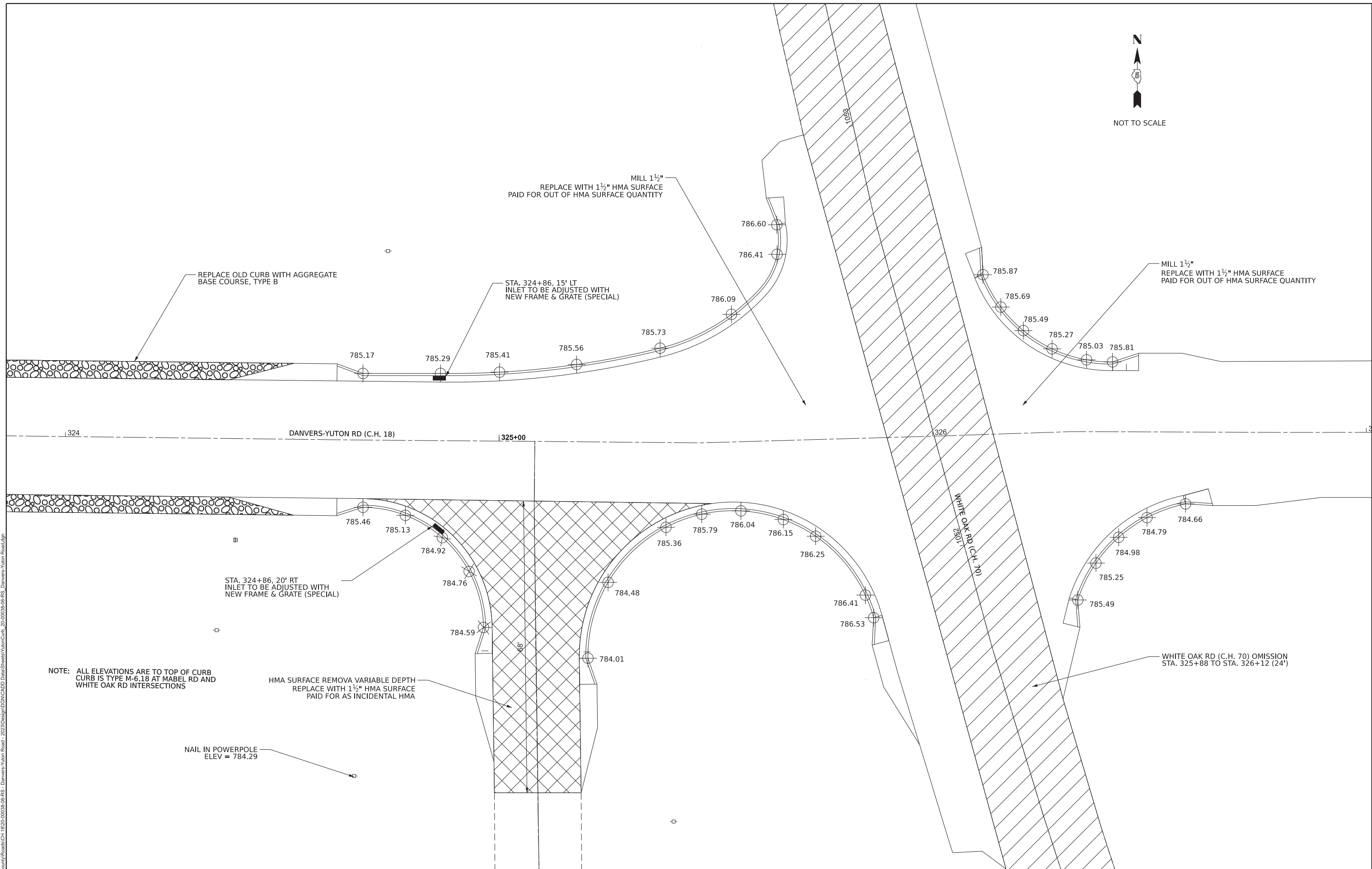

NOTE: ALL ELEVATIONS ARE TO TOP OF CURB
CURB IS TYPE M-6.18 AT MABEL RD AND
WHITE OAK RD INTERSECTIONS

HMA SURFACE REMOVA VARIABLE DEPTH
REPLACE WITH 1 1/2" HMA SURFACE
PAID FOR AS INCIDENTAL HMA

NAIL IN POWERPOLE
ELEV = 784.29

MODEL: Curb Replacement Utilities (Sheet)
FILE NAME: X:\County\Roads\CH 18\20-00038-06-RS - Danvers-Yuton Road - 2023\Design\DCN\CADD Data\Sheets\YutonCurb_20-00038-06-RS - Danvers-Yuton Road.dgn

USER NAME = collin.frantz	DESIGNED -	REVISED -
DRAWN -	REVISED -	
PLOT SCALE = 0.08333317' / in.	CHECKED -	REVISED -
PLOT DATE = 12/20/2022	DATE -	REVISED -

**STATE OF ILLINOIS
DEPARTMENT OF TRANSPORTATION**

**DANVERS-YUTON ROAD
YUTON CURB REPLACEMENT**

SCALE: SHEET 13 OF 24 SHEETS STA. ___ TO STA. ___

F.A.S RTE. 471	SECTION 20-00038-06-RS	COUNTY MCLEAN	TOTAL SHEETS 24	SHEET NO. 13
CONTRACT NO. 91621			ILLINOIS FED. AID PROJECT	

MODEL: C:\MS_Plan_1 (Sheet)
 FILE NAME: X:\County\Roads\CH_1820\00038-06-RS - Danvers-Yuton Road - 2023\Design\DCN\CADD Data\Sheet\PlanView_20-00038-06-RS - Danvers-Yuton Road.dgn

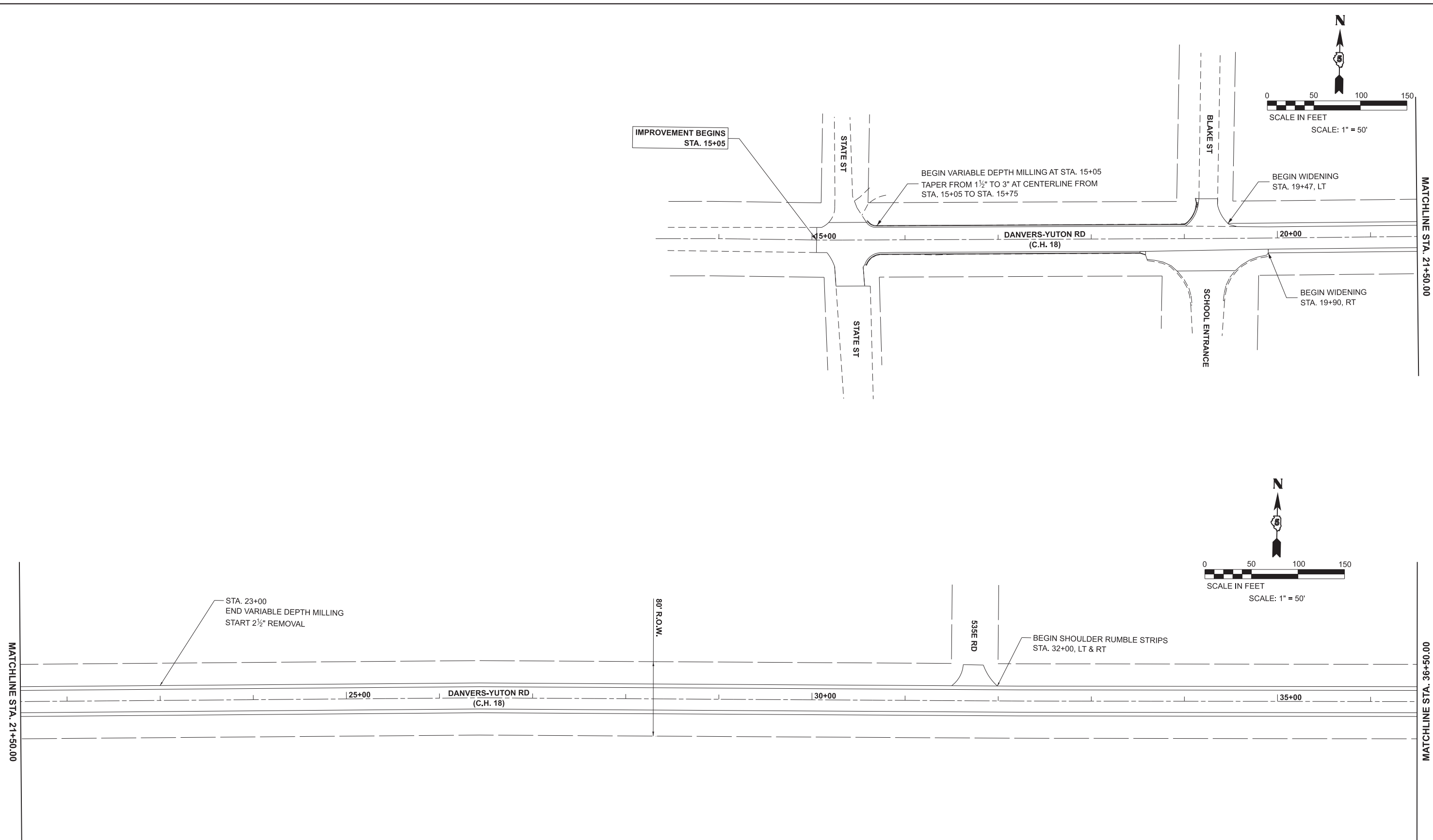

USER NAME = collin.frantz	DESIGNED -	REVISED -
DRAWN -	REVISED -	
PLOT SCALE = 0.08333317' / in.	CHECKED -	REVISED -
PLOT DATE = 12/20/2022	DATE -	REVISED -

**STATE OF ILLINOIS
 DEPARTMENT OF TRANSPORTATION**

**DANVERS-YUTON ROAD
 PLAN VIEW**

SCALE: 1"=50' SHEET 14 OF 24 SHEETS STA. TO STA.

F.A.S RTE.	SECTION	COUNTY	TOTAL SHEETS	SHEET NO.
471	20-00038-06-RS	MCLEAN	24	14
CONTRACT NO. 91621			ILLINOIS FED. AID PROJECT	

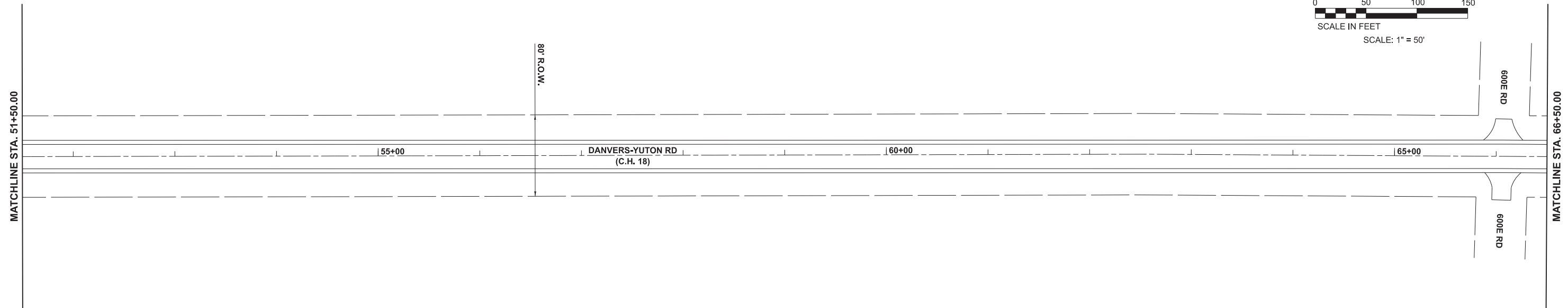
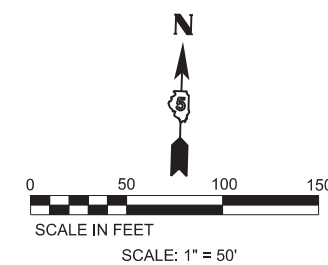
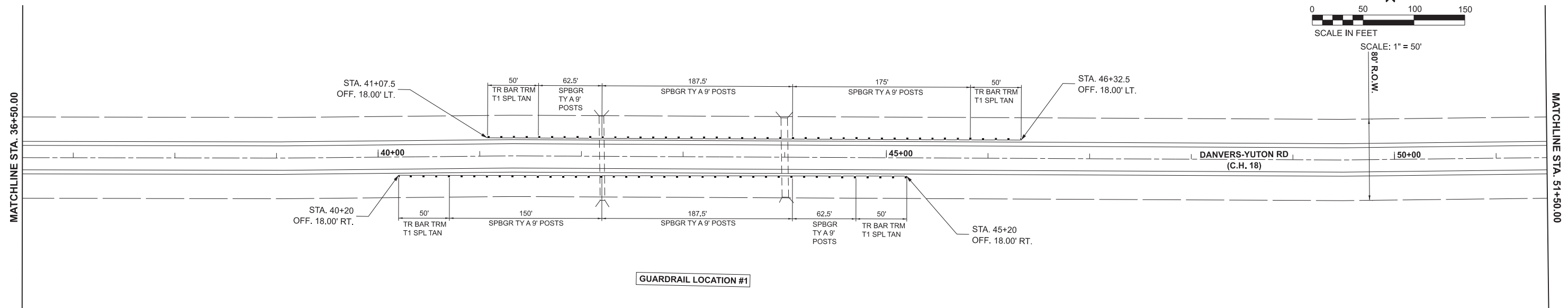
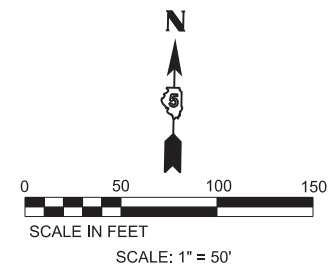

MODEL: C:\MS_Plan_9 (Sheet)
 FILE NAME: X:\County\State\CH 18\20-00038-06-RS - Danvers-Yuton Road - 2023\Design\DCN\CADD Data\Sheet\PlanView_20-00038-06-RS - Danvers-Yuton Road.dgn

USER NAME = collin.frantz	DESIGNED -	REVISED -
DRAWN -	REVISED -	
PLOT SCALE = 0.08333317' / in.	CHECKED -	REVISED -
PLOT DATE = 12/20/2022	DATE -	REVISED -

STATE OF ILLINOIS
DEPARTMENT OF TRANSPORTATION

DANVERS-YUTON ROAD
PLAN VIEW

SCALE: 1"=50' SHEET 15 OF 24 SHEETS STA. TO STA.

F.A.S RTE.	SECTION	COUNTY	TOTAL SHEETS	SHEET NO.
471	20-00038-06-RS	MCLEAN	24	15
CONTRACT NO. 91621				
ILLINOIS FED. AID PROJECT				

MODEL: C:\MS_Plan_8 (Sheet)
 FILE NAME: X:\County\Roads\CH 1820\00038-06-RS - Danvers-Yuton Road - 2023\Design\DCN\CADD Data\Sheet\PlanView_20-00038-06-RS - Danvers-Yuton Road.dgn

MATCHLINE STA. 66+50.00

MATCHLINE STA. 81+50.00

MATCHLINE STA. 81+50.00

MATCHLINE STA. 96+50.00

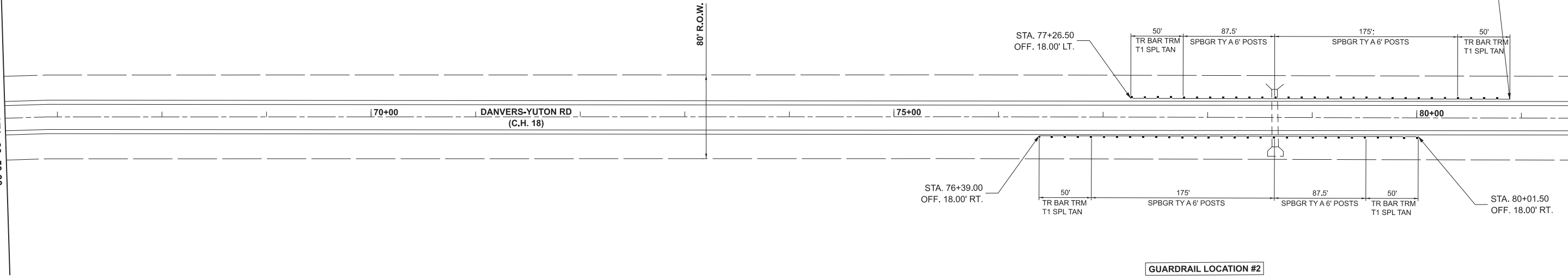

GUARDRAIL LOCATION #2

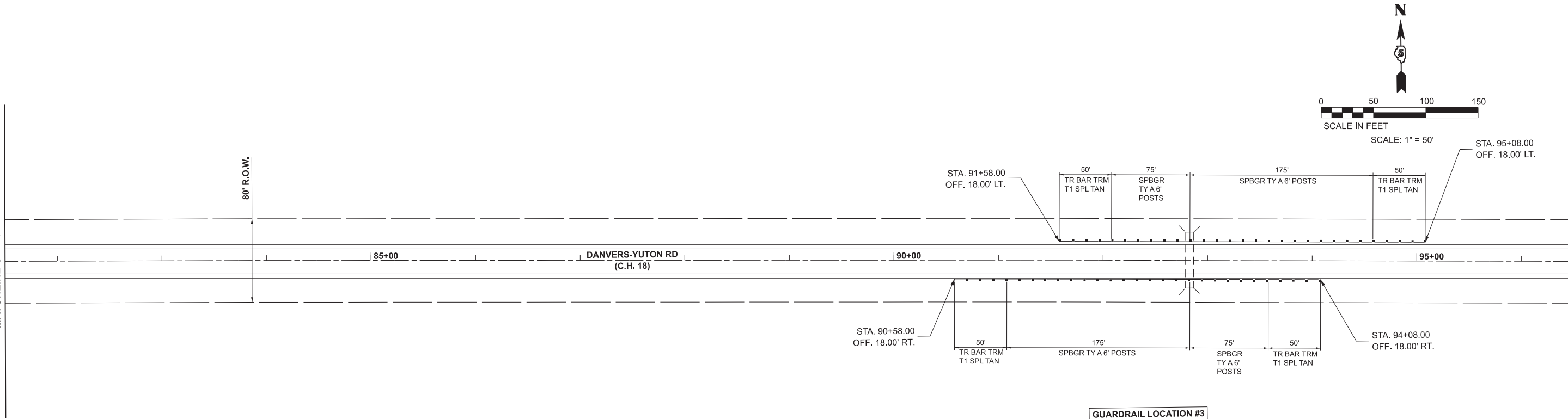

GUARDRAIL LOCATION #3

USER NAME = collin.frantz	DESIGNED -	REVISED -
DRAWN -	REVISED -	
PLOT SCALE = 0.083333317' / in.	CHECKED -	REVISED -
PLOT DATE = 12/20/2022	DATE -	REVISED -

**STATE OF ILLINOIS
 DEPARTMENT OF TRANSPORTATION**

**DANVERS-YUTON ROAD
 PLAN VIEW**

SCALE: 1"=50' SHEET 16 OF 24 SHEETS STA. TO STA.

F.A.S. RTE.	SECTION	COUNTY	TOTAL SHEETS	SHEET NO.
471	20-00038-06-RS	MCLEAN	24	16
CONTRACT NO. 91621			ILLINOIS FED. AID PROJECT	

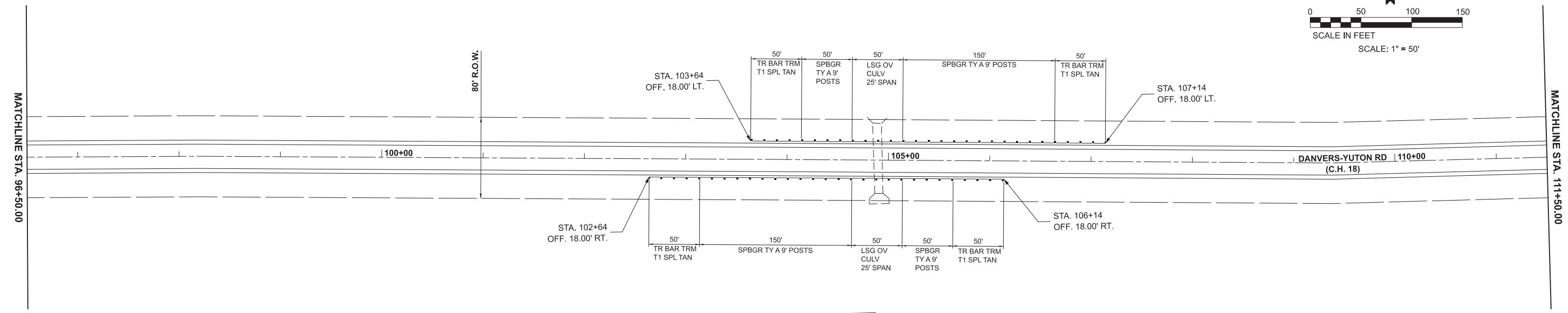
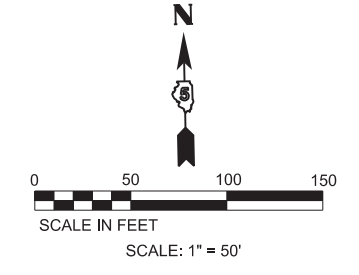

GUARDRAIL LOCATION #4

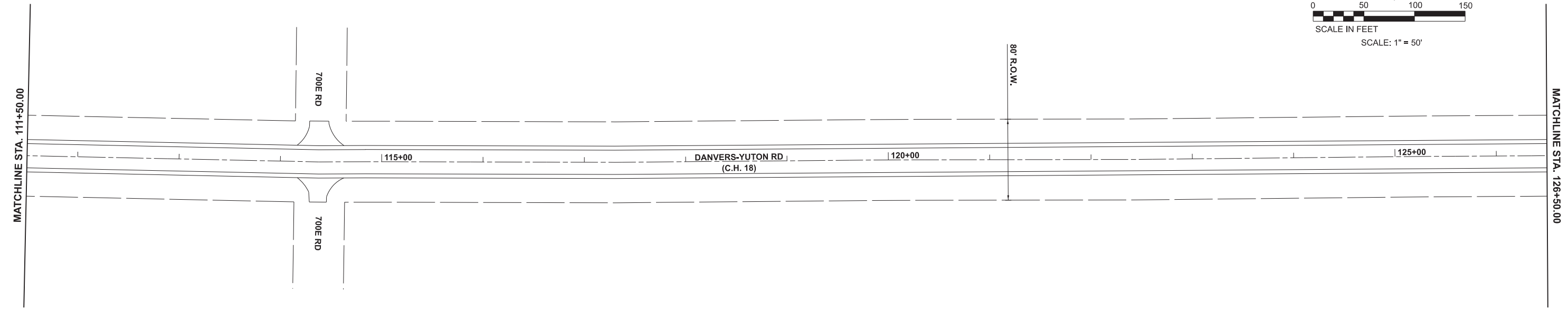
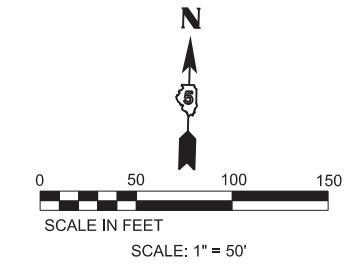

MODEL: C:\MS_Plan7 (Sheet)
 FILE NAME: X:\Country\Roads\CH 18\20\Design\DCN\CADD Data\Sheet\PlanView_20-00038-06-RS_Danvers-Yuton Road.dgn

USER NAME = collin.frantz	DESIGNED -	REVISED -
DRAWN -	REVISED -	
PLOT SCALE = 0.08333317' / in.	CHECKED -	REVISED -
PLOT DATE = 12/20/2022	DATE -	REVISED -

STATE OF ILLINOIS
DEPARTMENT OF TRANSPORTATION

DANVERS-YUTON ROAD
PLAN VIEW

SCALE: 1"=50' SHEET 17 OF 24 SHEETS STA. TO STA.

F.A.S RTE.	SECTION	COUNTY	TOTAL SHEETS	SHEET NO.
471	20-00038-06-RS	MCLEAN	24	17
CONTRACT NO. 91621				
ILLINOIS FED. AID PROJECT				

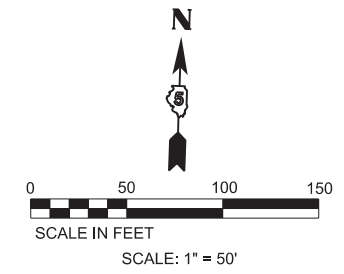

MATCHLINE STA. 126+50.00

MATCHLINE STA. 141+50.00

130+00

DANVERS-YUTON RD
(C.H. 18)

135+00

140+00

80' R.O.W.

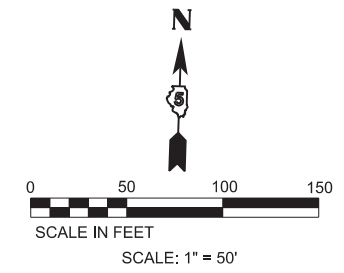

MATCHLINE STA. 141+50.00

MATCHLINE STA. 156+50.00

145+00

DANVERS-YUTON RD
(C.H. 18)

150+00

155+00

80' R.O.W.

MODEL: C:\MS_Plan_9 (Sheet)
FILE NAME: X:\County\Roads\CH_1820\00038-06-RS - Danvers-Yuton Road - 2023\Design\DCN\CADD Data\Sheet\PlanView_20-00038-06-RS - Danvers-Yuton Road.dgn

USER NAME = collin.frantz	DESIGNED -	REVISED -
	DRAWN -	REVISED -
PLOT SCALE = 0.083333317' / in.	CHECKED -	REVISED -
PLOT DATE = 12/20/2022	DATE -	REVISED -

**STATE OF ILLINOIS
DEPARTMENT OF TRANSPORTATION**

**DANVERS-YUTON ROAD
PLAN VIEW**

SCALE: 1"=50' SHEET 18 OF 24 SHEETS STA. TO STA.

F.A.S RTE.	SECTION	COUNTY	TOTAL SHEETS	SHEET NO.
471	20-00038-06-RS	MCLEAN	24	18
CONTRACT NO. 91621			ILLINOIS FED. AID PROJECT	

MODEL: C:\18_Plan_11 (Sheet)
 FILE NAME: X:\County\Roads\CH 1820\00038-06-RS - Danvers-Yuton Road - 2023\Design\DCN\CADD Data\Sheet\PlanView_20-00038-06-RS_Danvers-Yuton Road.dgn

MATCHLINE STA. 156+50.00

MATCHLINE STA. 171+50.00

MATCHLINE STA. 171+50.00

MATCHLINE STA. 186+50.00

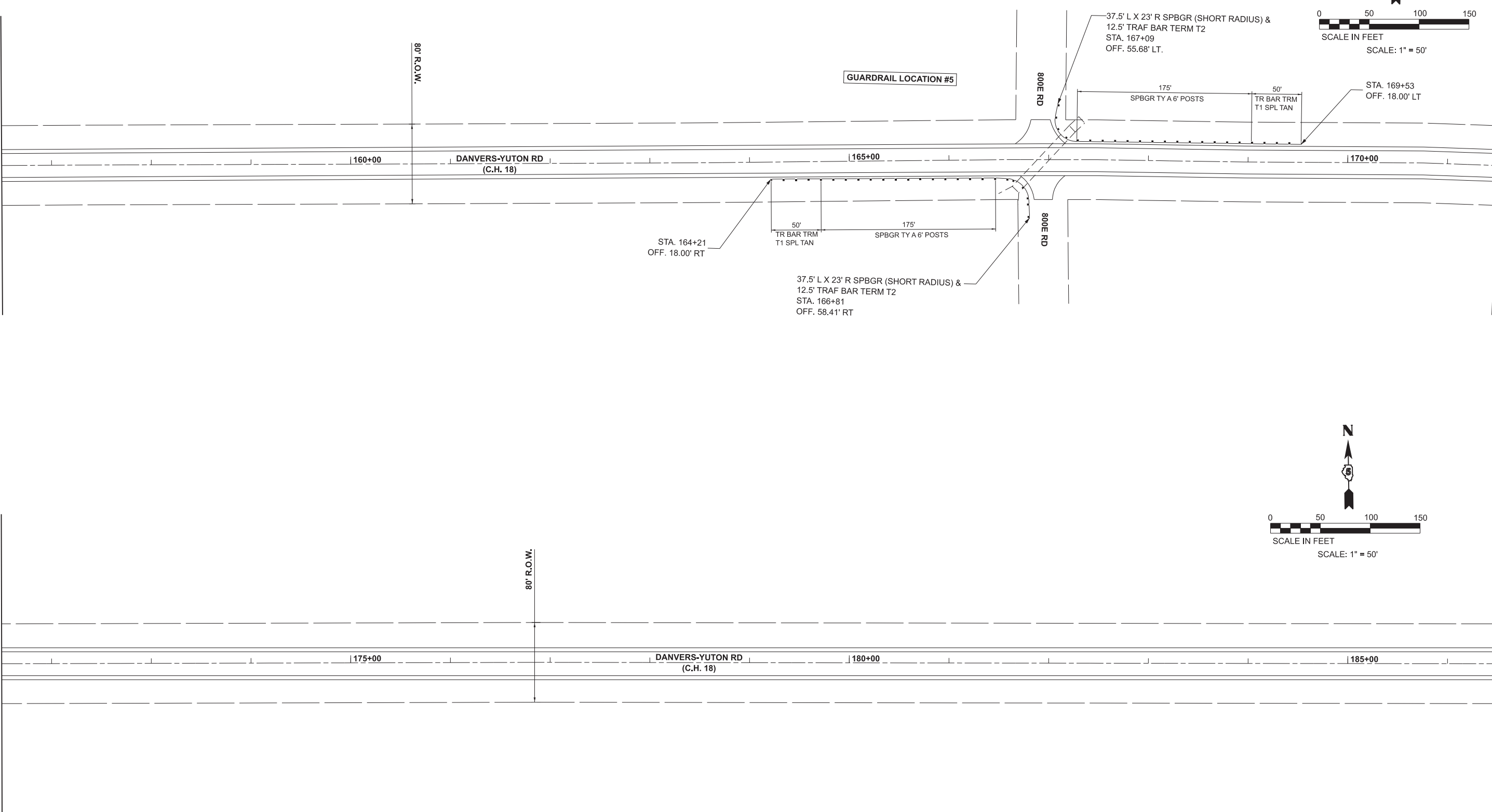

USER NAME = colln.frantz	DESIGNED -	REVISED -
	DRAWN -	REVISED -
PLOT SCALE = 0.083333317' / in.	CHECKED -	REVISED -
PLOT DATE = 12/20/2022	DATE -	REVISED -

**STATE OF ILLINOIS
 DEPARTMENT OF TRANSPORTATION**

**DANVERS-YUTON ROAD
 PLAN VIEW**

SCALE: 1"=50' SHEET 19 OF 24 SHEETS STA. TO STA.

F.A.S RTE.	SECTION	COUNTY	TOTAL SHEETS	SHEET NO.
471	20-00038-06-RS	MCLEAN	24	19
CONTRACT NO. 91621			ILLINOIS FED. AID PROJECT	

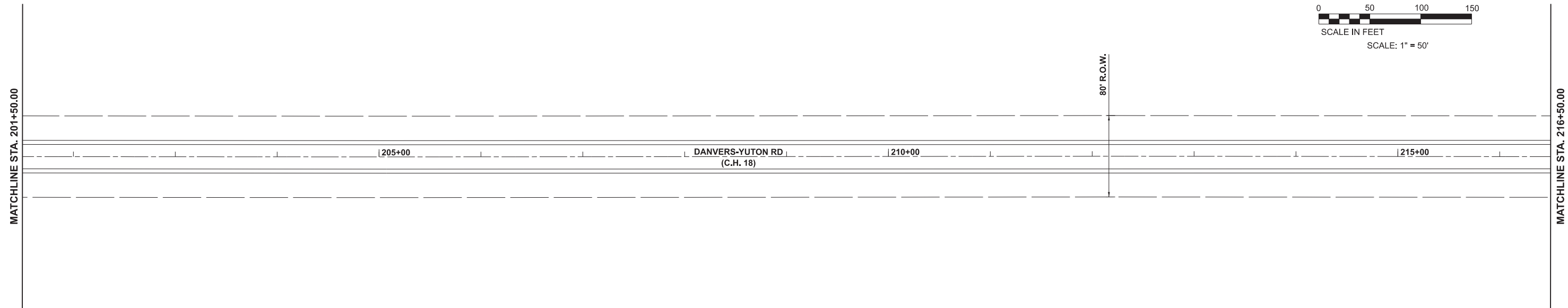
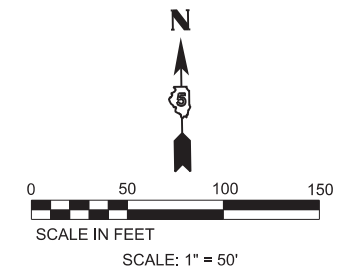
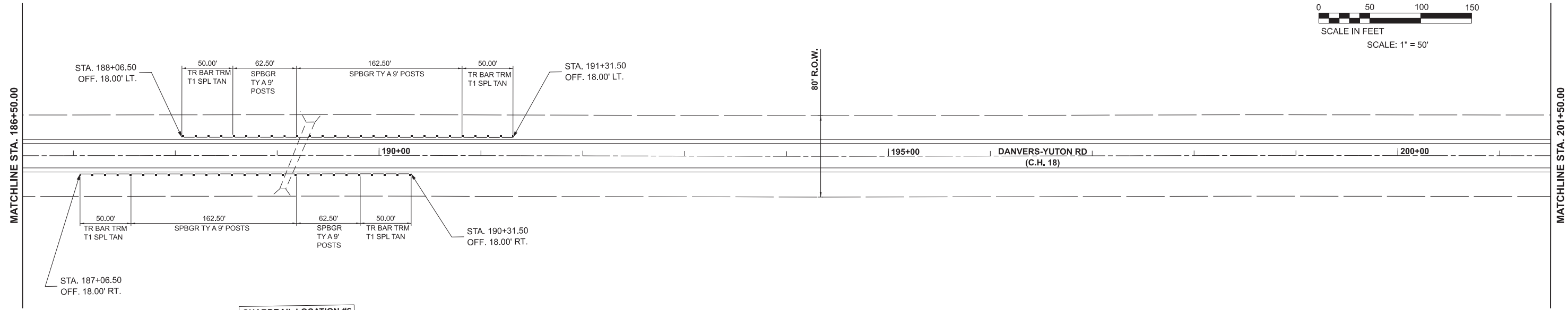
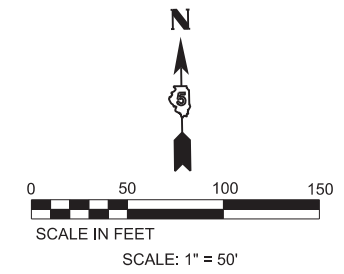

MODEL: C:\18_Plan_13 (Sheet)
 FILE NAME: X:\CountyRoads\CH 18\20-00038-06-RS - Danvers-Yuton Road - 2023\Design\DCN\CADD Data\Sheet\PlanView_20-00038-06-RS - Danvers-Yuton Road.dgn

USER NAME = collin.frantz	DESIGNED -	REVISED -
DRAWN -	REVISOR -	
PLOT SCALE = 0.08333317' / in.	CHECKED -	REVISED -
PLOT DATE = 12/20/2022	DATE -	REVISED -

STATE OF ILLINOIS
DEPARTMENT OF TRANSPORTATION

DANVERS-YUTON ROAD
PLAN VIEW

SCALE: 1"=50' SHEET 20 OF 24 SHEETS STA. TO STA.

F.A.S RTE.	SECTION	COUNTY	TOTAL SHEETS	SHEET NO.
471	20-00038-06-RS	MCLEAN	24	20
CONTRACT NO. 91621				
ILLINOIS FED. AID PROJECT				

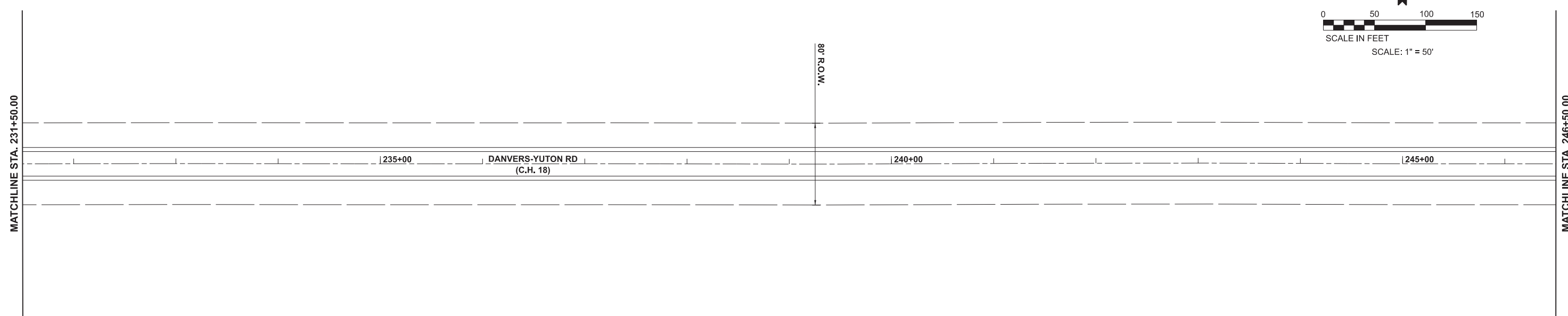
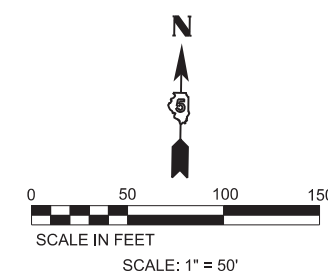
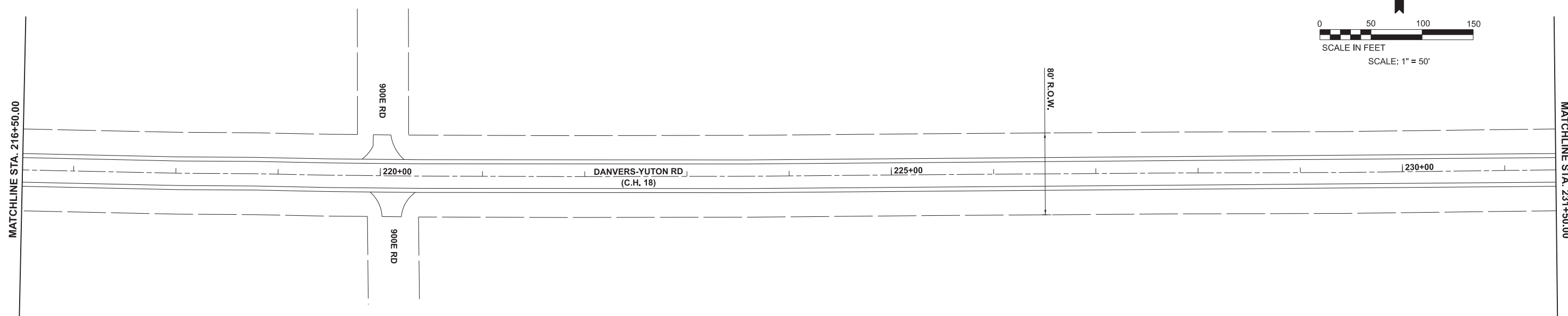
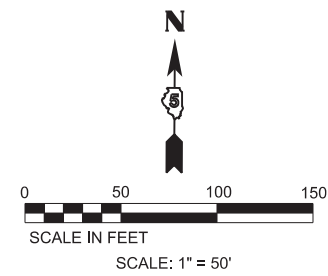

MODEL: C:\18_Plan_15 (Sheet)
 FILE NAME: X:\CountyRoads\CH 18\20-00038-06-RS - Danvers-Yuton Road - 2023\Design\DCN\CADD Data\Sheet\PlanView_20-00038-06-RS - Danvers-Yuton Road.dgn

USER NAME = collin.frantz	DESIGNED -	REVISED -
DRAWN -	REVISED -	
PLOT SCALE = 0.083333317' / in.	CHECKED -	REVISED -
PLOT DATE = 12/20/2022	DATE -	REVISED -

STATE OF ILLINOIS
DEPARTMENT OF TRANSPORTATION

DANVERS-YUTON ROAD
PLAN VIEW

SCALE: 1"=50' SHEET 21 OF 24 SHEETS STA. TO STA.

F.A.S RTE.	SECTION	COUNTY	TOTAL SHEETS	SHEET NO.
471	20-00038-06-RS	MCLEAN	24	21
CONTRACT NO. 91621				
ILLINOIS FED. AID PROJECT				

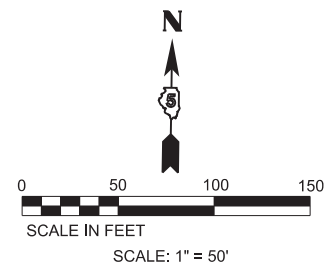

MATCHLINE STA. 246+50.00

MATCHLINE STA. 261+50.00

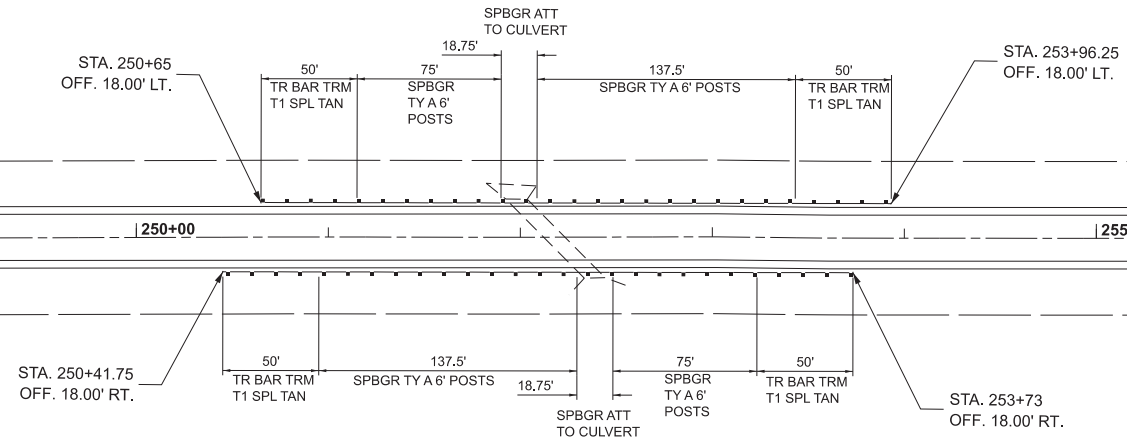

GUARDRAIL LOCATION #7

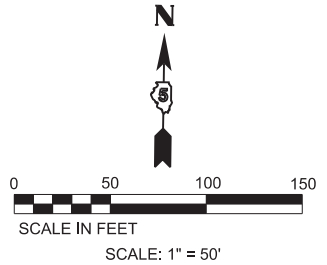
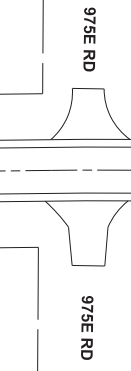

MATCHLINE STA. 261+50.00

MATCHLINE STA. 276+50.00

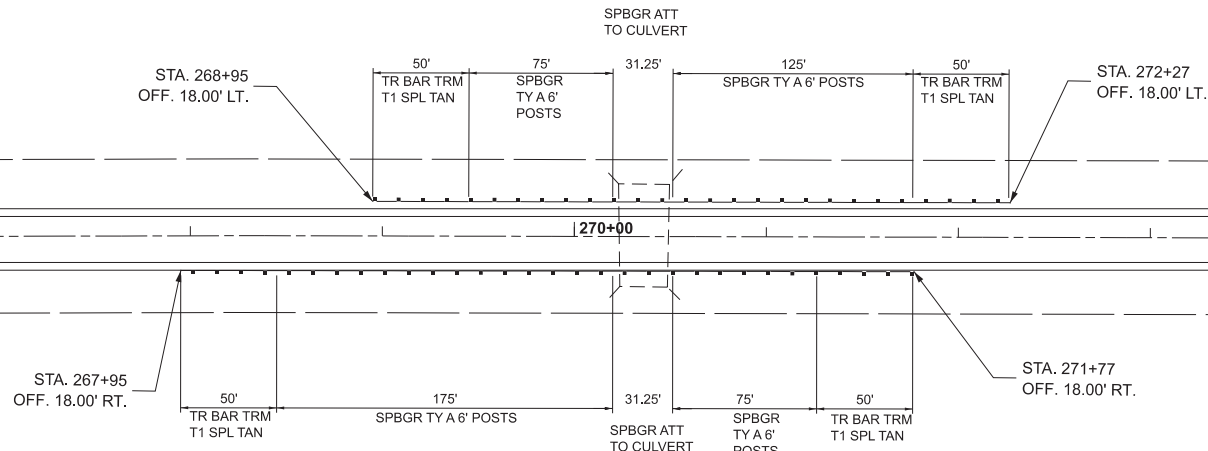

GUARDRAIL LOCATION #8

MODEL: C:\18_Plan_17 (Sheet)
FILE NAME: X:\CountyRoads\CH 18\20-00038-06-RS - Danvers-Yuton Road - 2023\Design\DCN\CADD Data\Sheet\PlanView_20-00038-06-RS - Danvers-Yuton Road.dgn

USER NAME = collin.frantz	DESIGNED -	REVISED -
	DRAWN -	REVISED -
PLOT SCALE = 0.083333317' / in.	CHECKED -	REVISED -
PLOT DATE = 12/20/2022	DATE -	REVISED -

**STATE OF ILLINOIS
DEPARTMENT OF TRANSPORTATION**

**DANVERS-YUTON ROAD
PLAN VIEW**

SCALE: 1"=50' SHEET 22 OF 24 SHEETS STA. TO STA.

F.A.S RTE.	SECTION	COUNTY	TOTAL SHEETS	SHEET NO.
471	20-00038-06-RS	MCLEAN	24	22
CONTRACT NO. 91621				
ILLINOIS FED. AID PROJECT				

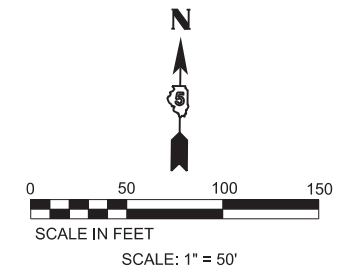

MATCHLINE STA. 276+50.00

MATCHLINE STA. 291+50.00

280+00 DANVERS-YUTON RD (C.H. 18) 285+00 290+00

80' R.O.W.

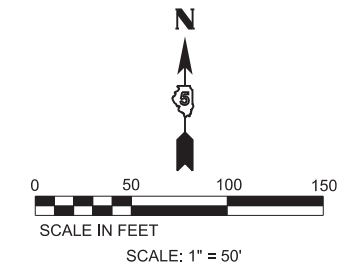

MATCHLINE STA. 291+50.00

MATCHLINE STA. 306+50.00

295+00 DANVERS-YUTON RD (C.H. 18) 300+00 305+00

80' R.O.W.

MODEL: C:\MS_Plan_10 (Sheet)
FILE NAME: X:\CountyRoads\CH 18\20-00038-06-RS - Danvers-Yuton Road - 2023\Design\DCN\CADD Data\Sheet\PlanView_20-00038-06-RS - Danvers-Yuton Road.dgn

USER NAME = collin.frantz	DESIGNED -	REVISED -
	DRAWN -	REVISED -
PLOT SCALE = 0.083333317' / in.	CHECKED -	REVISED -
PLOT DATE = 12/20/2022	DATE -	REVISED -

**STATE OF ILLINOIS
DEPARTMENT OF TRANSPORTATION**

**DANVERS-YUTON ROAD
PLAN VIEW**

SCALE: 1"=50' SHEET 23 OF 24 SHEETS STA. TO STA.

F.A.S RTE.	SECTION	COUNTY	TOTAL SHEETS	SHEET NO.
471	20-00038-06-RS	MCLEAN	24	23
CONTRACT NO. 91621			ILLINOIS FED. AID PROJECT	

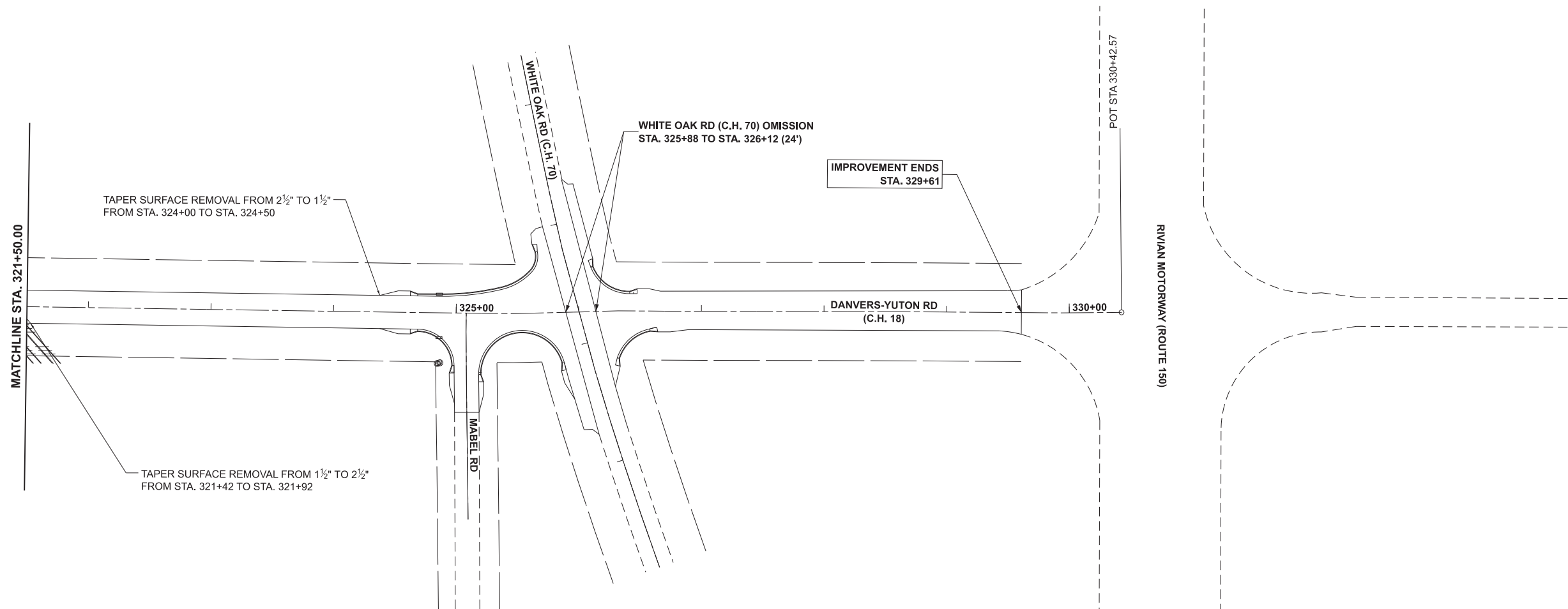
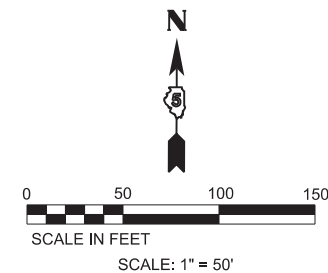
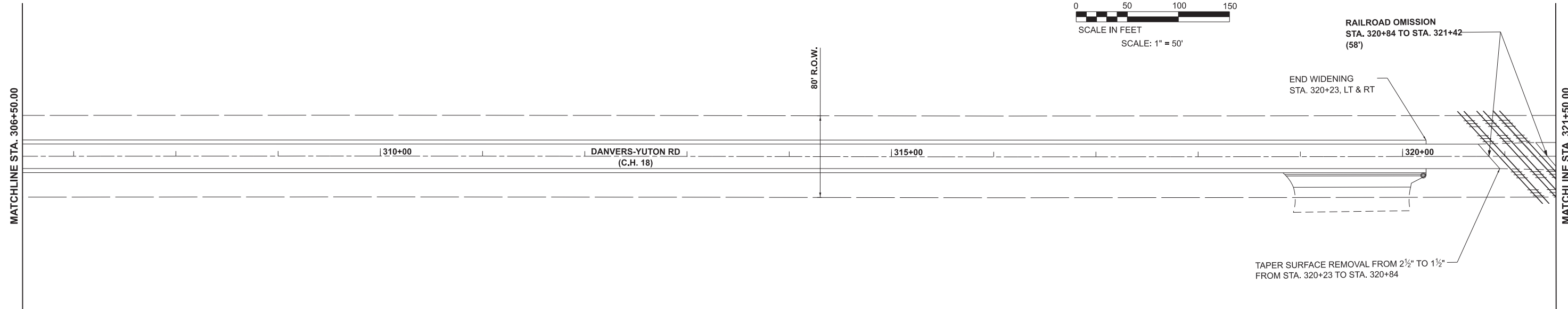
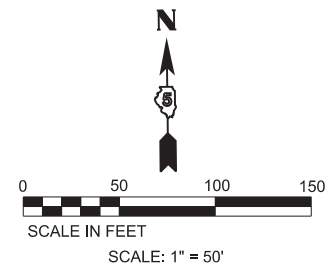

MODEL: C:\18_Plan_01 (Sheet)
 FILE NAME: X:\CountryRoads\CH 18\20-00038-06-RS - Danvers-Yuton Road - 2023\Design\DCN\CADD Data\Sheet\PlanView_20-00038-06-RS - Danvers-Yuton Road.dgn

USER NAME = colln.frantz	DESIGNED -	REVISED -
DRAWN -	REVISED -	
PLOT SCALE = 0.08333317' / in.	CHECKED -	REVISED -
PLOT DATE = 12/20/2022	DATE -	REVISED -

STATE OF ILLINOIS
DEPARTMENT OF TRANSPORTATION

DANVERS-YUTON ROAD
PLAN VIEW

SCALE: 1"=50' SHEET 24 OF 24 SHEETS STA. TO STA.

F.A.S. RTE.	SECTION	COUNTY	TOTAL SHEETS	SHEET NO.
471	20-00038-06-RS	MCLEAN	24	24
CONTRACT NO. 91621				
ILLINOIS FED. AID PROJECT				