

| F.A.P. RTE. | SECTION | COUNTY | TOTAL SHEETS | SHEET NO. |
|----------------------------------|------------|---------|------------------|-----------|
| 066 | 21 (B&G) R | MCHENRY | 66 | 57 |
| STA. 107+00.00 TO STA. 109+50.00 | | | | |
| FED. ROAD DIST. NO. ILLINOIS | | | FED. AID PROJECT | |

#62391

CONTRACTOR TO RESTORE TEMPORARY PAVEMENT AREAS

90 80 70 60 50 40 30 20 10 0 10 20 30 40 50 60 70 80

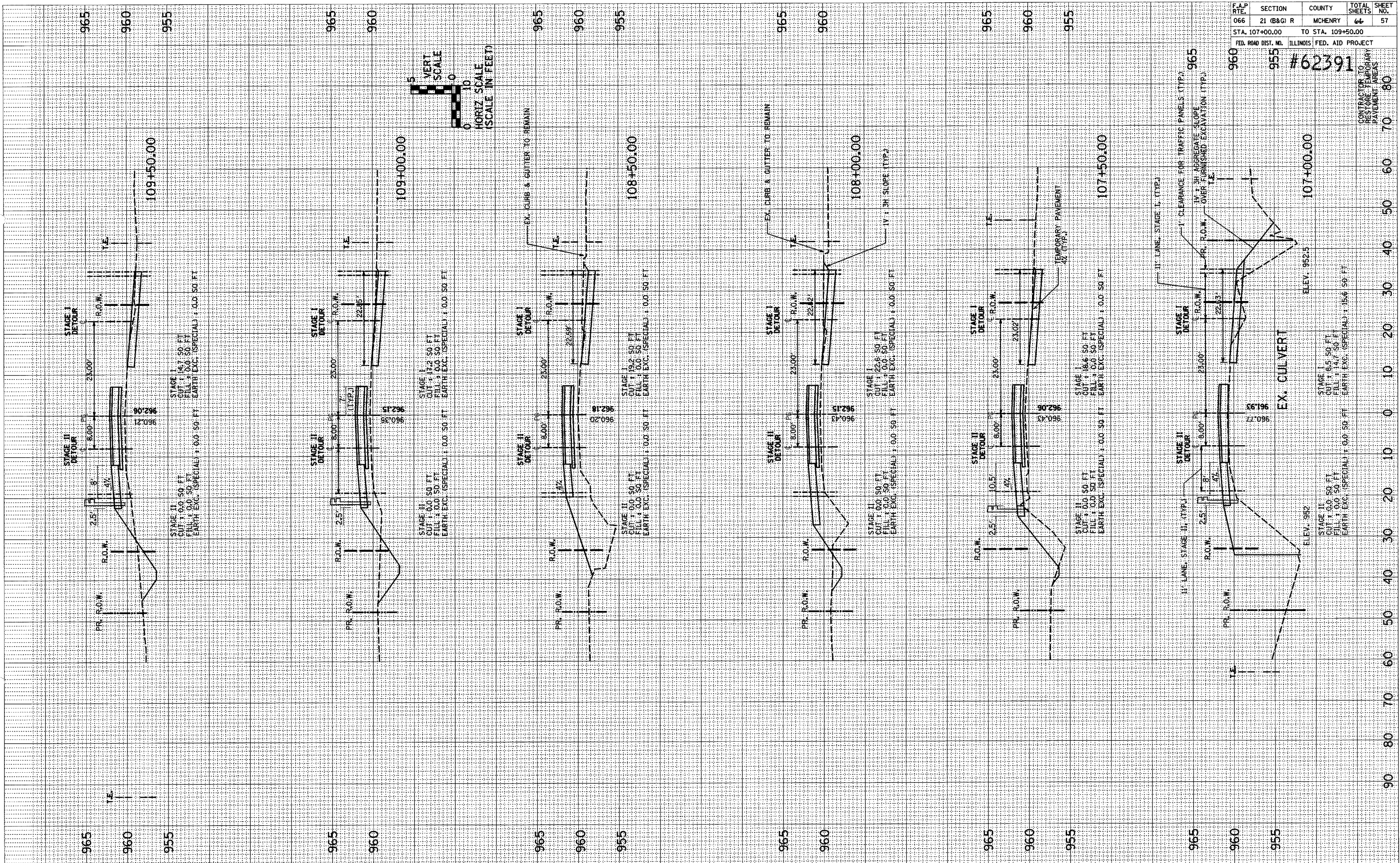

US ROUTE 14 STA. 107+00 TO STA. 109+50 TEMP. PAVEMENT