

62842

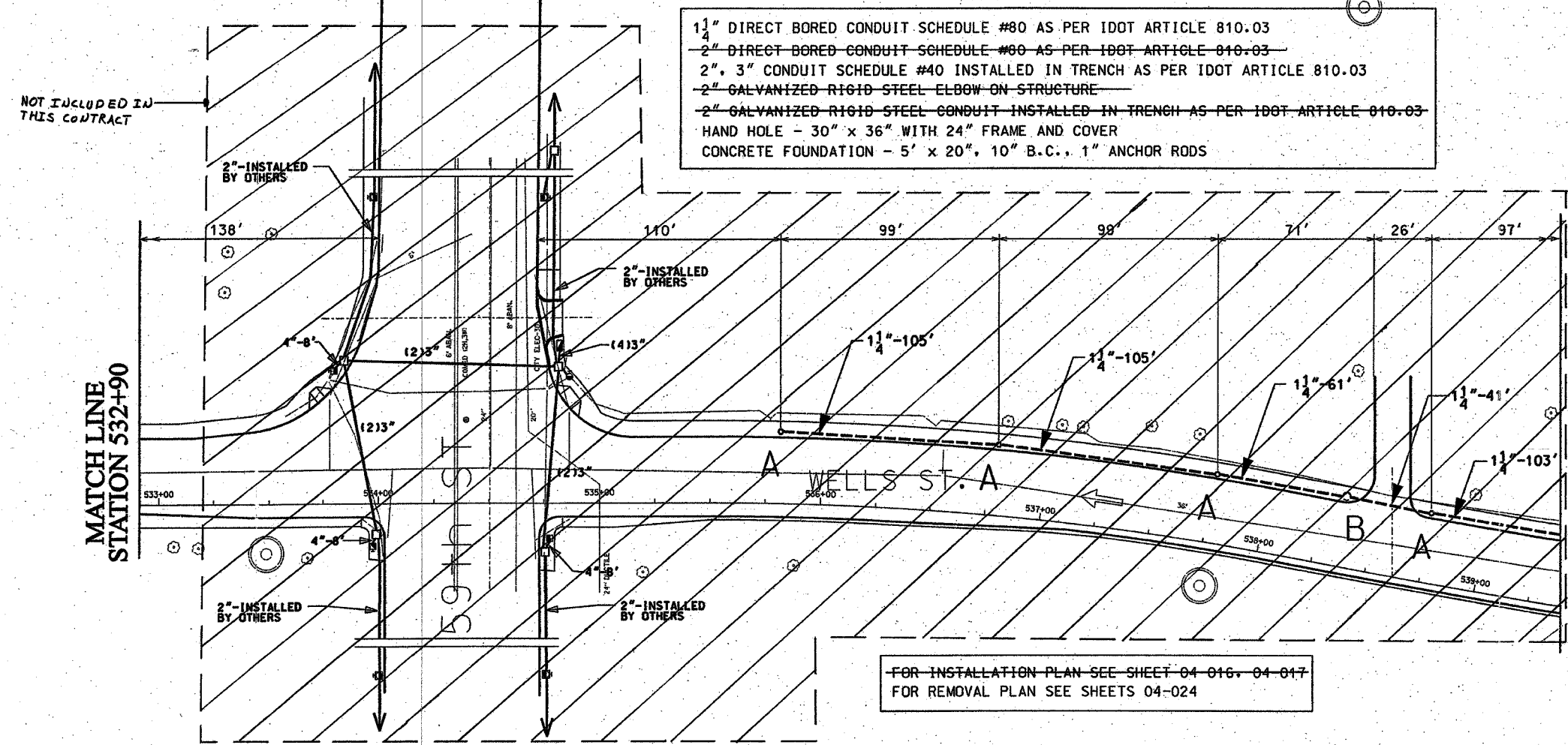

F. A. RTE	SECTION	COUNTY	TOTAL SHEETS	SHEET NO
90/94	*	COOK	31	18
STA. 523+45		TO STA. 539+40		
FED. ROAD DIST NO. 1		ILLINOIS		FED AID PROJECTS
* 2004-101 I				

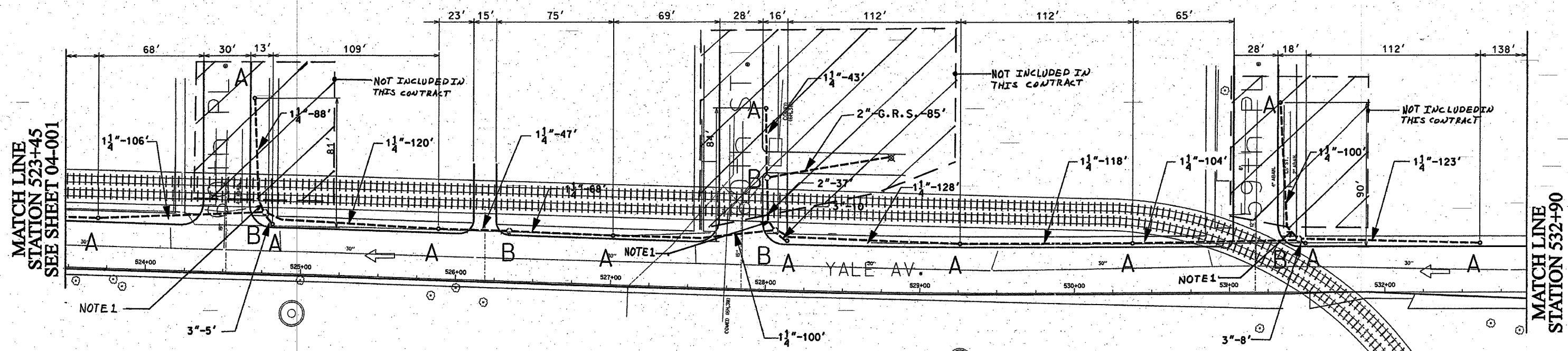

- 1 1/4" DIRECT BORED CONDUIT SCHEDULE #80 AS PER IDOT ARTICLE 810.03
- 2" DIRECT BORED CONDUIT SCHEDULE #80 AS PER IDOT ARTICLE 810.03
- 2", 3" CONDUIT SCHEDULE #40 INSTALLED IN TRENCH AS PER IDOT ARTICLE 810.03
- 2" GALVANIZED RIGID STEEL ELBOW ON STRUCTURE
- 2" GALVANIZED RIGID STEEL CONDUIT INSTALLED IN TRENCH AS PER IDOT ARTICLE 810.03
- HAND HOLE - 30" x 36" WITH 24" FRAME AND COVER
- CONCRETE FOUNDATION - 5' x 20", 10" B.C., 1" ANCHOR RODS

NOTES: CONTRACTOR IS TO INSTALL UNDERGROUND CONDUIT AND PULL ROPE BETWEEN FOUNDATIONS AS WELL AS PERFORM THE FOLLOWING WORK ITEMS ACCORDING TO BUREAU OF ELECTRICITY SPECIFICATIONS:

"A"- INSTALL 20" x 5' FOUNDATION, 10" B.C., 1" ANCHOR RODS AS PER DRAWING NO. 565, 2' OFF FACE OF CURB, UNLESS NOTED OTHERWISE. BUILD FOUNDATIONS FLUSH WITH SIDEWALK SURFACE.

"B"- INSTALL 30" HANDHOLE AS PER DRAWING NO. 867 WITH 24" FRAME AND COVER.

NOTES:

1. PROVIDE A CONDUIT STUB AT HANDHOLE EXTENDING TO ONE FOOT PAST THE LIMITS OF SIDEWALK REPLACEMENT. PROVIDE A CONDUIT CAP FOR THE CONDUIT STUB. THE CONDUIT CAP WILL BE INCLUDED IN THE UNIT PRICE FOR THE CONDUIT OF SPECIFIED TYPE AND DIAMETER. NO SEPARATE PAYMENT WILL BE MADE. SEE IDOT CONTRACT NO. 62835 FOR LIMITS OF SIDEWALK REPLACEMENT.

FOR INSTALLATION PLAN SEE SHEET 04-016, 04-017  
FOR REMOVAL PLAN SEE SHEETS 04-024

CITY OF CHICAGO  
DEPT. OF STREETS AND SANITATION  
BUREAU OF ELECTRICITY  
DIVISION OF ELECTRICAL ENGINEERING

DRAFTSMAN: B. GARNSEY	CHIEF DRAFTSMAN: ROBERT CARTER	ENGINEER: B. GARNSEY
SUPERVISING ENGINEER	ELEC. DESIGN ENGR.	
ENGINEER OF ELECTRICITY:		DWG. NO.
GEN'L SUPT. OF ELECTRICITY:		<b>04-002</b>
DEPUTY COMMISSIONER:		
SIZE: 22"   36"	SCALE: 1"=30'	DATE: 1/20/04
ILLINOIS DEPARTMENT OF TRANSPORTATION F.A.I. 90/94 (DAN RYAN EXPRESSWAY) 63rd St. TO 57th St. (FRONTAGE ROADS)		
STREET LIGHTING UNDERGROUND CONDUIT FACILITIES		
SCALE: 1" = 30'		DRAWN BY: B.T.G.
DATE: February 11, 2005		CHECKED BY: O.L.

REVISIONS	
NAME	DATE