

F. A. P. SHEET	SECTION	COUNTY	TOTAL SHEETS	SHEET NO.
365	56 RS-7	DU PAGE	24	7
STA. 82+23	TO STA. 95+23			
FED. ROAD DIST. NO. 1	ILLINOIS	FED. AID PROJECT		
CONTRACT NO.: 62909				

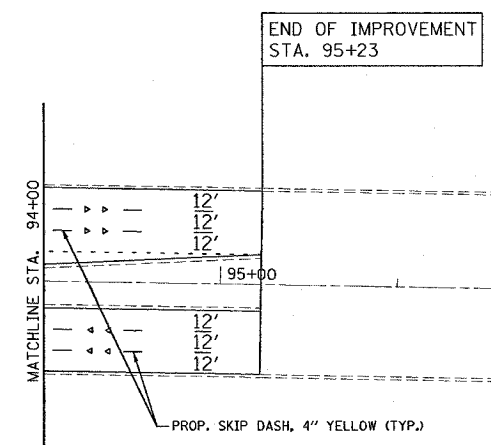
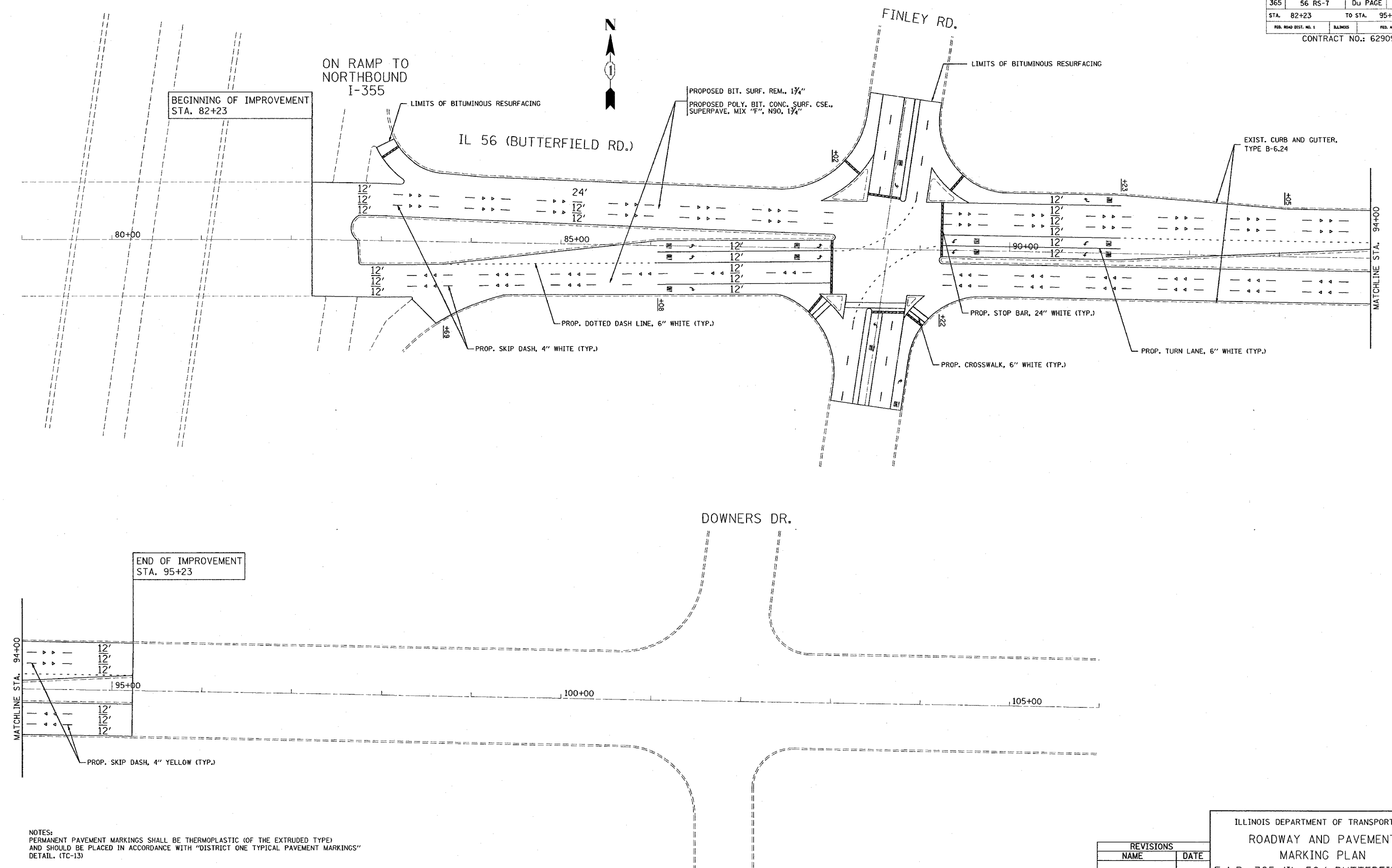

NOTES:
 PERMANENT PAVEMENT MARKINGS SHALL BE THERMOPLASTIC (OF THE EXTRUDED TYPE) AND SHOULD BE PLACED IN ACCORDANCE WITH "DISTRICT ONE TYPICAL PAVEMENT MARKINGS" DETAIL. (TC-13)

RAISED REFLECTIVE PAVEMENT MARKERS SHALL BE IN ACCORDANCE WITH THE DISTRICT ONE "TYPICAL APPLICATION RAISED REFLECTIVE PAVEMENT MARKERS DETAIL."

THE RESIDENT ENGINEER SHOULD CONTACT MR. DON CHIARUGI, AREA TRAFFIC ENGINEER, AT (847) 741-9857 PRIOR TO PLACING ANY PAVEMENT MARKINGS.

REVISIONS	
NAME	DATE

ILLINOIS DEPARTMENT OF TRANSPORTATION
 ROADWAY AND PAVEMENT
 MARKING PLAN
 F.A.P. 365 (IL 56/ BUTTERFIELD RD.)
 AT FINLEY RD.

SCALE: VERT. 1"=50'
 DATE 2/24/2005

DRAWN BY: P. STEED
 CHECKED BY:

2/24/2005
 c:\projects\62909\62909.dwg
 REF.