

F.A.P. RTE.	SECTION	COUNTY	TOTAL SHEETS	SHEET NO.
317	•	LIVINGSTON	205	79
STA. 243+50.00 TO STA. 244+00.00				
CONTRACT NO. 66261				
• 25 RS-2 & 26 RS-4				

FINAL SURVEY	BY	DATE
NO. 1	J. K.	
NO. 2		
NO. 3		
NO. 4		
NO. 5		
NO. 6		
NO. 7		
NO. 8		
NO. 9		
NO. 10		

OPTIONAL SURVEY	BY	DATE
NO. 1		
NO. 2		
NO. 3		
NO. 4		
NO. 5		
NO. 6		
NO. 7		
NO. 8		
NO. 9		
NO. 10		

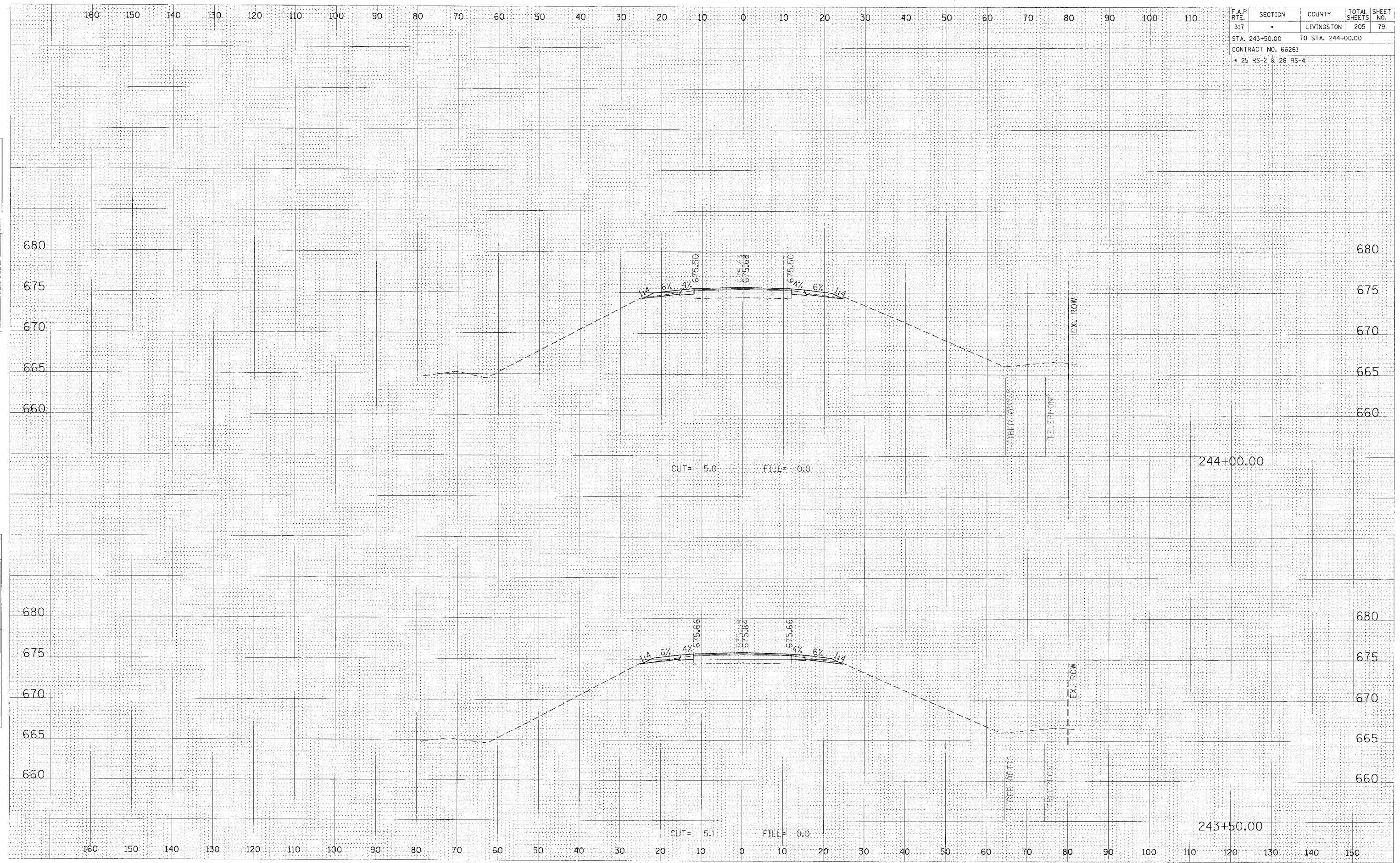

CROSS SECTION, STA 243+50.00 TO 244+00.00, FAP 317 (US ROUTE 24)