

F.A.S. RTE.	SECTION	COUNTY	TOTAL SHEETS	SHEET NO.
1279	1(D,E,F,P)I-3	LASALLE	19	8
STA. 23+51		TO STA. 35+09		
FED. ROAD DIST. NO. ILLINOIS		NON-FED. AID PROJECT		

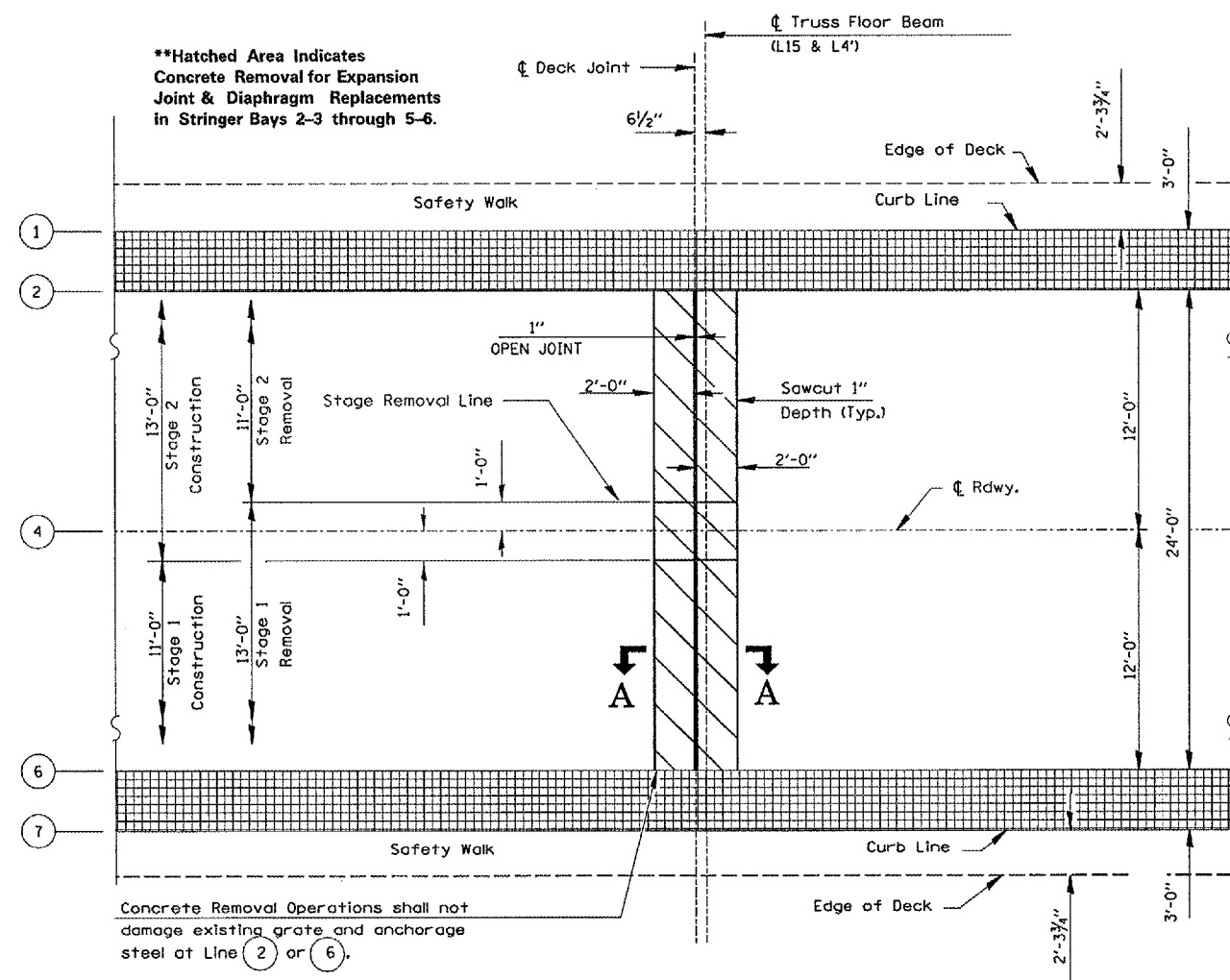

****Hatched Area Indicates Concrete Removal for Expansion Joint & Diaphragm Replacements in Stringer Bays 2-3 through 5-6.**



Concrete Removal Operations shall not damage existing grate and anchorage steel at Line 2 or 6.

EXISTING DECK PLAN
Truss Spans @ L15 & L4'

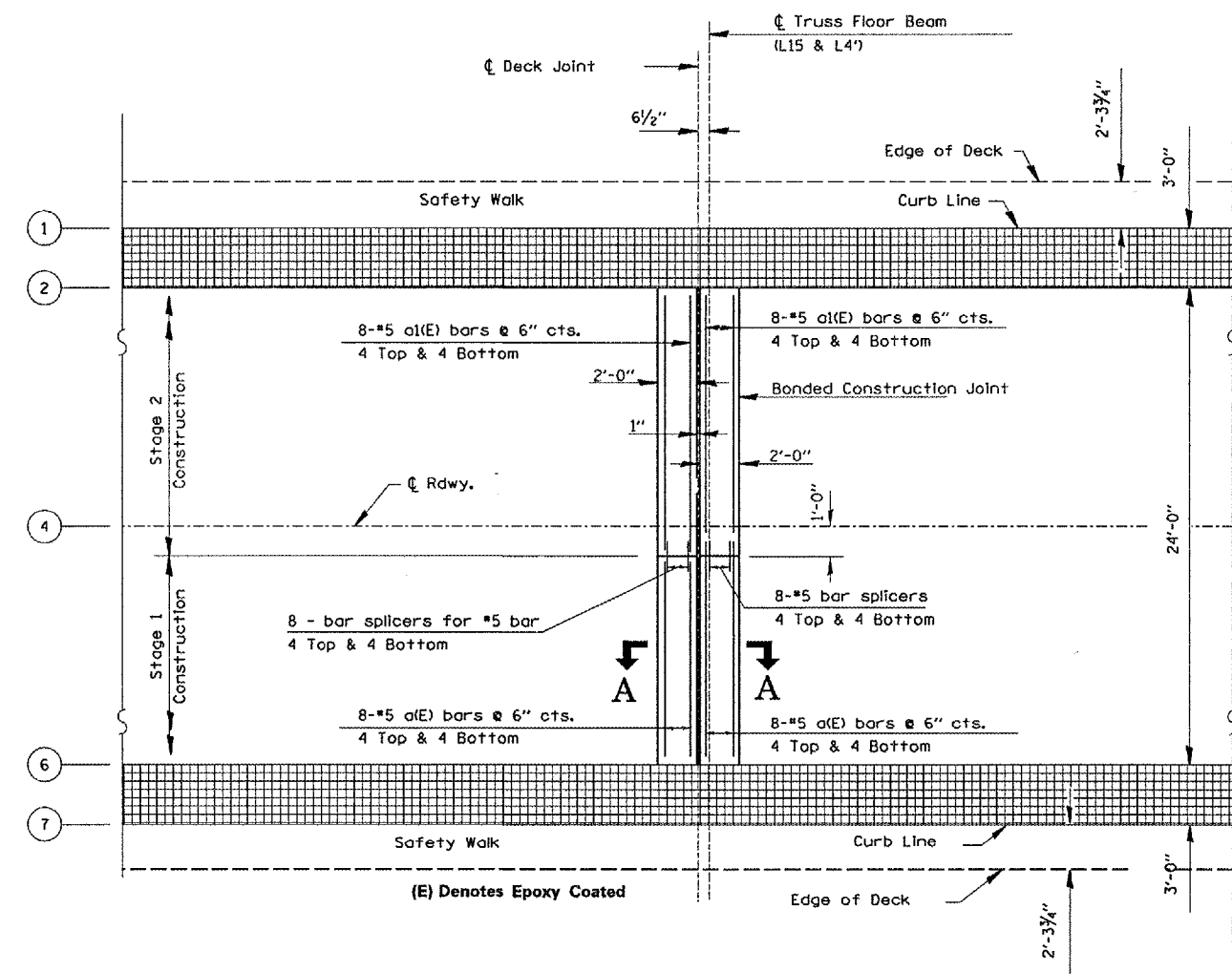

PROPOSED DECK PLAN
Truss Spans @ L15 & L4'

(E) Denotes Epoxy Coated

BILL OF MATERIAL

BAR	NO.	SIZE	LENGTH	SHAPE
a(E)	32	#5	10'-8"	—
a1(E)	32	#5	12'-8"	—
Concrete Removal			Cu. Yd.	4.3
Reinforcement Bars, Epoxy Coated			Pound	779
Bar Splicers			Each	32
Concrete Superstructure			Cu. Yd.	4.3
Silicone Joint Sealer, 1"			Foot	120
Polymer Concrete			Cu. Ft.	3.5

SEE SHEET 9 FOR SECTIONS A-A

REVISIONS	
NAME	DATE

ILLINOIS DEPARTMENT OF TRANSPORTATION
JOINT RECONSTRUCTION DETAILS @ L15 & L4'
EXISTING S.N. 050-0088
IL 178 OVER ILLINOIS-RIVER
STATION 29+30
VERT. SCALE: HORIZ. DATE: 12/08/04
DRAWN BY: RLW
CHECKED BY:

cm326/details.dgn