

F.A.S. RTE.	SECTION	COUNTY	TOTAL SHEETS	SHEET NO.
1279	1(D,E,F,P)I-3	LASALLE	19	10
STA. 23+51		TO STA. 35+09		
FED. ROAD DIST. NO. .		ILLINOIS	NON-FED. AID PROJECT	

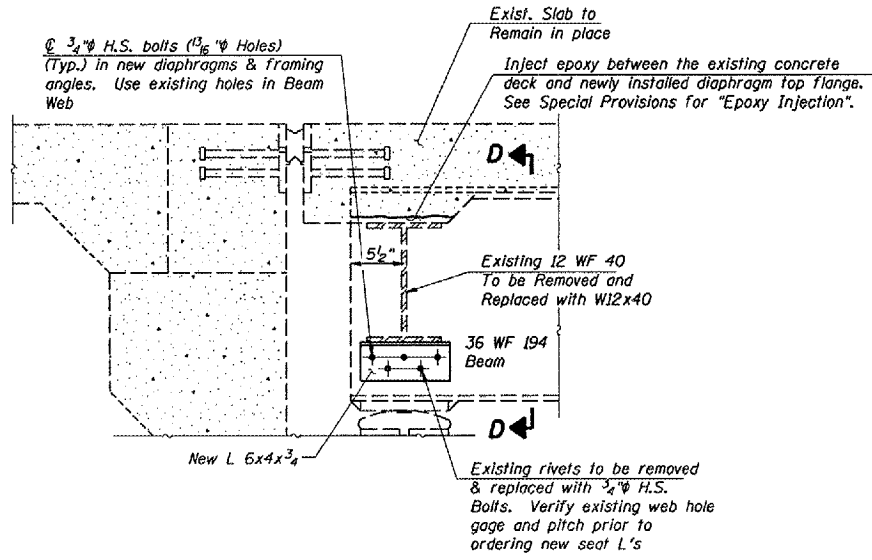

SECTION SOUTH ABUTMENT
Diaphragm D Replacement (Stage 1 Construction)

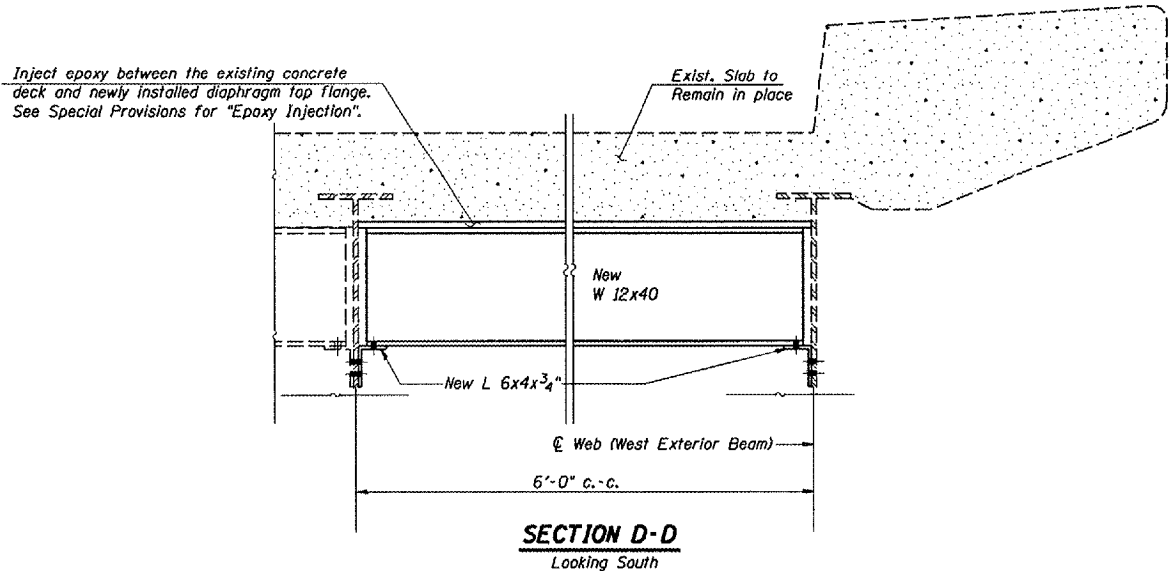

SECTION D-D
Looking South

cm325/details.dgn

REVISIONS	
NAME	DATE

ILLINOIS DEPARTMENT OF TRANSPORTATION

SOUTH ABUTMENT SECTION

EXISTING S.N. 050-0088
IL 178 OVER ILLINOIS RIVER
STATION 29 + 30

VERT. SCALE: DRAWN BY: RLW
 HORIZ. SCALE: CHECKED BY:

DATE: 12/08/04