







F.A.I. RTE.	SECTION	COUNTY	TOTAL SHEETS	SHEET NO.
57	D-3 BRIDGE PAINTING 2005-1	IROQUOIS	16	5
FED. ROAD DIST. NO. _____		ILLINOIS FED. AID PROJECT		

**LENGEND**

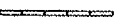
-  Work Zone
-  Type II barricade, drum or vertical barricade with stead burn monodirectional light
-  Temporary concrete barrier
-  Type C Monodirectional reflector
-  Vertical panel with steady burn monodirectional light
-  Impact attenuator

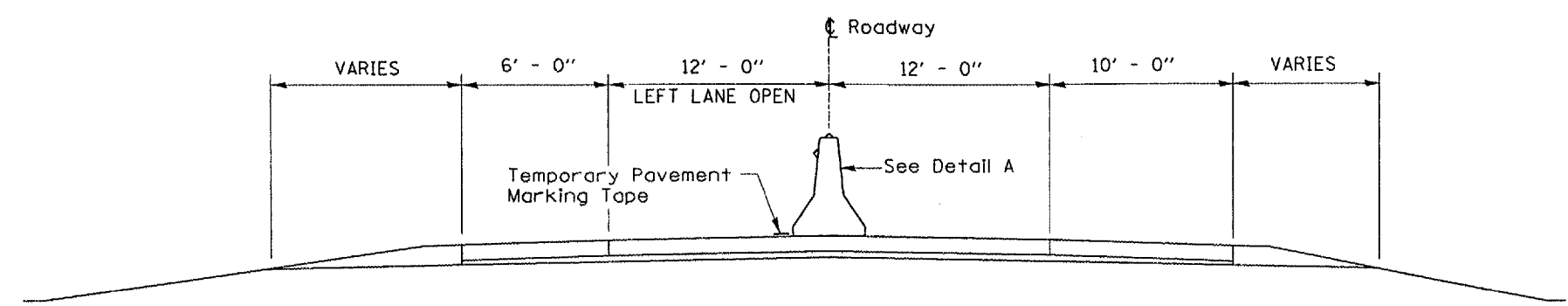

**SECTION A-A**

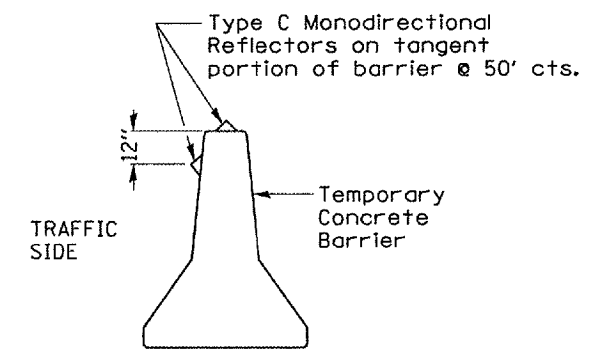

**DETAIL A**

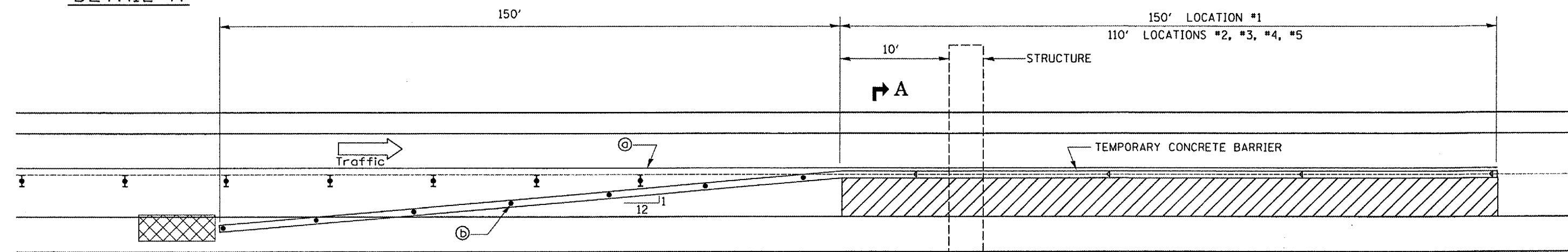

**PLAN**

- (a) Reflectorized temporary pavement marking tape shall be placed throughout the taper and along side the work area. The edge line shall be white for right lane closure.
- (b) Vertical panels at 25' centers with steady burning monodirectional lights.

REVISIONS	
NAME	DATE

ILLINOIS DEPARTMENT OF TRANSPORTATION  
**TRAFFIC CONTROL DETAILS**  
**RIGHT LANE CLOSURE**  
 SCALE: VERT. \_\_\_\_\_  
 HORIZ. \_\_\_\_\_  
 DATE 06/21/04  
 DRAWN BY RW  
 CHECKED BY \_\_\_\_\_

Work this sheet with Traffic Control Standards 701400 & 701402

Date: 01/10/05  
bridgepaint05/2005-1/details.dgn