

STATE OF ILLINOIS
DEPARTMENT OF TRANSPORTATION

ROUTE NO.	SECTION	COUNTY	TOTAL SHEETS	SHEET NO.	SHEET NO. 3 of 15 SHEETS
F.A.I. 74	*	PEORIA	1360	1025	
FED. ROAD DIST. NO. 7	ILLINOIS	FED. AID PROJECT			

* (72-7)R-3 Contract 68200

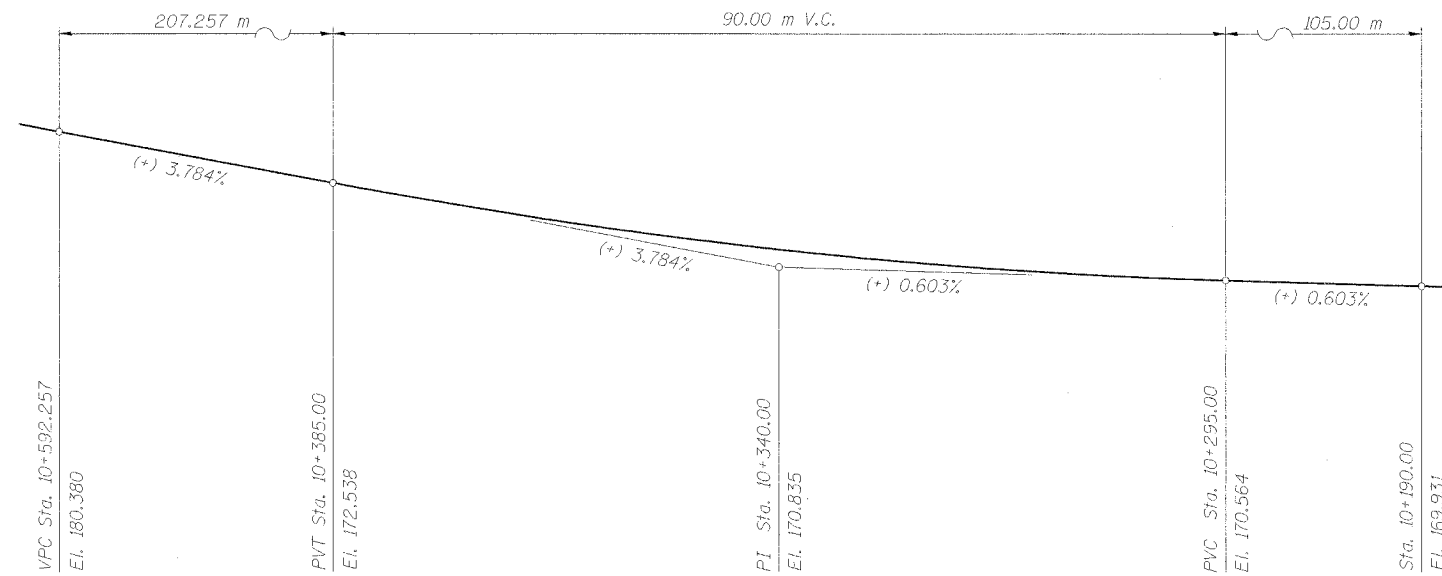

B PROFILE GRADE OF RAMP C-3

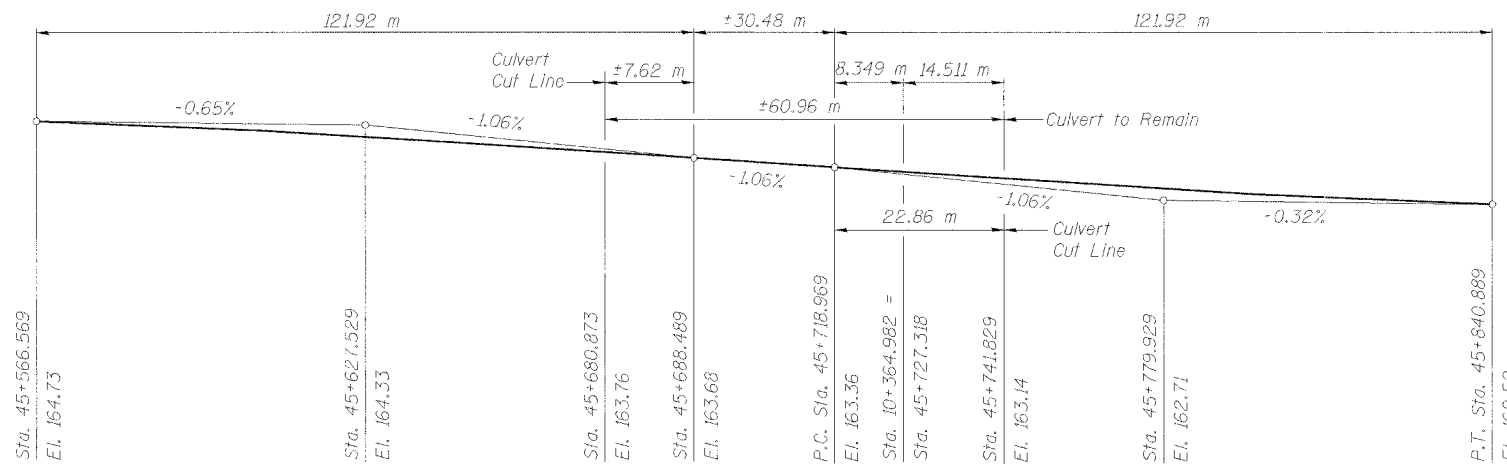

CULVERT FLOW LINE PROFILE

North End
Stations are measured along Culvert $\text{\textcircled{C}}$,
unless noted otherwise
See Station Equation

CULVERT FLOW LINE PROFILE

South End
Stations are measured along Culvert $\text{\textcircled{C}}$
@ Sta. 10+364.982 = Sta. 45+727.318
at Flow Line/ $\text{\textcircled{C}}$ of Culvert.

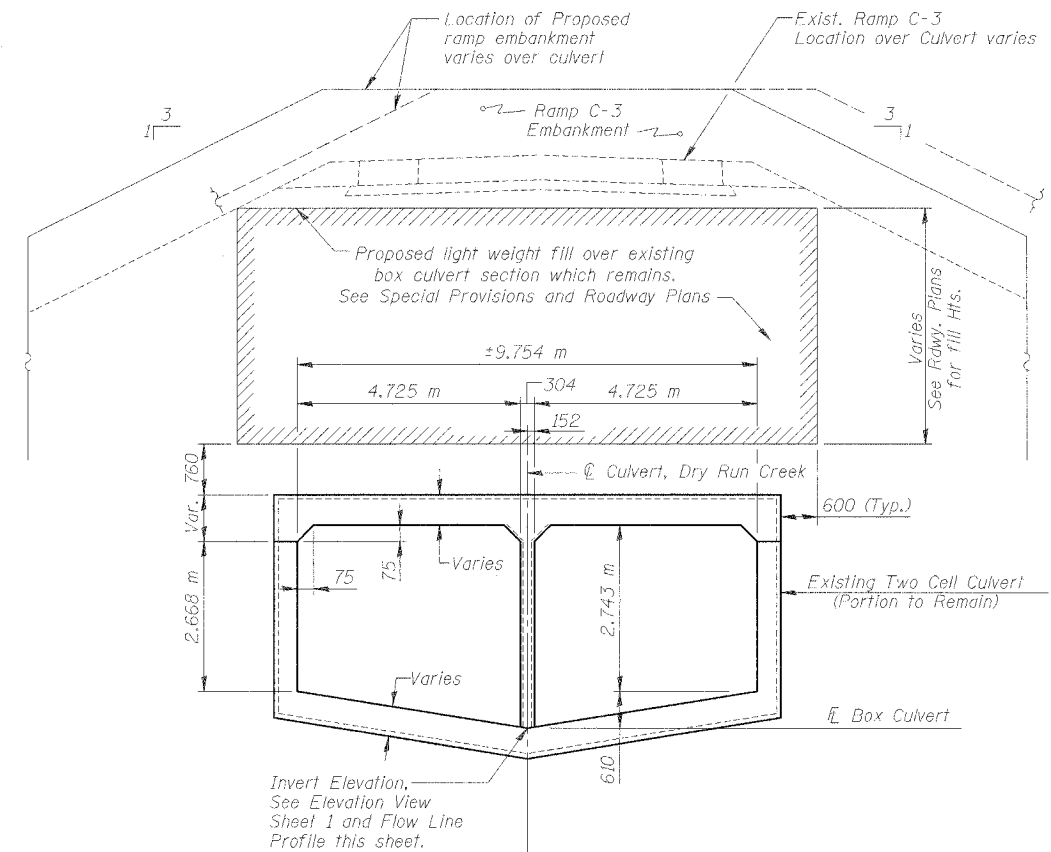

SECTION B-B

From Sta. 45+680.873 to Sta. 45+741.829

**PROPOSED HORIZONTAL
CURVE DATA**

Curve No. 332
Alignment = Ramp C-3
Design Speed = 80 km/h
P.I. Sta. = 10+356.775
R (m) = 1293.773
T (m) = 113.756
L (m) = 226.928
E (m) = 4.991
S.E. = 2.70%
Transition In = 10+238 to 10+245
Transition Out = 10+466 to 10+478
P.C. Sta. = 10+243.019
P.T. Sta. = 10+469.948

**PROFILE GRADES,
CURVE DATA, & SECTION B-B
NORTH & SOUTH CULVERT EXTENSION
RAMP C-3 OVER DRY RUN CREEK
F.A.I. ROUTE 74(I-74) SECTION (72-7)R-3
PEORIA COUNTY
STATION 10+277.51 TO
STA. 10+441.66 (RAMP C-3)
STRUCTURE NUMBER 072-2005**

DESIGNED	LLV
CHECKED	PJL
DRAWN	MGM
CHECKED	LLV



111 NE Jefferson Ave.
Peoria, Illinois 61602
Ph(309)676-8464
FAX(309)676-5445