

D:\projects\roadwork\1102-5a.dwg 12/20/2004 7:43:23 AM

68201

F.A.I. RTE.	SECTION	COUNTY	TOTAL SHEETS	SHEET NO.
74	*	TAZEWELL	1366	126
STA. 2+100.000		TO STA. 3+300.000		
FED. ROAD DIST. NO.		ILLINOIS FED. AID PROJECT		

*(90-111R-2;9013,14,14-11R-1

P.I. STA. 2+579.299
 $\Delta = 1^\circ 43' 09''$ (L.T.)
 N 444,687.376
 E 750,264.701
 (NO CURVE)

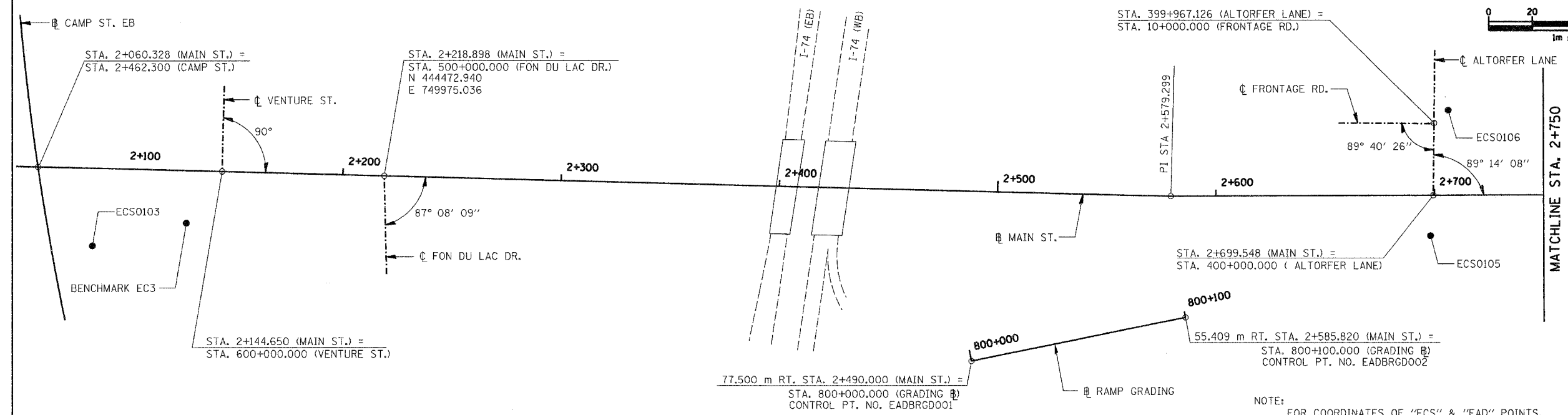
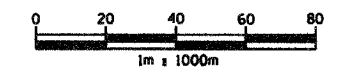
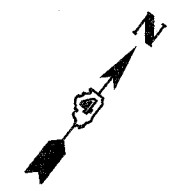

STA. 399+967.126 (ALTORFER LANE) =
 STA. 10+000.000 (FRONTAGE RD.)

PI STA. 2+579.299

STA. 2+699.548 (MAIN ST.) =
 STA. 400+000.000 (ALTORFER LANE)

800+100

55.409 m RT. STA. 2+585.820 (MAIN ST.) =
 STA. 800+100.000 (GRADING #)
 CONTROL PT. NO. EADBRG002

77.500 m RT. STA. 2+490.000 (MAIN ST.) =
 STA. 800+000.000 (GRADING #)
 CONTROL PT. NO. EADBRG001

NOTE:
 FOR COORDINATES OF "ECS" & "EAD" POINTS,
 SEE REFERENCE TIES & BENCHMARK SHEET.
 FOR BENCHMARK INFORMATION,
 SEE REFERENCE TIES & BENCHMARK SHEET.

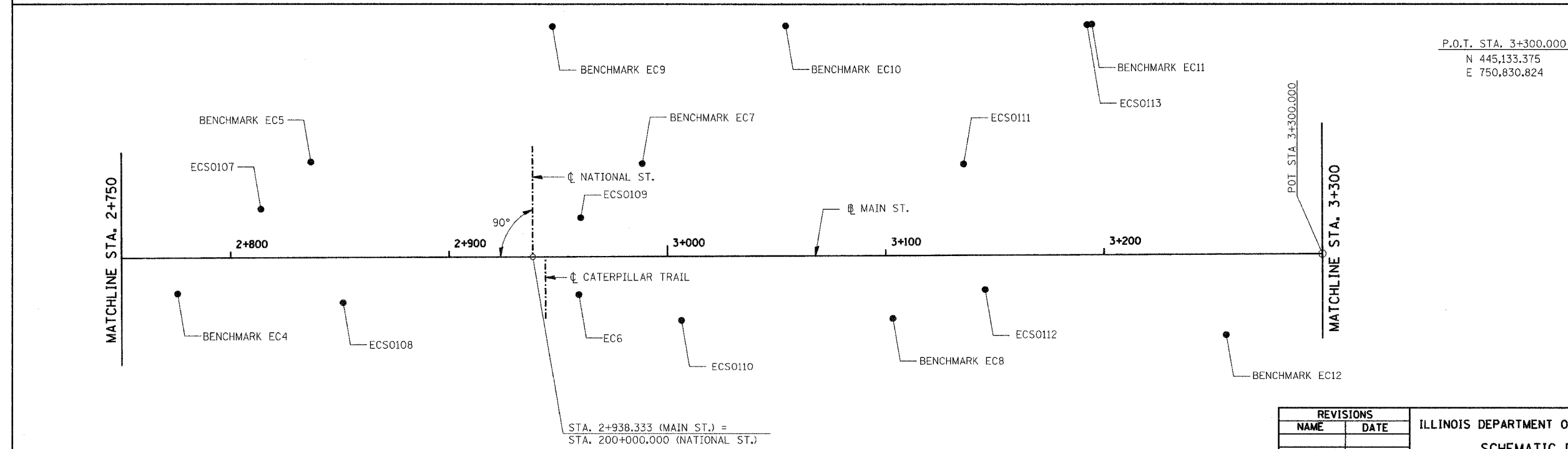

P.O.T. STA. 3+300.000
 N 445,133.375
 E 750,830.824

STA. 2+938.333 (MAIN ST.) =
 STA. 200+000.000 (NATIONAL ST.)

SHEET 3 OF 4



REVISIONS	
NAME	DATE

ILLINOIS DEPARTMENT OF TRANSPORTATION
 SCHEMATIC DRAWING
 ILL. 116 - U.S. 150 - MAIN ST.
 STA. 2+100 TO STA. 3+300

DATE 12-20-04
 DRAWN BY SRS
 CHECKED BY JJM