

F.A.I. RTE.	SECTION	COUNTY	TOTAL SHEETS	SHEET NO.
74	(90-11R-2; 90(13,14,14-1)R-1	TAZEWELL	1366	128
STA. 152+445.837 TO STA. 152+700				
FED. ROAD DIST. NO. 4 ILLINOIS FED. AID PROJECT				

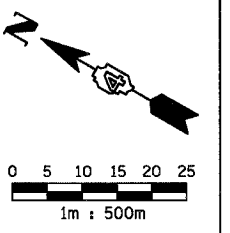

LEGEND	
	TEMPORARY PAVEMENT MARKING
	TRAFFIC FLOW DIRECTION
	TEMPORARY CONCRETE BARRIER

THIS MAINTENANCE OF TRAFFIC PLAN SHOWS SPECIAL TRAFFIC CONTROL IN THIS AREA. IN ADDITION TO THE SPECIAL TRAFFIC CONTROL DETAILS SHOWN, IDOT TRAFFIC CONTROL HIGHWAY STANDARDS SHALL APPLY WHERE APPLICABLE AND AS DIRECTED BY THE ENGINEER. SEE TRAFFIC NOTES ON THE CONSTRUCTION SEQUENCING SHEET FOR PRE STAGE 3 FOR APPLICABLE IDOT HIGHWAY STANDARDS.

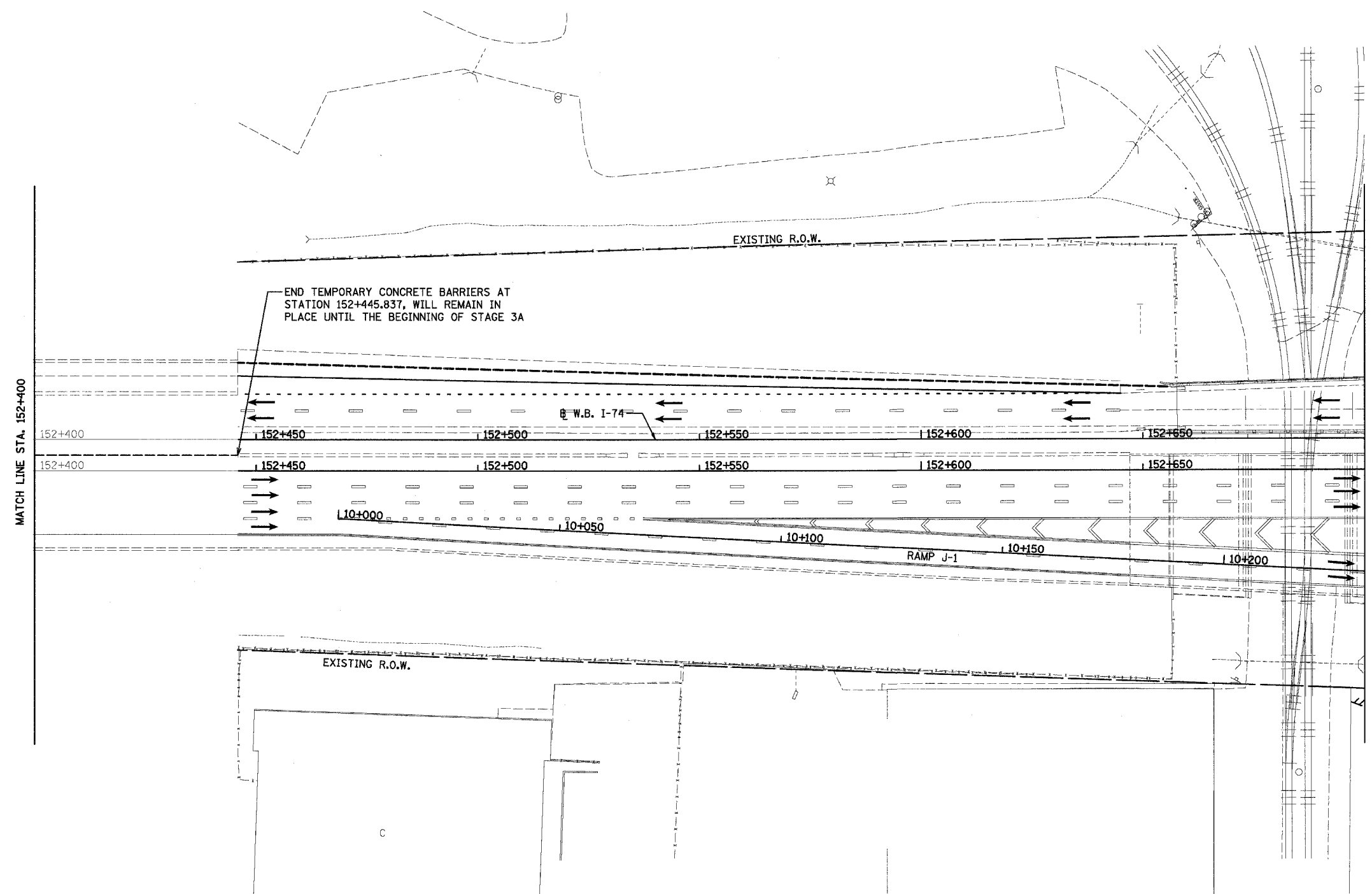

REVISIONS	
NAME	DATE

ILLINOIS DEPARTMENT OF TRANSPORTATION
 F.A.I. ROUTE 74 (I-74)
 MAINTENANCE OF TRAFFIC
 STAGE 3A-1 (PRE STAGE 3)
 I-74 STA. 152+400 TO STA. 152+700
 DRAWN BY KMO
 CHECKED BY RTG
 DATE 12/20/2004