

F.A.I. RTE.	SECTION	COUNTY	TOTAL SHEETS	SHEET NO.
74	(90-11)R-2; 90(13,14,14-1)R-1	TAZEWELL	1366	132
STA. 3+200		TO STA. 3+800		
FED. ROAD DIST. NO. 4		ILLINOIS FED. AID PROJECT		

THIS MAINTENANCE OF TRAFFIC PLAN SHOWS SPECIAL TRAFFIC CONTROL IN THIS AREA. IN ADDITION TO THE SPECIAL TRAFFIC CONTROL DETAILS SHOWN, IDOT TRAFFIC CONTROL HIGHWAY STANDARDS SHALL APPLY WHERE APPLICABLE AND AS DIRECTED BY THE ENGINEER. SEE TRAFFIC NOTES ON THE CONSTRUCTION SEQUENCING SHEET FOR PRE STAGE 3 FOR APPLICABLE IDOT HIGHWAY STANDARDS.

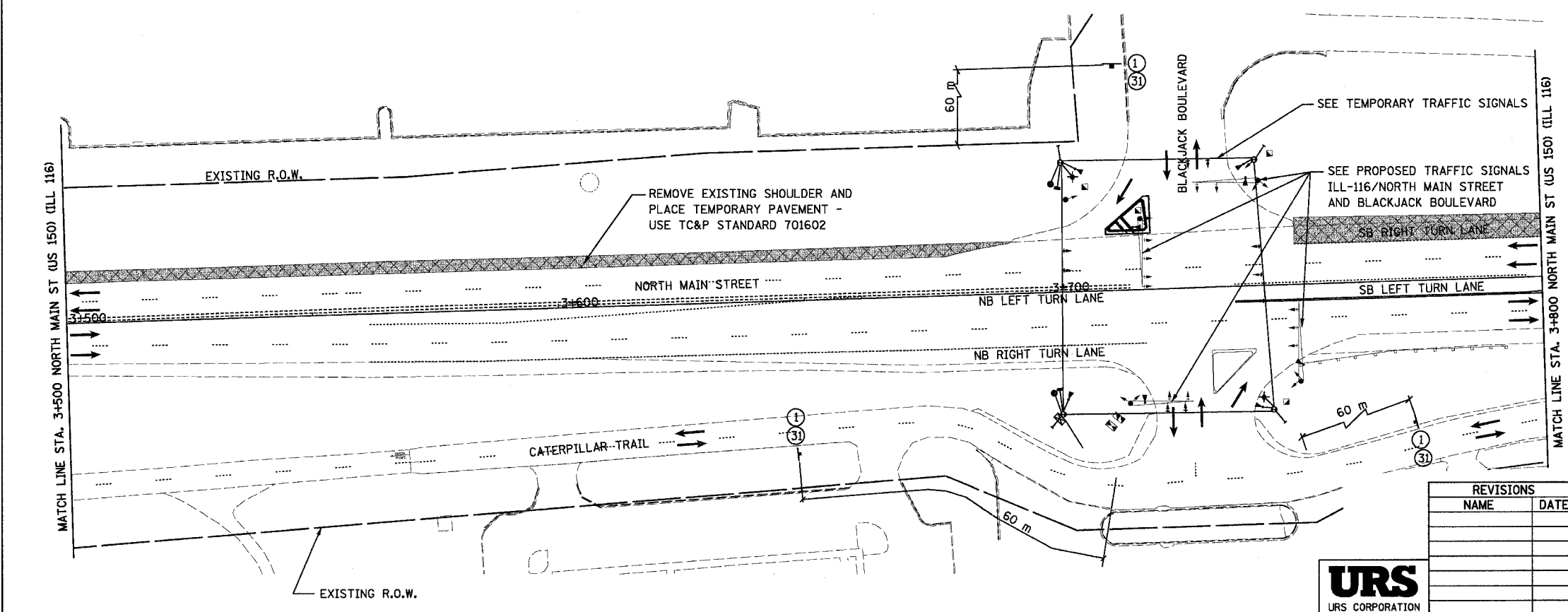
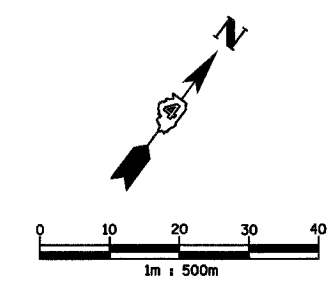
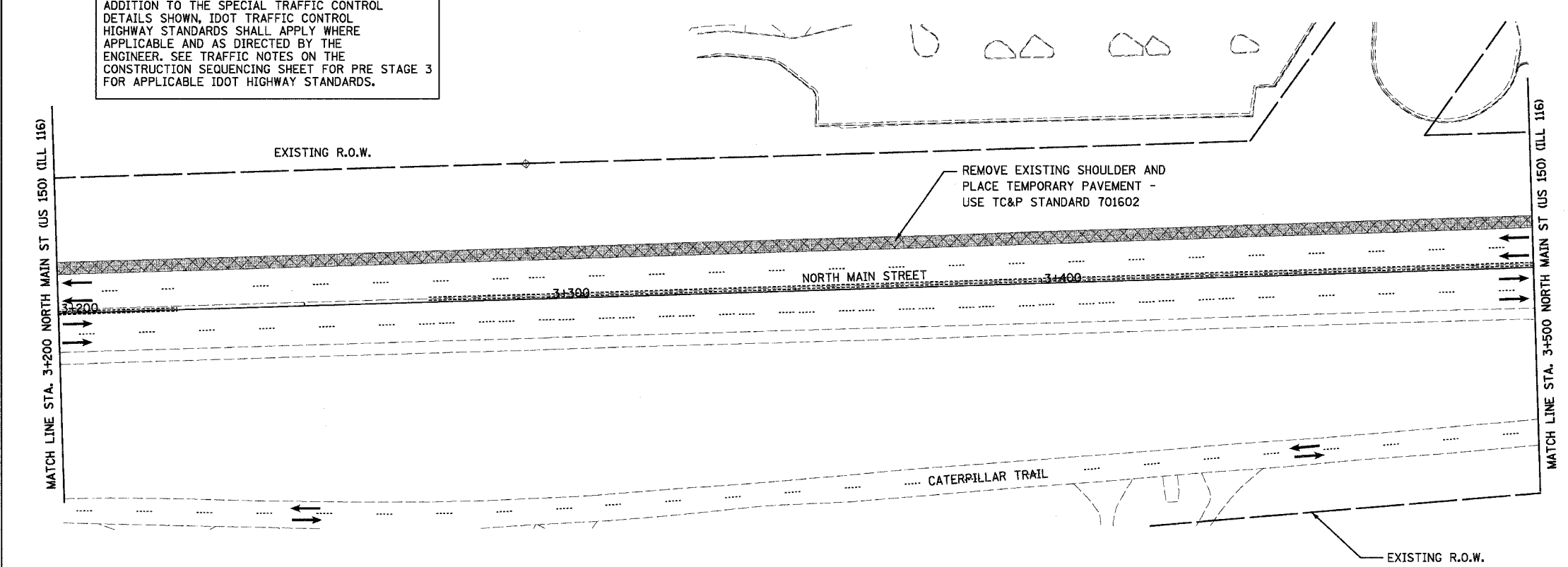

LEGEND

- TEMPORARY PAVEMENT
- WORK ZONE
- TRAFFIC FLOW DIRECTION
- SIGN, SEE MOT GENERAL NOTES AND LEGEND SHEET FOR SIGN TYPE

REVISIONS	
NAME	DATE



ILLINOIS DEPARTMENT OF TRANSPORTATION
 F.A.I. ROUTE 74 (I-74)
 MAINTENANCE OF TRAFFIC
 STAGE 3A-1 (PRE STAGE 3)
 NORTH MAIN STREET 3+200 TO 3+800
 DRAWN BY KMO
 DATE 12/20/2004
 CHECKED BY RTG