

F.A.I. RTE.	SECTION	COUNTY	TOTAL SHEETS	SHEET NO.
74	(90-11R-2) 90(13,14,14-1R-1	TAZEWELL	1366	151
STA. 153+000		TO STA. 153+300		
FED. ROAD DIST. NO. 4		ILLINOIS FED. AID PROJECT		

NOTES: BEFORE SHIFTING WESTBOUND I-74 TRAFFIC TO THE EASTBOUND LANES, TEMPORARY CONCRETE BARRIER LOCATED IN THE MEDIAN FROM THE PREVIOUS CONTRACT MUST BE RELOCATED.

MAINLINE TRAFFIC CONTROL FOR I-74 SHALL BE IN ACCORDANCE WITH STANDARD 701101 AND 701406.

SEE TEMPORARY TRAFFIC CONTROL SCHEDULE TO VERIFY LOCATION OF TEMPORARY CONCRETE BARRIERS. BARRIER WALL REFLECTORS SHALL BE INSTALLED ON ALL TEMPORARY CONCRETE BARRIER IN ACCORDANCE WITH THE SPECIAL PROVISION FOR THESE BARRIERS

SEE MOT GENERAL NOTES SHEET FOR TEMPORARY SIGNING LEGEND.

FOR NORTH MAIN STREET MOT DETAILS IN STAGE 3, REFER TO SUB STAGES 3A-2, 3A-3, 3A-4, AND 3A-5 (N. MAIN STREET STATIONS 2+000 TO 3+200)

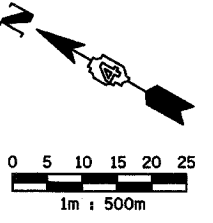
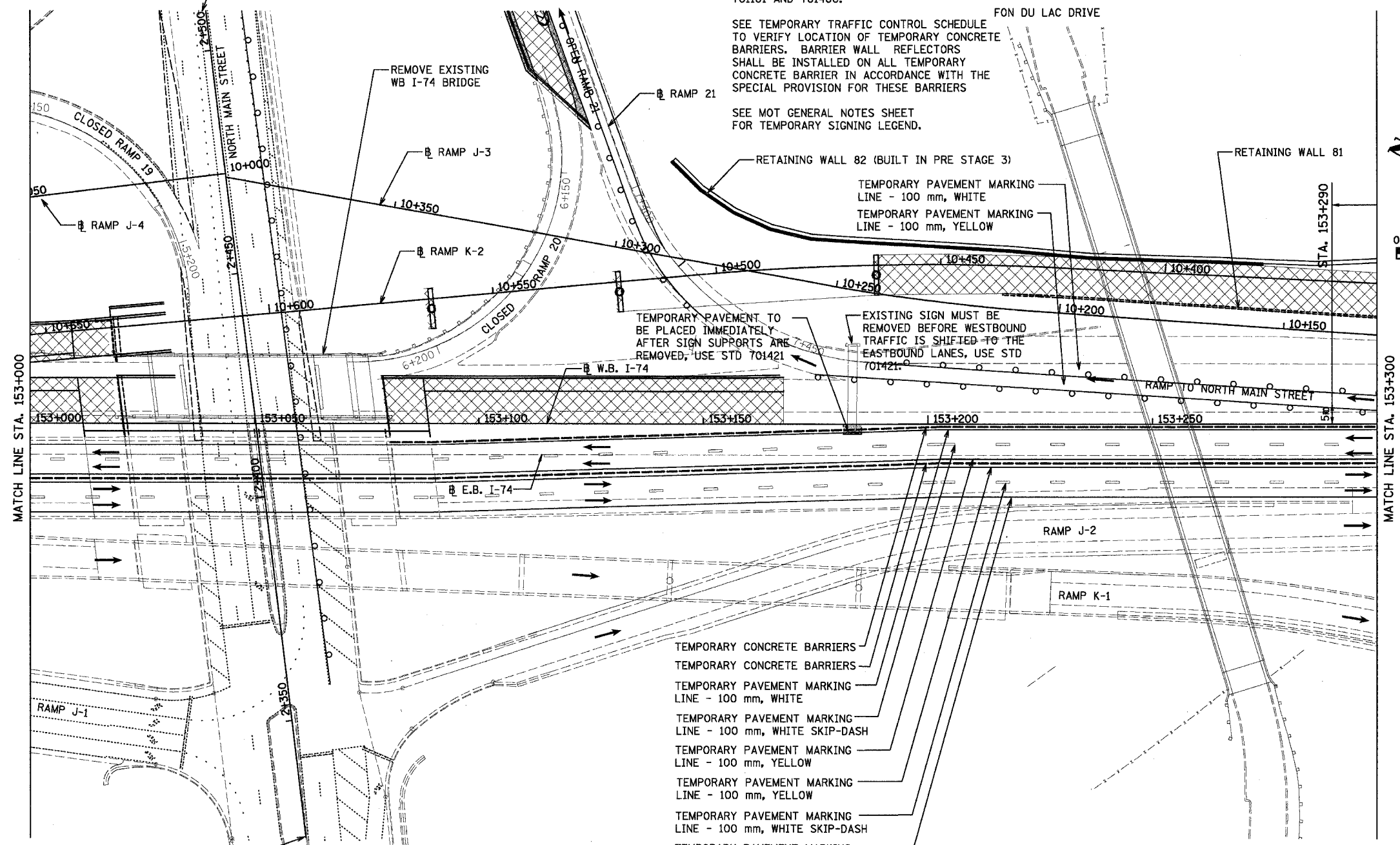

- TEMPORARY CONCRETE BARRIERS
- TEMPORARY CONCRETE BARRIERS
- TEMPORARY PAVEMENT MARKING LINE - 100 mm, WHITE
- TEMPORARY PAVEMENT MARKING LINE - 100 mm, WHITE SKIP-DASH
- TEMPORARY PAVEMENT MARKING LINE - 100 mm, YELLOW
- TEMPORARY PAVEMENT MARKING LINE - 100 mm, YELLOW
- TEMPORARY PAVEMENT MARKING LINE - 100 mm, WHITE SKIP-DASH
- TEMPORARY PAVEMENT MARKING LINE - 100 mm, WHITE

FOR NORTH MAIN STREET MOT DETAILS IN STAGE 3, REFER TO SUB STAGES 3A-2, 3A-3, 3A-4 AND 3A-5 (N. MAIN STREET STATIONS 2+000 TO 3+200)

LEGEND	
	TEMPORARY PAVEMENT MARKING
	TEMPORARY PAVEMENT
	WORK ZONE
	DRUM WITH STEADY BURNING MONO-DIRECTIONAL LIGHT
	TEMPORARY CONCRETE BARRIER

THIS MAINTENANCE OF TRAFFIC PLAN SHOWS SPECIAL TRAFFIC CONTROL IN THIS AREA. IN ADDITION TO THE SPECIAL TRAFFIC CONTROL DETAILS SHOWN, IDOT TRAFFIC CONTROL HIGHWAY STANDARDS SHALL APPLY WHERE APPLICABLE AND AS DIRECTED BY THE ENGINEER. SEE TRAFFIC NOTES ON THE CONSTRUCTION SEQUENCING SHEET FOR STAGE 3A FOR APPLICABLE IDOT HIGHWAY STANDARDS.



REVISIONS	
NAME	DATE

ILLINOIS DEPARTMENT OF TRANSPORTATION
 F.A.I. ROUTE 74 (I-74)
 MAINTENANCE OF TRAFFIC
 STAGE 3A
 STA. 153+000 TO STA. 153+300 I-74
 DRAWN BY KMO
 CHECKED BY RTG
 DATE 12/20/2004