

F.A.I. RTE.	SECTION	COUNTY	TOTAL SHEETS	SHEET NO.
74	*	TAZEWELL	1366	171
STA.		TO STA.		
FED. ROAD DIST. NO.		ILLINOIS FED. AID PROJECT		

*(90-11)R-2;90(13,14,14-1)R-1

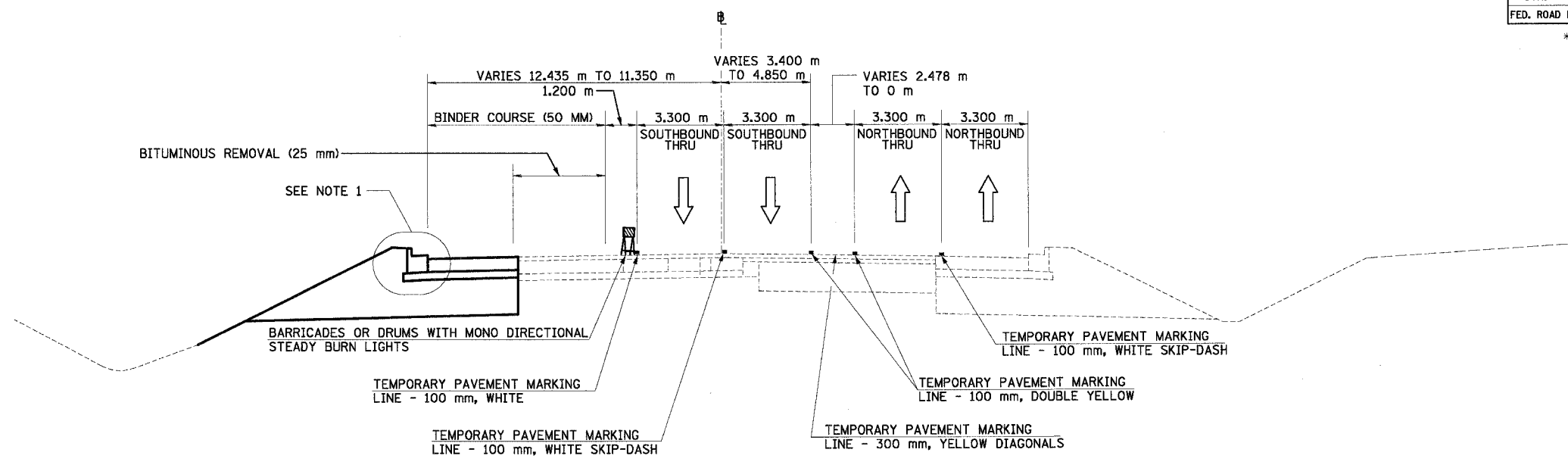

NORTH MAIN ST MOT TYPICAL SECTION NO. 13B
STA. 3+058.794 TO STA. 3+178.034

13B

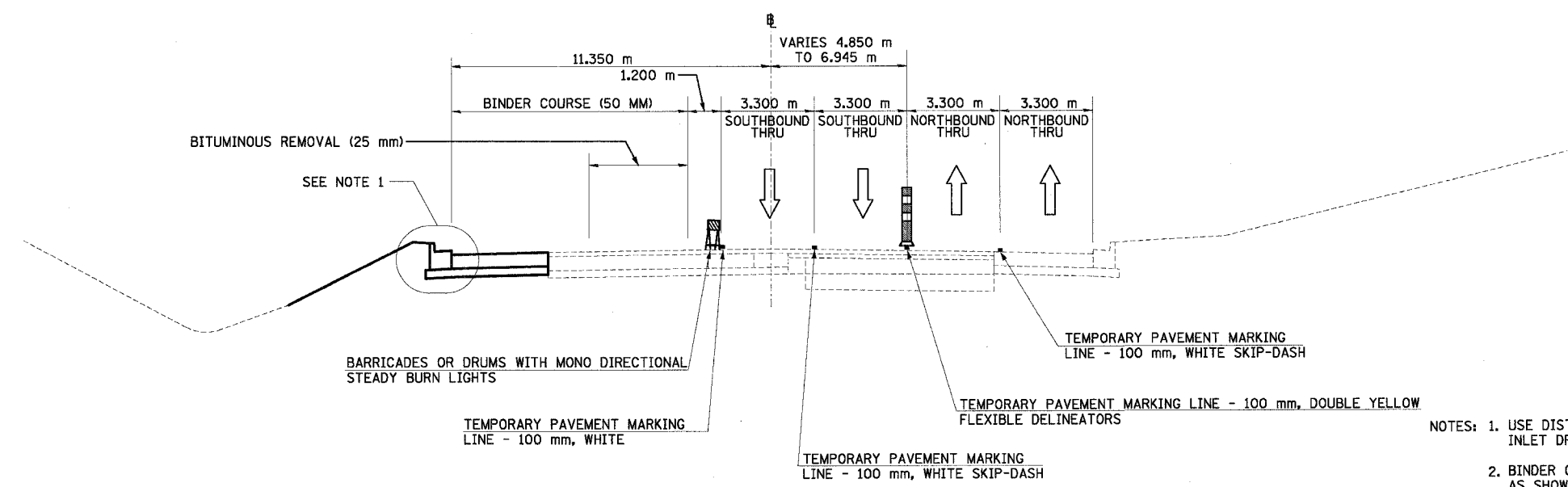

NORTH MAIN ST MOT TYPICAL SECTION NO. 14B
STA. 3+178.034 TO STA. 3+546.295

14B

- NOTES: 1. USE DISTRICT 4 STANDARD 602401-D4, TEMPORARY INLET DRAINAGE TREATMENT
2. BINDER COURSE IS TO BE PLACED IN WORKZONE AREAS AS SHOWN

REVISIONS	
NAME	DATE

ILLINOIS DEPARTMENT OF TRANSPORTATION
FAI ROUTE 74 (I-74)
MAINTENANCE OF TRAFFIC
STAGE 3A-3
ILL. 116-U.S. 150-NORTH MAIN ST.
TYPICAL SECTIONS 13B & 14B
DATE 12/20/2004
DRAWN BY MRF
CHECKED BY RTG

