

F.A. RTE.	SECTION	COUNTY	TOTAL SHEETS	SHEET NO.
74	*	TAZEWELL	1366	188
STA.		TO STA.		
FED. ROAD DIST. NO.		ILLINOIS FED. AID PROJECT		

*190-11)R-2:90(13,14,14-1)R-1

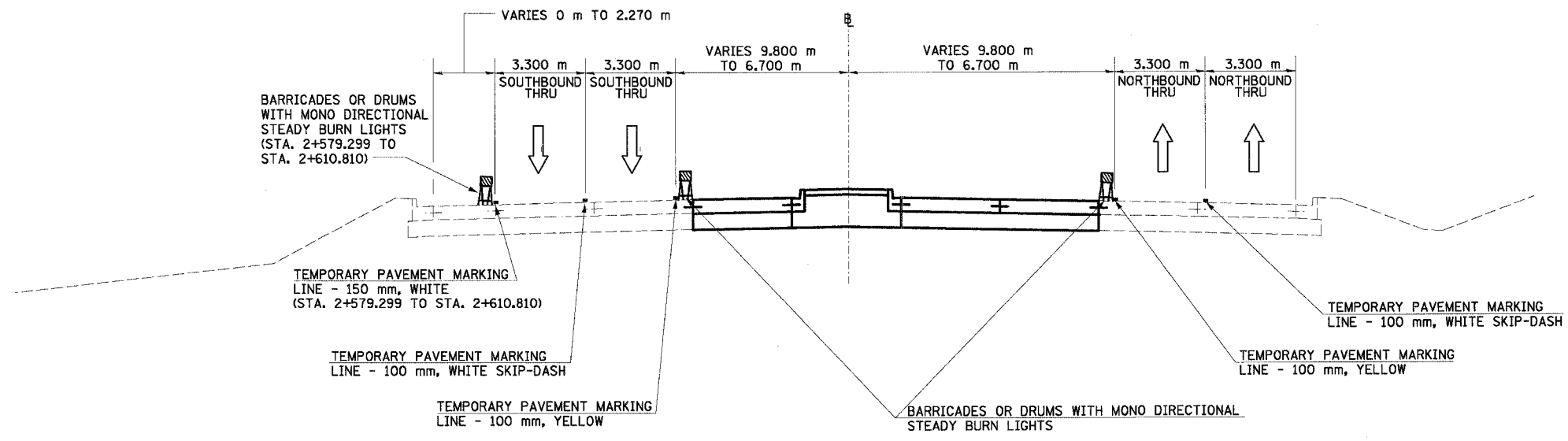

NORTH MAIN ST MOT TYPICAL SECTION NO. 9C (9C)
 STA. 2+579.299 TO STA. 2+703.299

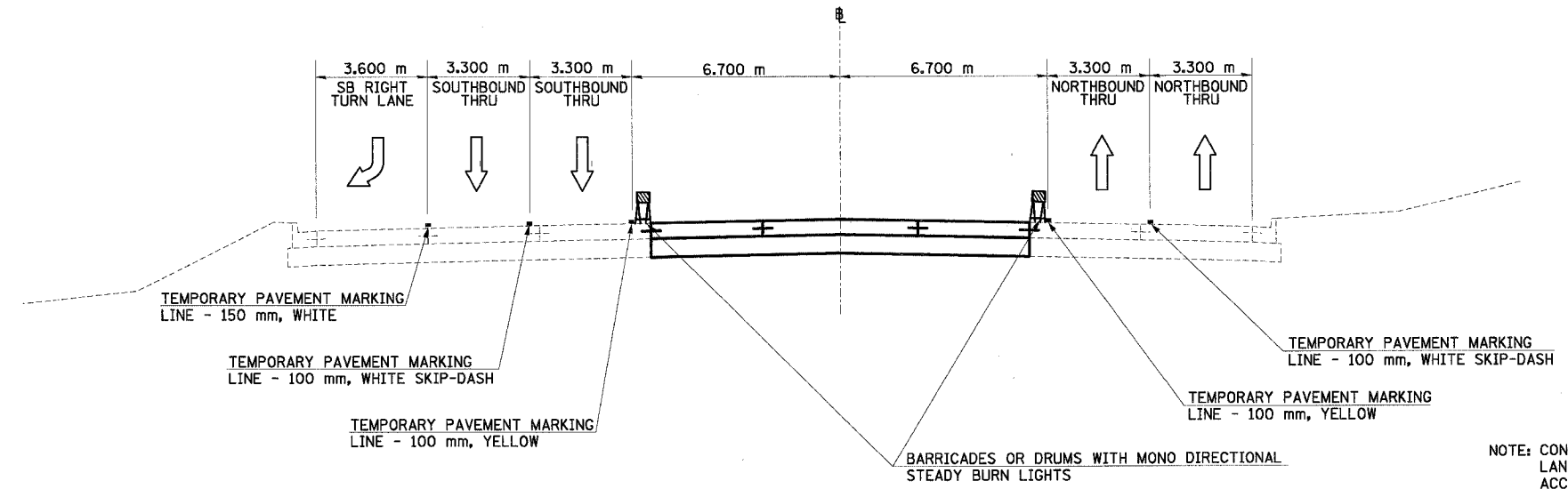

NORTH MAIN ST MOT TYPICAL SECTION NO. 10C (10C)
 STA. 2+703.299 TO STA. 2+743.300

NOTE: CONSTRUCTION OF THE NORTH MAIN STREET/ALTORFER LANE INTERSECTION SHALL BE STAGED SO THAT FULL ACCESS CAN BE MAINTAINED THROUGHOUT THIS INTERSECTION DURING THE ENTIRE DURATION OF CONSTRUCTION. STAGE 1 SHALL BE CONSTRUCTED DURING THE CONSTRUCTION OF THE PORTION OF NORTH MAIN STREET UP TO STATION 2+706.000. STAGE 2 SHALL NOT BE INITIATED UNTIL STAGE 1 IS COMPLETED. REFER TO TYPICAL SECTIONS 7A, 8A, 9C AND 10C FOR COORDINATION TO THE OUTER LANE PORTIONS OF NORTH MAIN STREET THAT HAVE BEEN PREVIOUSLY CONSTRUCTED.

REVISIONS	
NAME	DATE

ILLINOIS DEPARTMENT OF TRANSPORTATION
 FAI ROUTE 74 (I-74)
 MAINTENANCE OF TRAFFIC
 STAGE 3A-4
 ILL. 116-U.S. 150-NORTH MAIN ST.
 TYPICAL SECTIONS 9C & 10C
 DATE 12/20/2004
 DRAWN BY MRF
 CHECKED BY RTG

