

F.A.I. RTE.	SECTION	COUNTY	TOTAL SHEETS	SHEET NO.
74	*	TAZEWELL	1366	189
STA.		TO STA.		
FED. ROAD DIST. NO.		ILLINOIS FED. AID PROJECT		

*190-11R-2;9013,14,14-1R-1

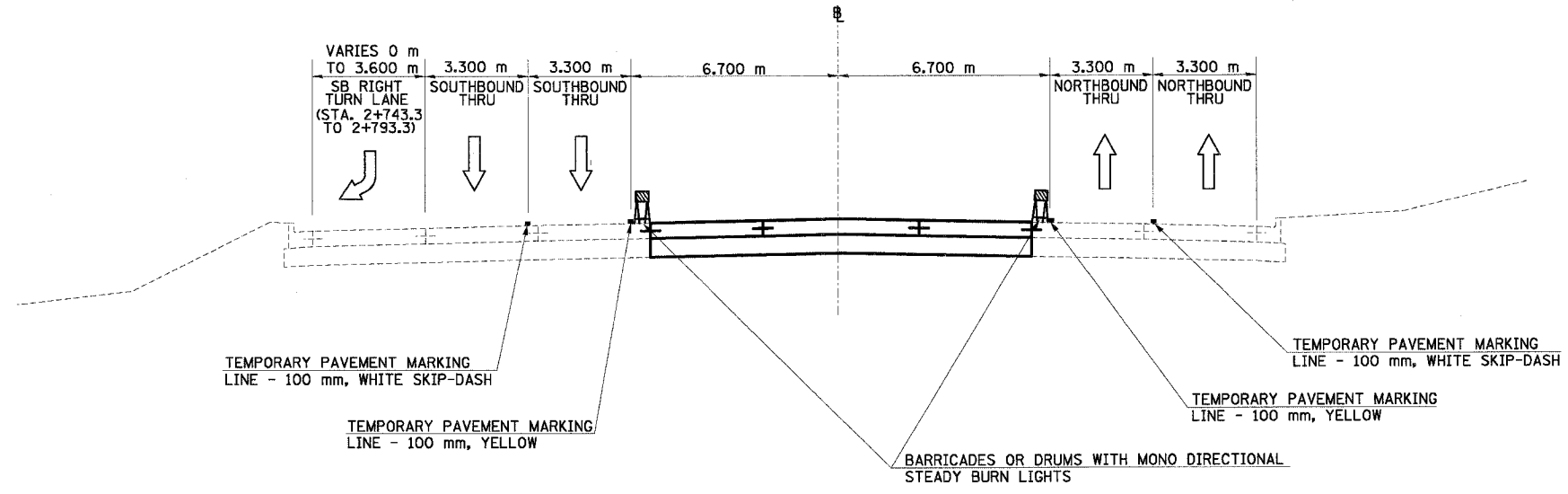

NORTH MAIN ST MOT TYPICAL SECTION NO. 11C (11C)
 STA. 2+743.300 TO STA. 2+800.000
 END OF COMPLETE PAVEMENT RECONSTRUCTION

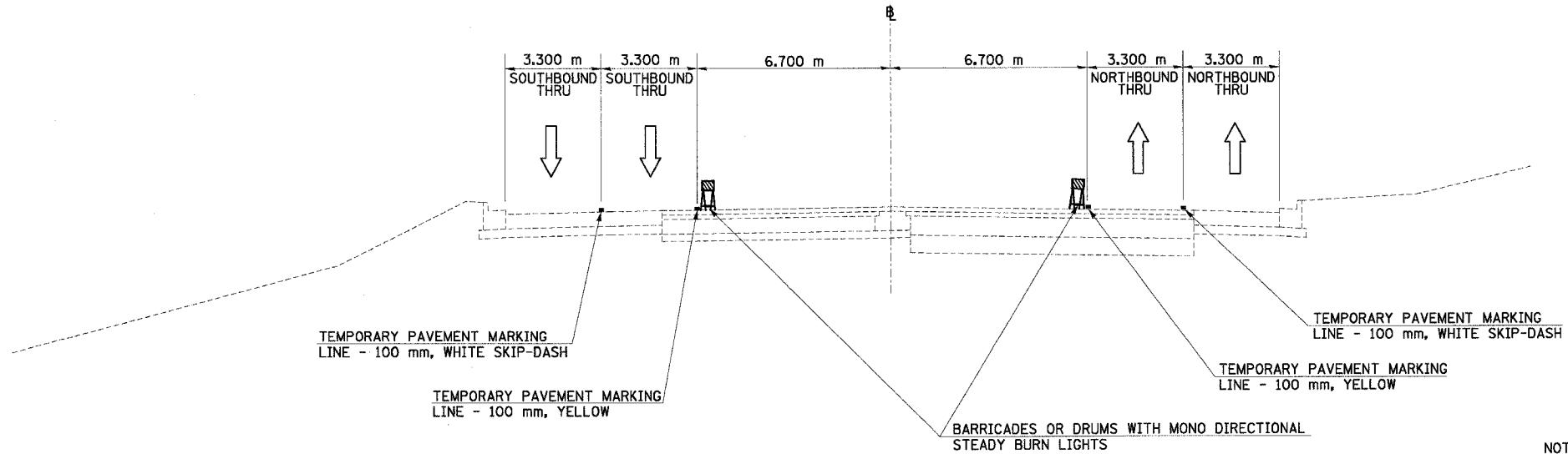

NORTH MAIN ST MOT TYPICAL SECTION NO. 12C (12C)
 STA. 2+800.000 TO STA. 3+023.295
 BEGIN RESURFACE AND WIDENING

NOTE:
 50mm BINDER COURSE TO BE PLACED WITHIN CENTER AREAS OF NORTH MAIN STREET THAT HAVE NOT RECEIVED BINDER COURSE DURING STAGES 3A-2 AND 3A-3. BARRICADES SHALL BE PLACED TO PROTECT THE AREAS THAT WILL RECEIVE BINDER COURSE DURING STAGE 3A-4

REVISIONS		ILLINOIS DEPARTMENT OF TRANSPORTATION FAI ROUTE 74 (I-74) MAINTENANCE OF TRAFFIC STAGE 3A-4 ILL. 116-U.S. 150-NORTH MAIN ST. TYPICAL SECTIONS 11C & 12C
NAME	DATE	



DATE 12/20/2004
 DRAWN BY MRF
 CHECKED BY RTG