

F.A.I. RTE.	SECTION	COUNTY	TOTAL SHEETS	SHEET NO.
74	*	TAZEWELL	1366	193
STA.		TO STA.		
FED. ROAD DIST. NO.		ILLINOIS FED. AID PROJECT		

\*(90-11)R-2:90(13,14,14-1)R-1

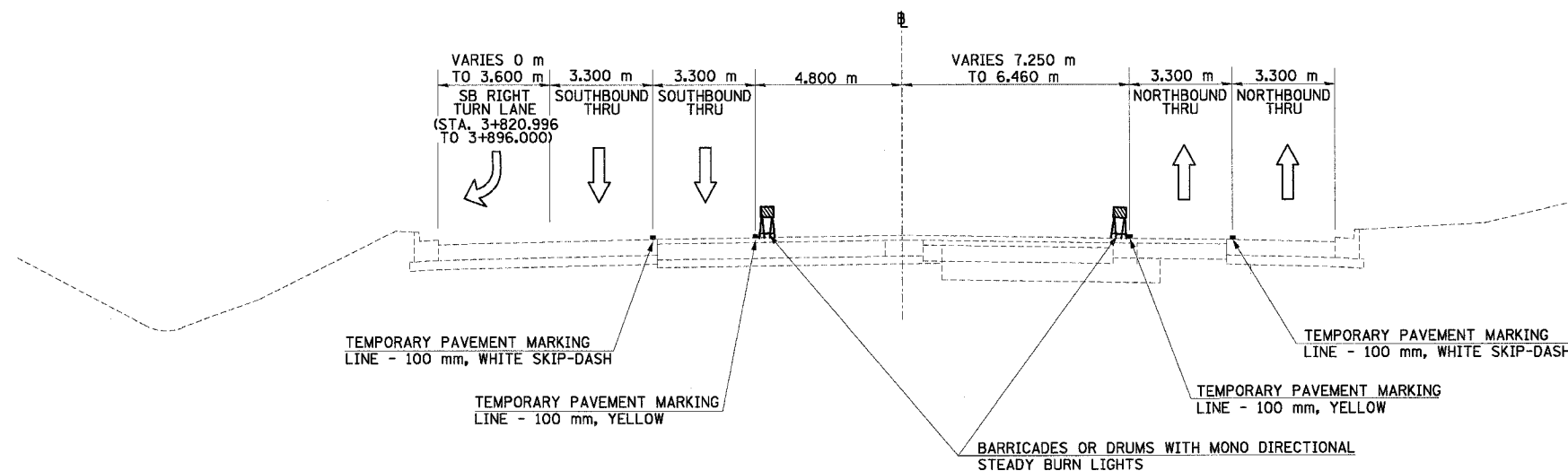

**NORTH MAIN ST MOT TYPICAL SECTION NO. 19C**  
STA. 3+820.996 TO STA. 3+896.000

19C

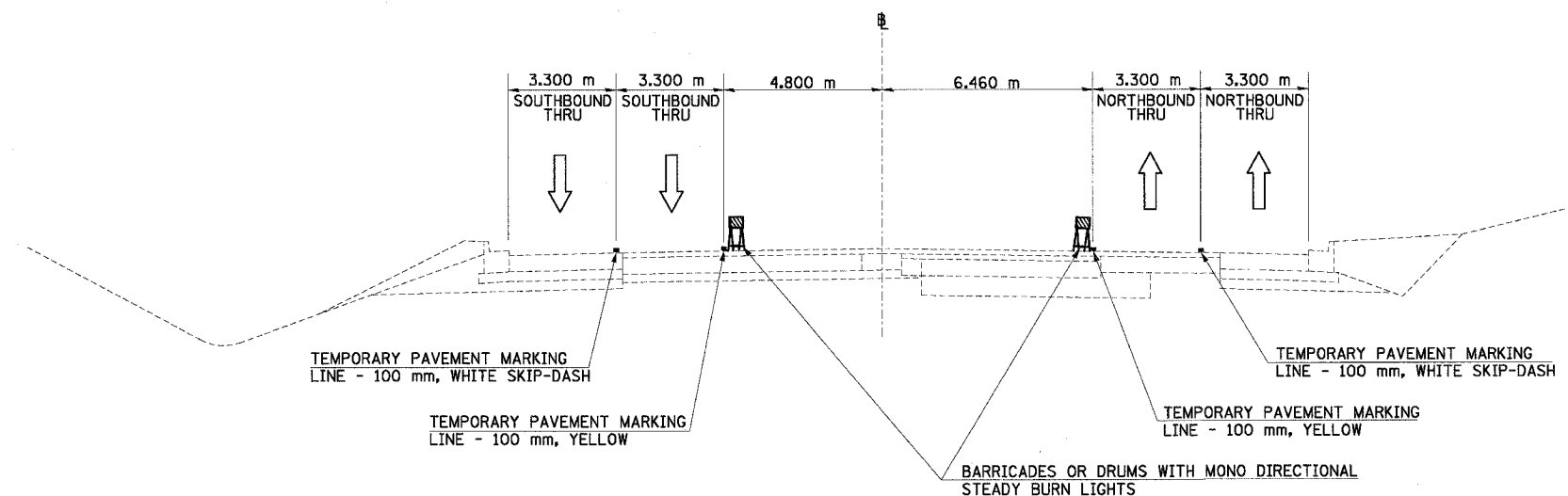

**NORTH MAIN ST MOT TYPICAL SECTION NO. 20C**  
STA. 3+896.000 TO STA. 3+977.000

20C

NOTE:

50mm BINDER COURSE TO BE PLACED WITHIN CENTER AREAS OF NORTH MAIN STREET THAT HAVE NOT RECEIVED BINDER COURSE DURING STAGES 3A-2 AND 3A-3. BARRICADES SHALL BE PLACED TO PROTECT THE AREAS THAT WILL RECEIVE BINDER COURSE DURING STAGE 3A-4

REVISIONS	
NAME	DATE



ILLINOIS DEPARTMENT OF TRANSPORTATION  
FAI ROUTE 74 (I-74)  
MAINTENANCE OF TRAFFIC  
STAGE 3A-4  
ILL. 116-U.S. 150-NORTH MAIN ST.  
TYPICAL SECTIONS 19C & 20C  
DATE 12/20/2004  
DRAWN BY MRF  
CHECKED BY RTG