

F.A.I. RTE.	SECTION	COUNTY	TOTAL SHEETS	SHEET NO.
74	(90-11R-2) 90(13,14,14-1R-1)	TAZEWELL	1366	210
STA. 152+700		TO STA. 153+000		
FED. ROAD DIST. NO. 4		ILLINOIS FED. AID PROJECT		

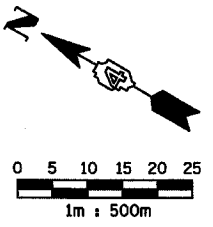

LEGEND	
	WORK ZONE
	TRAFFIC FLOW DIRECTION

THIS MAINTENANCE OF TRAFFIC PLAN SHOWS SPECIAL TRAFFIC CONTROL IN THIS AREA. IN ADDITION TO THE SPECIAL TRAFFIC CONTROL DETAILS SHOWN, IDOT TRAFFIC CONTROL HIGHWAY STANDARDS SHALL APPLY WHERE APPLICABLE AND AS DIRECTED BY THE ENGINEER. SEE TRAFFIC NOTES ON THE CONSTRUCTION SEQUENCING SHEET FOR STAGE 3C FOR APPLICABLE IDOT HIGHWAY STANDARDS.

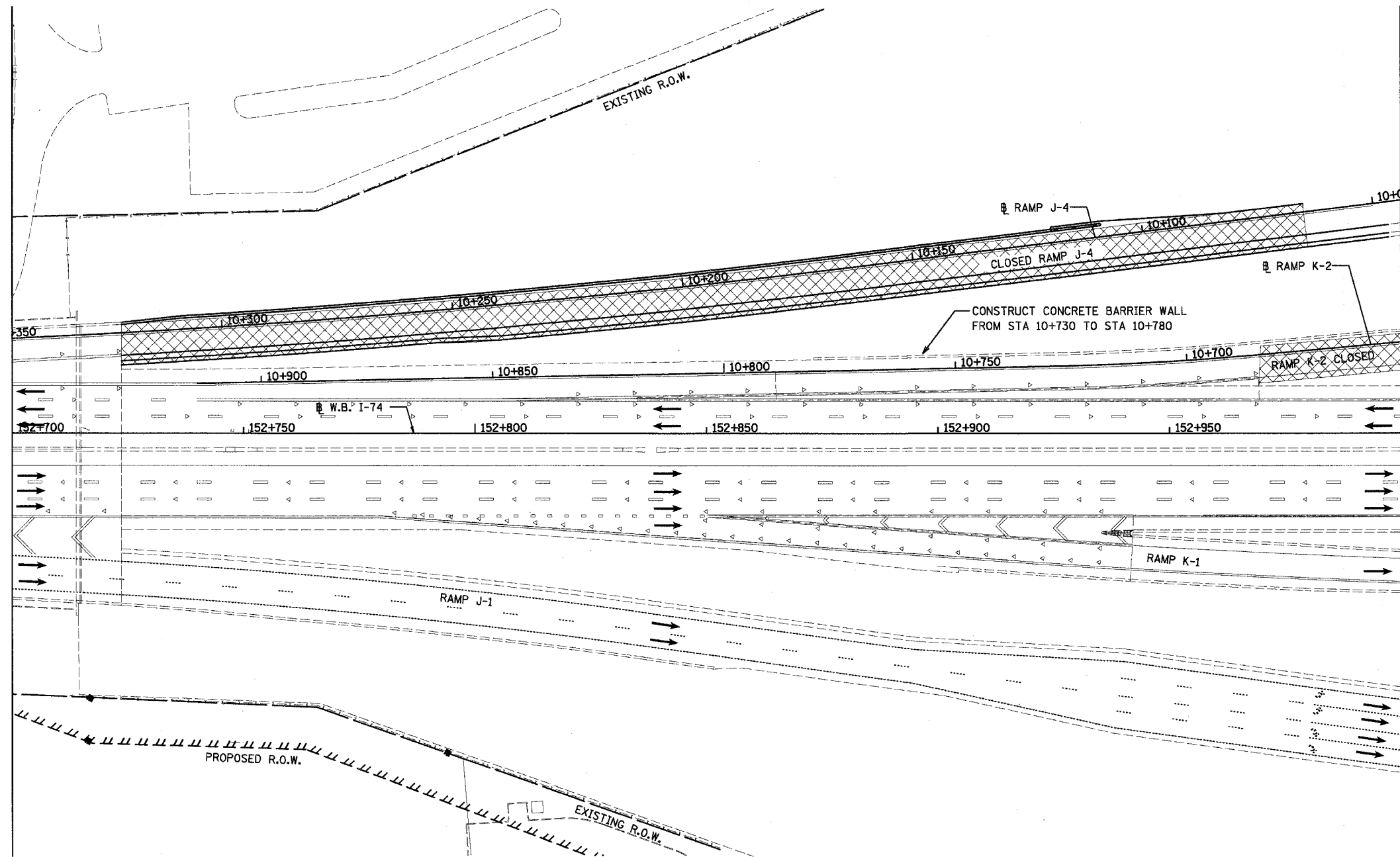

REVISIONS	
NAME	DATE

ILLINOIS DEPARTMENT OF TRANSPORTATION
F.A.I. ROUTE 74 (I-74)
MAINTENANCE OF TRAFFIC
STAGE 3C
STA. 152+700 TO STA. 153+000 I-74
DRAWN BY KMO
CHECKED BY RTG
DATE 12/20/2004