

F.A.I. RTE.	SECTION	COUNTY	TOTAL SHEETS	SHEET NO.
74		TAZEWELL	1366	278
STA. 2+750.000 TO STA. 2+900.000				
FED. ROAD DIST. NO. 4			ILLINOIS FED. AID PROJECT	
* (90-11R-2;90(13,14,14-1R-1				

DISPOSITION OF EXISTING DRAINAGE FEATURES

- A** STRUCTURE TO BE ADJUSTED WITH NEW FRAME AND GRATE
- A** STRUCTURE TO BE ADJUSTED WITH NEW FRAME AND LID
- ADJ** STRUCTURE TO BE ADJUSTED
- C** STRUCTURE TO BE CLEANED
- F** STRUCTURE TO BE FILLED
- REC** STRUCTURE TO BE RECONSTRUCTED WITH NEW FRAME AND LID
- R** STRUCTURE TO BE REMOVED
- AB** ITEM TO BE ABANDONED
- REL** ITEM TO BE RELOCATED
- SSR** STORM SEWER REMOVAL
- SSC** STORM SEWER TO BE CLEANED

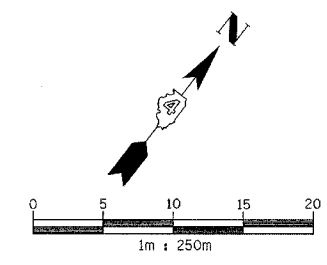

EXISTING DRAINAGE AND UTILITY LEGEND

- OVERHEAD ELECTRIC
- STORM SEWER
- SANITARY SEWER
- CULVERT PIPE
- TRENCH DRAIN
- UNDERGROUND TELEPHONE
- UNDERGROUND FIBER OPTIC
- UNDERGROUND COMMUNICATIONS DUCT
- UNDERGROUND WATER MAIN
- UNDERGROUND GAS MAIN
- HEADWALL
- INLET
- CONC END SECTION
- UTILITY MANHOLE
- ELECTRIC/TELEPHONE SPLICE BOX
- TRAFFIC SIGNAL HANDHOLE
- POWER POLE
- TELEPHONE POLE
- HIGH MAST LIGHT
- ABOVE GROUND TRANSFORMER
- WATER VALVE OR UTIL. BOX
- FIRE HYDRANT
- RAILROAD SWITCH
- RAILROAD SIGNAL
- FIBER OPTIC JUNCTION BOX

MATCH LINE STA. 2+750

MATCH LINE STA. 2+900

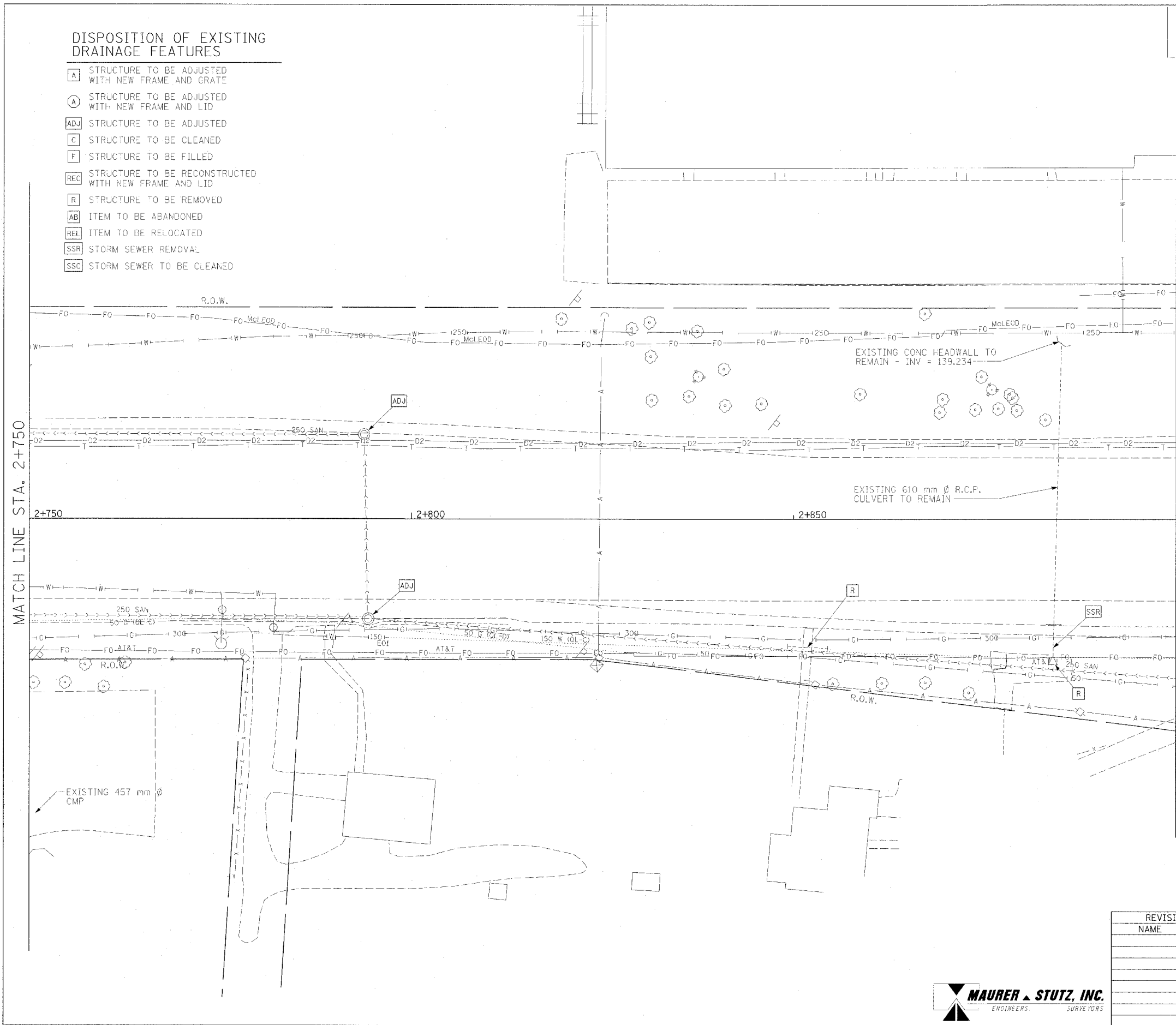

EXISTING CONDITIONS

REVISIONS	
NAME	DATE

ILLINOIS DEPARTMENT OF TRANSPORTATION
DRAINAGE AND UTILITY PLAN
MAIN STREET
 STA 2+750 TO 2+900
 DRAWN BY JAM
 DATE 12/20/04 CHECKED BY MJS

