

F.A.I. RTE.	SECTION	COUNTY	TOTAL SHEETS	SHEET NO.
74	*	TAZEWELL	1366	1294
STA. 3+950.000		TO STA. 4+100.000		
FED. ROAD DIST. NO. 4		ILLINOIS FED. AID PROJECT		

• (90-111R-2;90113,14,14-1R-1

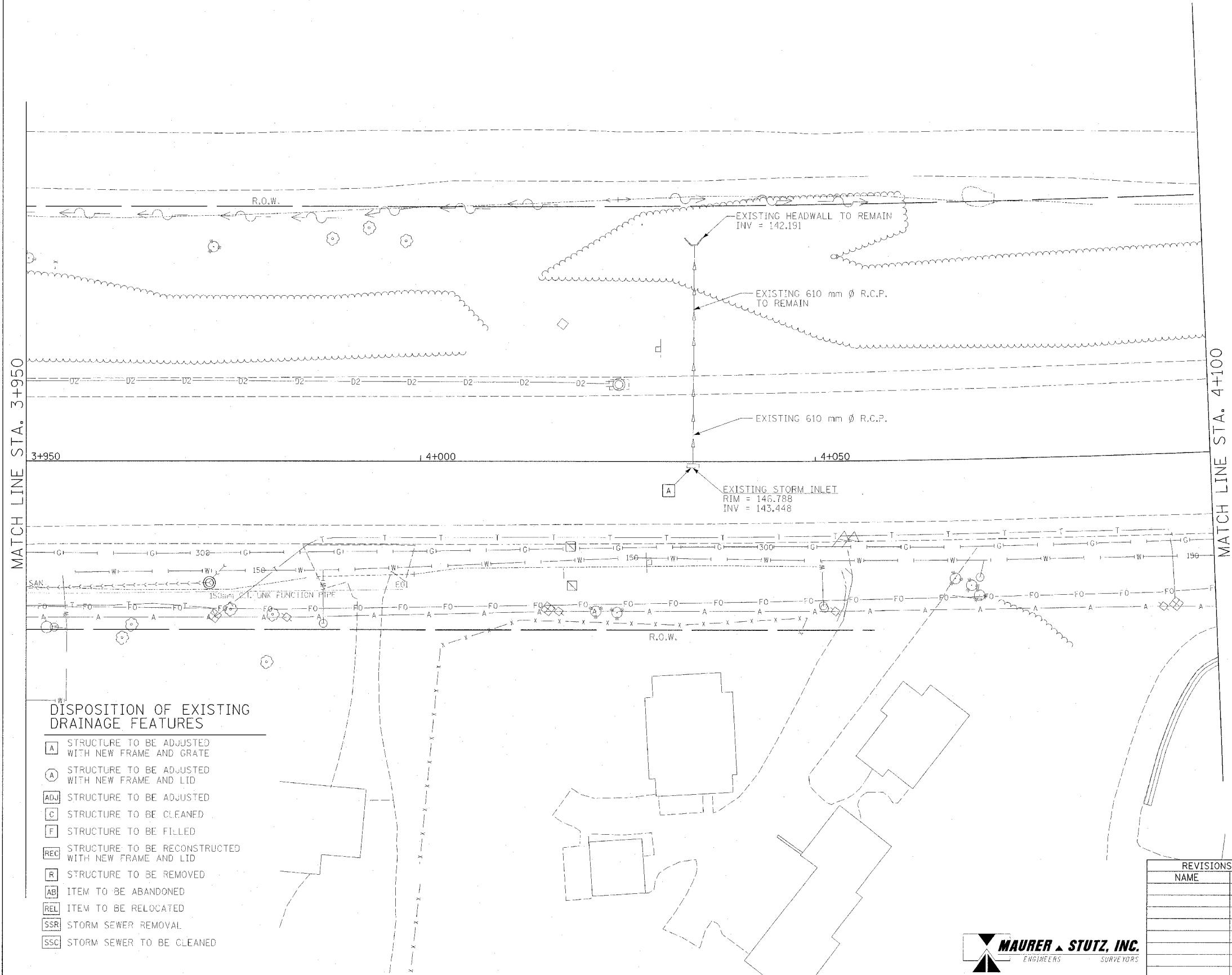
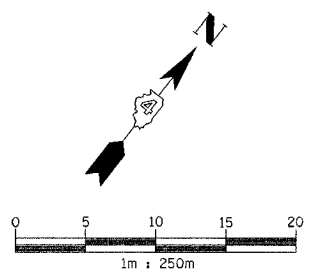

**EXISTING DRAINAGE AND UTILITY LEGEND**

—A—	OVERHEAD ELECTRIC
—SS—	STORM SEWER
—S—	SANITARY SEWER
—C—	CULVERT PIPE
—T—	TRENCH DRAIN
—U—	UNDERGROUND TELEPHONE
—FO—	UNDERGROUND FIBER OPTIC
—D—	UNDERGROUND COMMUNICATIONS DUCT
—W—	UNDERGROUND WATER MAIN
—G—	UNDERGROUND GAS MAIN
—H—	HEADWALL
—I—	INLET
—C—	CONC END SECTION
—M—	UTILITY MANHOLE
—S—	ELECTRIC/TELEPHONE SPLICE BOX
—T—	TRAFFIC SIGNAL HANDHOLE
—P—	POWER POLE
—T—	TELEPHONE POLE
—L—	HIGH MAST LIGHT
—T—	ABOVE GROUND TRANSFORMER
—V—	WATER VALVE OR UTIL. BOX
—F—	FIRE HYDRANT
—S—	RAILROAD SWITCH
—S—	RAILROAD SIGNAL
—J—	FIBER OPTIC JUNCTION BOX

**DISPOSITION OF EXISTING DRAINAGE FEATURES**

- [A] STRUCTURE TO BE ADJUSTED WITH NEW FRAME AND GRATE
- [A] STRUCTURE TO BE ADJUSTED WITH NEW FRAME AND LID
- [ADJ] STRUCTURE TO BE ADJUSTED
- [C] STRUCTURE TO BE CLEANED
- [F] STRUCTURE TO BE FILLED
- [REC] STRUCTURE TO BE RECONSTRUCTED WITH NEW FRAME AND LID
- [R] STRUCTURE TO BE REMOVED
- [AB] ITEM TO BE ABANDONED
- [REL] ITEM TO BE RELOCATED
- [SSR] STORM SEWER REMOVAL
- [SSC] STORM SEWER TO BE CLEANED

**EXISTING CONDITIONS**

REVISIONS	
NAME	DATE

ILLINOIS DEPARTMENT OF TRANSPORTATION  
**DRAINAGE AND UTILITY PLAN**  
**MAIN STREET**  
 STA 3+950 TO 4+100  
 DRAWN BY JAM  
 DATE 12/20/04 CHECKED BY MJS

