

F.A.I. RTE.	SECTION	COUNTY	TOTAL SHEETS	SHEET NO.
74	90-1R-2003,14+1R-1	TAZEWELL	1366	334
STA. 153+300.000 TO STA. 153+892.180				
FED. ROAD DIST. NO. 4 ILLINOIS FED. AID PROJECT				

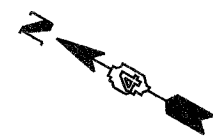
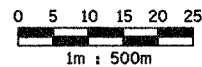

MATCHLINE STA. 153+300 (W.B. I-74)

MATCHLINE STA. 153+600 (W.B. I-74)

MATCHLINE STA. 153+600 (W.B. I-74)

MATCHLINE STA. 153+892.180 (W.B. I-74)
(SEE SET 2 OF 4 FOR CONTINUATION OF W.B. I-74 PAVEMENT MARKINGS)

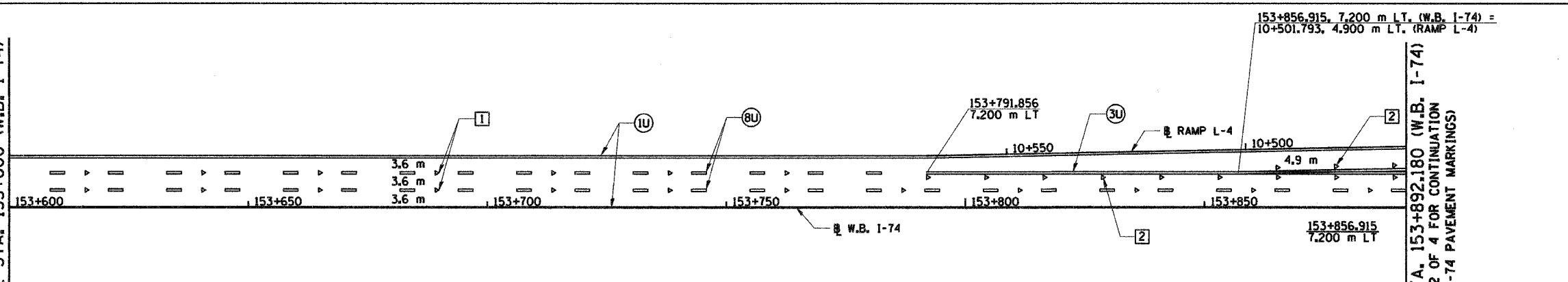
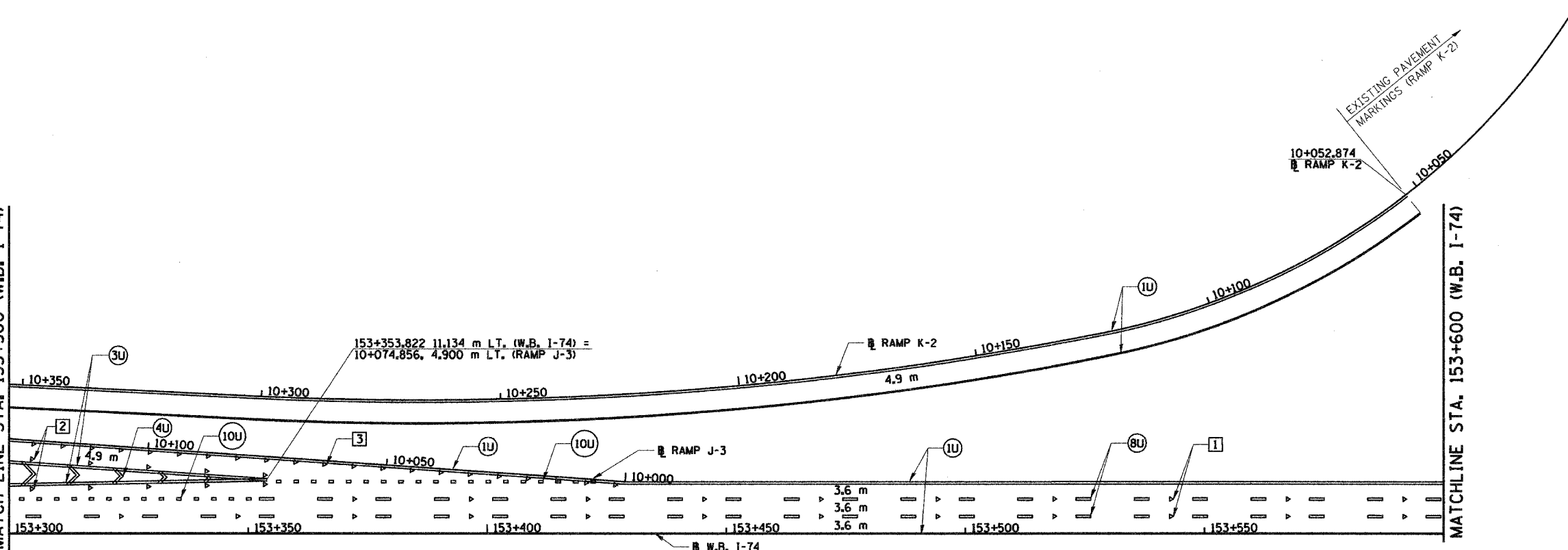

PAVEMENT MARKING LEGEND		RAISED REFLECTIVE PAVEMENT MARKERS	
(1X)	100 (4) SOLID	1	ONE-WAY CRYSTAL MARKER AT 24.38 m(80') CENTERS
(2X)	150 (6) SOLID	2	ONE-WAY CRYSTAL MARKER AT 12.19 m(40') CENTERS
(3X)	200 (8) SOLID	3	ONE-WAY CRYSTAL MARKER AT 6.10 m(20') CENTERS
(4X)	300 (12) SOLID	4	ONE-WAY AMBER MARKER AT 12.19 m(40') CENTERS
(5X)	600 (24) SOLID	5	TWO-WAY AMBER MARKER AT 12.19 m(40') CENTERS FOR SPEEDS LESS THAN 45 MPH
(6X)	100 (4) DOUBLE SOLID	6	TWO-WAY AMBER MARKER AT 24.38 m(80') CENTERS FOR SPEEDS GREATER THAN 45 MPH
(7X)	100 (4) SKIP DASH		
(8X)	150 (6) SKIP DASH		
(9X)	200 (8) SKIP DASH		
(10X)	200 (8) DOTTED		
(11X)	LETTERS AND ARROWS		

WHERE "X" DESIGNATES: — — WHITE
 E = EPOXY — — YELLOW
 P = PAINT
 T = THERMOPLASTIC
 U = POLYUREA

All dimensions are in millimeters (inches) unless otherwise shown.

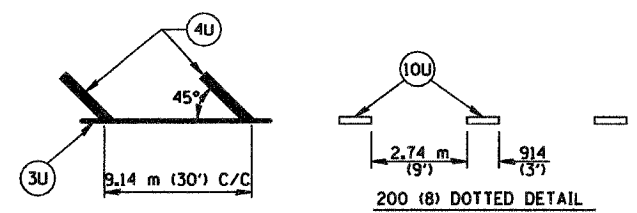

DATE: DATE-TIME HERE TIME HERE
 BEGIN FILE NAME GOES HERE-SIZE IS LARGE ENOUGH FOR LONG FILE NAMES

REVISIONS	
NAME	DATE



ILLINOIS DEPARTMENT OF TRANSPORTATION
PAVEMENT MARKING PLAN
WESTBOUND I-74
STA. 153+300.000 TO
STA. 153+892.180

DATE 12-20-04

DRAWN BY JEH
 CHECKED BY