

\\phase2\roadway\101104-Sema.dgn 12/17/2004 12:08:13 PM

88201

F.A.I. RTE.	SECTION	COUNTY	TOTAL SHEETS	SHEET NO.
74	*	TAZEWELL	136	337
STA. 2+900		TO STA. 3+600		
FED. ROAD DIST. NO.		ILLINOIS FED. AID PROJECT		
* (90-10R-2)90(3,4,14-10R-1				

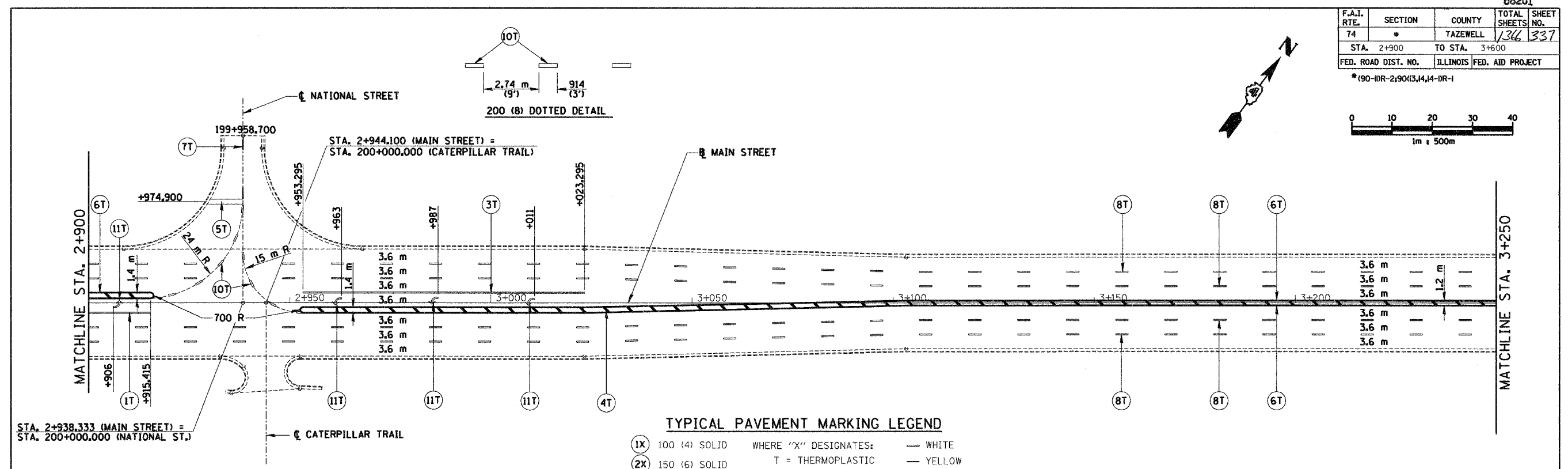
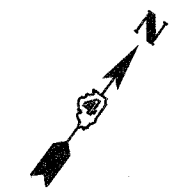
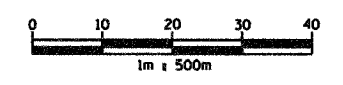

TYPICAL PAVEMENT MARKING LEGEND

- 1X 100 (4) SOLID WHERE "X" DESIGNATES: — WHITE
- 2X 150 (6) SOLID T = THERMOPLASTIC — YELLOW
- 3X 200 (8) SOLID E = EPOXY
- 4X 300 (12) SOLID P = PAINT
- 5X 600 (24) SOLID
- 6X 100 (4) DOUBLE SOLID
- 7X 100 (4) SKIP DASH (9m-3m)
- 8X 150 (6) SKIP DASH (9m-3m)
- 9X 200 (8) SKIP DASH (9m-3m)
- 10X 200 (8) DOTTED
- 11X LETTERS AND SYMBOLS

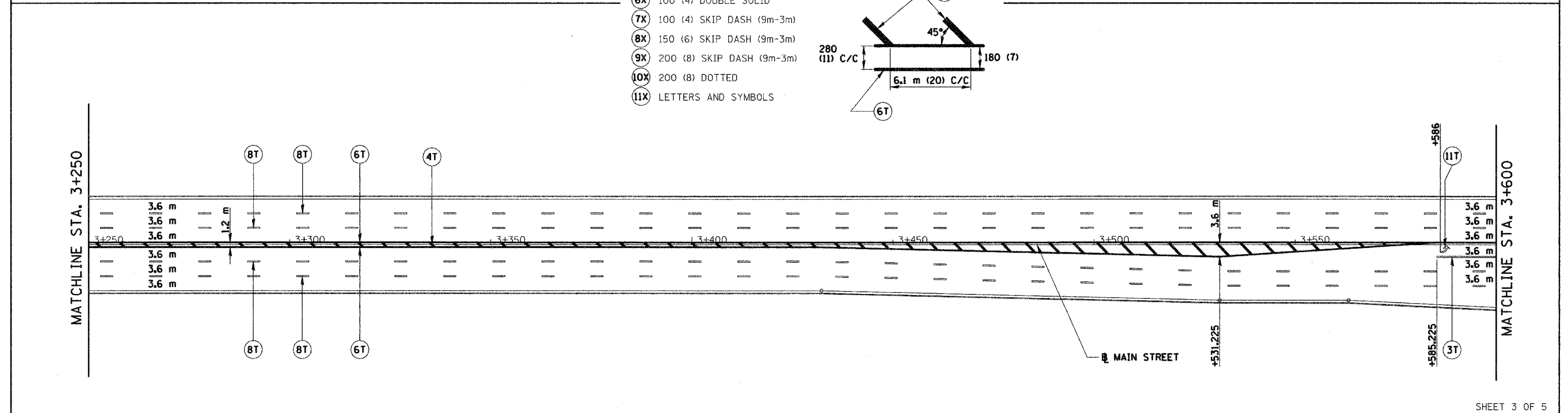
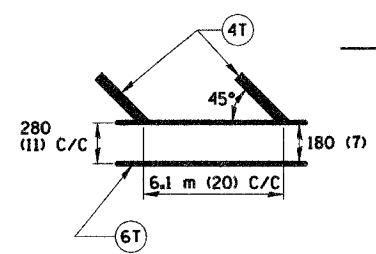

SHEET 3 OF 5

REVISIONS	
NAME	DATE

ILLINOIS DEPARTMENT OF TRANSPORTATION
 PAVEMENT MARKING PLAN
 ILL. 116 - U.S. 150 - MAIN ST.
 STA. 2+900 TO STA. 3+600



DATE 12-20-04
 DRAWN BY SRS
 CHECKED BY JJM