

F.A.I. RTE.	SECTION	COUNTY	TOTAL SHEETS	SHEET NO.
74	*	TAZEWELL	1366	354
STA.		TO STA.		
FED. ROAD DIST. NO.		ILLINOIS FED. AID PROJECT		
* (90-111R-2)90113, 14, 14-1R-1				

- LEGEND:**
- PERM SIGN, CM-C - PERMANENT SIGN, INSTALLED IN CITY OF EAST PEORIA MAIN CAMP INTERSECTION CONTRACT
 - TEMP SIGN, C68199 - EXISTING TEMPORARY SIGN INSTALLED IN CONTRACT 68199
 - RET - RETAIN EXISTING SIGN
 - PSR - REMOVAL IN PERMANENT SIGNING PLANS (TIMING OF REMOVAL INDICATED IN SUB-STAGE BY 'X'S')
 - RTSPA - REINSTALL TEMPORARY SIGN PANEL ASSEMBLY (INCLUDES REMOVAL)
 - CTSO - COMPOSITE TEMPORARY SIGN OVERLAY (INCLUDES REMOVAL)
 - SPO(S) - SIGN PANEL OVERLAY, SPECIAL (INCLUDES REMOVAL)
 - TSPD - TEMPORARY SIGN PANEL OVERLAY (INCLUDES REMOVAL)
 - TSPA - TEMPORARY SIGN PANEL ASSEMBLY (INCLUDES REMOVAL)
 - RSPA - REMOVE SIGN PANEL ASSEMBLY
 - RELSPA - RELOCATE SIGN PANEL ASSEMBLY
 - SP - SIGN PANEL, TYPE 1, 2 OR 3 AND ASSEMBLY TYPE A OR B.
 - TC&P(SP) - SIGN INCLUDED IN MOT STANDARD FOR TRAFFIC CONTROL (PAID AS PART OF TRAFFIC CONTROL AND PROTECTION, SPECIAL)
 - TC&P(EX) - SIGN INCLUDED IN MOT STANDARD FOR TRAFFIC CONTROL AND PROTECTION (PAID AS PART OF TRAFFIC CONTROL AND PROTECTION, EXPRESSWAYS)

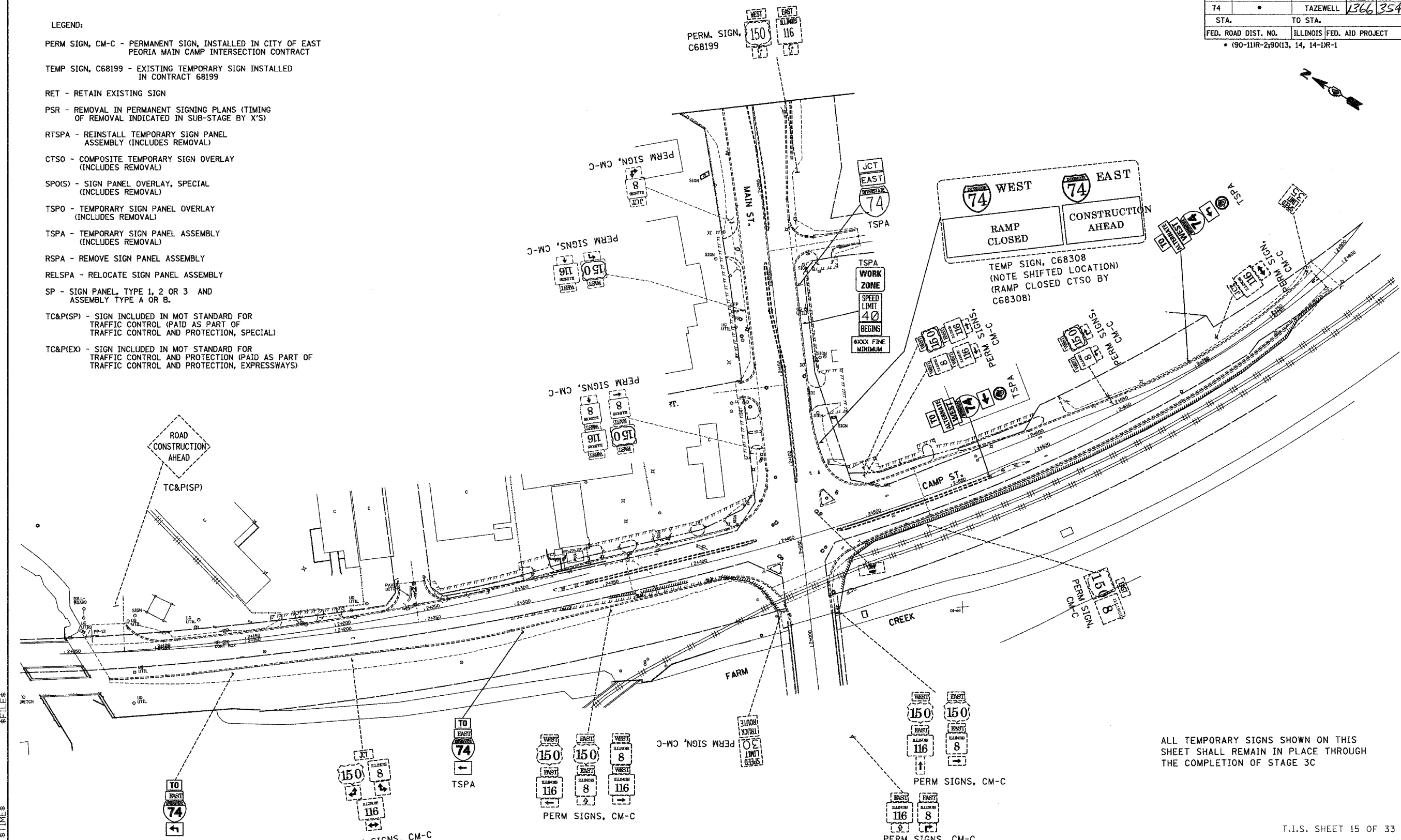

ALL TEMPORARY SIGNS SHOWN ON THIS SHEET SHALL REMAIN IN PLACE THROUGH THE COMPLETION OF STAGE 3C

REVISIONS	
NAME	DATE

ILLINOIS DEPARTMENT OF TRANSPORTATION
CONCEPTUAL TEMPORARY INFORMATION SIGNING PLAN
 CONTRACT 68201
 STAGE 3A
 DRAWN BY DJK
 CHECKED BY DPA
 DATE 12-20-04

INFORMATION FOR THIS SHEET WAS PROVIDED BY ALFRED BENESCH & COMPANY

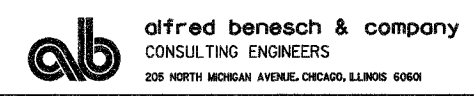

\$DATE\$ \$TIME\$ \$FILE\$

D:\projects\68201\68201.dwg 1/6/2005 2:30:15 PM