

F.A.I. RTE.	SECTION	COUNTY	TOTAL SHEETS	SHEET NO.
74	90-1R-2003J44-1R-1	TAZEWELL	1366	379
STA.		TO STA.		
FED. ROAD DIST. NO. 4		ILLINOIS		FED. AID PROJECT

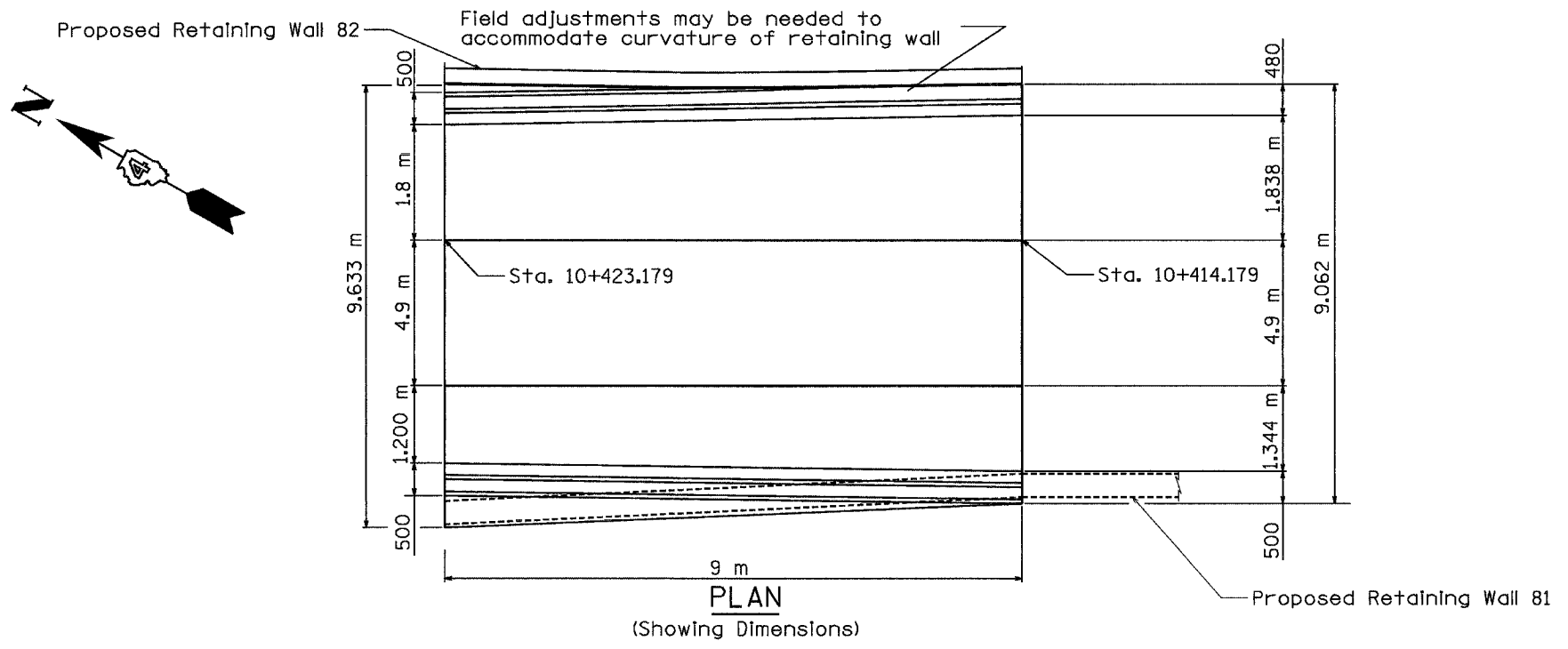

DESIGN STRESSES

$f_y = 400 \text{ MPa}$   
 $f'_c = 24 \text{ MPa}$   
 $n = 8.5$

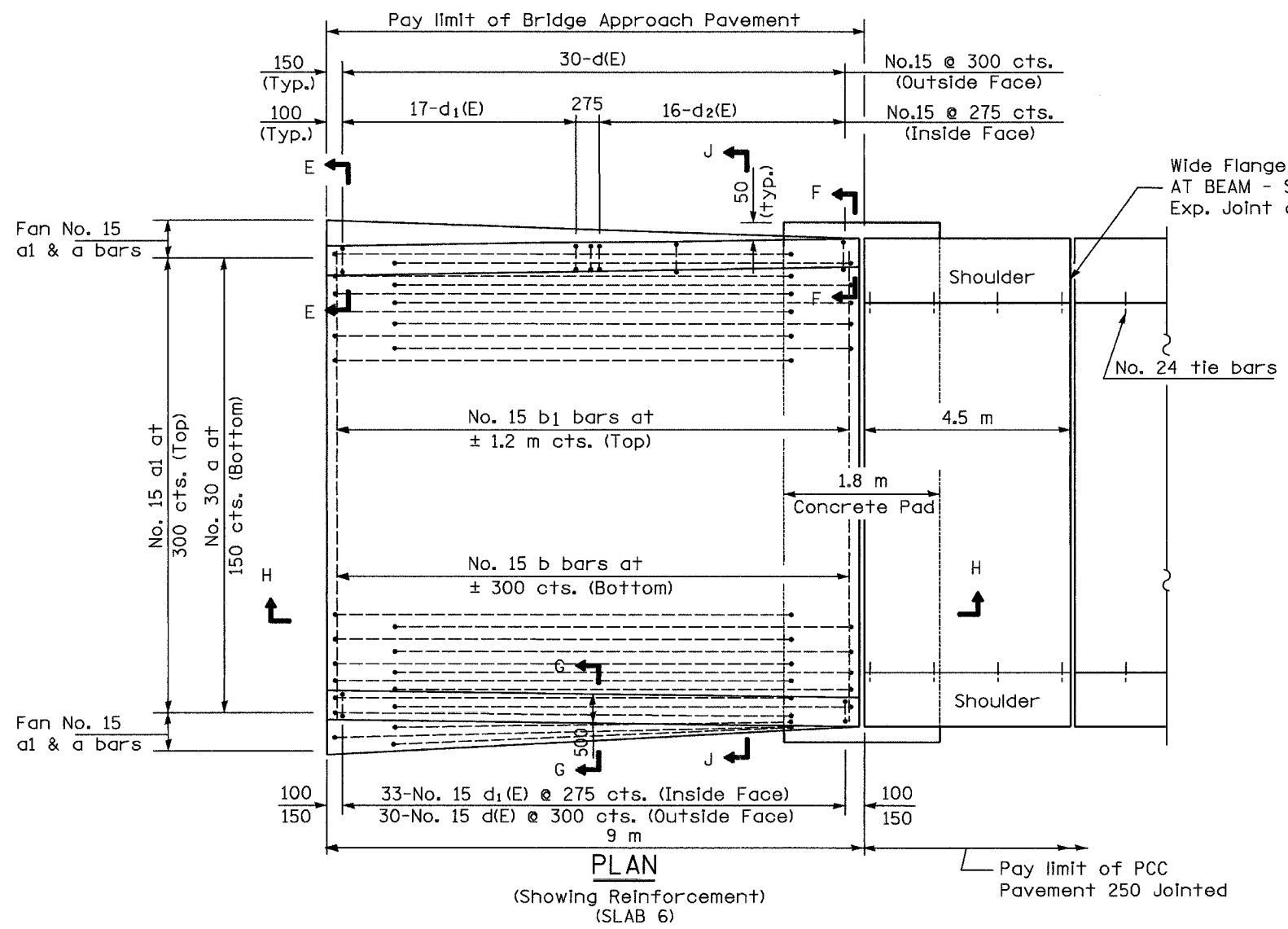

GENERAL NOTES

- See Standard 420001 for joint details not shown.
- All dimensions are in millimeters unless otherwise shown.
- See Sheet 6 of 6 for Slab No. 6 Bill of Material.

REVISIONS	
NAME	DATE

ILLINOIS DEPARTMENT OF TRANSPORTATION  
 BRIDGE APPROACH PAVEMENT  
 DETAILS SOUTH SLAB, RAMP K-2  
 OVER MAIN ST. (ILL 116)  
 DATE 12-20-04  
 DRAWN BY TMM  
 CHECKED BY ACW

