

ROUTE NO.	SECTION	COUNTY	TOTAL SHEETS	SHEET NO.
F.A.I. 74	90-13HVB	TAZEWELL	1366	450
FED. ROAD DIST. NO. 7	ILLINOIS	FED. AID PROJECT-		

SHEET NO. 2  
68 SHEETS

FOR LEGEND SEE PLAN VIEW ON SHT. 1

Legend	Location Station Elevation	Legend	Location Station Elevation
①	Bk. of N.Abut. Sta. 153+496.485 Elev. 152.103	⑩	☉ Pier #3 Sta. 153+588.515 Elev. 152.838
②	☉ Brg. N. Abut. Sta. 153+497.494 Elev. 152.110	⑪	☉ Pier #4 Sta. 153+625.193 Elev. 153.131
③	☉ Pier #1 Sta. 153+511.819 Elev. 152.224	⑫	☉ Pier #5 Sta. 153+649.336 Elev. 153.299
④	Sta. 153+525.091 (E.B. I-74)= Sta. 100+106.136 (W.B. Camp St.)	⑬	☉ Pier #6 Sta. 153+696.123 Elev. 153.419
⑤	Sta. 153+533.740 (W.B. I-74)= Sta. 100+117.264 (W.B. Camp St.)	⑭	☉ Pier #7 Sta. 153+723.860 Elev. 153.363
⑥	☉ Pier #2 Sta. 153+548.243 Elev. 152.516	⑮	☉ Brg. S.Abut. Sta. 153+740.751 Elev. 153.283
⑦	Sta. 153+569.683 (W.B. I-74)= Sta. 200+072.296 (E.B. Camp St.)	⑯	Bk. of S.Abut. Sta. 153+741.674 Elev. 153.278
⑧	Sta. 153+564.119 (E.B. I-74)= Sta. 200+063.355 (E.B. Camp St.)	⑰	Exist. WB. Structure
⑨	Sta. 10+501.988 (Ramp J-2)= Sta. 200+047.266 (E.B. Camp St.)		

STATE OF ILLINOIS  
DEPARTMENT OF TRANSPORTATION

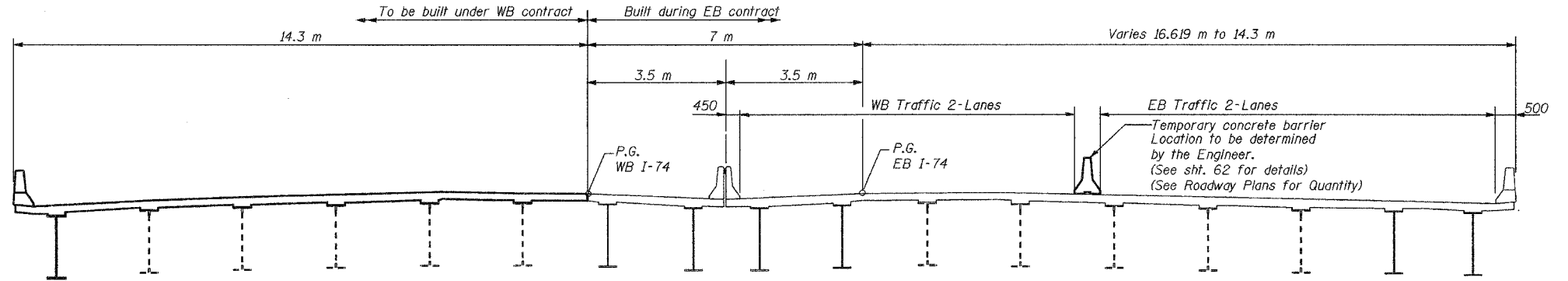

TRAFFIC STAGING DETAILS  
(LOOKING SOUTH)

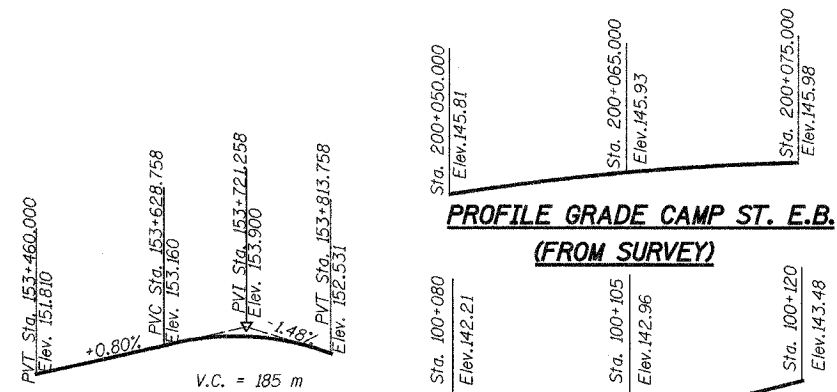
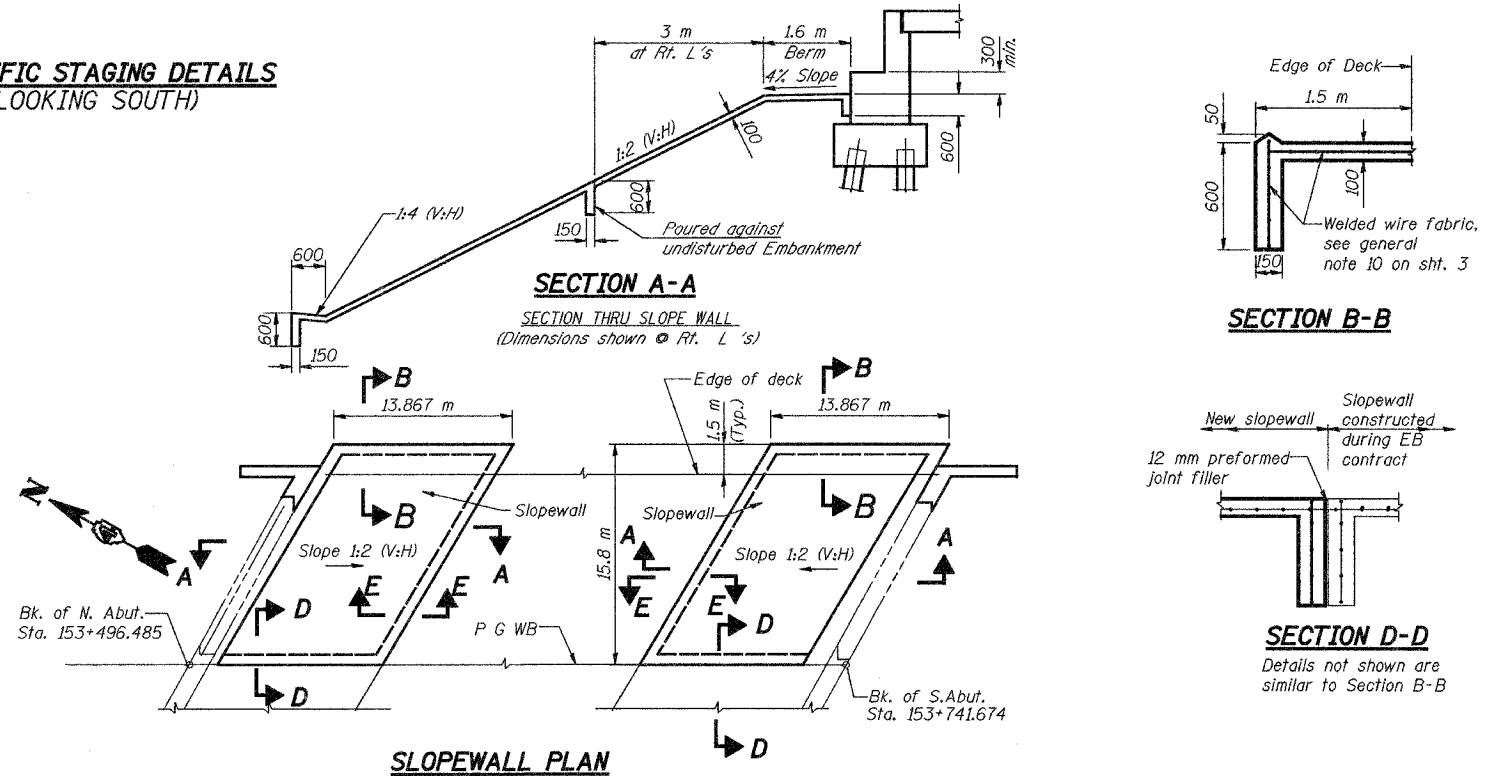

PROFILE GRADE I-74

PROFILE GRADE CAMP ST. W.B.  
(FROM SURVEY)

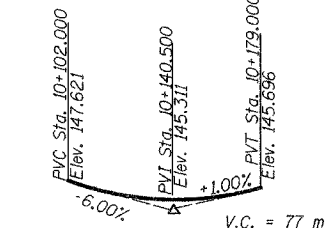

PROFILE GRADE RAMP K-1

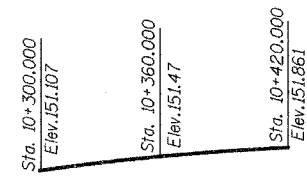

PROFILE GRADE RAMP J-2

CURVE DATA

WB CAMP ST. (Existing)	EB CAMP ST. (Existing)	EB CAMP ST. (Cont.)	RAMP K-1
Δ = 25°39'38.17"	Δ = 3°08'56.00"	Δ = 3°08'56.00"	Δ = 62°22'16.90"
R = 325.000 m	R = 1109.214 m	R = 1109.214 m	R = 155.000 m
T = 74.019 m	T = 30.488 m	T = 30.488 m	T = 93.818 m
L = 145.555 m	L = 60.961 m	L = 60.961 m	L = 168.731 m
E = 8.322 m	E = 0.419 m	E = 0.419 m	E = 29.182 m
PC = 99+958.149	PC = 200+000.000	PC = 200+060.961	PC = 10+621.912
PI = 100+032.168	PI = 200+030.488	PI = 200+091.449	PI = 10+715.730
PT = 100+103.704	PT = 200+060.961	PCC = 200+121.921	PT = 10+790.643
SE = 1.5 %	SE = 2.0 %	SE = 2.0 %	SE = 7.0%

Transition in : 10+573 to 10+643  
Transition out : N.A.

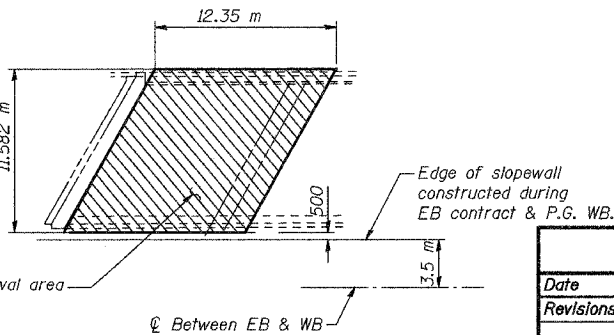

EXISTING SLOPEWALL REMOVAL PLAN  
(There is no exist. Slopewall at South Abutment)

CURVE DATA, SLOPEWALL AND STAGING DETAILS			
Date	Designed EV	WESTBOUND F.A.I. ROUTE 74 OVER CAMP STREET, FARM CREEK, AND TP&W RR F.A.I. RTE. 74 SECTION (90-13HVB)BY TAZEWELL COUNTY STATION 153+625.193 STRUCTURE NO. 090-0009	Sheet No.
Revisions	Drawn EV		2
	Checked NPP		of 68
	Approved NPP		
Prepared By: BRW, Inc. A Division of URS		1701 Golf Rd., Suite 1000 Rolling Meadows, IL.	BRW Job No. 17049-071