

ROUTE NO.	SECTION	COUNTY	SHEETS	SHEET NO.
FAI 74	*	TAZEWELL	1366 633	20 SHEETS
FED. ROAD DIST. NO. 7		ILLINOIS		FED. AID PROJECT
*90-11HB-5				

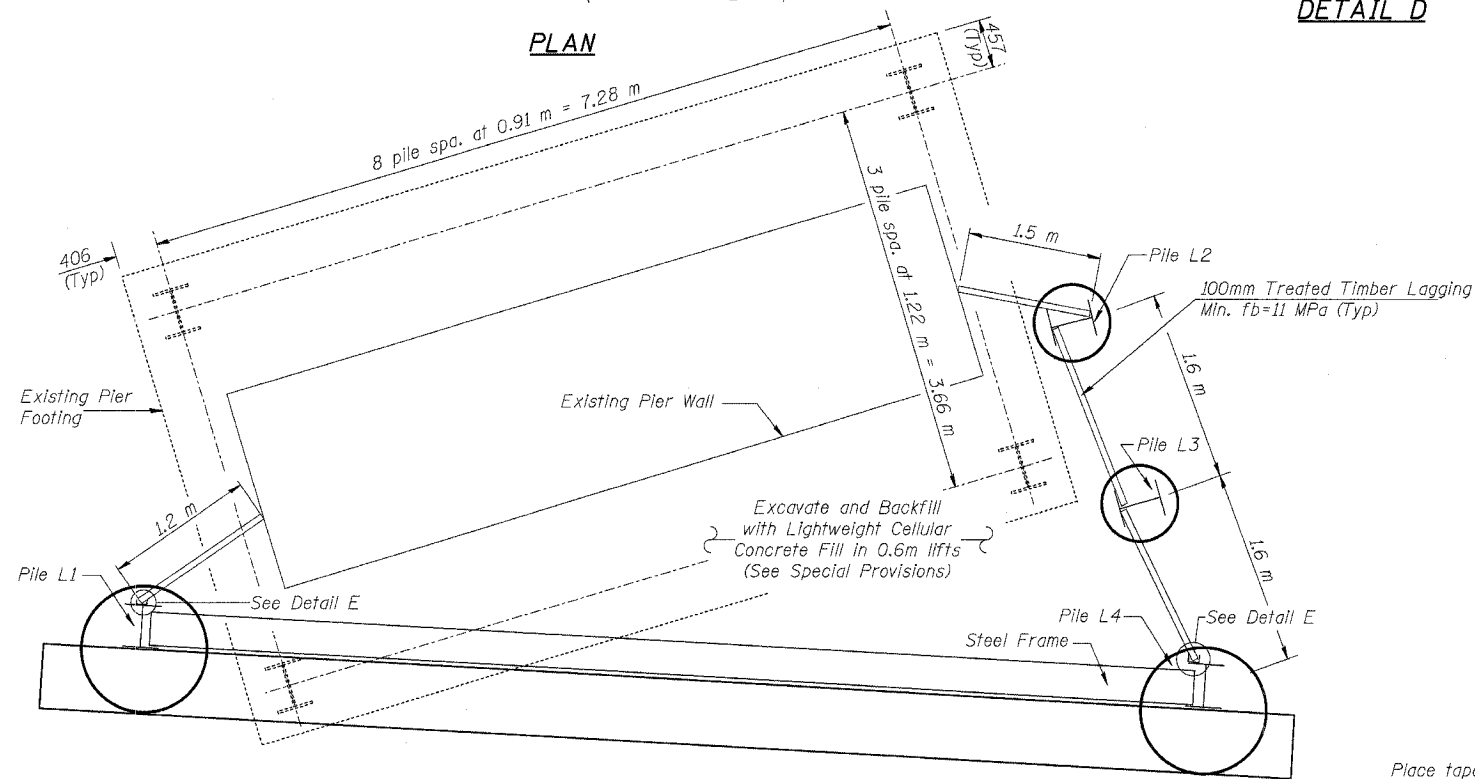

Item	Unit	Quantity
Treated Timber Lagging	m ²	23
Lightweight Cellular Concrete Fill	m ³	51.7
Structural Steel	kg	3290
Stud Shear Connectors	Each	94

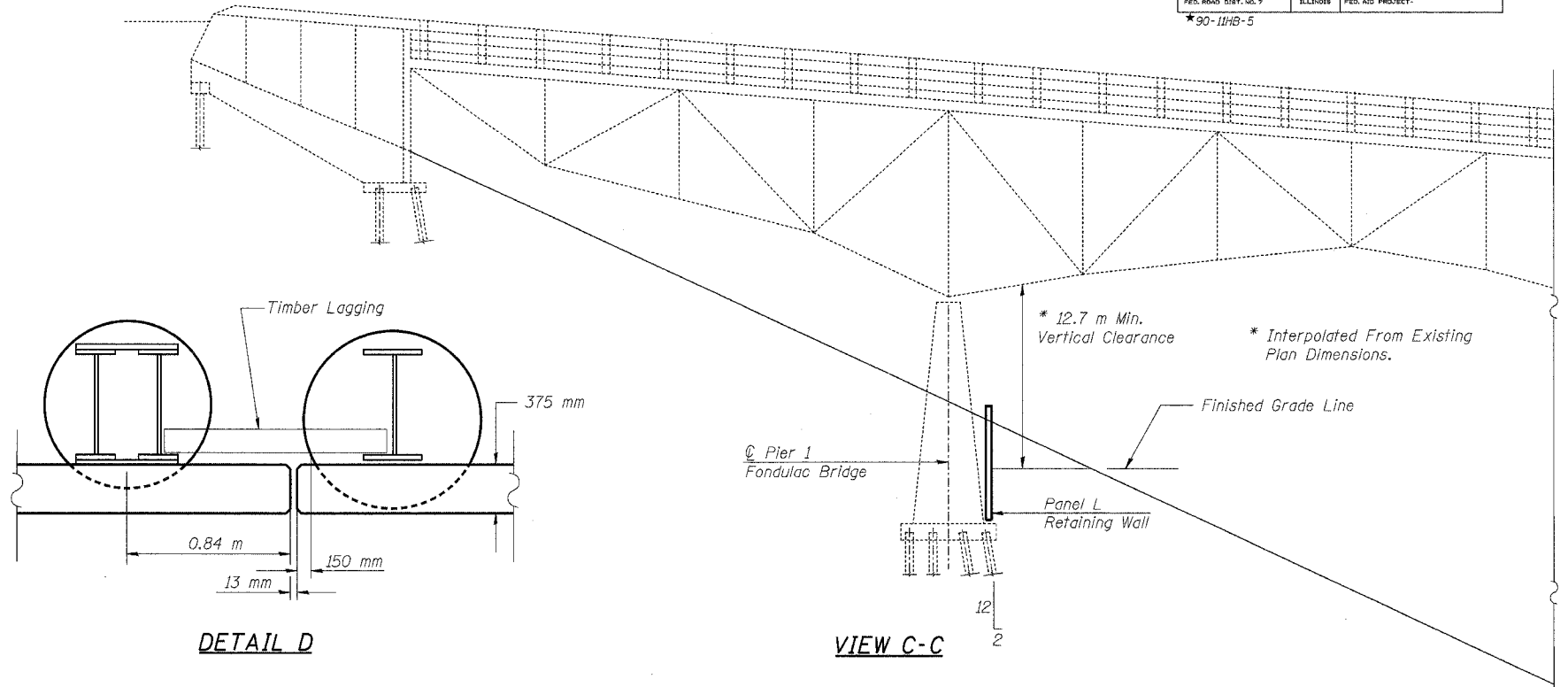
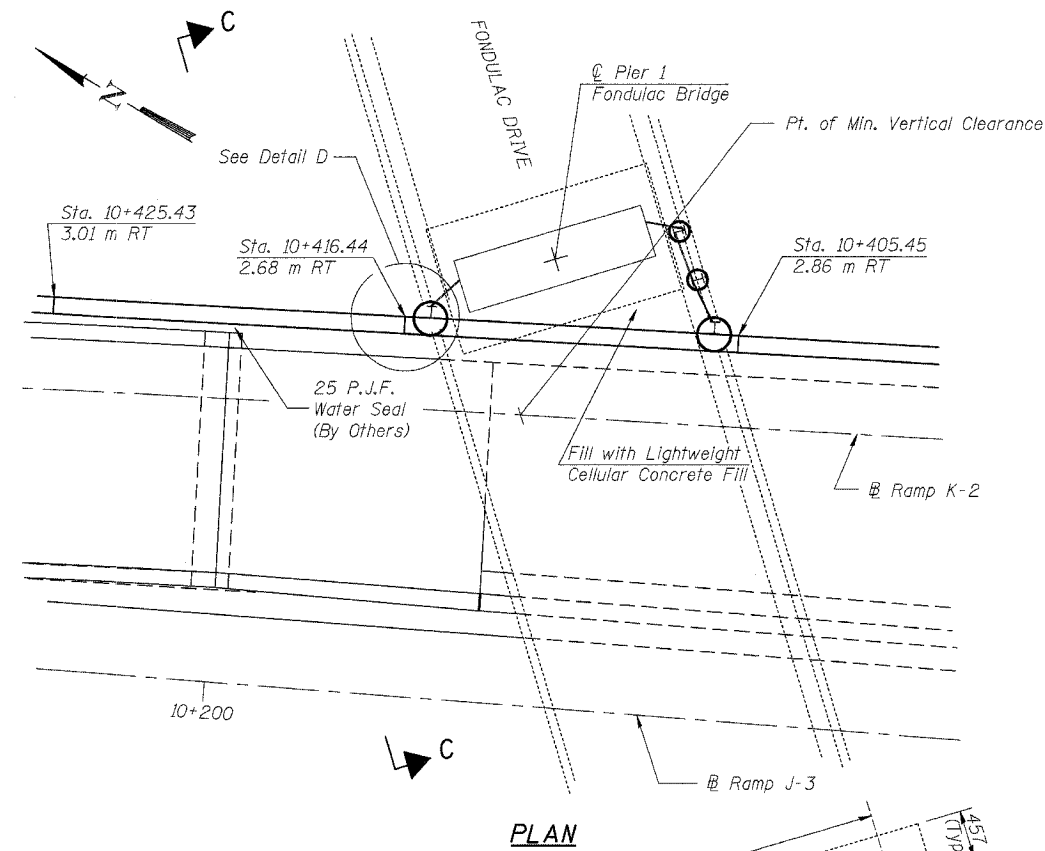
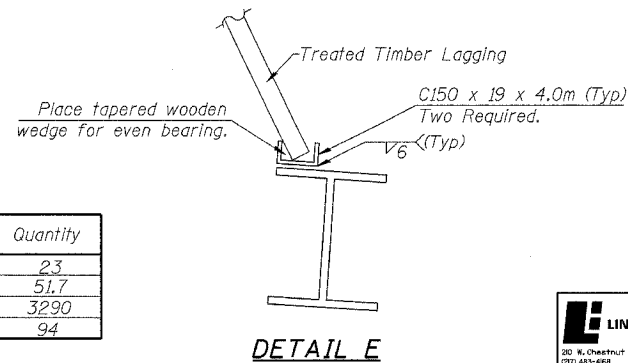
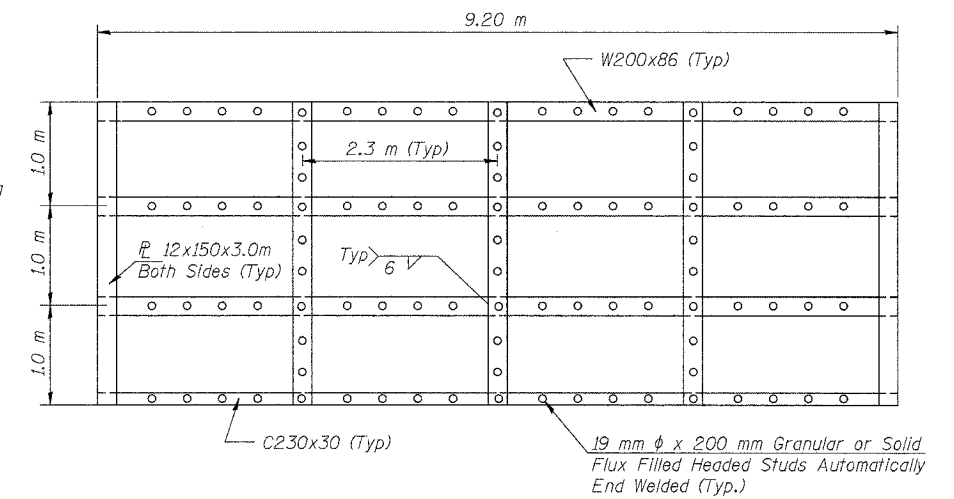
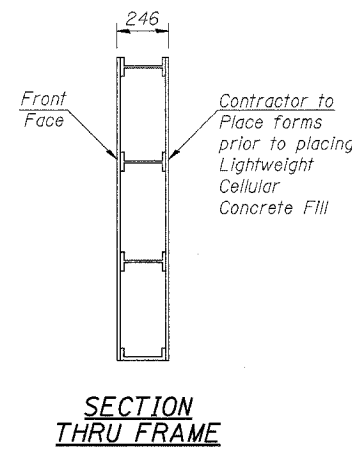

SEQUENCE OF CONSTRUCTION

1. Drill and set soldier piles L1 thru L4.
2. Place treated timber lagging as shown while excavating on west side of pier.
3. Place steel frame between piles L1 and L4 and provide formwork on east face.
4. Backfill with Low Weight Material (See Special Provisions).
5. Place shear connectors and cast concrete panels.

REVISIONS

NO.	DATE	DESCRIPTION

LIN ENGINEERING, LTD.

20 W. Chestnut
Chicago, Illinois 60629
Tel: 312-461-4644 Fax: 312-461-4700
Designed By: MTH Checked By: KR6 Drawn By: JMD
Date: 09/02 File: r90411-500908513.dgn

ILLINOIS DEPARTMENT OF TRANSPORTATION
MISCELLANEOUS DETAILS
RETAINING WALL 82
F.A.I. RTE. 74 (I-74)
SECTION 90-11HB-5
TAZEWELL COUNTY
RAMP K-2 STATION 10+378 TO 10+507
STRUCTURE NUMBER 090-8513