

...:\pbase2\ref\141102-5am.dwg 12/15/2004 2:37:34 PM

54 52 50 48 46 44 42 40 38 36 34 32 30 28 26 24 22 20 18 16 14 12 10 8 6 4 2 0 2 4 6 8 10 63201

| | | | | | |
|--|---------------------|----------------------|----------|------------------|-----------|
| URS URS CORPORATION ST. LOUIS, MO | F.A.I. RTE. | SECTION | COUNTY | TOTAL SHEETS | SHEET NO. |
| | 74 | 100-11R-2803J44-1R-1 | TAZEWELL | 1360 | 150 |
| | STA. | TO STA. | | FED. AID PROJECT | |
| | FED. ROAD DIST. NO. | ILLINOIS | | | |

| | | |
|---------------|----|------|
| FINAL SURVEY | BY | DATE |
| SURVEYED | | |
| NOTE BOOK | | |
| NO. | | |
| AREAS CHECKED | | |

| | | |
|-----------------|----|------|
| ORIGINAL SURVEY | BY | DATE |
| SURVEYED | | |
| NOTE BOOK | | |
| NO. | | |
| AREAS CHECKED | | |

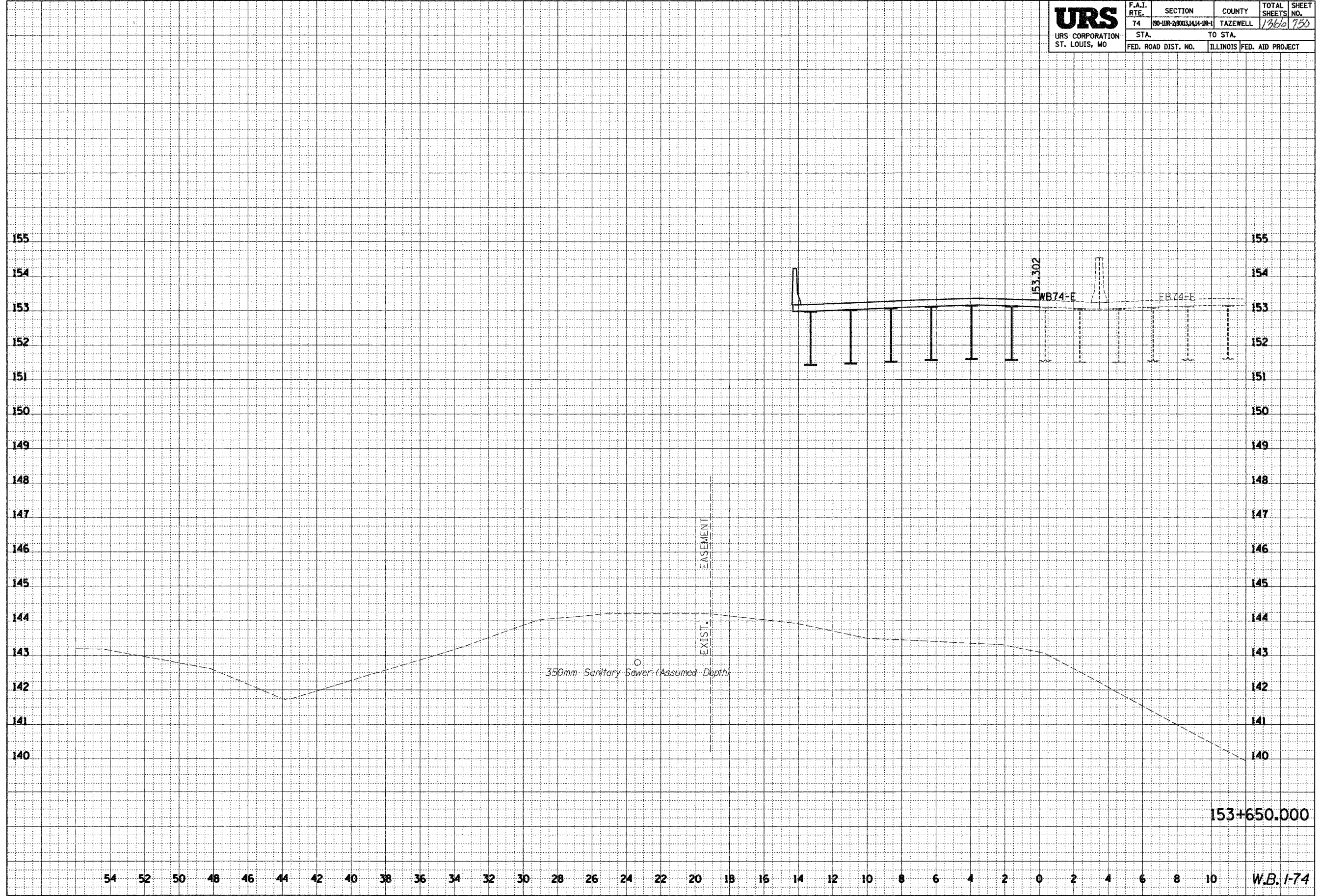

153+650.000

54 52 50 48 46 44 42 40 38 36 34 32 30 28 26 24 22 20 18 16 14 12 10 8 6 4 2 0 2 4 6 8 10 W.B. 1-74