

...:\projects\11101-5am.dwg 12/16/2004 4:00:03 PM

F.A.I. SECTION		COUNTY	TOTAL SHEETS	SHEET NO.
74 *		TAZEWELL	1266	885
STA. TO STA.		ILLINOIS FED. AID PROJECT		
		*(90-IIR-2)9003,4,14-DR-1		

FINAL SURVEY	DATE
NO.	
SURVEYED	BY
NOTE BOOK	
AREAS	
CHECKED	

URS
URS CORPORATION
DECATUR, ILLINOIS

ORIGINAL SURVEY	DATE
NO.	
SURVEYED	BY
NOTE BOOK	
AREAS	
CHECKED	

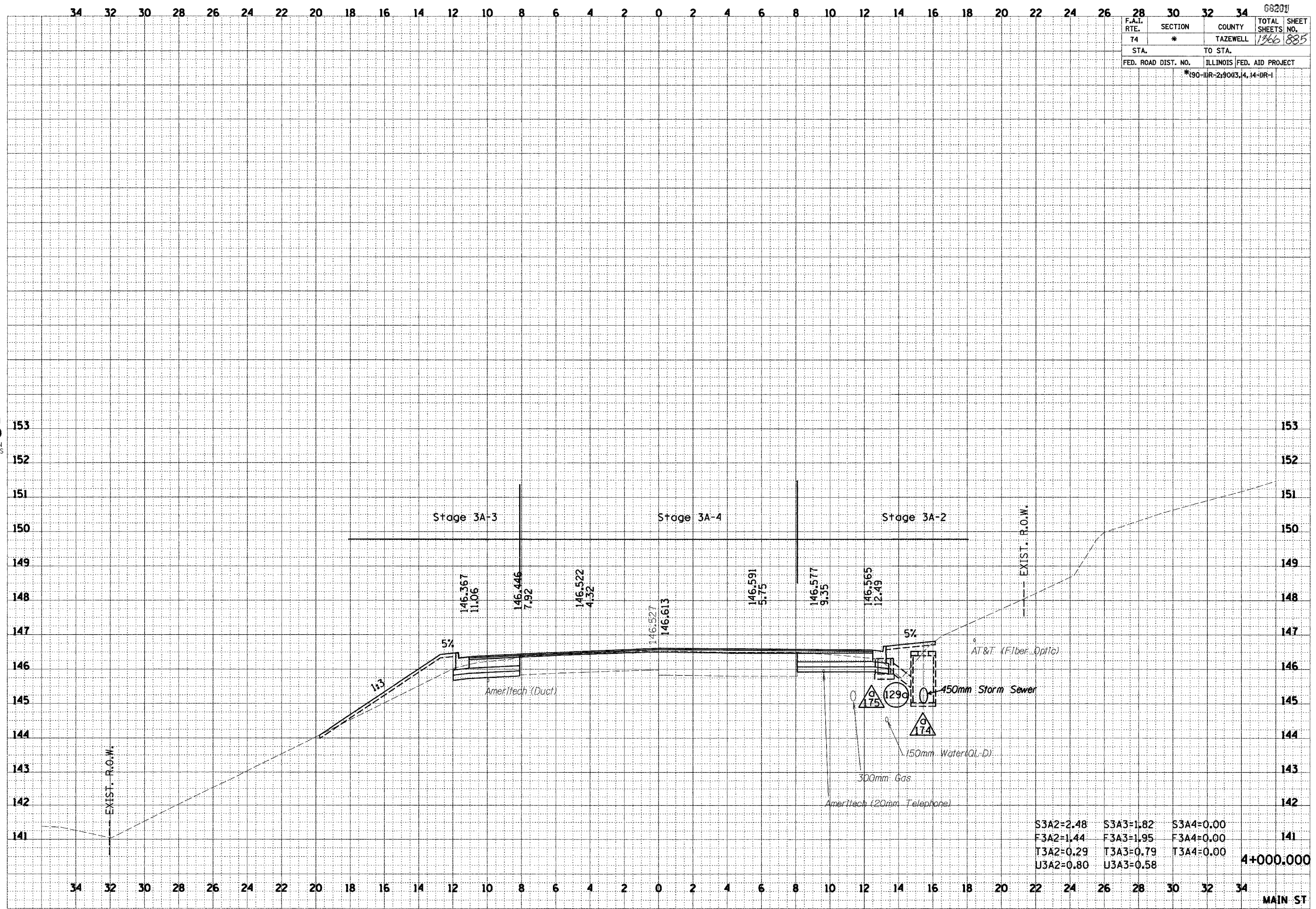

S3A2=2.48	S3A3=1.82	S3A4=0.00
F3A2=1.44	F3A3=1.95	F3A4=0.00
T3A2=0.29	T3A3=0.79	T3A4=0.00
U3A2=0.80	U3A3=0.58	

4+000.000

MAIN ST