

CURVE LAYOUT DATA									
CURVE NO.	PI STA.	NORTHING	EASTING	PC/PCC STA.	NORTHING	EASTING	PT/PCC	NORTHING	EASTING
2013	155+476.818	442,480.5659	751,332.2614	154+962.013	442,928.2006	751,078.0040	155+964.709	442,235.7311	751,785.1185

STATION EQUATIONS		NORTHING	EASTING
8	STA. 154+525.000 (W.B. I-74) = STA. 10+000.000 (RAMP L-3)	443,311.8984	750,868.6882

F.A.I. RTE.	SECTION	COUNTY	TOTAL SHEETS	SHEET NO.
74	*	TAZEWELL	1366	938
STA. 154+500		TO STA. 155+200		
FED. ROAD DIST. NO. 4		ILLINOIS FED. AID PROJECT		

• (90-11)R-2;90(13,14,14-1)R-1

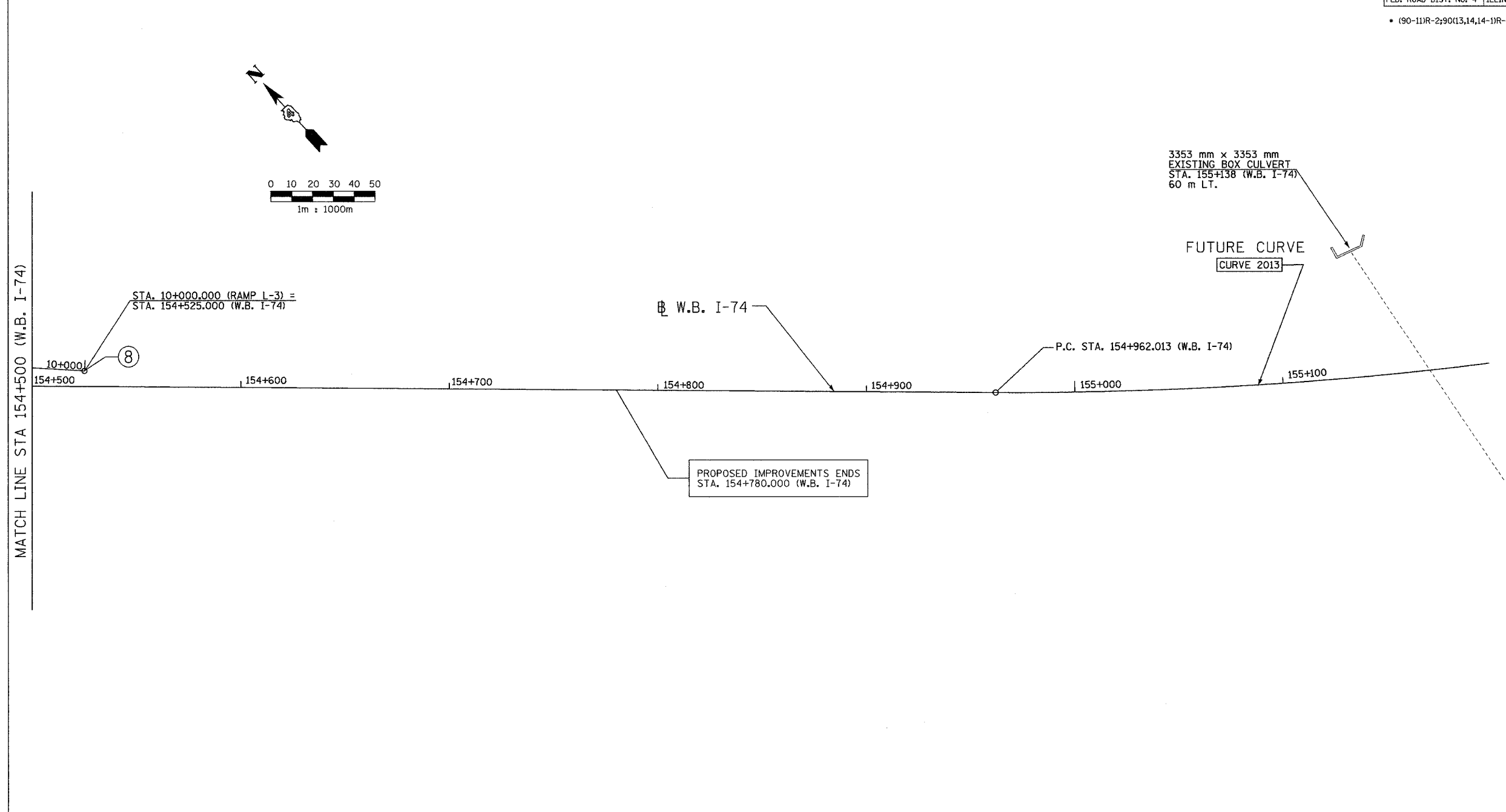

FUTURE CURVE DATA	
CURVE NO.	2013
ALIGNMENT	W.B. I-74
DESIGN SPEED	100 KM/H
P.I. STA	155+476.818
Δ	32°00'21"
R	1795.000 m
T	514.805 m
L	1002.696 m
E	72.364 m
S.E.	+3.1%
TRANSITION IN	154+898-154+984
TRANSITION OUT	155+943-156+029
P.C. STA	154+962.013
P.T. STA	155+964.709



REVISIONS	
NAME	DATE

SHEET 2 OF 2

ALL STATIONS INDICATED ARE WESTBOUND STATIONING UNLESS OTHERWISE NOTED.

ILLINOIS DEPARTMENT OF TRANSPORTATION

SCHEMATIC DRAWING  
F.A.I. ROUTE 74 (I-74)  
STA. 154+500 TO 155+200

DATE 01/07/2005

DRAWN BY  
CHECKED BY

01/07/2005 05:45:58 PM  
D:\gdg\15589-74\dwg\contractor\132-5a.dwg

CONTRACT 11: PLAN SET 2 OF 4 FINAL PLANS 01/05