

CURVE LAYOUT DATA									
CURVE NO.	PI STA.	NORTHING	EASTING	PC/PCC STA.	NORTHING	EASTING	PT/PCC	NORTHING	EASTING
1	99+774.193	443,790.4112	750,321.5725	99+752.727	443,794.6459	750,299.4680	99+795.734	443,793.4474	750,343.8733
2	99+873.458	443,804.3375	750,423.8587	99+795.734	443,793.4474	750,343.8733	99+952.112	443,843.1550	750,494.6364
3	99+994.193	443,863.5904	750,531.8973	99+952.112	443,843.1550	750,494.6364	100+036.394	443,884.9010	750,568.6648
4	100+083.641	443,908.9756	750,610.2014	100+036.394	443,884.9010	750,568.6648	100+130.848	443,938.5325	750,648.0334
5	100+172.949	444,008.9837	750,699.5805	100+130.848	443,938.5325	750,648.0334	100+214.220	443,808.7800	750,494.6364
6	99+776.215	443,801.2277	750,323.4295	99+753.665	443,805.4227	750,301.5326	99+798.638	443,807.5361	750,344.8135
7	99+979.567	443,858.5819	750,517.8494	99+798.638	443,807.5361	750,344.8135	100+160.845	443,973.6409	750,656.8044

F.A.I. RTE.	SECTION	COUNTY	TOTAL SHEETS	SHEET NO.
74*	**	TAZEWELL	1366	935
STA. 99+722.695		TO STA. 100+213.313		
FED. ROAD DIST. NO.		ILLINOIS	FED. AID PROJECT	
*WASHINGTON STREET **90-111R-2;90113,14,14-1R-1				

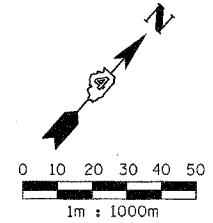
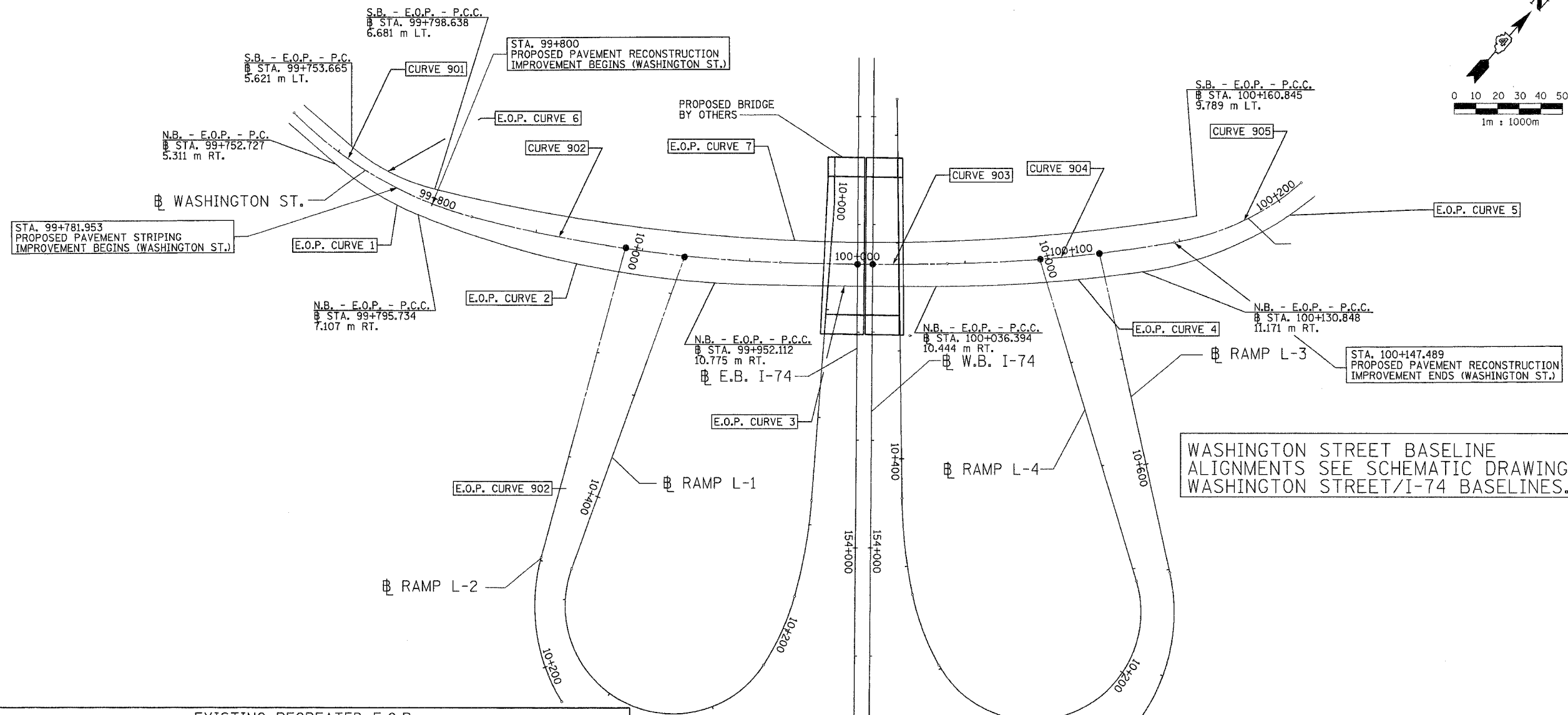

EXISTING RECREATED E.O.P.							
CURVE NO.	1	2	3	4	5	6	7
ALIGNMENT	WASHINGTON	WASHINGTON	WASHINGTON	WASHINGTON	WASHINGTON	WASHINGTON	WASHINGTON
P.I. STA	99+774.193	99+873.458	99+994.193	100+083.641	100+172.949	99+776.215	99+979.567
OFFSET (ft)	8.515 m RT	18.197 m RT	10.475 m RT	12.521 m RT	15.277 m RT	2.266 m LT	8.055 m RT
Δ	20°12'14"	20°57'02"	01°23'39"	07°51'47"	31°39'18"	27°16'49"	23°11'23"
R	126.3291 m	436.595 m	3492.759 m	698.558 m	160.020 m	91.871 m	879.284 m
T	22.507 m	80.723 m	42.497 m	48.009 m	45.364 m	22.294 m	180.408 m
L	44.547 m	159.643 m	84.990 m	95.867 m	88.408 m	43.742 m	355.877 m
E	1.989 m	47.400 m	0.259 m	1.648 m	6.306 m	2.666 m	18.317 m
S.E.	N.C.	N.C.	N.C.	N.C.	N.C.	N.C.	N.C.
TRANSITION IN	N/A	N/A	N/A	N/A	N/A	N/A	N/A
TRANSITION OUT	N/A	N/A	N/A	N/A	N/A	N/A	N/A
P.C. STA (ft)	99+752.727	99+795.734	99+952.112	100+036.394	100+130.848	99+753.665	99+798.638
OFFSET (ft)	5.311 m RT	7.107 m RT	10.775 m RT	10.444 m RT	11.171 m RT	5.621 m LT	6.681 m LT
P.T. STA (ft)	99+795.734	99+952.112	100+036.394	100+130.848	100+214.220	99+798.638	100+160.845
OFFSET	7.107 m RT	10.775 m RT	10.444 m RT	11.171 m RT	8.667 m RT	6.681 m LT	9.789 m LT

WASHINGTON STREET BASELINE ALIGNMENTS SEE SCHEMATIC DRAWING WASHINGTON STREET/I-74 BASELINES.

ALL DIMENSIONS ARE IN METERS (m) EXCEPT AS NOTED

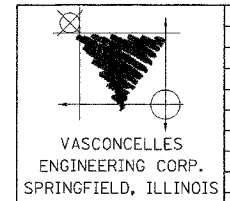

REVISIONS	
NAME	DATE

ILLINOIS DEPARTMENT OF TRANSPORTATION
 SCHEMATIC DRAWING
 WASHINGTON STREET/EDGE OF PAVEMENT ALIGNMENT
 STA. 99+722.695 TO 100+213.313
 DRAWN BY
 CHECKED BY
 DATE

CONTRACT 11: PLAN SET 2 OF 3 PRE-FINAL 02/02/04 VEC 8 OF 53 JOB NO. 751-001 VASCONCELLES ENGINEERING CORP. DESIGN FIRM REGISTRATION NUMBER 184-002107

sc0002-6dws