

F.A.I. RTE.	SECTION	COUNTY	TOTAL SHEETS	SHEET NO.
74	*	TAZEWELL	1366	942
STA. 154+850		TO STA. 155+200		
FED. ROAD DIST. NO. 4		ILLINOIS FED. AID PROJECT		

• (90-11)R-2;90(13,14,14-1)R-1

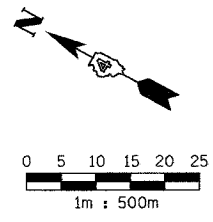

NOTE: ALL CONTRACTOR FURNISHED TEMPORARY CONCRETE BARRIER WITHIN THIS SECTION SHALL BE TYPE F CONCRETE BARRIER.

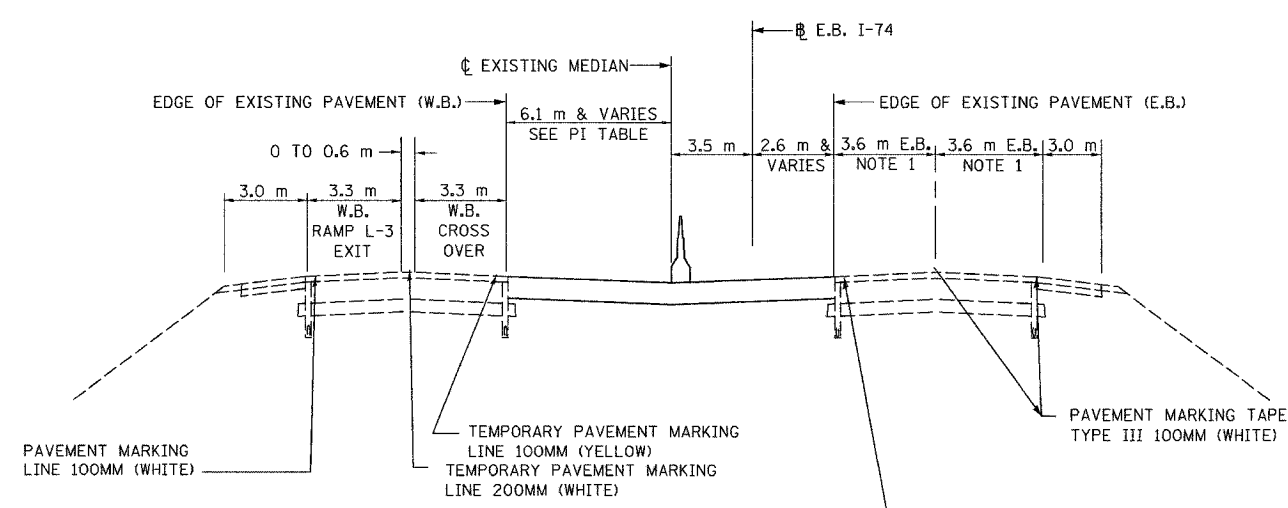
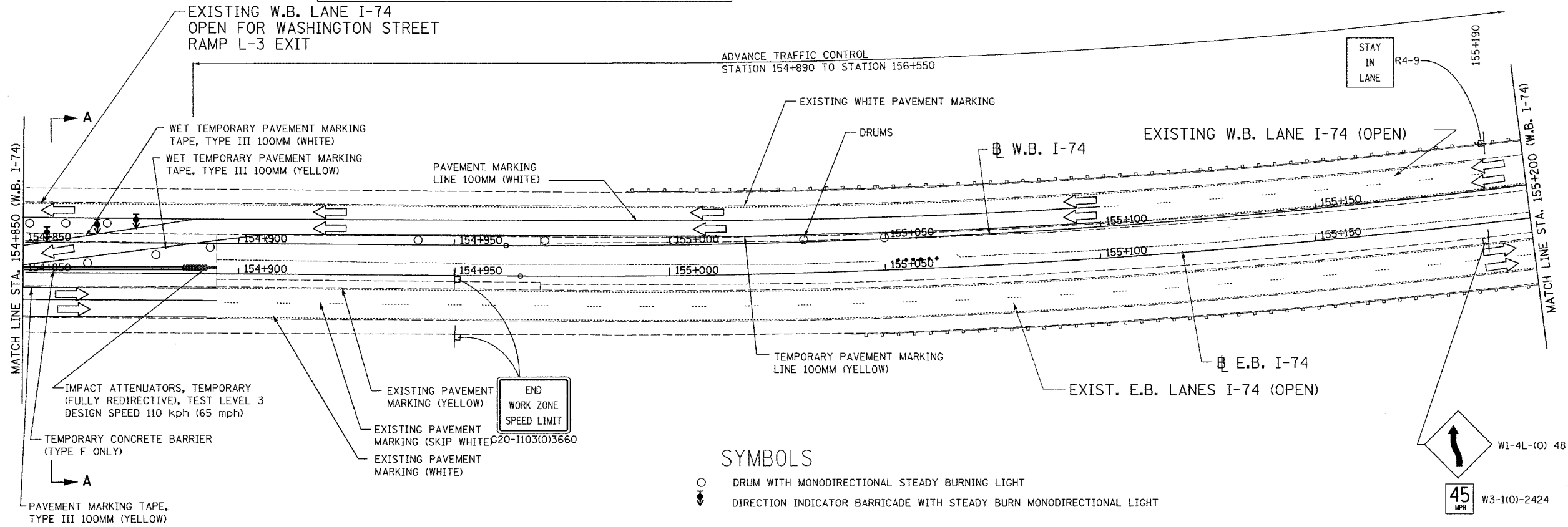

NOTE 1 - 3.3 m LANES STA. 154+760 TO 154+887
STA. 154+887 TO 154+900 3.3 m TO 3.6 m

SECTION A-A

REFER TO TYPICAL SECTIONS THIS CONTRACT FOR PAVEMENT STRUCTURE

LOCATION	OFFSET IN METERS FROM EASTBOUND BASE LINE					
	WESTBOUND		EASTBOUND			
	SOLID WHITE	SOLID YELLOW	SOLID YELLOW	CENTER WHITE	OUTER WHITE	TCB LANE DIVIDER
STA. 154+860.00	3.5 LT		3 RT	6.3 RT	9.6 RT	0.55 LT
STA. 154+887.00			2.6 RT	6.2 RT	9.8 RT	
STA. 154+900.00	12.8 LT	9.5 LT				
STA. 154+906.40						

ALL DIMENSIONS ARE IN METERS (m) EXCEPT AS NOTED

ALL STATIONS INDICATED ARE WESTBOUND STATIONING UNLESS OTHERWISE NOTED.

DA & A
DAILY & ASSOCIATES, ENGINEERS, INC.
PEORIA, ILLINOIS

REVISIONS	
NAME	DATE

ILLINOIS DEPARTMENT OF TRANSPORTATION

MAINTENANCE OF TRAFFIC
STAGE 3A
STA. 154+850 TO STA. 155+200

DATE 01/07/2005

DRAWN BY
CHECKED BY

01/07/2005 04:48:19 PM
q:\data\5589-74\dwg\contract\m1104_3a-6a.dwg

CONTRACT 11: PLAN SET 2 OF 4 FINAL PLANS 01/05