

F.A.I. RTE.	SECTION	COUNTY	TOTAL SHEETS	SHEET NO.
74	*	TAZEWELL	1366	952
STA. 153+800		TO STA. 157+800		
FED. ROAD DIST. NO. 4		ILLINOIS FED. AID PROJECT		

• (90-11)R-2;90(13,14,14-1)R-1

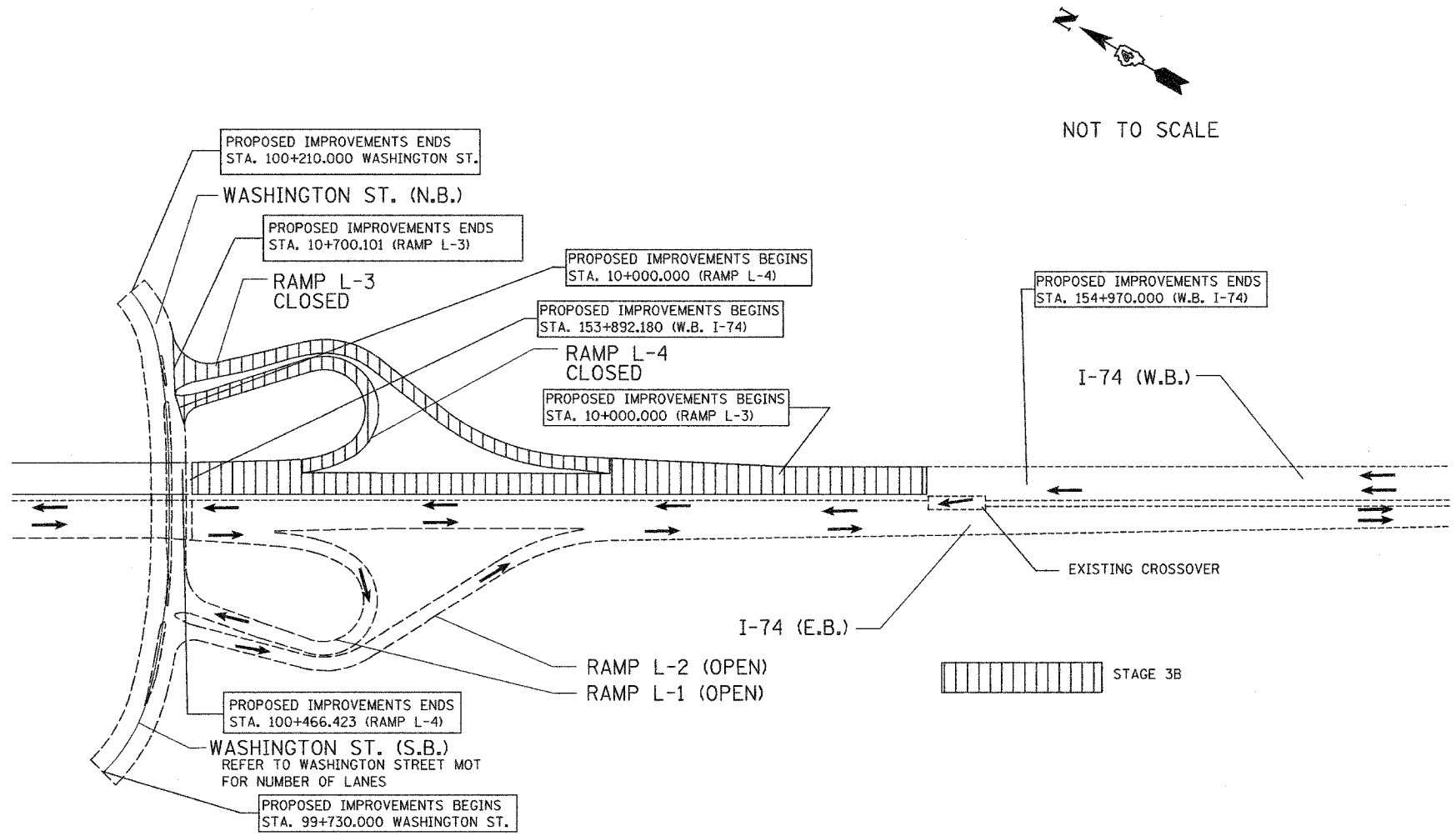

NOT TO SCALE

**F.A.I. ROUTE 74 (W.B. I-74)**

**MAINTENANCE OF TRAFFIC AND CONSTRUCTION SEQUENCE**

**STAGE 3B CONSTRUCTION:**

1. CLOSE THE WESTBOUND EXIT RAMP L-3.
2. REMOVE THE EXISTING PAVEMENT AND SHOULDERS ON THE WESTBOUND LANES BETWEEN STATION 154+250.000 AND STATION 154+780.000, ALL OF RAMP L-3 AND A PORTION OF RAMP L-4.
3. COMPLETE THE CONSTRUCTION OF THE PAVEMENT STRUCTURE, INCLUDING THE AGGREGATE SUBBASE, BITUMINOUS CONCRETE BINDER COURSE, CONTINUOUSLY REINFORCED PCC PAVEMENT, PCC CONCRETE SHOULDER, AGGREGATE SHOULDER AND OTHER INCIDENTAL ITEMS. THE WORK ZONE INCLUDES THE WESTBOUND LANES ON I-74 BETWEEN STATION 153+892.108 AND 154+250.000.
4. COMPLETE THE CONSTRUCTION OF THE PAVEMENT STRUCTURE, INCLUDING THE AGGREGATE SUBBASE, BITUMINOUS CONCRETE BINDER COURSE, PCC PAVEMENT, PCC CONCRETE SHOULDER, PCC GUTTER AND OTHER INCIDENTAL ITEMS ON RAMP L-3 AND L-4.
5. APPLY PERMANENT STRIPPING FOR WESTBOUND I-74, RAMP L-3, AND RAMP L-4.

**STAGE 3B TRAFFIC**

1. USING STANDARD 701411-I74, CLOSE RAMP L-3.
2. MAINTAIN TWO WAY TRAFFIC ON THE EXISTING I-74 EASTBOUND LANES FROM STATION 153+892.180 TO STATION 154+780.000. MAINTAIN CROSSOVER.

**SUMMARY OF TEMPORARY CONCRETE BARRIER IN STAGE 3B**

REMOVE TEMPORARY CONCRETE BARRIER; REMOVE TEMPORARY CONCRETE BARRIER, STATE OWNED FROM EXISTING WESTBOUND PAVEMENT AND MEDIAN SHOULDER OF WESTBOUND PAVEMENT FROM STATION 154+203 TO STATION 154+350 AND STATION 154+350 TO STATION 154+780.

SHEET 11 OF 18

ALL STATIONS INDICATED ARE WESTBOUND STATIONING UNLESS OTHERWISE NOTED.

ILLINOIS DEPARTMENT OF TRANSPORTATION

MAINTENANCE OF TRAFFIC SCHEMATIC DRAWING  
STAGE 3B  
STA. 153+800 TO STA. 157+800

DRAWN BY  
CHECKED BY

DATE 01/12/2005



REVISIONS	
NAME	DATE

01/12/2005 05:27:55 PM  
d:\dotg\5589-74\dwg\contr\ce\11\m110\_3b-6e.dgn

CONTRACT 11: PLAN SET 2 OF 4 FINAL PLANS 01/05