

F.A.I. RTE.	SECTION	COUNTY	TOTAL SHEETS NO.	SHEET NO.
74	*	TAZEWELL	1368	955
STA. 154+500		TO STA. 154+850		
FED. ROAD DIST. NO. 4		ILLINOIS FED. AID PROJECT		

• (90-11)R-2;90(13,14,14-1)R-1

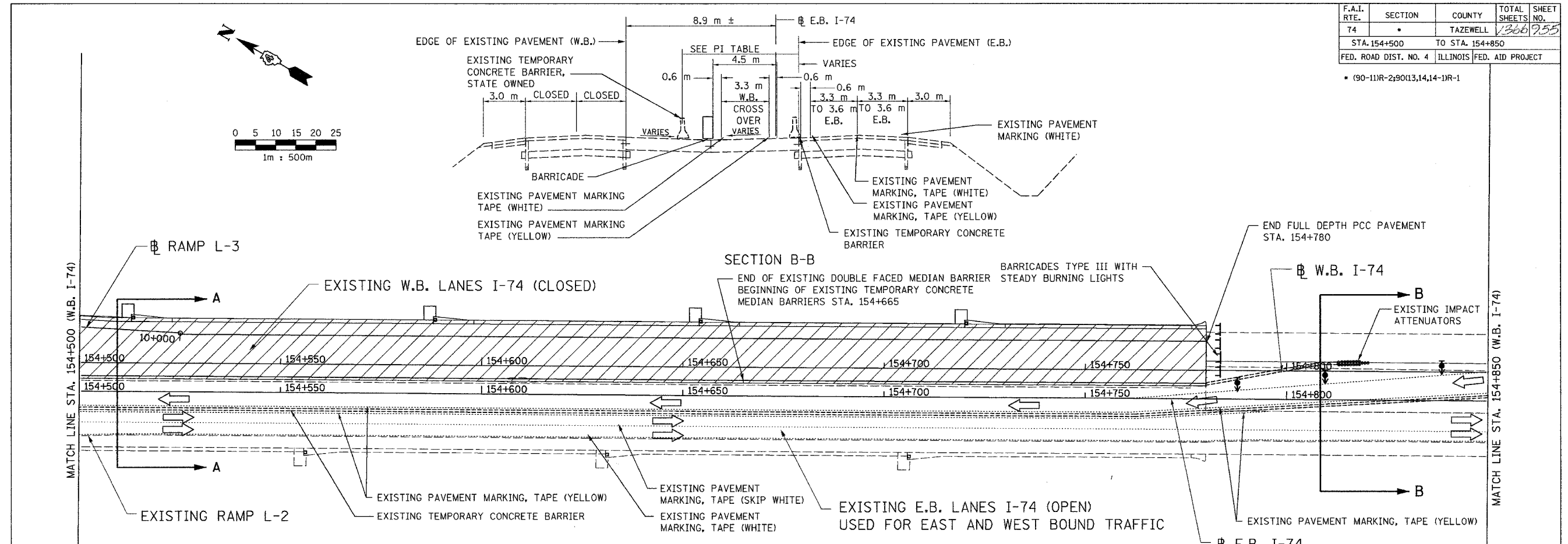

SYMBOLS

- WORK AREA
- DIRECTION INDICATOR BARRICADE WITH STEADY BURN MONODIRECTIONAL LIGHT

RAMP L-3
WIDTH VARIES 5.0 m ± TO 0
STA. 154+325 ± TO STA. 154+525 ±

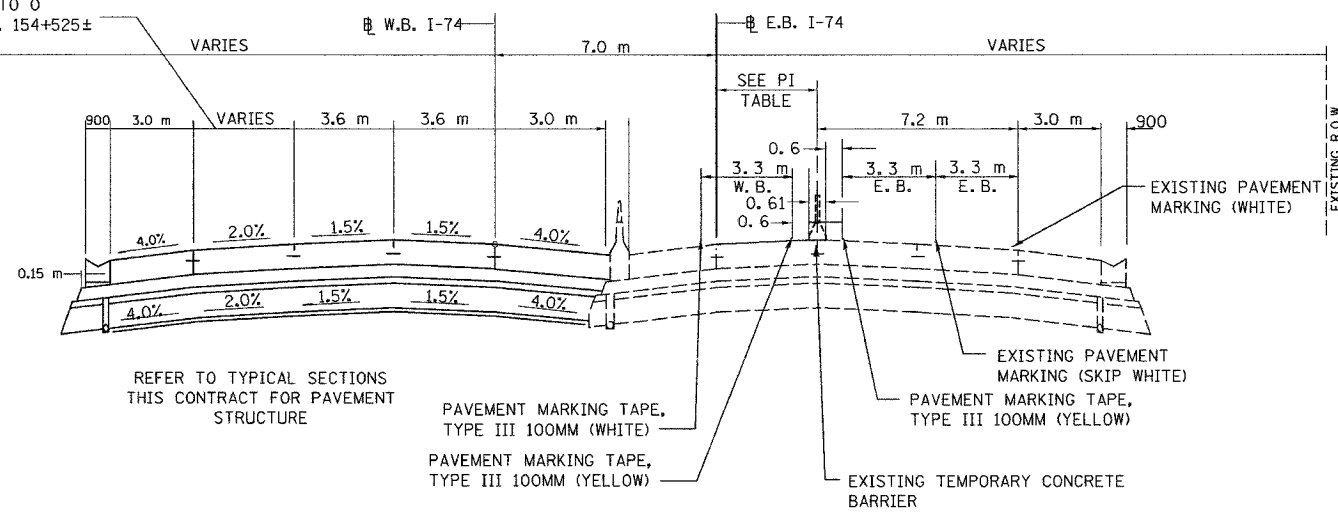

REFER TO TYPICAL SECTIONS THIS CONTRACT FOR PAVEMENT STRUCTURE

LOCATION	POINTS OF INTERSECTION (PI) TABLE						
	OFFSET IN METERS FROM EASTBOUND BASE LINE						
	WESTBOUND			EASTBOUND			
	SOLID WHITE	SOLID YELLOW	TCB OUTER	SOLID YELLOW	CENTER WHITE	OUTER WHITE	TCB LANE DIVIDER
STA. 154+500.00	0.6 LT	2.7 RT.		4.5 RT	7.8 RT	11.1 RT	3.6 RT.
STA. 154+760.00	0.6 LT	2.7 RT.		4.5 RT	7.8 RT	11.1 RT	3.6 RT.
STA. 154+762.00							
STA. 154+780.00			3.16 LT				
STA. 154+810.00			9 LT				

SECTION A-A

TRAFFIC CONTROL:
LANE CLOSURE SHALL BE IN ACCORDANCE WITH STANDARD 701416

ALL DIMENSIONS ARE IN METERS (m) EXCEPT AS NOTED

ALL STATIONS INDICATED ARE WESTBOUND STATIONING UNLESS OTHERWISE NOTED.

DA
DAILY & ASSOCIATES, ENGINEERS, INC.
PEORIA, ILLINOIS

REVISIONS	
NAME	DATE

ILLINOIS DEPARTMENT OF TRANSPORTATION
MAINTENANCE OF TRAFFIC STAGE 3B
STA. 154+500 TO STA. 154+850
DRAWN BY
CHECKED BY
DATE 01/07/2005

01/07/2005 04:48:24 PM
G:\data\5589-74\dwg\contract\mth\3_3b-6a.dgn

CONTRACT 11: PLAN SET 2 OF 4 FINAL PLANS 01/05

C:\MSOFT\311\11313-36-46-00-01072005\04-48-24 PM