

F.A.I. RTE.	SECTION	COUNTY	TOTAL SHEETS	SHEET NO.
74*	**	TAZEWELL	1966	973
STA. 99+960		TO STA. 100+050		
FED. ROAD DIST. NO.		ILLINOIS	FED. AID PROJECT	
*WASHINGTON STREET		**(90-1DR-2)90(13,14,14-1R-1		

TRAFFIC CONTROL
 LANE CLOSURE ON WASHINGTON STREET
 SHALL BE IN ACCORDANCE WITH
 STANDARD 701601 FOR PLACEMENT OF
 DRUMS OR BARRICADES

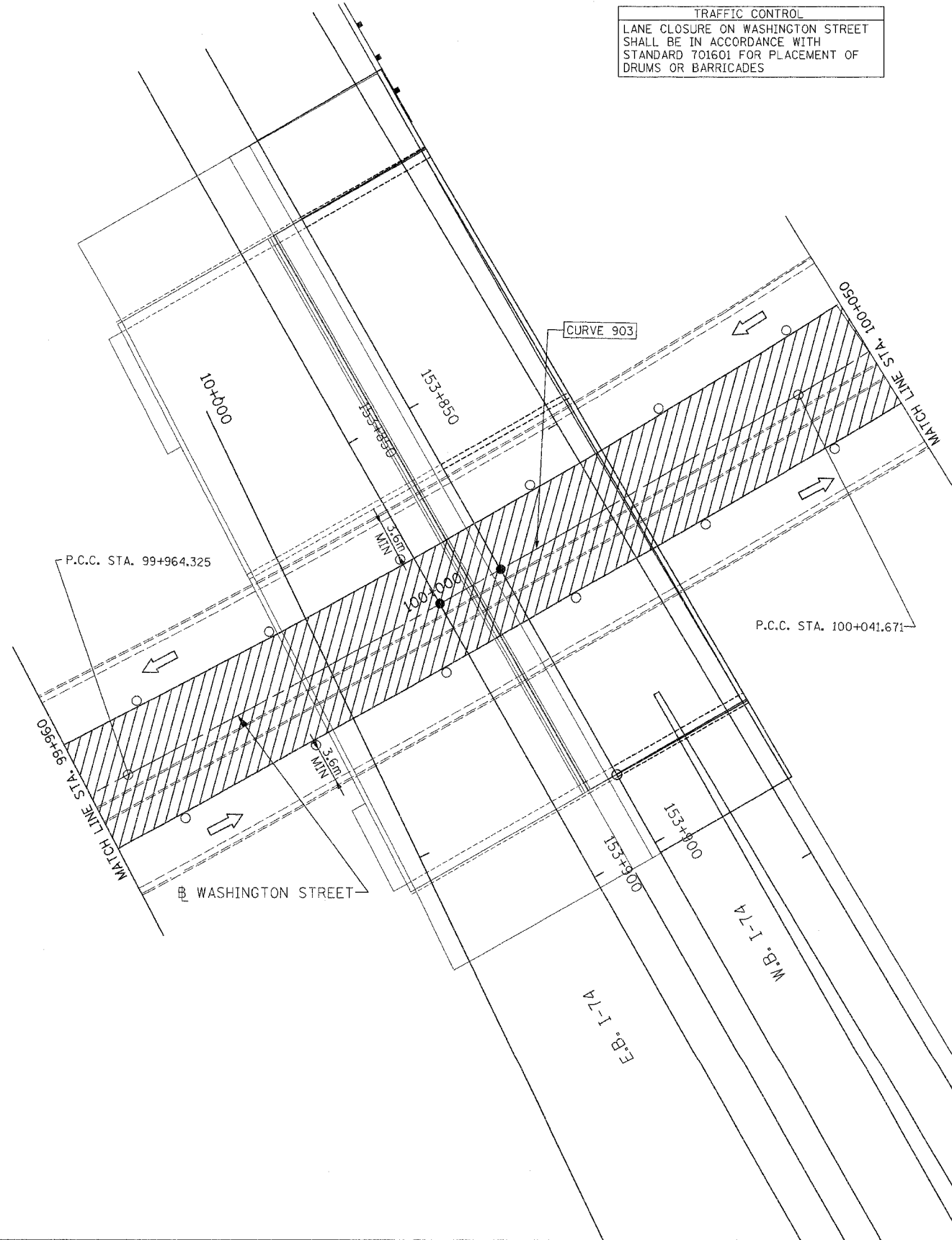
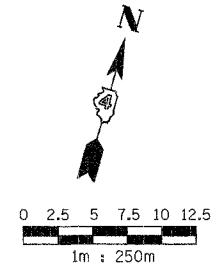

- SYMBOLS**
- WORK AREA
 - DRUM OR BARRICADE 15.2m (50') SPACING
 - DIRECTION OF TRAFFIC FLOW

VASCONCELLES
 ENGINEERING CORP.
 SPRINGFIELD, ILLINOIS

REVISIONS	
NAME	DATE

ILLINOIS DEPARTMENT OF TRANSPORTATION

MAINTENANCE OF TRAFFIC
 STAGE 3-1
 WASHINGTON STREET
 STA. 99+960 TO STA. 100+050

DATE _____ DRAWN BY _____
 CHECKED BY _____

mf0002-6bws

CONTRACT 111 PLAN SET 2 OF 3 PRE-FINAL 02/02/04 VEC 11 OF 53. JOB NO. 751-001 VASCONCELLES ENGINEERING CORP. DESIGN FIRM REGISTRATION NUMBER 184-002107